

# Ground Floor

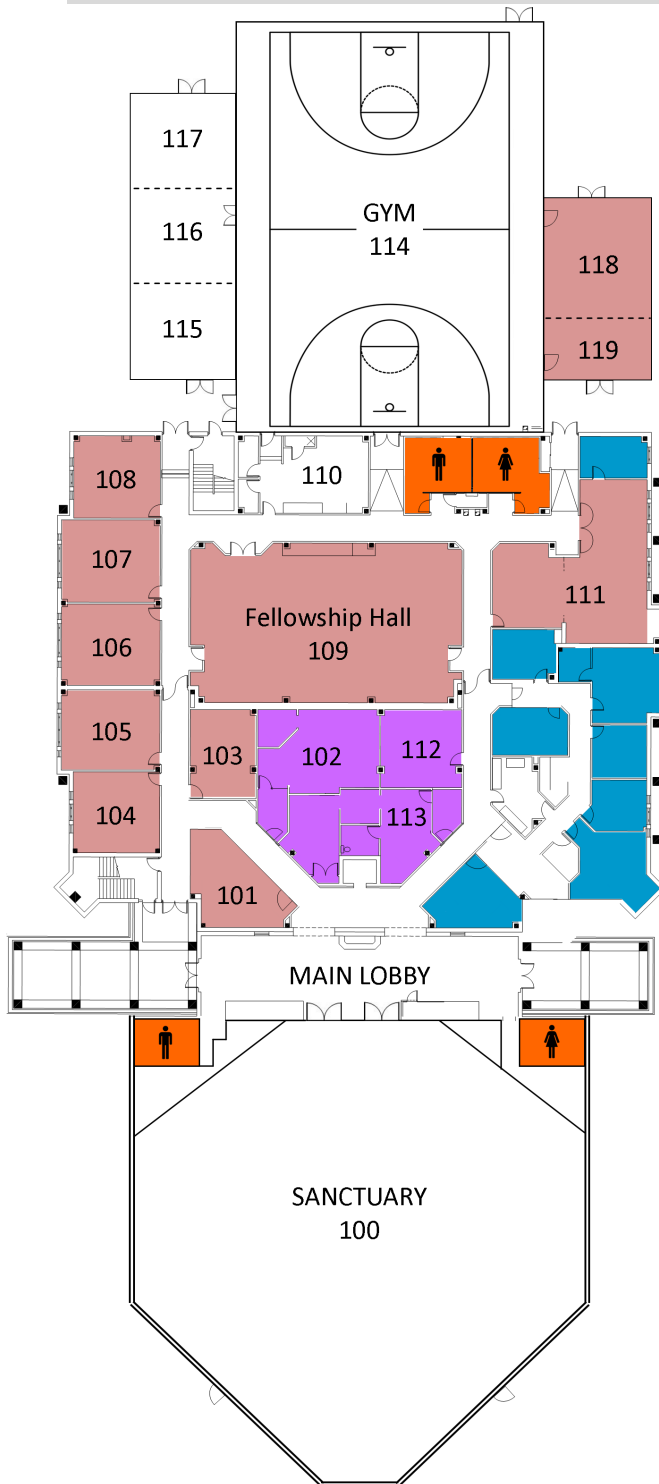

# Second Floor

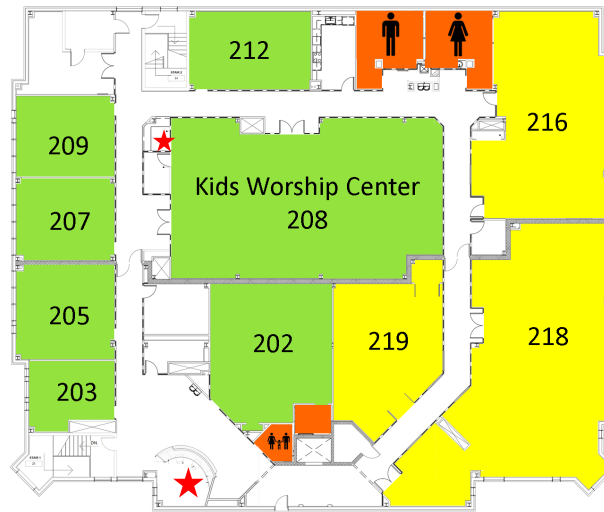

## Sunday Mornings

### 10:00 AM—Bible Studies





Preschool		Adults	
birth-11 mos.	Rm. 102	Young Adults	Rm. 108
12-23 mo.	Rm. 113	(Single Adults 18-28)	
2-3 yrs.	Rm. 112	Young Couples	Rm. 106
		(Couples 20-35)	
Children's Ministry		Couples for Christ	Rm. 111
		(Couples 35-45)	
4yr.-K	Rm. 202	Guardians	Rm. 101
1st-2nd Grade	Rm. 205	(Parents of Teens)	
3rd-4th Grade	Rm. 207	Homebuilders	Rm. 107
5th-6th Grade	Rm. 209	(Couples 45-55)	
Student Ministry		Joy Class	Rm. 104
		(Ladies 29 & up)	
7th-12th Grade	Rm. 218	Discovery	Rm. 109
		Abundant Life	Rm. 118
		Harvesters	Rm. 105
		(Senior Adults 55+)	

### 11:00 AM—Worship Service

Preschool	
birth-11 mos.	Rm. 102
12-23 mo.	Rm. 113
2-3 yrs.	Rm. 112
Children's Ministry	
4yr.-K	Rm. 202
1st-2nd Grade	Rm. 205
3rd-4th Grade	Rm. 207
5th-6th Grade	Rm. 209

## Wednesday Evenings

### 7:00 PM—Worship Service

Preschool		Awana Ministry (Cont.)	
birth-23 mos.	Rm. 102		
Awana Ministry		Kindergarten	Rm. 202
		1st Grade	Rm. 203
		2nd Grade	Rm. 205
			
2-3 Yr. Olds	Rm. 113		
		3rd-4th Gd. Girls	Rm. 207
		3rd-4th Gd. Boys	Rm. 209
4-5 Yr. Olds	Rm. 202	5th-6th Gd.	Rm. 212
Student Ministry (7th-12th Grade)		Rm. 218	
Adult Bible Study		Rm. 109	