

PROGRAMMATIC IMPACT OF EXPANSION PROJECT

First Floor

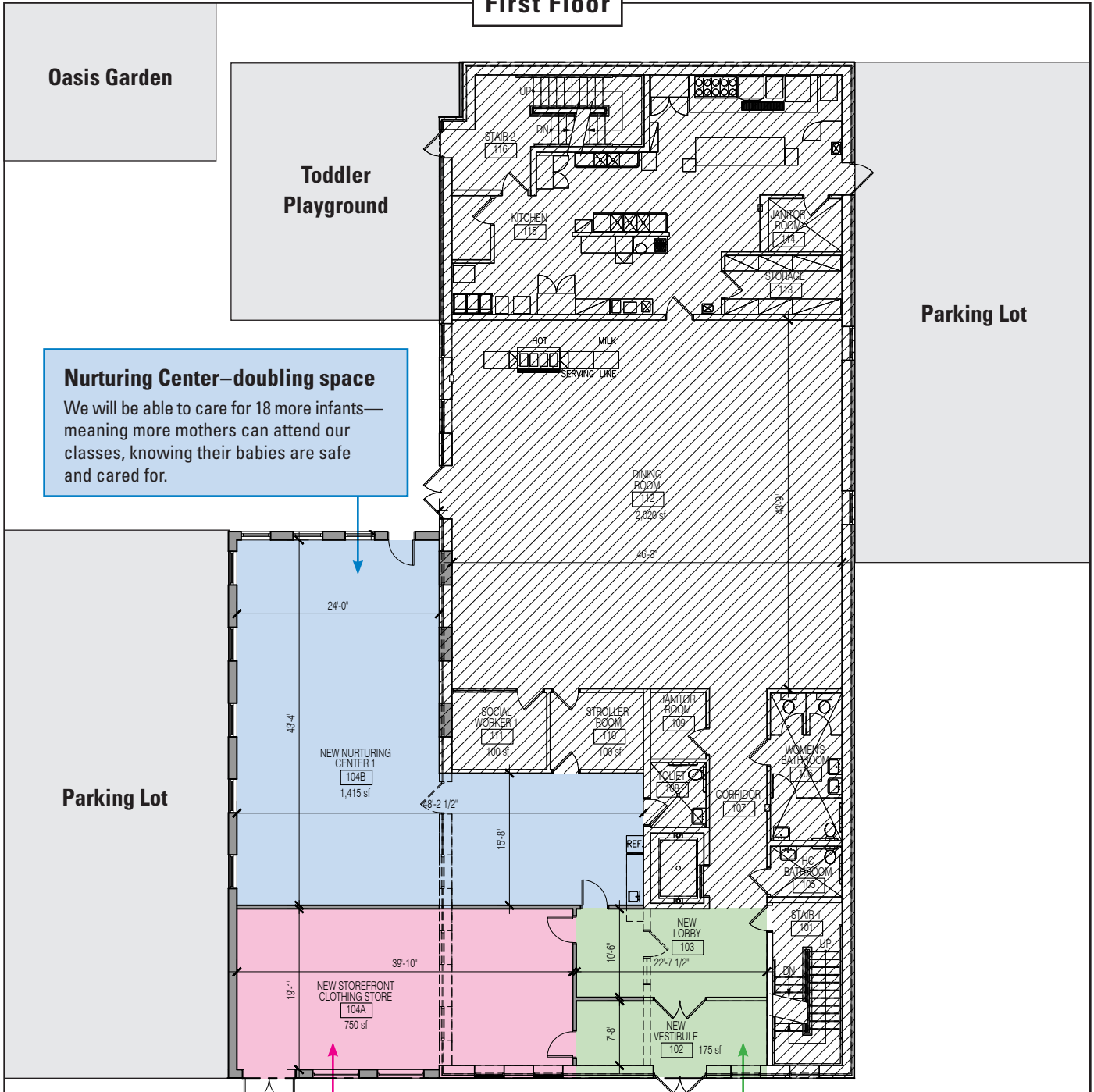

Oasis Garden

Toddler Playground

Parking Lot

Nurturing Center—doubling space
We will be able to care for 18 more infants—meaning more mothers can attend our classes, knowing their babies are safe and cared for.

Parking Lot

Oasis Boutique—new
We'll open a boutique, giving women job-training opportunities in sales and marketing. We'll sell high-end donated clothing and use the profits to fund our job-training programs—making Oasis more sustainable.

Expanded Lobby—expanded by 30%
Women and children will no longer wait outside for services, and with a larger lobby, we can keep emergency donations—food, diapers, coats—handy for immediate distribution.