

Jamé Masjid Markham

2900 Denison Street, Markham, ON L3R4J8
Markham, ON, Canada

Architects	Zak Ghanim Architect Toronto, ON, Canada
Clients	Islamic Society of Markham Markham, ON, Canada
Commission	1998
Design	1999 - 2001
Construction	2001 - 2005
Occupancy	2006
Site	8,260 m²
Ground floor	1,271 m²
Total floor	2,381 m²
Costs	3,770,000 USD

Programme This mosque is significant in uniting a community that was initially divided over its construction. It follows convention with its traditional Islamic features including a symmetrical façade; shaded arcades; and a domed porch, minaret, and prayer hall. The steel and pre-cast concrete construction is faced in cast stone with copper clad domes and internally intricate Islamic detailing is evident. The entrance faces two intersecting streets and all members of the community are welcome to use the gymnasium, school and library. It has become a focal point in Markham, fostering tolerance and understanding and moving the Mayor to declare Eid Al Fitr a formal holiday.

MARKHAM MOSQUE

South View, Entrance porch

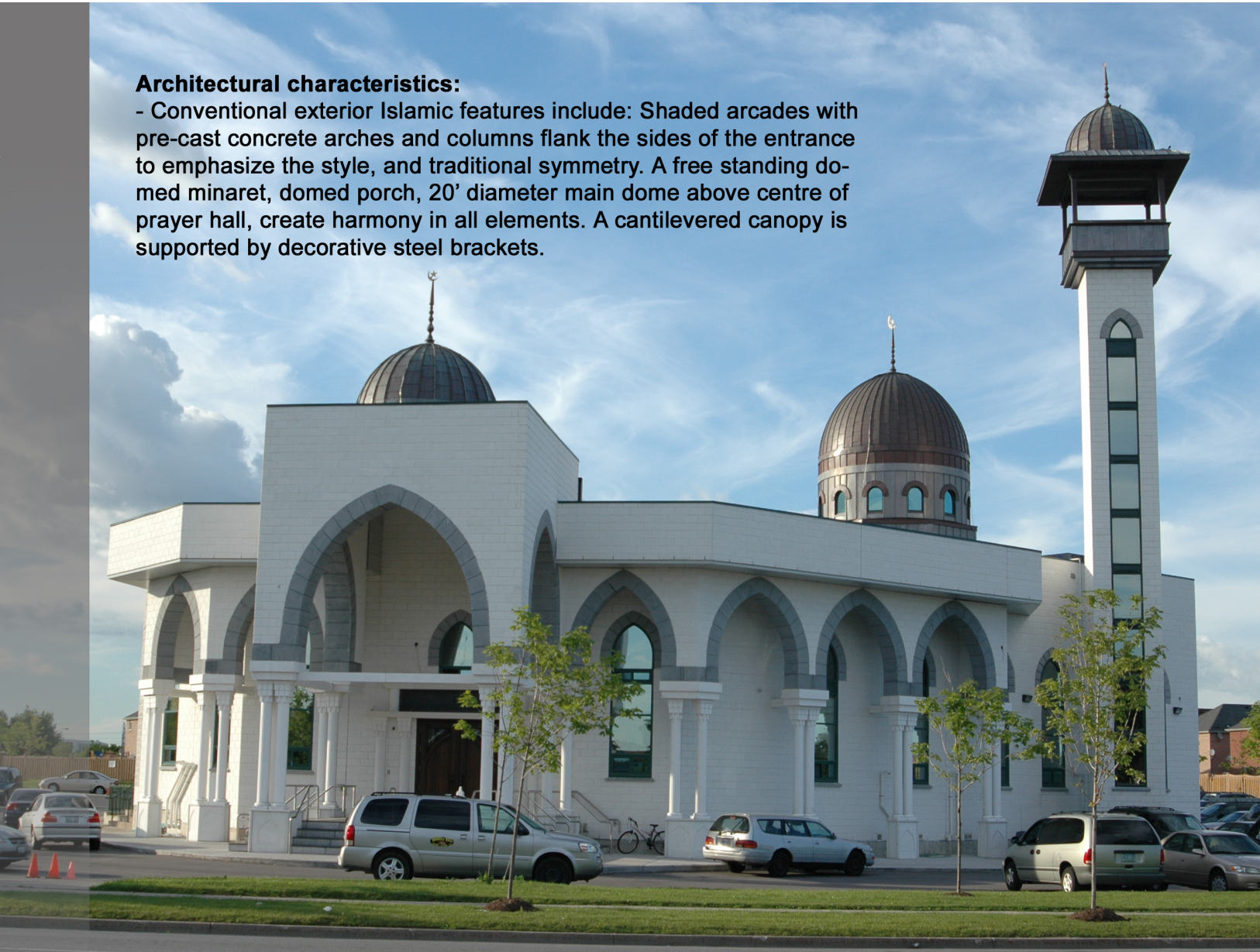

Architectural characteristics:

- Conventional exterior Islamic features include: Shaded arcades with pre-cast concrete arches and columns flank the sides of the entrance to emphasize the style, and traditional symmetry. A free standing domed minaret, domed porch, 20' diameter main dome above centre of prayer hall, create harmony in all elements. A cantilevered canopy is supported by decorative steel brackets.



View of Minaret , South side

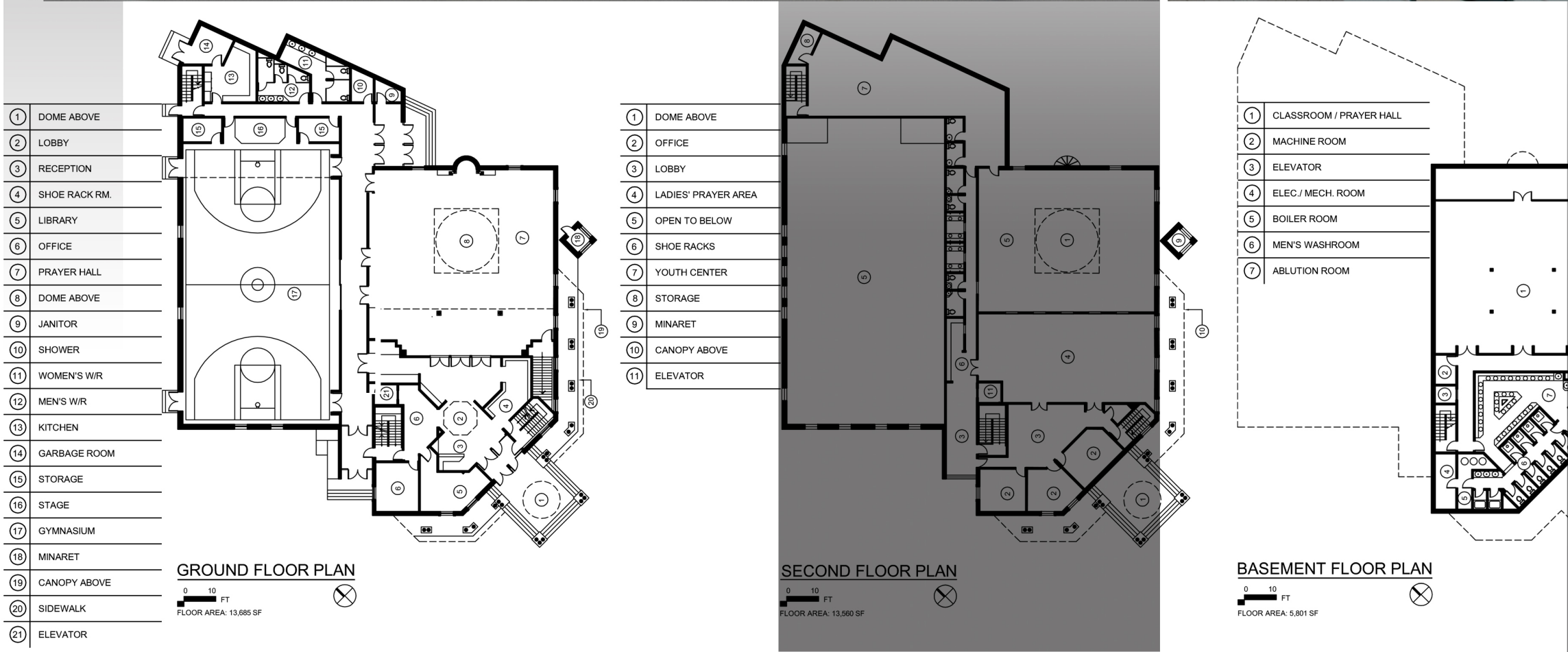



Column's Cap & Arch base



Columns of Entrance porch



Interior view of Dome

Exterior view of dome, main hall.

MARKHAM MOSQUE



Initial design: 1999
Upon application to the building dept in Markham, Ontario, some local Chinese community members opposed to the mosque base upon their Feng Shui beliefs that the orientation of the building will bring bad luck, death and disaster, in addition traffic and parking chaos.

Some neighbours were worried that dead washing room in the mosque may be a health hazard, while others complained that minaret will be an infringement on their privacy and backyards. In addition, some thought the minaret will use loud-speakers and bright lights.



International & Local Media Coverage

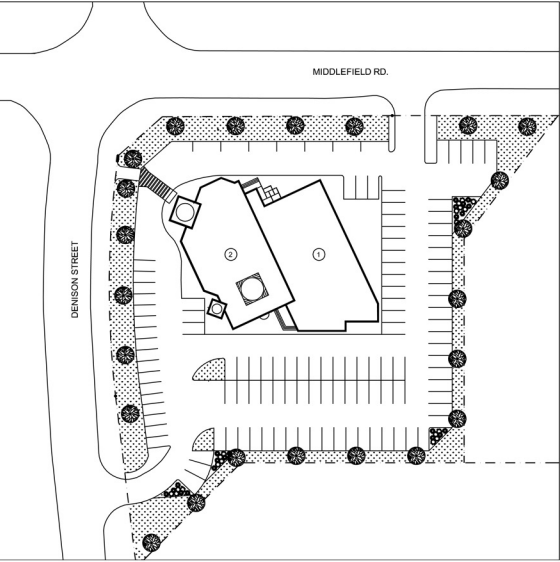

HIS VIEW: Mr. Ho, who would not give his first name, told Markham council last night that some of the Chinese community worry about a mosque in their neighbourhood.

Two cultures clash over plan for mosque

Markham okays building despite objections

By GAIL SWAINSON, YORK REGION BUREAU
Markham council has approved plans for a controversial mosque over the strenuous objections of some local residents who say the building will bring bad luck, death and disaster.
"According to feng shui, those who live behind any place of worship will become poor," Mr. Ho, who refused to give his first name, said last night in an interview.
"Unfortunately, our whole mid-1980s, so for council last prove changes agreement, de from many of mostly Chin neighbours.
Markham co last night to a site plan, those still be some re proposal later.
Construction next month an The 25,581-sq ing will contain ship, a school, tre and fun rooms as well room for those Mayor Don t for understand who opposed it.
"We have to

THE TORONTO STAR Monday, November 8, 1999

Building faith and harmony

Ground broken for first mosque in Markham

By GAIL SWAINSON, YORK REGION BUREAU
Members of Markham's Islamic community gathered yesterday to celebrate a new beginning.
With hundreds of worship-



NEW MOSQUE: Mohammed Khan, left, and his son Omeir, 7, join other members of the Muslim community yesterday in breaking ground for a mosque in Markham.
"Inshallah (God willing), we will be in our house of worship soon," Khalil said in Urdu.
But it hasn't always been so easy. From the beginning, the mosque project became a focus of conflict between Markham's Chinese and Muslim communities.
While many of the mostly Chinese neighbours opposed the Muslim house of worship on purely secular grounds — too much noise, traffic gridlock, not enough parking — One resident who lives in a neighbourhood of about 200 homes directly behind the mosque property said anyone living to the rear of a place of worship will become poor, while those living to either side could be widowed.
Others said the storing of dead bodies on site, which will be done at the mosque, is also considered unfortunate feng shui.
Some residents strenuously objected to an 25-metre minaret, which had actually been scaled back from 34 metres by mosque officials as a goodwill gesture.
because it suffered from bad feng shui.
A 75-name petition opposing the mosque project would attract more signatures than the mosque project would attract.
Feng shui is an ancient Chinese belief that the order of your surroundings can directly affect your life, health, wealth and relationships. Some proponents of feng shui argued the mosque project would attract bad luck, disaster, even death.
One resident who lives in a neighbourhood of about 200 homes directly behind the mosque property said anyone living to the rear of a place of worship will become poor, while those living to either side could be widowed.
Others said the storing of dead bodies on site, which will be done at the mosque, is also considered unfortunate feng shui.
Some residents strenuously objected to an 25-metre minaret, which had actually been scaled back from 34 metres by mosque officials as a goodwill gesture.

Members of the local Chinese community have also used concerns about bad feng shui to argue against the construction of a funeral home on Woodbine Ave.
Some merchants expressed fears the funeral home would drive away business.
Some said it was such a bad omen, they would not even drive by it.
In March 1998, the Ontario Municipal Board rejected applications from Chinese neighbours against building the funeral home on the grounds that such beliefs cannot be taken into account under the Planning Act.
The board also rejected feng shui arguments about funeral home developments in North York and Scarborough.
"The board has consistently stated that considerations which do not relate to land use... should not be a factor in the evaluation of the appropriateness of an application," said a report to Markham council this summer.
Members of both communities are now putting great effort into building bridges of understanding.
Several Chinese neighbours, along with Markham Councillor Tony Wong, attended yesterday's groundbreaking ceremony, and a number of members of the Islamic Society of Markham attended a fundraiser at the Yee Hong Centre for Geriatric Care last week.
"There will always be differences," said Wong, who voted against the mosque in July, but later worked with Usman to bring the communities together. "But we will overcome them."

A public hearing attended by mayor, city council and almost 800 persons. The audience was addressed by different members of the council and the architect.
The council voted 11-2 in favour. After the meeting a great number of the Chinese community were convinced about the merits of the design & compliance with the zoning, building, fire and health bylaws and codes.



Minaret, Under Construction

Interior view of Mihrab