

Restoration of Raees Ali Delvari Museum

Bushehr, Iran	
Architects	Hamed Badri Ahmadi, Mahshid Karami Tehran, Iran
Clients	Organisation of Handicraft & Cultural Heritage & Tourism Tehran, Iran
Commission	2005
Design	2005 - 2006
Construction	2006 - 2008
Occupancy	2008
Site	3,780 m²
Ground floor	700 m²
Total floor	700 m²
Costs	730,000 USD
Programme	This building belonged to a south Iranian World War I hero and, although simple in its architecture, it is important to local people. The preservation project has aimed to respect this simplicity and, as far as possible, the building has been restored to its original form, based on a careful study of regional architecture. The project was hampered by a low budget and a lack of skilled workers and equipment, and channels had to be dug around the walls to control moisture in the soil. The great courtyard has been planted with a palm grove - a familiar regional feature that provides a gathering space for locals and visitors.
Building Type	Restoration & Adaptive Re-Use
2010 Award Cycle	3678.IRA



1



2



3



4

Before renovation

8

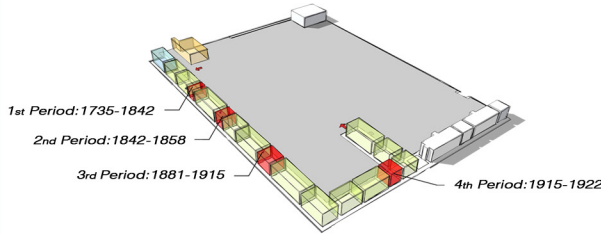

Dividing the museum spaces to 4 historical periods



Visitors path in the museum



5

RESTORATION AND REHABILITATION OF RAEES ALI DELVARI MUSEUM

3678. IRA
Main Sheet

This project is conducted in 6000 population city of Delvar, 35 kilometers far from Boushehr. Boushehr is one of the south provinces of Iran and it is 1200 kilometers far from Tehran. The building belongs to Raees Ali Delvari's (1881-1915) family, heroes of South of Iran's fights in the First World War.



Site Plan



6

The area of the project is 3780 square meters , in which 700 square meters is devoted to covered space and 2480 square meters is for open space. Designing was done in 2 parts: Building restoration and Interior decoration. The major concept of the designing was simplicity and respect to the admirable status of the existing building. It was tried, in all of decision makings, to avoid from creating undesirable and extra message and to establish reciprocal respect between architecture of new elements and building old construction.

9



10



11



12





18 19 20 21

The age of the major built up area of the museum is about 110 years and it is house of one of Iran's south notables and contenders. For this reason in the process of renovation ,designing and executive group ,have tried to be entirely loyal to old shape of the building and corrective finishing touches with the right principals and strategies and turn it to the first existed shape .

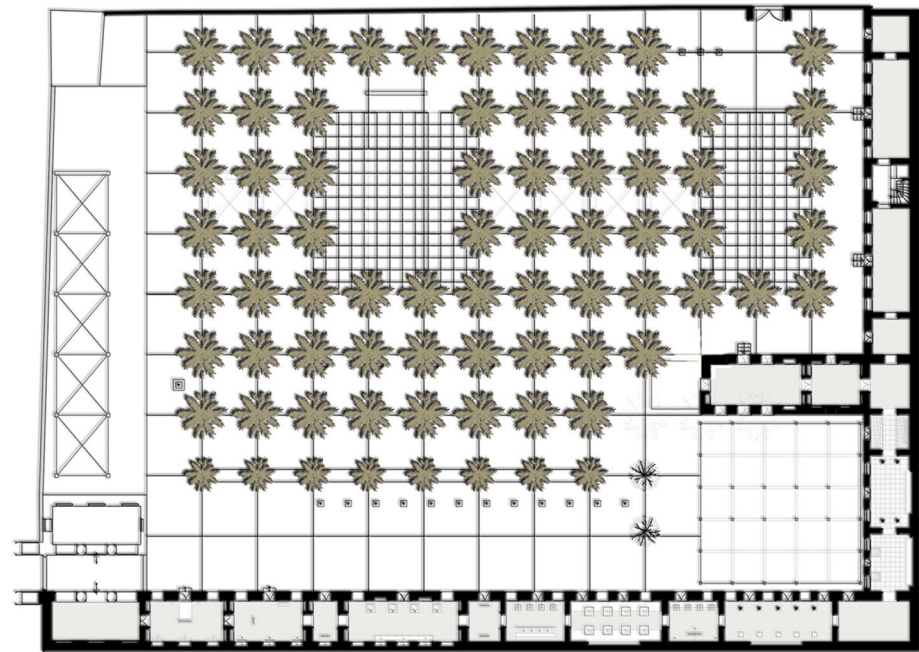

Plan of Museum



Section of museum



25

Type of given data has been defined to the addressees in designing the interior spaces of the museum and a scenario has been specified for them. The designing group tried to use the admirable plainness and originality of the building itself and all the forming items of the museum had been designed in ultimate plainness. Our apprehension was to present a good sight of the object and documents in the museum and not allow beautiful rural shape of the building of the museum being over shadowed of the introduction.



RESTORATION AND REHABILITATION OF RAEES ALI DELVARI MUSEUM

3678. IRA Main Sheet

