

# MHS/PHMS Morning Student Drop Off

Drivers should the campus enter off Indiana St. (for high school) or off of Carlisle St. (for high school or middle school). High school students can be dropped off at the curb near door #1 or door #11 beginning at 7:15a.m. Middle school students must be dropped off at door #11. Regardless of the door used, please drop your student off on the right side of the roadway so that others may pass to the left. Pull forward as much as possible before letting your student exit the vehicle so others can exit at the same time. Please DO NOT drop off students from the left lane, as this creates a dangerous situation for our students.

Parents who drop their students off at door #1 should continue through the MHS south parking lot and follow traffic around the loop and onto Carlisle St.

After dropping your student off at door #11, parents should continue around the "loop" between MHS and PHMS and turn right in front of the school (this is a ONE WAY, west), and depart via the west exit onto Carlisle Street.

Please do not drop off students in other areas as this creates traffic issues for our student drivers and our buses and creates dangerous situations for students walking.

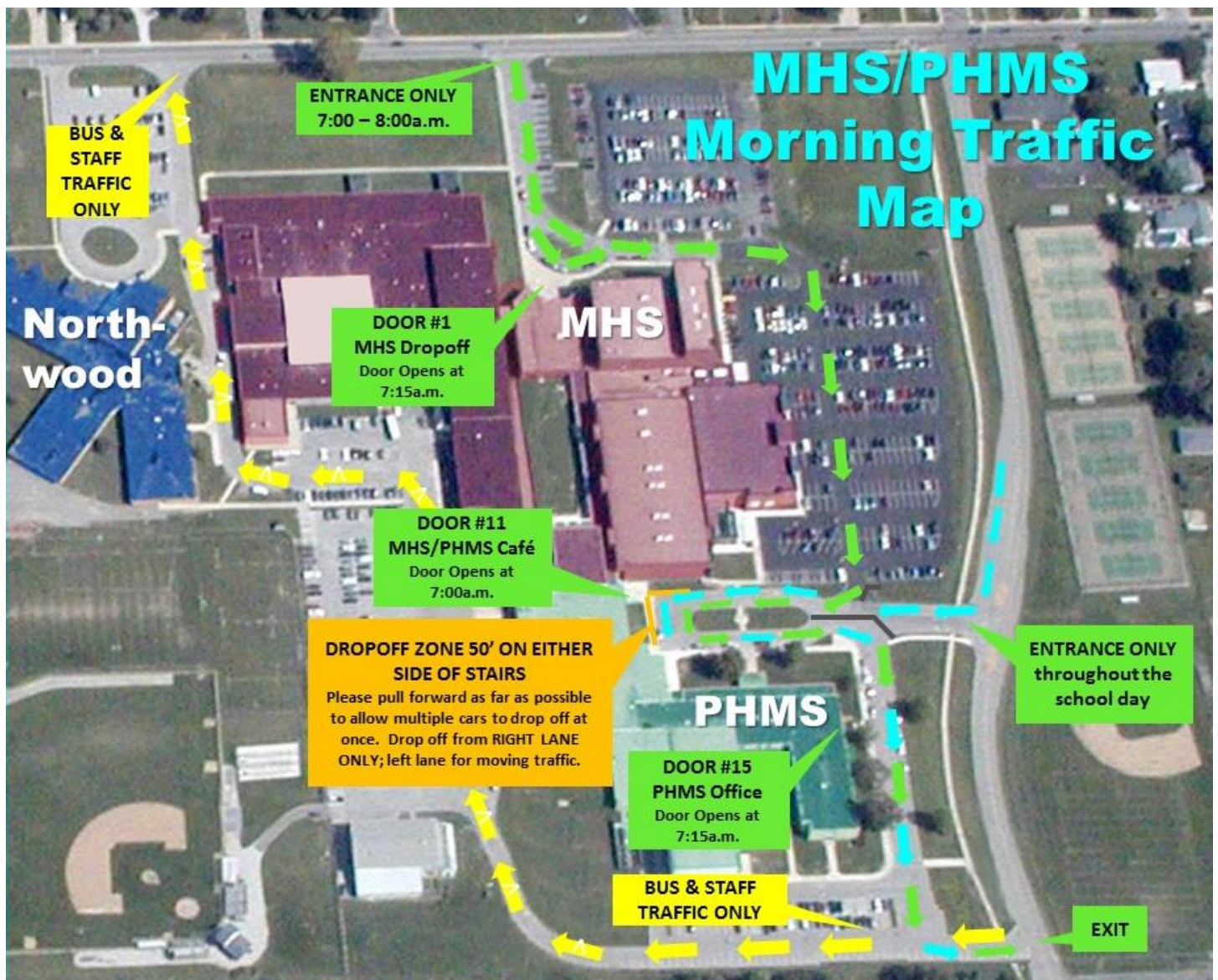

# MHS/PHMS Afternoon Student Pick Up

In the afternoon for pick-up, students may each school exit through multiple doors. The gate from the MHS south lot toward the Carlisle St. driveway is closed, so all MHS student traffic must exit onto Indiana St. For this reason, we ask that anyone coming to pick up students exiting MHS Door #1 have their car in place by 2:25p.m.

If picking up students exiting Door #11 or other PHMS doors, park on the right curb and pull as far forward as possible. Once your student gets in the vehicle, pull to the left and exit in front of PHMS to Carlisle St. If you are waiting, pull as far forward as possible.

*Please do not line up in other areas as this creates traffic issues for our student drivers and our buses and creates dangerous situations for students walking home.*

