

19'-20' HAWK HILL 1, 2, 3 21'-22' RIFT ZONE 27.5 1, 2, 3

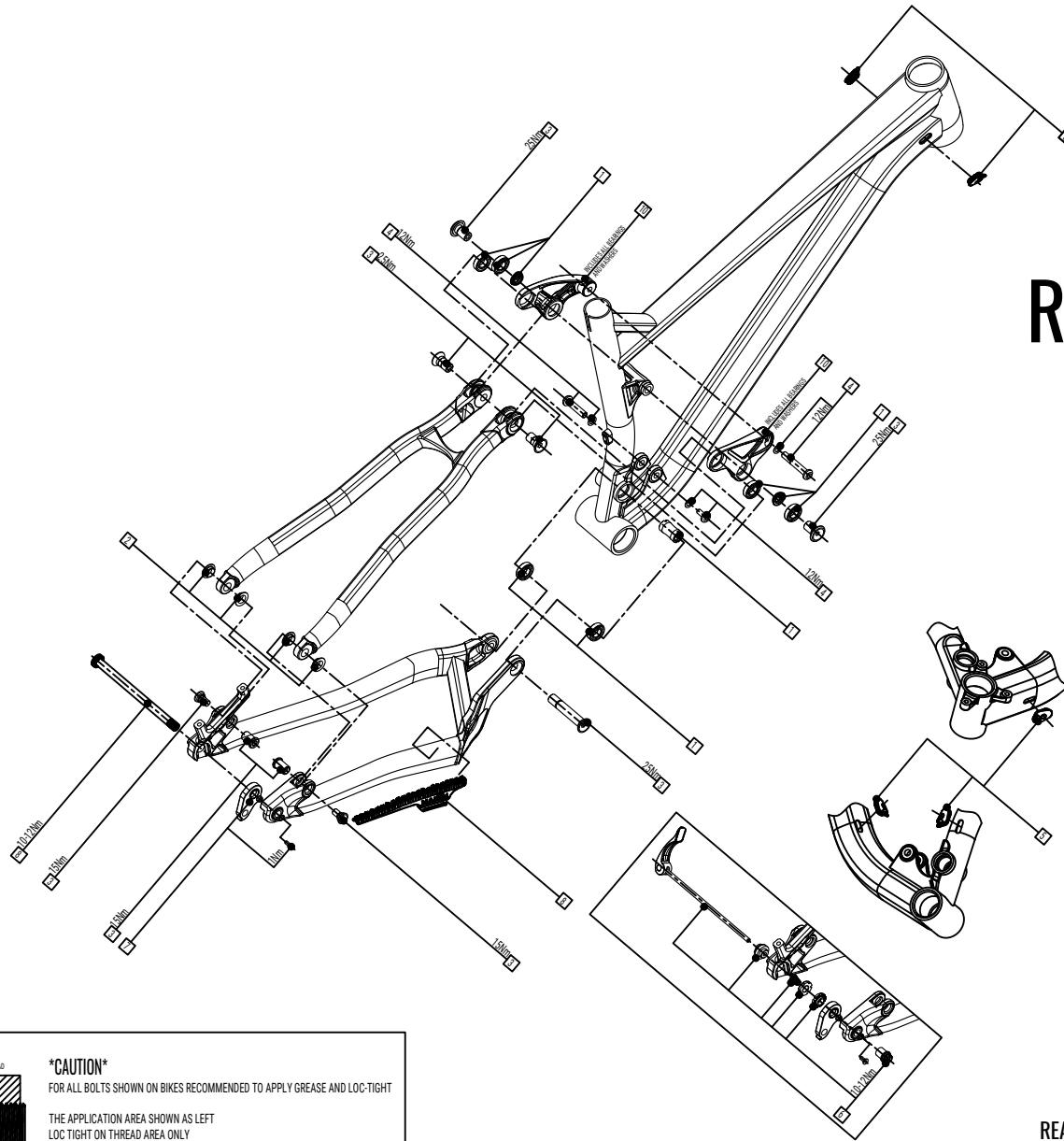

SERVICE PARTS			
NO.	ARTICLE CODE	DESCRIPTION	NOTES
1	726902	BEARING KIT A, RUBBER SEALED BEARING 69010RS 12X24X6, QTY 6	
2	726910	3 SIGDIS PLANE BEARING KIT, QTY 4	
3	727250	PIVOT BOLT KIT D	
4	726917	SHOCK BOLT KIT C	
5	730802	RUBBER GRADUATED KIT ONE PIECE	
6	726924	CLOSED 9 TO 12 QR ASSEMBLY 141MM (148MM)	OE SPEC AXLE: 20' HAWK HILL, 1:21'-22' RIFT ZONE 27.5 1
7	726205	HANGER PAD AND MOUNTING BOLT (MAG. 7010MM SOCKET COUNTERSINK HEAD CAP SCREW)	
8	722772	CS PROTECTOR SERIES 3 ALLOY	DOES NOT COME STOCK BUT IS COMPATIBLE
9	726552	BOLT ON AXLE BIT 148X120MM	
10	726907	ROCKER LINKAGE, MULTITRAC PT	

TECHNICAL DATA		
FORK AXLE TO CROWN	OE SPEC: 530MM	MAX: 530MM
REAR WHEEL TRAVEL	129MM	
TIRE COMPATIBILITY	FRONT: 27.5X2.5"	REAR: 27.5X2.5"
HEADSET DIM	UPPER: 25MM	LOWER: 25.56
SHOCK INFO	EZE: 210MM	STROKE: 50MM
SHOCK HARDWARE	UPPER: 25X60	LOWER: 25X60
SEATPOST DIAMETER	33.9MM	
SEAT COLLAR DIAMETER	34.9MM	
CHAINLINE	52.55MM	
REAR BRAKE MOUNT	POST MOUNT 160MM MAX 100MM	
REAR AXLE	148X120MM	
BEARING SPEC	69010RS IGUS P/N: JPM1214-65	QTY: 6 QTY: 4

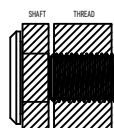

CAUTION
FOR ALL BOLTS SHOWN ON BIKES RECOMMENDED TO APPLY GREASE AND LOC-TIGHT

THE APPLICATION AREA SHOWN AS LEFT
LOC-TIGHT ON THREAD AREA ONLY
GREASE ON SHAFT AREA ONLY
FOR THOSE BOLTS WITHOUT SHAFT, LOC-TIGHT NEEDED ONLY.

S: 168MM M: 178MM L: 204MM XL: 209MM

REAM DEPTH

MARIN
BIKES CALIFORNIA