

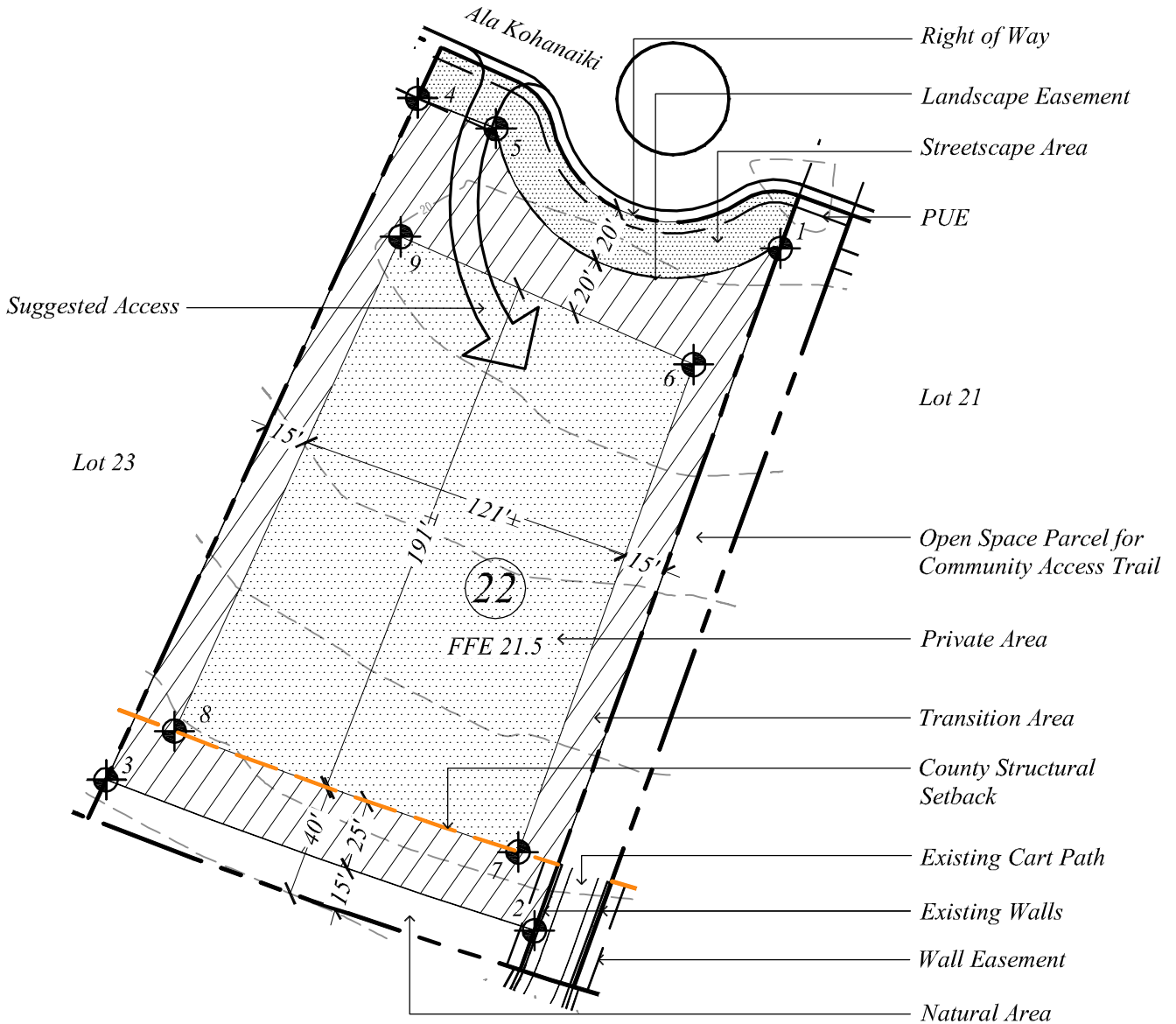

DRAFT





KOHANAIKI Lot 22 Kahakai Lot

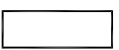
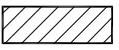
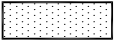

LEGEND

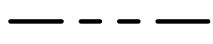
-  Natural Area
-  Transition Area
-  Private Area
-  Streetscape Area

-  Lot Boundary
-  Building Envelope Boundary
-  Stake Location and Number

Lot Area: 0.99 AC±
 Private Area: 23,158 SF±
 Building Envelope Area: 37,619 SF±
 Building Height Max. Elevation: 40.5' (42.5')
 R.O. Water Allocation: 2,600 GPD MAX

November 25, 2013
March 29, 2013

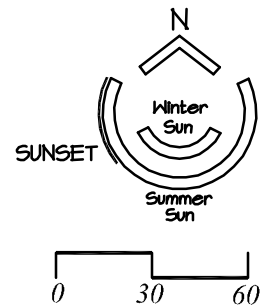

The locations of the Private Area, Natural Area, Transition Area, Streetscape Area, Easements, Structural Setback and other physical structures and height of the Finish Floor elevation depicted on this diagram are approximations. Purchasers are advised to verify the same prior to commencing construction. Please see reverse side for additional information. All elevations are from sea level which is elevation 0'.

All linear or square footages for Transition Zone and Building Envelope within homesite boundary lines are estimates only. This material is presented as being representational, only, of the Building Envelope and is not intended as a substitute for onsite inspection and independent determination by owner of the attributes of the homesite, which are suitable for satisfying owner's intended purposes.

The Private, Transition and Natural Area boundaries, dimensions, areas, irrigation quantities, lot lines, topography and features and/or information shown on this diagram are approximate and for information only. These diagrams are not a substitute for a lot survey, and no representation regarding the accuracy or completeness of the information shown on the diagram is made

The utility easements shown on this plan are preliminary and have not been finalized by the Project's civil engineer. The actual locations of the utilities may vary in the field, and accordingly, the utility easements depicted on this plan may require adjustments and/or additional utility easement(s) may need to be designated prior to or after closing.

The irrigation quantities indicated on these lot diagrams have been calculated by the developer.