



FOR LEASE: ±25,084 SF TOTAL

**2475 Polvorosa Drive**  
San Leandro, CA



### Property Features

- ±25,084 SF Total
- ±1,675 SF Office
- ±1.32 Acre Lot
- Parcel #: 079A-0541-030
- 2 Dock High Doors
- 4 Drive-In Doors
- ±16' Clear Height
- 8 Minute Drive to Oakland International Airport

**Available October 1, 2020**

**FOR LEASE: Call Broker For Pricing**



**John McManus, MCR, CCIM**

Executive Director

+1 510 414 2949

john.mcmanus@cushwake.com

LIC #01129064

**Jeff Powers**

Associate

+1 510 891 5821

jeff.powers@cushwake.com

LIC #02021074



**LBA Logistics**

555 12th Street, Suite 1400

Oakland, CA 94607

main +1 510 465 8000

fax +1 510 465 1350

**cushmanwakefield.com**

©2020 Cushman & Wakefield. All rights reserved. The information contained in this communication is strictly confidential. This information has been obtained from sources believed to be reliable but has not been verified. NO WARRANTY OR REPRESENTATION, EXPRESS OR IMPLIED, IS MADE AS TO THE CONDITION OF THE PROPERTY (OR PROPERTIES) REFERENCED HEREIN OR AS TO THE ACCURACY OR COMPLETENESS OF THE INFORMATION CONTAINED HEREIN, AND SAME IS SUBMITTED SUBJECT TO ERRORS, OMISSIONS, CHANGE OF PRICE, RENTAL OR OTHER CONDITIONS, WITHDRAWAL WITHOUT NOTICE, AND TO ANY SPECIAL LISTING CONDITIONS IMPOSED BY THE PROPERTY OWNER(S). ANY PROJECTIONS, OPINIONS OR ESTIMATES ARE SUBJECT TO UNCERTAINTY AND DO NOT SIGNIFY CURRENT OR FUTURE PROPERTY PERFORMANCE.



**CUSHMAN &  
WAKEFIELD**

FOR LEASE: ±25,084 SF TOTAL

**2475 Polvorosa Drive**  
San Leandro, CA

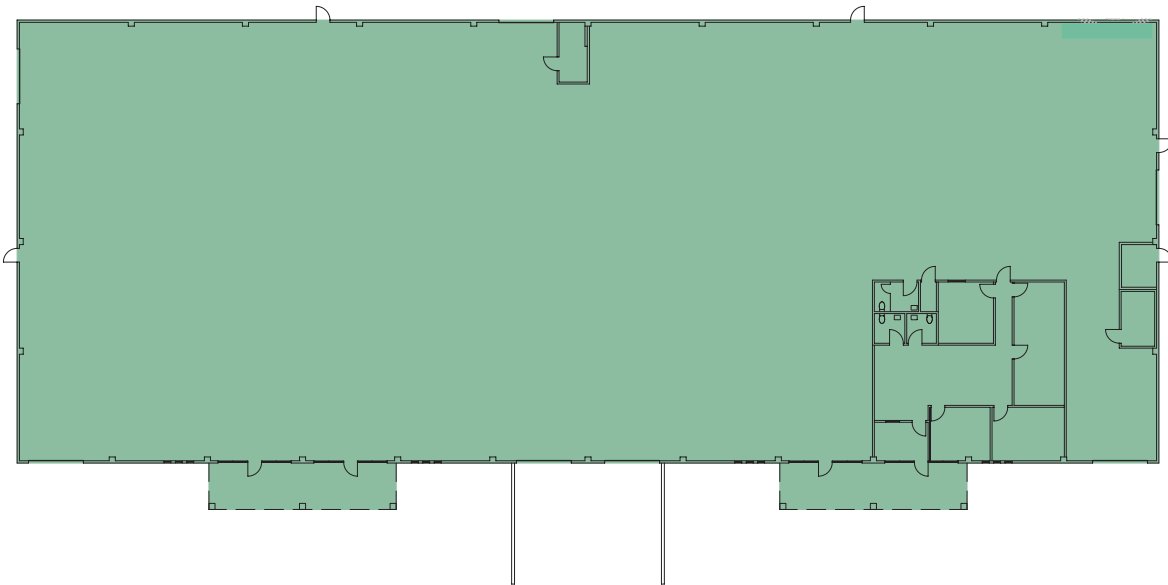

**John McManus, MCR, CCIM**

Executive Director

+1 510 414 2949

john.mcmanus@cushwake.com

LIC #01129064

**Jeff Powers**

Associate

+1 510 891 5821

jeff.powers@cushwake.com

LIC #02021074



**LBA**Logistics

555 12th Street, Suite 1400

Oakland, CA 94607

main +1 510 465 8000

fax +1 510 465 1350

**cushmanwakefield.com**

©2020 Cushman & Wakefield. All rights reserved. The information contained in this communication is strictly confidential. This information has been obtained from sources believed to be reliable but has not been verified. NO WARRANTY OR REPRESENTATION, EXPRESS OR IMPLIED, IS MADE AS TO THE CONDITION OF THE PROPERTY (OR PROPERTIES) REFERENCED HEREIN OR AS TO THE ACCURACY OR COMPLETENESS OF THE INFORMATION CONTAINED HEREIN, AND SAME IS SUBMITTED SUBJECT TO ERRORS, OMISSIONS, CHANGE OF PRICE, RENTAL OR OTHER CONDITIONS, WITHDRAWAL WITHOUT NOTICE, AND TO ANY SPECIAL LISTING CONDITIONS IMPOSED BY THE PROPERTY OWNER(S). ANY PROJECTIONS, OPINIONS OR ESTIMATES ARE SUBJECT TO UNCERTAINTY AND DO NOT SIGNIFY CURRENT OR FUTURE PROPERTY PERFORMANCE.



FOR LEASE: ±181,720 SF TOTAL

## 2451 Polvorosa Drive San Leandro, CA



### Property Features

- ±181,720 SF Total
- ±14,362 SF Office
- ±8.01 Acre Lot
- Parcel #: 079A-0541-033-02
- 4 Office Areas
- 6 Potential Storefronts
- 36 Dock High Doors
- 2 Drive-In Doors
- 11 Rail Doors
- ±24' Clear Height
- 8 Minute Drive to Oakland International Airport

**Available October 1, 2020**

**FOR LEASE: Call Broker for Pricing**



#### John McManus, MCR, CCIM

Executive Director

+1 510 414 2949

john.mcmanus@cushwake.com

LIC #01129064

#### Jeff Powers

Associate

+1 510 891 5821

jeff.powers@cushwake.com

LIC #02021074



**LBA Logistics**

555 12th Street, Suite 1400

Oakland, CA 94607

main +1 510 465 8000

fax +1 510 465 1350

**cushmanwakefield.com**

©2020 Cushman & Wakefield. All rights reserved. The information contained in this communication is strictly confidential. This information has been obtained from sources believed to be reliable but has not been verified. NO WARRANTY OR REPRESENTATION, EXPRESS OR IMPLIED, IS MADE AS TO THE CONDITION OF THE PROPERTY (OR PROPERTIES) REFERENCED HEREIN OR AS TO THE ACCURACY OR COMPLETENESS OF THE INFORMATION CONTAINED HEREIN, AND SAME IS SUBMITTED SUBJECT TO ERRORS, OMISSIONS, CHANGE OF PRICE, RENTAL OR OTHER CONDITIONS, WITHDRAWAL WITHOUT NOTICE, AND TO ANY SPECIAL LISTING CONDITIONS IMPOSED BY THE PROPERTY OWNER(S). ANY PROJECTIONS, OPINIONS OR ESTIMATES ARE SUBJECT TO UNCERTAINTY AND DO NOT SIGNIFY CURRENT OR FUTURE PROPERTY PERFORMANCE.





**CUSHMAN &  
WAKEFIELD**

FOR LEASE: ±181,720 SF TOTAL

**2451 Polvorosa Drive**  
San Leandro, CA



**John McManus, MCR, CCIM**

Executive Director

+1 510 414 2949

[john.mcmanus@cushwake.com](mailto:john.mcmanus@cushwake.com)

LIC #01129064

**Jeff Powers**

Associate

+1 510 891 5821

[jeff.powers@cushwake.com](mailto:jeff.powers@cushwake.com)

LIC #02021074



**LBA**Logistics

555 12th Street, Suite 1400

Oakland, CA 94607

main +1 510 465 8000

fax +1 510 465 1350

[cushmanwakefield.com](http://cushmanwakefield.com)

©2020 Cushman & Wakefield. All rights reserved. The information contained in this communication is strictly confidential. This information has been obtained from sources believed to be reliable but has not been verified. NO WARRANTY OR REPRESENTATION, EXPRESS OR IMPLIED, IS MADE AS TO THE CONDITION OF THE PROPERTY (OR PROPERTIES) REFERENCED HEREIN OR AS TO THE ACCURACY OR COMPLETENESS OF THE INFORMATION CONTAINED HEREIN, AND SAME IS SUBMITTED SUBJECT TO ERRORS, OMISSIONS, CHANGE OF PRICE, RENTAL OR OTHER CONDITIONS, WITHDRAWAL WITHOUT NOTICE, AND TO ANY SPECIAL LISTING CONDITIONS IMPOSED BY THE PROPERTY OWNER(S). ANY PROJECTIONS, OPINIONS OR ESTIMATES ARE SUBJECT TO UNCERTAINTY AND DO NOT SIGNIFY CURRENT OR FUTURE PROPERTY PERFORMANCE.



**CUSHMAN &  
WAKEFIELD**

FOR LEASE: ±181,720 SF TOTAL

**2451 Polvorosa Drive**  
San Leandro, CA



**John McManus, MCR, CCIM**

Executive Director

+1 510 414 2949

[john.mcmanus@cushwake.com](mailto:john.mcmanus@cushwake.com)

LIC #01129064

**Jeff Powers**

Associate

+1 510 891 5821

[jeff.powers@cushwake.com](mailto:jeff.powers@cushwake.com)

LIC #02021074



**LBA**Logistics

555 12th Street, Suite 1400

Oakland, CA 94607

main +1 510 465 8000

fax +1 510 465 1350

**[cushmanwakefield.com](http://cushmanwakefield.com)**

©2020 Cushman & Wakefield. All rights reserved. The information contained in this communication is strictly confidential. This information has been obtained from sources believed to be reliable but has not been verified. NO WARRANTY OR REPRESENTATION, EXPRESS OR IMPLIED, IS MADE AS TO THE CONDITION OF THE PROPERTY (OR PROPERTIES) REFERENCED HEREIN OR AS TO THE ACCURACY OR COMPLETENESS OF THE INFORMATION CONTAINED HEREIN, AND SAME IS SUBMITTED SUBJECT TO ERRORS, OMISSIONS, CHANGE OF PRICE, RENTAL OR OTHER CONDITIONS, WITHDRAWAL WITHOUT NOTICE, AND TO ANY SPECIAL LISTING CONDITIONS IMPOSED BY THE PROPERTY OWNER(S). ANY PROJECTIONS, OPINIONS OR ESTIMATES ARE SUBJECT TO UNCERTAINTY AND DO NOT SIGNIFY CURRENT OR FUTURE PROPERTY PERFORMANCE.