

±92,259 SF FOR LEASE



9281 PITTSBURGH, RANCHO CUCAMONGA, CALIFORNIA 91730

BUILDING FEATURES

| | |
|----------------------|--|
| Building Size: | ±92,259 SF (Divisible) |
| Office Size: | ±4,768 SF |
| Dock Doors: | 8 (8' x 10') with Pit Levelers on Each Door |
| Rail Doors: | 6 (10' x 10') Active Doors |
| Min Clear Height: | 24' |
| Column Spacing: | 48' x 48' |
| Sprinkler System: | .45/3,000 GPM |
| Location: | Close to the I-15, I-210 and I-10 Freeways |
| Corporate Neighbors: | Polyone Corp., Sun Deliveries and Ultimate Logistics |

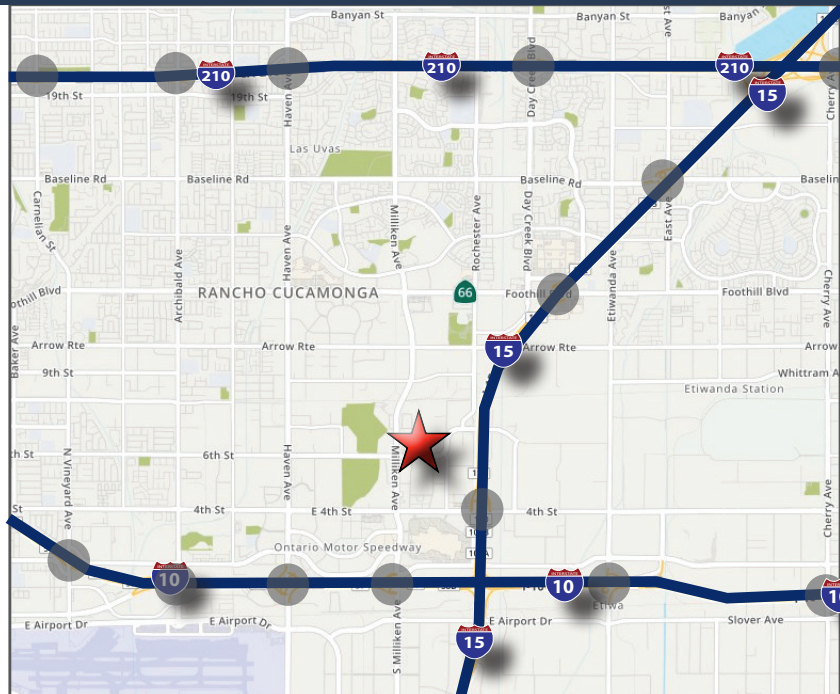

MARK ZORN, SIOR
License No. 01303982
DIR 1+ 909 937 6318
mark.zorn@colliers.com

CORY WHITMAN
License No. 01876150
DIR 1+ 909 937 6363
cory.whitman@colliers.com

COLLIERS INTERNATIONAL
2855 E. Guasti Road, Suite 401
Ontario, CA 91761-7645
www.colliers.com



FOR LEASE >

±92,259 SF INDUSTRIAL BUILDING

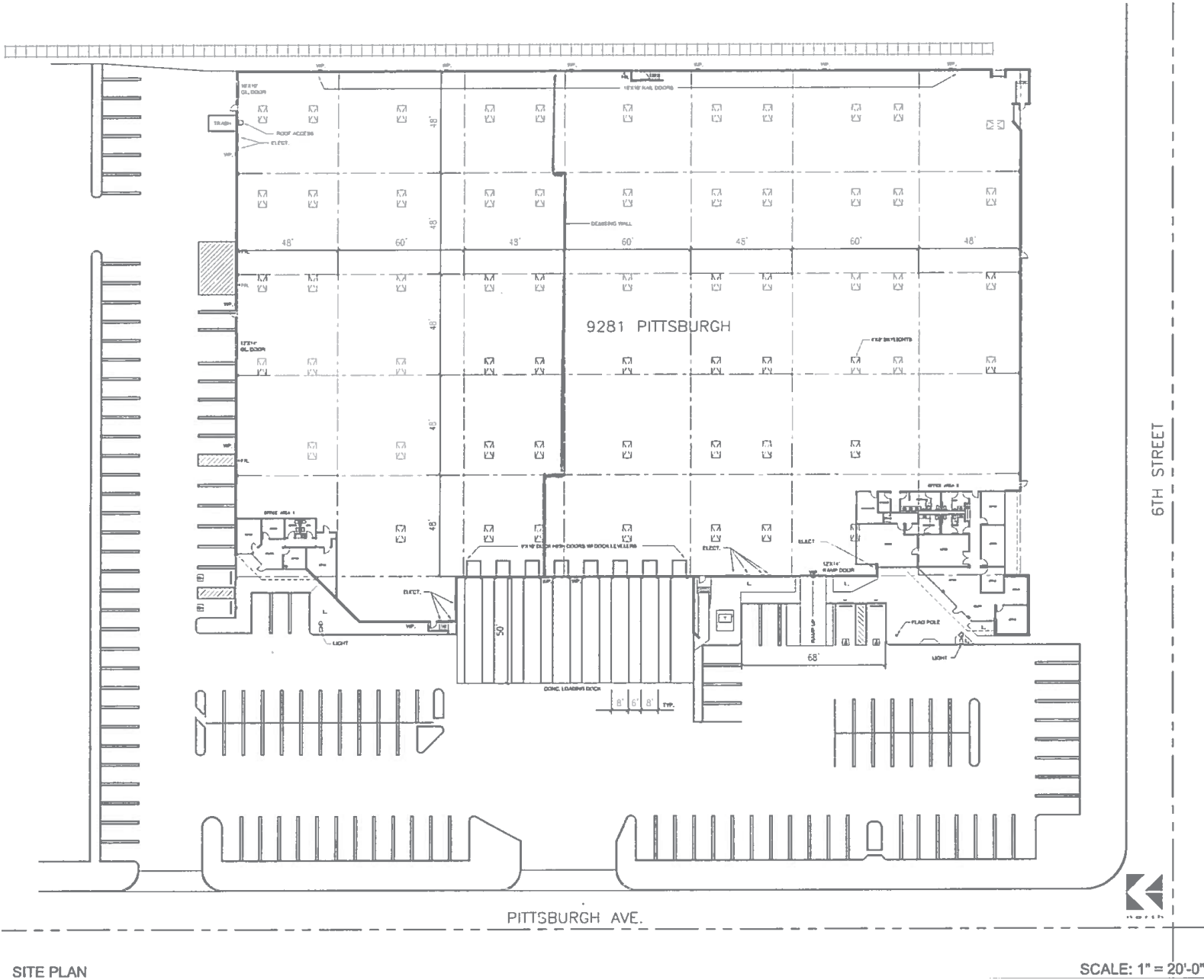

MARK ZORN, SIOR
License No. 01303982
DIR 1+ 909 937 6318
mark.zorn@colliers.com

CORY WHITMAN
License No. 01876150
DIR 1+ 909 937 6363
cory.whitman@colliers.com

COLLIERS INTERNATIONAL
2855 E. Guasti Road, Suite 401
Ontario, CA 91761-7645
www.colliers.com

