

AVAILABLE FOR LEASE - 58,358 SF

6363 W. 73RD STREET BEDFORD PARK, IL



OUTDOOR STORAGE AND YARD FOR TRAILER PARKING

PROPERTY SPECIFICATIONS:

BUILDING SIZE:	58,358 SF
OFFICE:	9,124 SF
SITE SIZE:	4.91 acres
CLEAR HEIGHT:	20'-23'
LOADING:	6 exterior docks 4 drive-in doors
PARKING:	50 cars 35 trailers
ZONING:	F (Motor Freight Terminal - mechanical and body repair allowed)
POWER:	1,600 amps (subject to verification)
LEASE RATE:	Subject to Offer
COMMENTS:	Hard to find outdoor storage Convenient access to expressways, intermodal yards and airports



AVAILABLE FOR LEASE - 58,358 SF

6363 W. 73RD STREET
BEDFORD PARK, IL

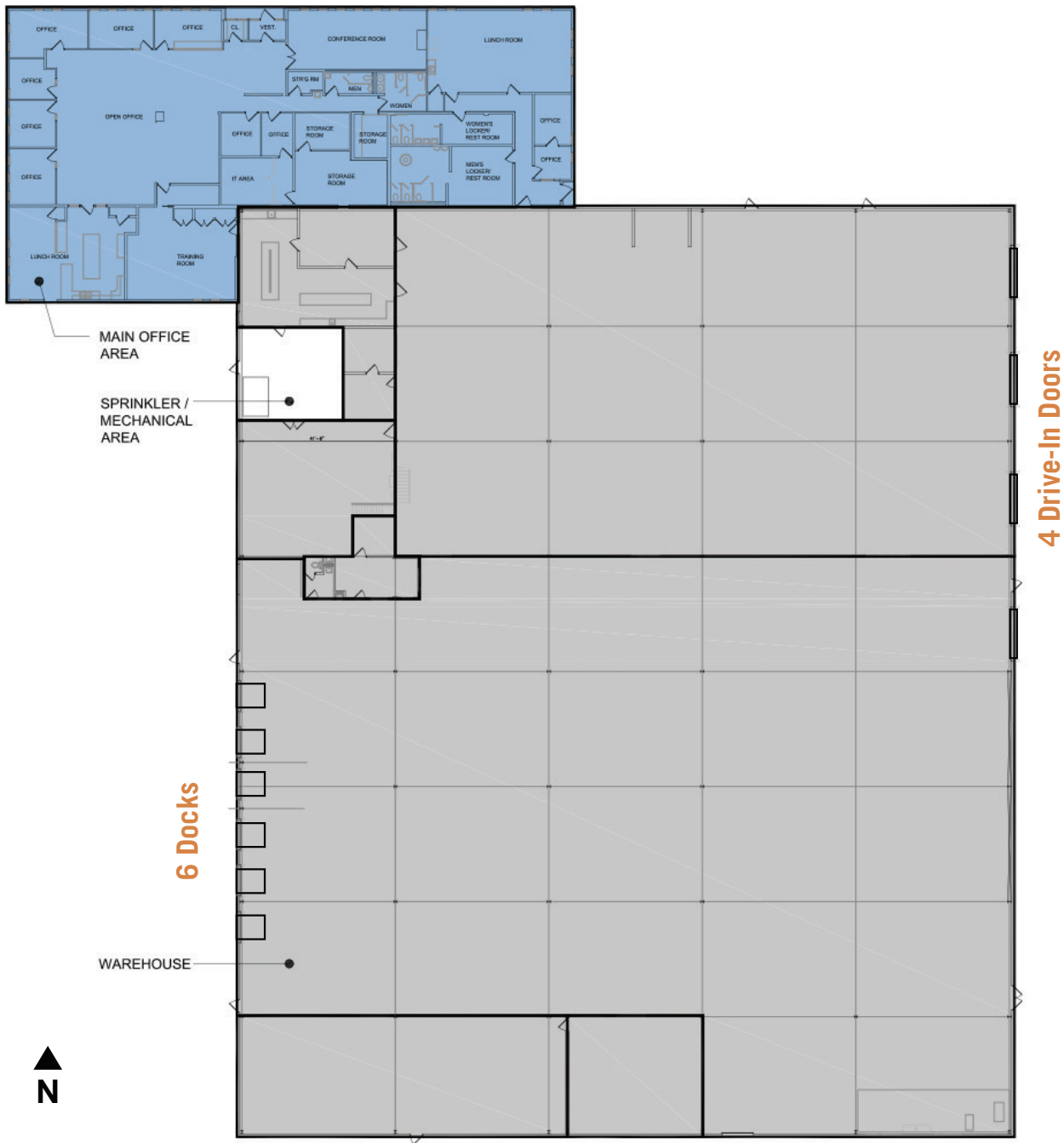

AVAILABLE FOR LEASE - 58,358 SF

6363 W. 73RD STREET BEDFORD PARK, IL

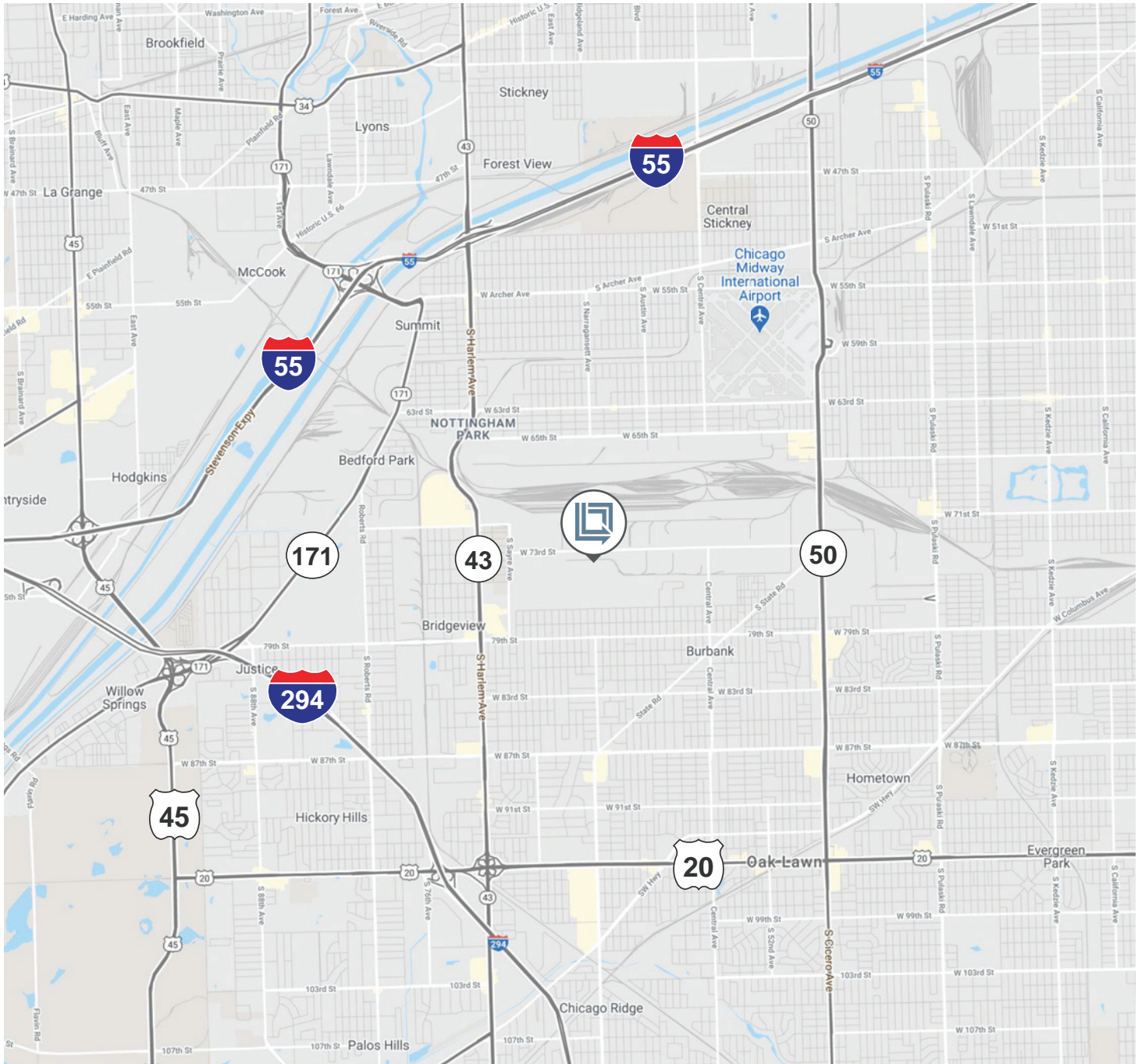

For more information contact:

Tim McCahill
Principal
tmccahill@lee-associates.com
D 773.355.3044

Brian Vanosky
Principal
bvanosky@lee-associates.com
D 773.355.3023

Joe Feeney
Senior Associate
jfeeney@lee-associates.com
D 773.355.3039

Dylan Maher
Associate
dmaher@lee-associates.com
D 773.355.3033