

403 NORTH LEVEE ROAD

PUYALLUP, WASHINGTON 98371

 FOR LEASE



CBRE

LBALogistics 



**CLICK FOR
VIRTUAL TOUR**



PROPERTY FEATURES



80,150 SF
STAND ALONE BUILDING



5,169 SF SINGLE
STORY OFFICE SPACE



5.44 ACRE SITE



SPACE CAN
BE DEMISED



FULLY
INSULATED



8 DOCK HIGH DOORS &
3 GRADE LEVEL DOORS



2 MECHANICAL PIT
LEVELERS &
6 EDGE OF DOCKS



PARTIALLY FENCED
AND SECURED TRUCK
COURTS WITH
CONCRETE
TRUCK APRONS



79 PARKING
STALLS



11 TRUCK &
10 SEMI TRAILER
PARKING STALLS



EASY ACCESS
TO HWY 167

SITE PLAN

80,150 SF

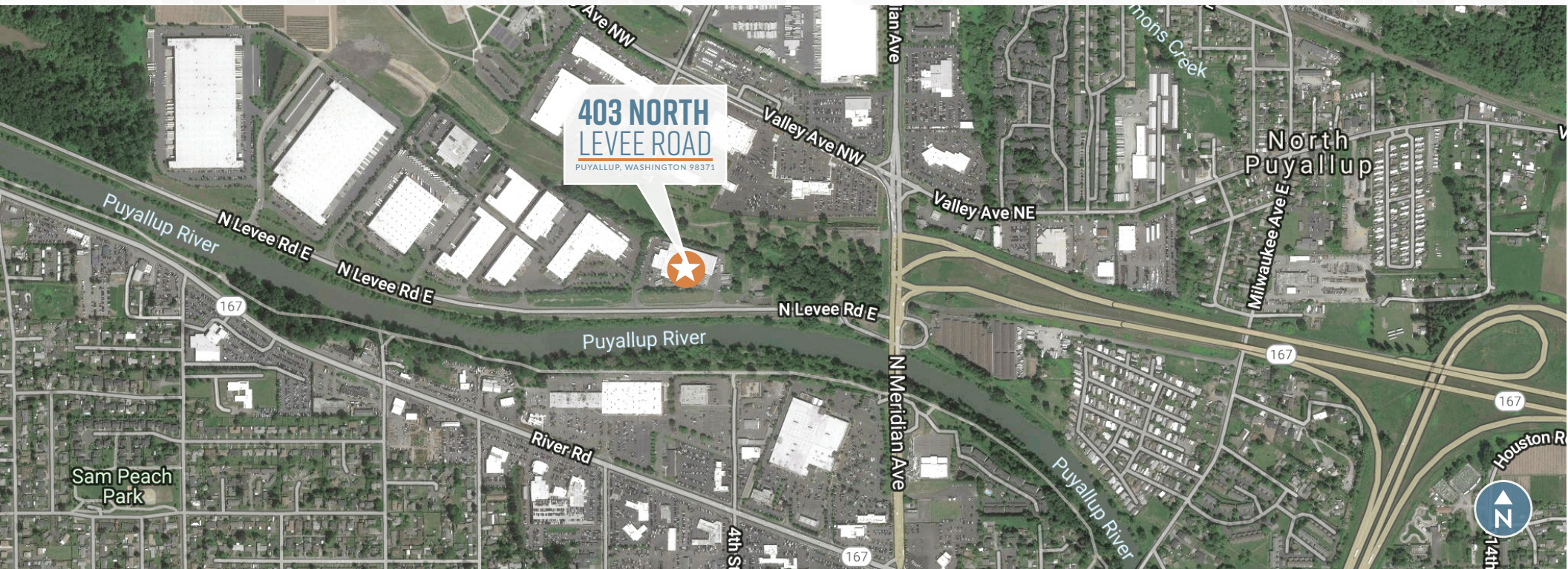
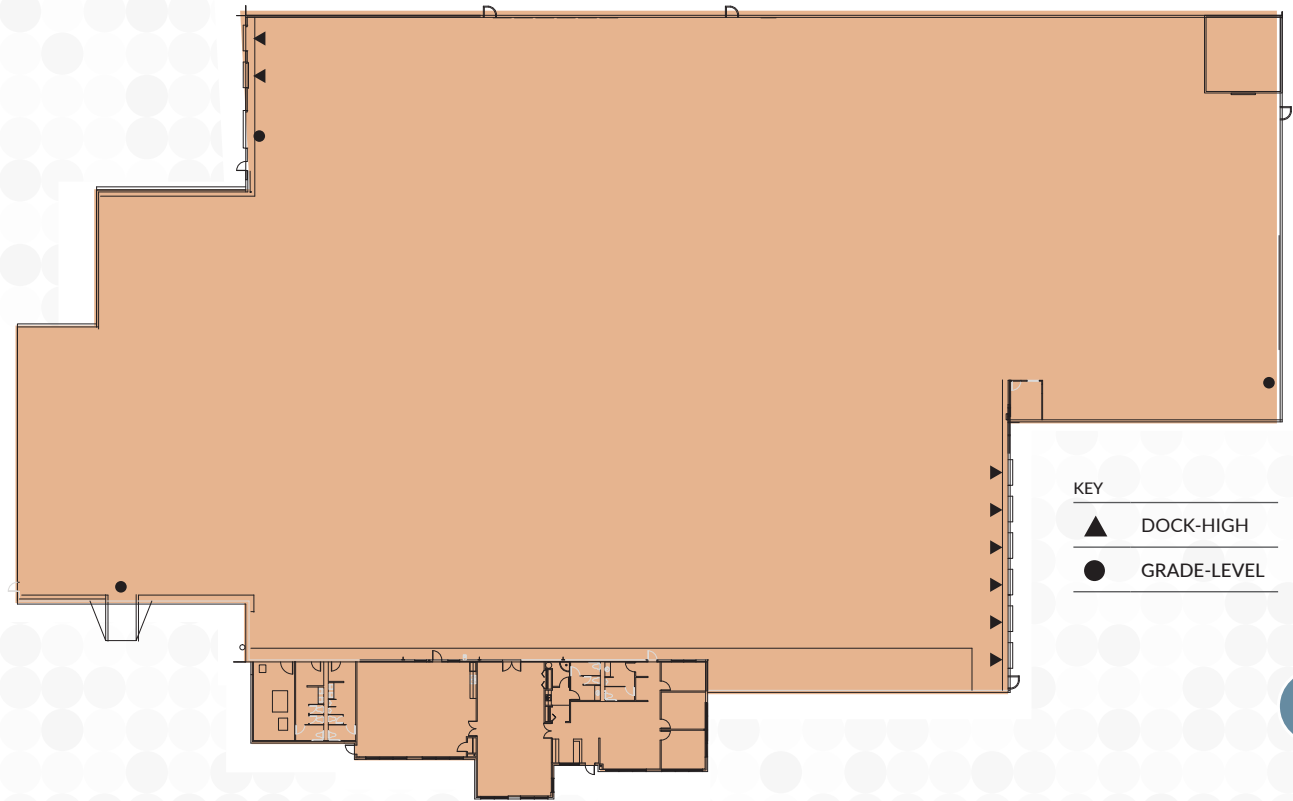

FOR INFORMATION, CONTACT

ANDREW STARK

Senior Vice President

+1 206 442 2746

andrew.stark@cbre.com

CHRIS COWLES

Vice President

+1 253 596 0048

chris.cowles@cbre.com

CBRE, INC. | 1420 Fifth Ave | Suite 1700 | Seattle, WA 98101

© 2021 CBRE, Inc. All rights reserved. This information has been obtained from sources believed reliable, but has not been verified for accuracy or completeness. You should conduct a careful, independent investigation of the property and verify all information. Any reliance on this information is solely at your own risk. CBRE and the CBRE logo are service marks of CBRE, Inc. All other marks displayed on this document are the property of their respective owners, and the use of such logos does not imply any affiliation with or endorsement of CBRE. Photos herein are the property of their respective owners. Use of these images without the express written consent of the owner is prohibited. 031021 amf

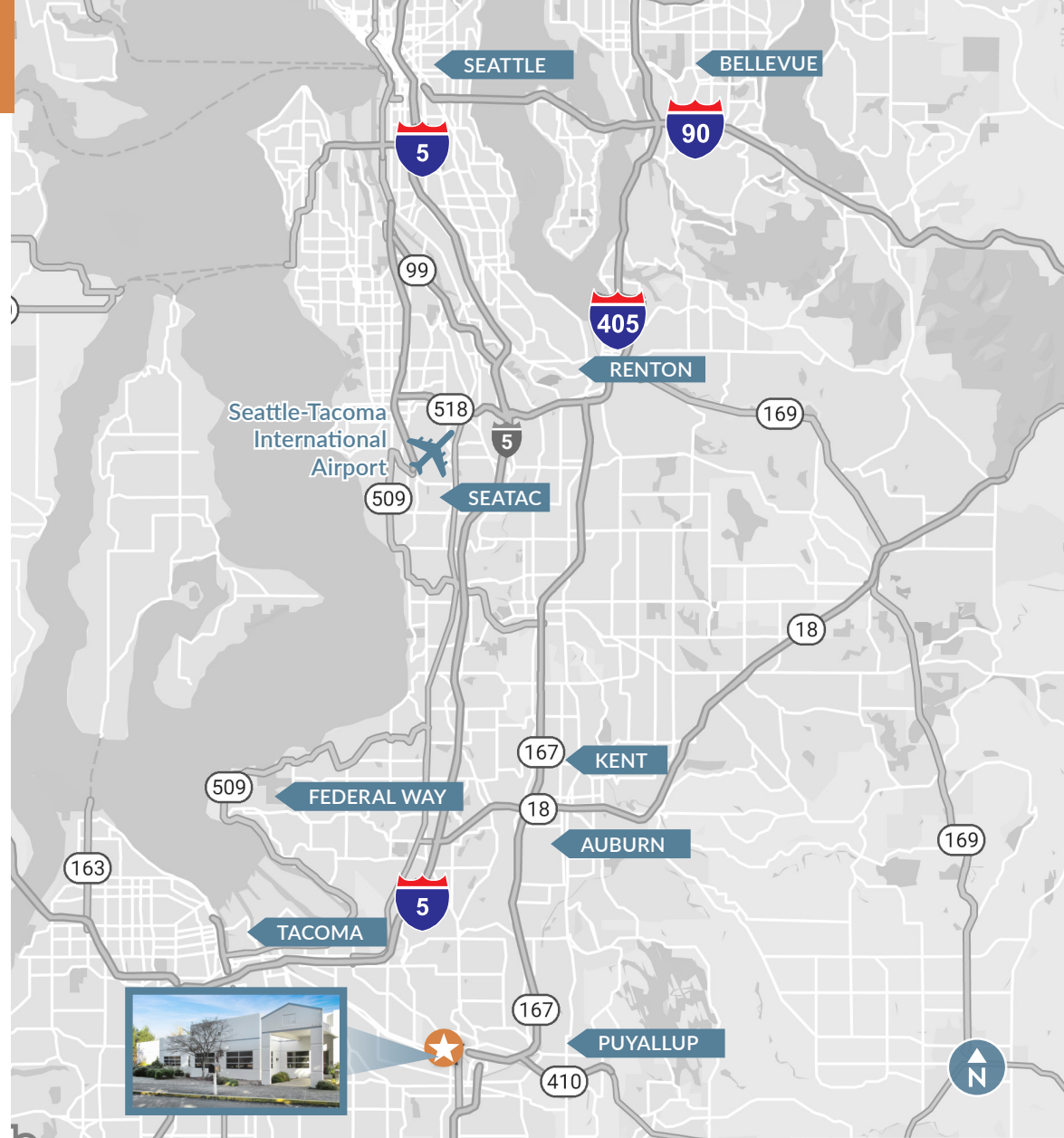

CBRE

LBALogistics

DISTANCES TO/FROM
403 NORTH LEVEE ROAD
PUYALLUP, WA



25 MILES TO SEA-TAC
INTERNATIONAL
AIRPORT



33 MILES TO
SEATTLE



8 MILES TO
TACOMA



33 MILES TO
BELLEVUE