



2023

GX 460

OWNER'S MANUAL QUICK GUIDE

Contents

The Quick Guide is not intended as a substitute for your *Owner's Manual*. We strongly encourage you to review the *Owner's Manual* and supplementary manuals so you will have a better understanding of your vehicle's capabilities and limitations.

Overview	3
For safe use	
Floor mat installation	10
Entering and Exiting	
Keys	11
Smart Access System with Push-button Start	12
When Driving	
Theft Deterrent System	14
Engine (Ignition) Switch	15
Multi-information Display	17
Eco Driving Indicator Light	19
Turn Signal Lever	20
Dynamic Radar Cruise Control	21
LDA (Lane Departure Alert)	25
Intuitive Parking Assist	26
Multi-terrain Select	26
Multi-terrain Monitor	28
Four-wheel Drive System	29
Crawl Control	30
BSM (Blind Spot Monitor)	31
Headlight Switch	33
Automatic High Beam	34
Windshield Wipers and Washers	36
Rear Window Wiper and Washer	38

Driving Comfort	
Remote Touch.....	39
Center Display.....	40
Navigation System*	43
Hands-free System For Cellular Phone*	45
Audio System*	49
Front Automatic Air Conditioning System*	56
Rear Air Conditioning System*	61
Interior features	
Voice Command System*	63
USB/AUX Ports.....	70
Garage Door Opener.....	71
Lexus Enform	
LEXUS Enform Safety Connect	75
Lexus Enform Remote	77
Lexus Enform Service Connect	78
Audio	
SiriusXM Satellite Radio.....	79
Opening and Closing	
Door Locks.....	80
Power Windows.....	81
Moon Roof.....	82
Fuel Tank Cap.....	83
What to do if...	
List of Warning/Indicator Lights	85
If the electronic key does not operate properly.....	89
If the engine does not start.....	91

*: These features may be operated by Voice Command (See P. 63)

Depending on specifications, the vehicle shown in the illustration may differ from your vehicle in terms of equipment.

Overview

Instrument Panel

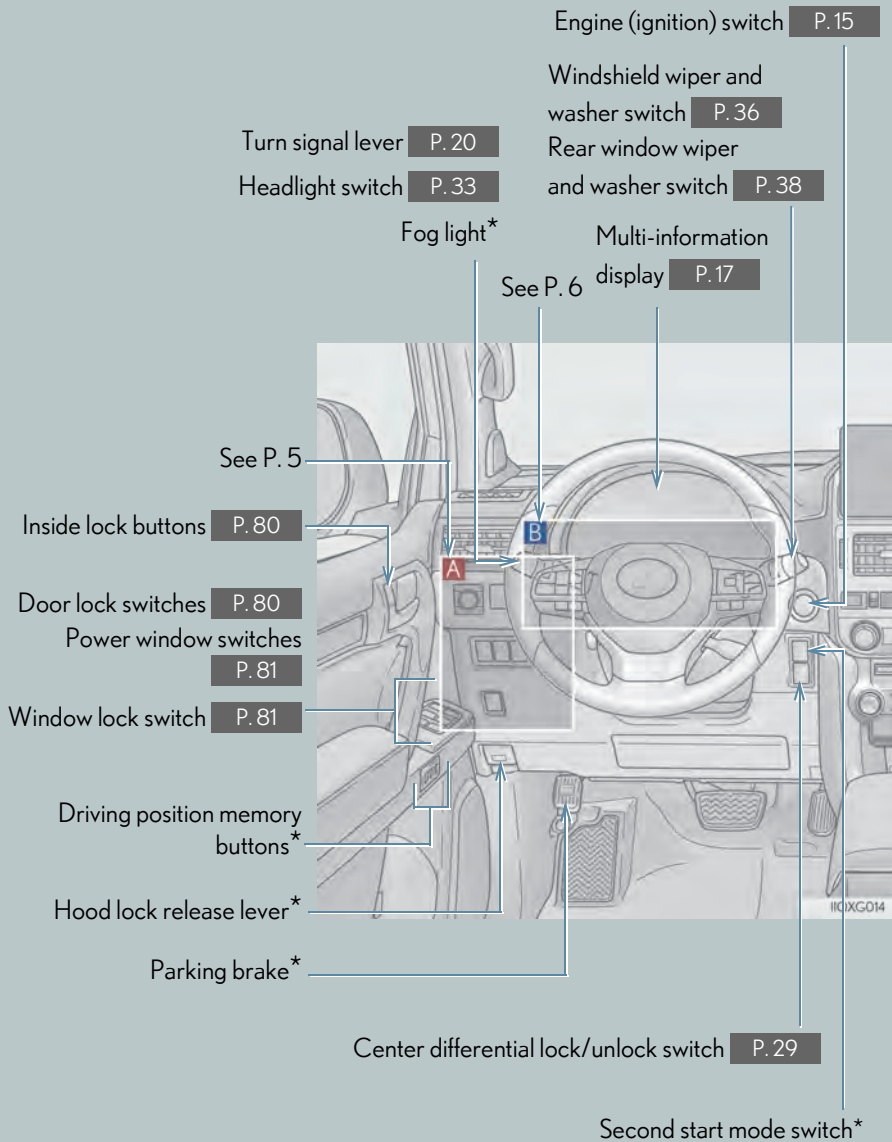

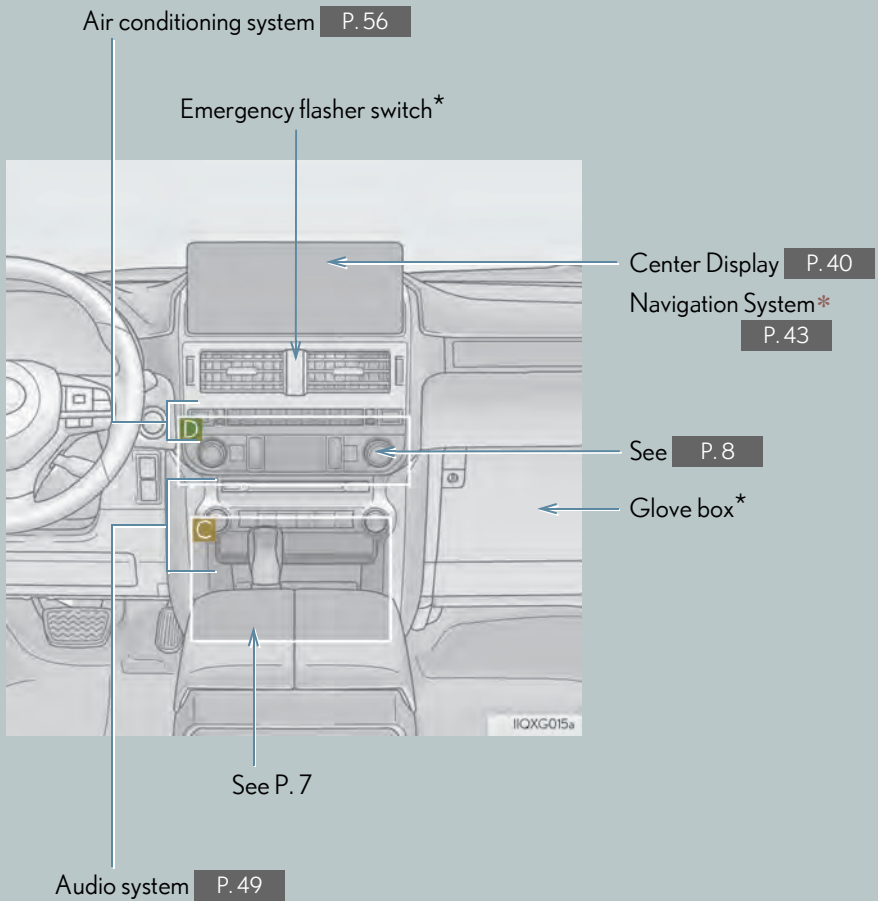

*: If equipped

*: Refer to "OWNER'S MANUAL".

A

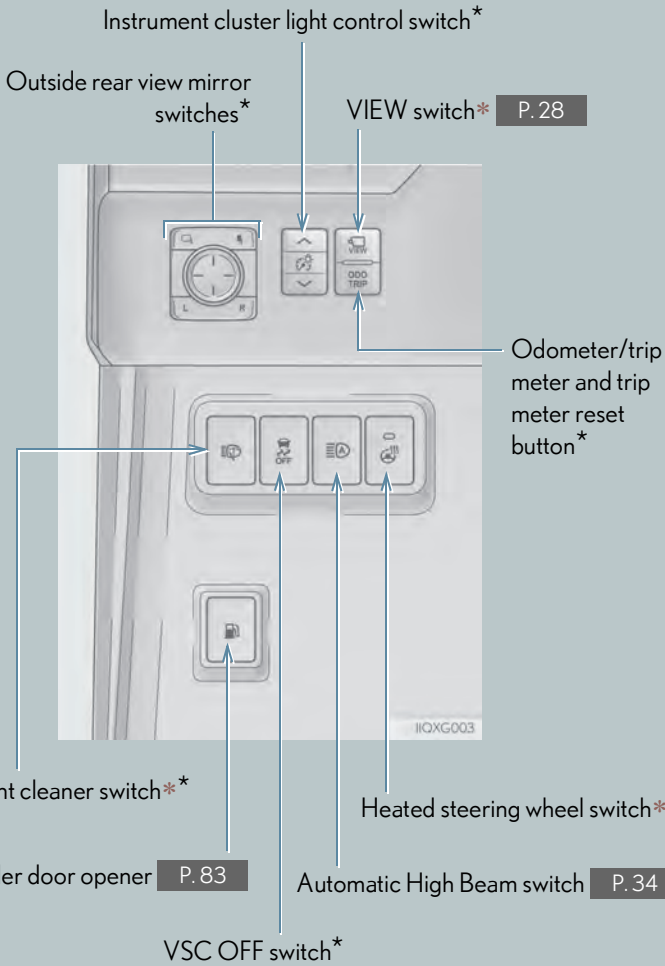

B

Audio remote control switches P.50

Meter control switches P.18

Talk switch P.63

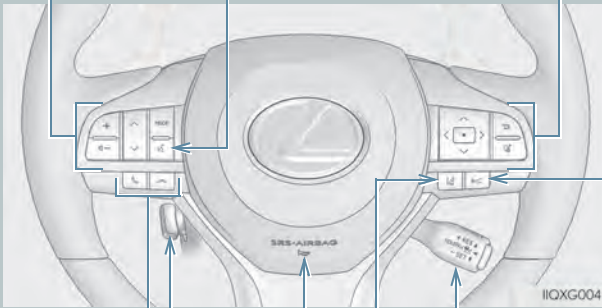

Horn *

Tilt and telescopic steering control switch *

Vehicle-to-vehicle distance switch P.21

Dynamic radar cruise control P.21

Telephone switches P.48

LDA (Lane Departure Alert) switch P.25

*: If equipped

*: Refer to "OWNER'S MANUAL".

C

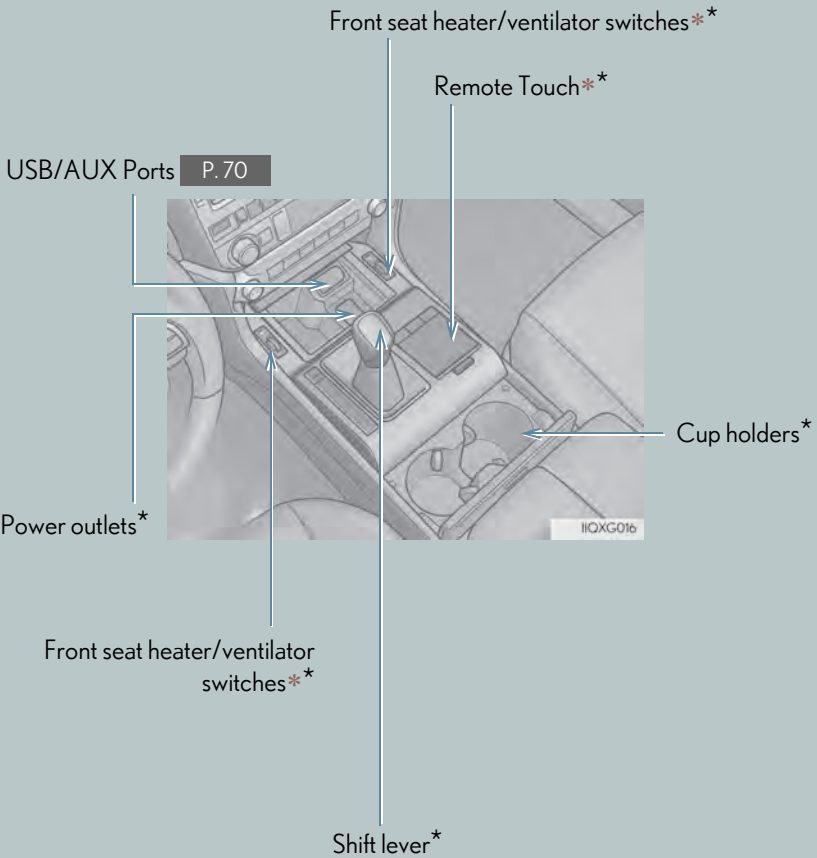

D

Crawl Control ON/OFF switch*

P. 30

"DAC" switch**

AVS switch**

Four-wheel drive control
switch P. 29

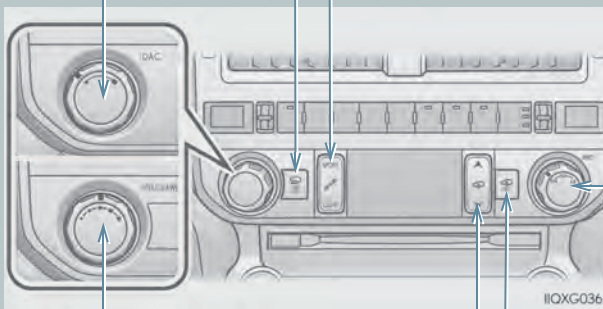

Multi-terrain Select mode selector dial*

P. 26

Crawl Control speed selector dial*

P. 30

Height control
OFF switch**

Height control switch**

*: If equipped

*: Refer to "OWNER'S MANUAL".

Conversation mirror*
Auxiliary boxes*

Personal/interior lights*

Moon roof switches P. 82

Vanity lights*

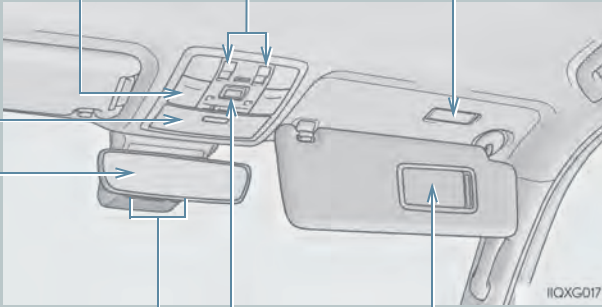

Inside rear view mirror*

Vanity mirrors*

"SOS" button* P. 75

Garage door opener buttons P. 71

*: If equipped

*: Refer to "OWNER'S MANUAL".

Floor mat installation

Use only floor mats designed specifically for vehicles of the same model and model year as your vehicle. Fix them securely in place onto the carpet.

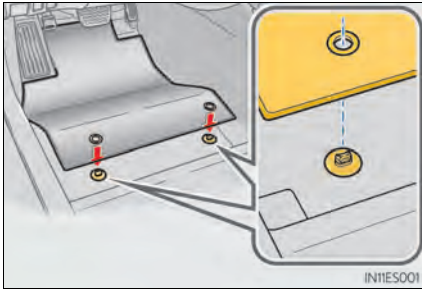

- 1** Insert the retaining hooks (clips) into the floor mat eyelets.

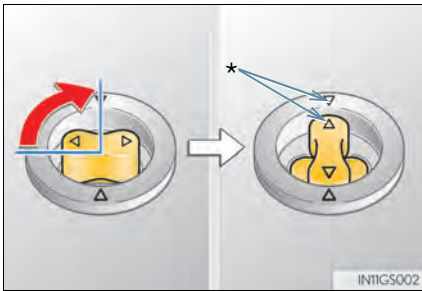

- 2** Turn the upper knob of each retaining hook (clip) to secure the floor mats in place.

*: Always align the \triangle marks.

The shape of the retaining hooks (clips) may differ from that shown in the illustration.

Keys

■ Electronic key



Smart access system with push-button start (→P. 12, 15)

Wireless remote control (→P. 11)

■ Mechanical key

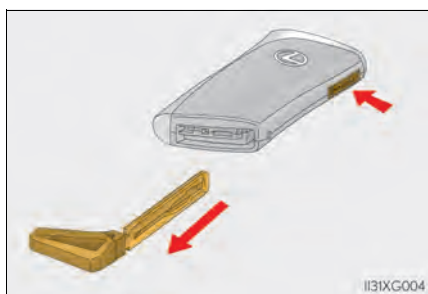

To take out the mechanical key, push the release button and take the key out.

The mechanical key can only be inserted in one direction, as the key only has grooves on one side. If the key cannot be inserted in a lock cylinder, turn it over and re-attempt to insert it.

After using the mechanical key, store it in the electronic key. Carry the mechanical key together with the electronic key. If the electronic key battery is depleted or the entry function does not operate properly, you will need the mechanical key.

■ Wireless remote control

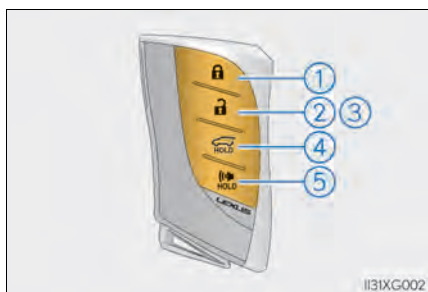

- ① Locks the doors
Check that the door is securely locked.
 - ② Unlocks the doors
 - ③ Opens the windows and moon roof*
 - ④ Opens the glass hatch (press and hold)
 - ⑤ Sounds the alarm
- *: These settings must be customized at your Lexus dealer.

Smart Access System with Push-button Start

The following operations can be performed simply by carrying the electronic key on your person, for example in your pocket. The driver should always carry the electronic key. For details on starting the engine, see page 15.

■ Entering and exiting the vehicle

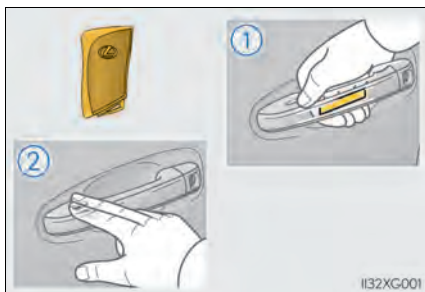

- ① Grip the driver's door handle to unlock the door. Grip the passenger's door handle to unlock all the doors.*

Make sure to touch the sensor on the back of the handle.

The doors cannot be unlocked for 3 seconds after the doors are locked.

*: The door unlock settings can be changed.

- ② Touch the lock sensor (the indentation on the upper part or lower part of the front door handle) to lock the doors. Check that the door is securely locked.

■ Unlocking and locking the back door

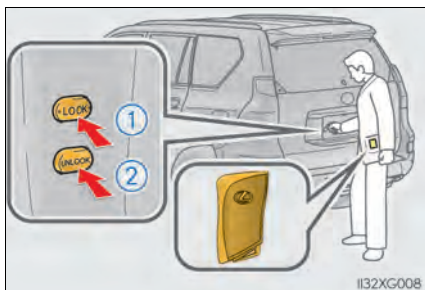

- ① Locks all the doors
Check that the door is securely locked.
- ② Unlocks all the doors
The doors cannot be unlocked for 3 seconds after the doors are locked.

■ Opening the glass hatch

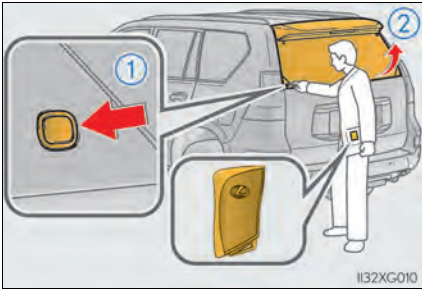

- ① While carrying the electronic key, press the button to pop up the glass hatch.
- ② Raise
The glass hatch can be opened even when the back door is locked.

For details on what to do when the electronic key does not operate properly, see page 89.

Theft Deterrent System

■ Engine immobilizer system

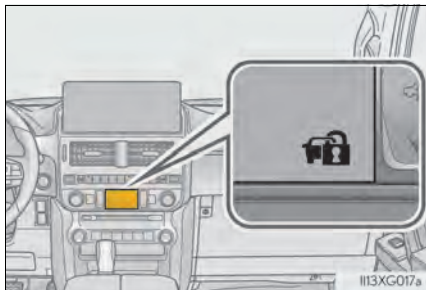

The indicator light flashes after the engine switch has been turned off to indicate that the system is operating.

The indicator light stops flashing after the engine switch has been turned to ACCESSORY or IGNITION ON mode to indicate that the system has been canceled.

■ Alarm

The alarm uses light and sound to give an alert when an intrusion is detected.

To set the alarm:

Close the doors, glass hatch and hood, and lock all the doors. The system will be set automatically after 30 seconds.

The indicator light changes from being on to flashing when the system is set.

To deactivate or stop the alarm:

- Unlock the doors.
- Turn the engine switch to ACCESSORY or IGNITION ON mode, or start the engine. (The alarm will be deactivated or stopped after a few seconds.)

Engine (Ignition) Switch

Performing the following operations when carrying the electronic key on your person starts the engine or changes engine switch modes.

Starting the engine

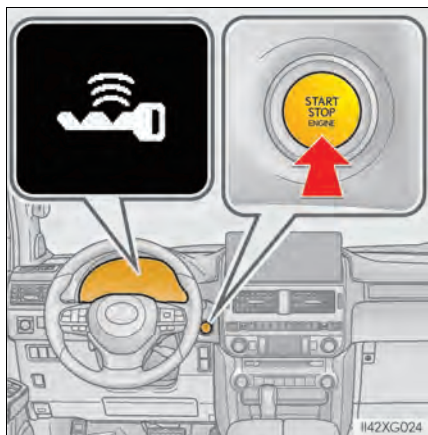

- 1 Check that the parking brake is set.
- 2 Check that the shift lever is set in P.
- 3 Firmly depress the brake pedal.



and a message will be displayed on the multi-information display.

If it is not displayed, the engine cannot be started.

- 4 Press the engine switch shortly and firmly.

When operating the engine switch, one short, firm press is enough.

It is not necessary to press and hold the switch.

The engine will crank until it starts or for up to 30 seconds, whichever is less.

Continue depressing the brake pedal until the engine is completely started.

The engine can be started from any engine switch mode.

Stopping the engine

- 1 Stop the vehicle.
- 2 Set the parking brake, and shift the shift lever to P.
- 3 Press the engine switch.
- 4 Release the brake pedal and check that "ACCESSORY" or "IGNITION ON" is not shown on the meter.

■ Changing engine switch modes

Modes can be changed by pressing the engine switch with brake pedal released. (The mode changes each time the switch is pressed.)

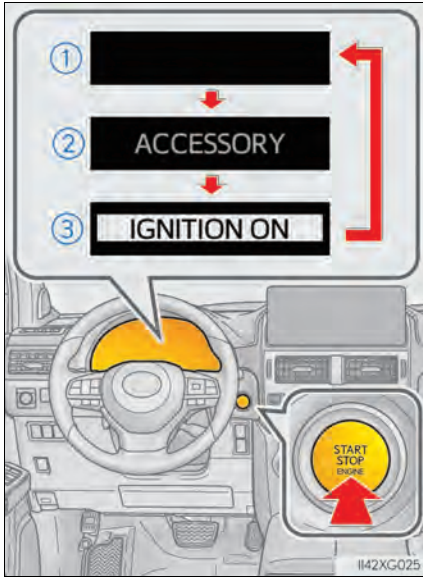

- ① Off*
The emergency flashers can be used.
 - ② ACCESSORY mode
Some electrical components such as the audio system can be used. "ACCESSORY" will be displayed on the multi-information display.
 - ③ IGNITION ON mode
All electrical components can be used. "IGNITION ON" will be displayed on the multi-information display.
- *: If the shift lever is in a position other than P when turning off the engine, the engine switch will be turned to ACCESSORY mode, not to off.

Multi-information Display

The following information will be displayed when a menu icon is selected.

Display information



Drive information

Select to display various drive data.



Vehicle information display

Select to display the vehicle information.



Driving assist system information

Select to display the operational status of the following systems:

- Dynamic radar cruise control (→P. 21)
- LDA (Lane Departure Alert) (→P. 25)



Warning message display

Select to display warning messages and measures to be taken if a malfunction is detected.





Settings display

Select to change the meter display settings and the operation settings of some vehicle functions.

■ Operating the meter control switches

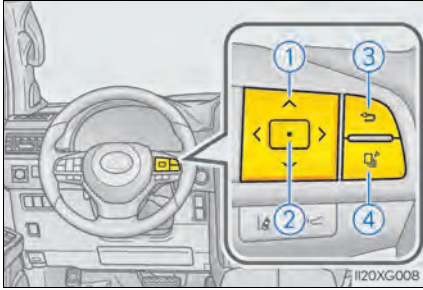
The multi-information display is operated using the meter control switches.



- ① < > : Switch menu
^ v : Change displayed content, scroll up/down the screen and move the cursor up/down
- ② Press: Enter/Set
Press and hold: Reset
- ③ Return to the previous screen
- ④ Press: Displays the screen registered to 

When no screen has been registered, the drive information screen will be displayed.

Press and hold: Registers the currently displayed screen to 

When the confirmation screen is displayed, select yes to register the screen. If the selected screen cannot be registered, a registration failure message will be shown.

If a problem is detected in any of the vehicle's systems, a warning message is shown on the multi-information display.

Eco Driving Indicator Light

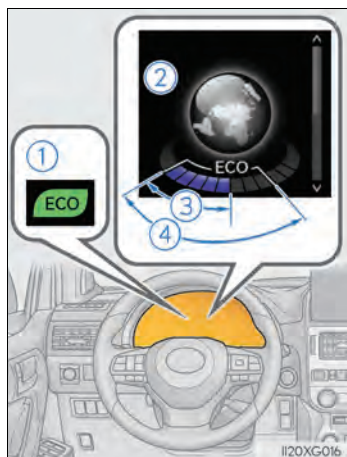

- ① **Eco Driving Indicator Light**
During Eco-friendly acceleration operation (Eco driving), the Eco Driving Indicator Light will turn on. When the acceleration exceeds Zone of Eco driving, or when the vehicle is stopped, the light turns off.
- ② **Eco Driving Indicator Zone Display**
Suggests the Zone of Eco driving with current Eco driving ratio based on acceleration.
- ③ **Eco driving ratio based on acceleration**
If the acceleration exceeds Zone of Eco driving, the right side of Eco Driving Indicator Zone Display will illuminate.
- ④ **Zone of Eco driving**
Eco Driving Indicator will not operate under the following conditions:
 - The shift lever is in any position other than D.
 - Vehicles with adaptive variable suspension system: The driving mode is set to sport mode.
 - The vehicle speed is approximately 81 mph (130 km/h) or higher.

Turn Signal Lever

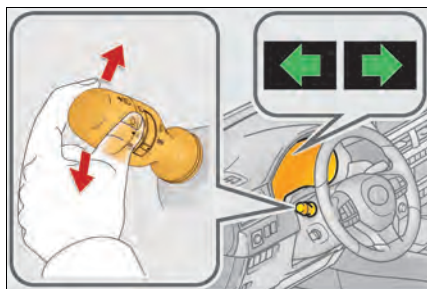

- ① Right turn
- ② Lane change to the right (move the lever partway and then release it)
- ③ Lane change to the left (move the lever partway and then release it)
- ④ Left turn

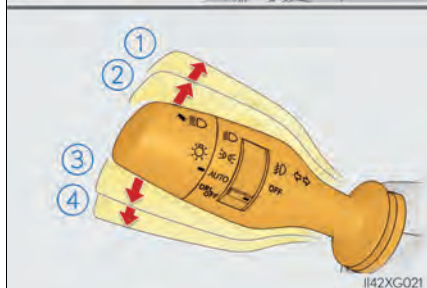

Dynamic Radar Cruise Control

In vehicle-to-vehicle distance control mode, the vehicle automatically accelerates and decelerates to match the speed changes of the preceding vehicle even if the accelerator pedal is not depressed. In constant speed control mode, the vehicle runs at a fixed speed.

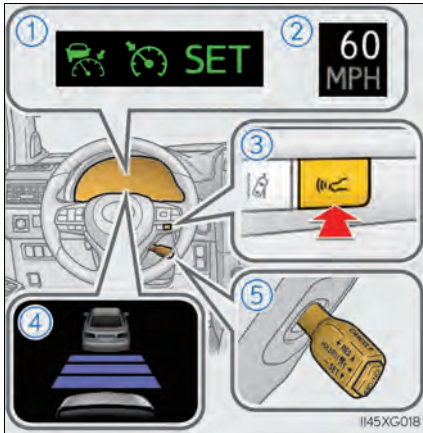

- ① Indicators
- ② Set speed
- ③ Vehicle-to-vehicle distance switch
- ④ Display
- ⑤ Cruise control switch

■ Setting the vehicle speed (vehicle-to-vehicle distance control mode)

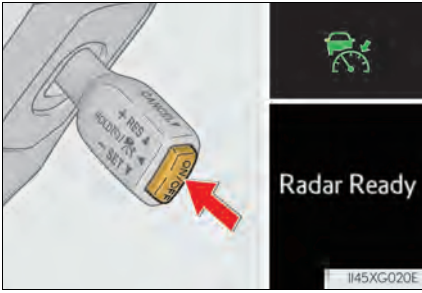

- 1 Press the “ON/OFF” button to activate the cruise control.

Radar cruise control indicator will come on and a message will be displayed on the multi-information display.

Press the button again to deactivate the cruise control.

If the “ON/OFF” button is pressed and held for 1.5 seconds or more, the system turns on in constant speed control mode.

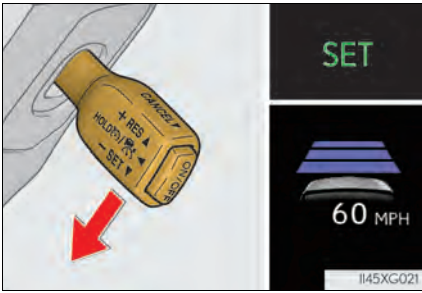

- 2 Accelerate or decelerate, with accelerator pedal operation, to the desired vehicle speed (at or above approximately 30 mph [50 km/h]) and push the lever down to set the speed.

Cruise control “SET” indicator will come on.

The vehicle speed at the moment the lever is released becomes the set speed.

■ Adjusting the set speed

To change the set speed, operate the lever until the desired set speed is displayed.

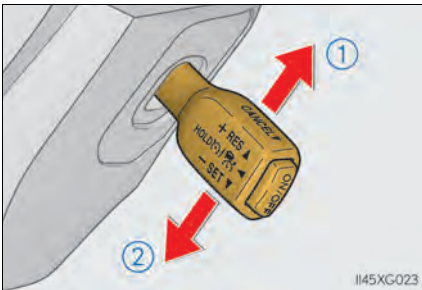

- ① Increases the speed
- ② Decreases the speed

Fine adjustment: Momentarily move the lever in the desired direction.

Large adjustment: Hold the lever up or down to change the speed, and release when the desired speed is reached.

■ Changing the vehicle-to-vehicle distance (vehicle-to-vehicle distance control mode)

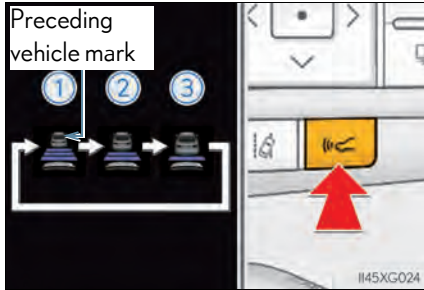

Pressing the switch changes the vehicle-to-vehicle distance as follows:

- ① Long
- ② Medium
- ③ Short

The vehicle-to-vehicle distance is set automatically to long mode when the engine switch is turned to IGNITION ON mode.

If a vehicle is running ahead of you, the preceding vehicle mark will also be displayed.

The vehicle-to-vehicle distance control mode maintains the preset cruising speed as long as no vehicle is detected ahead.

■ Canceling and resuming the speed control

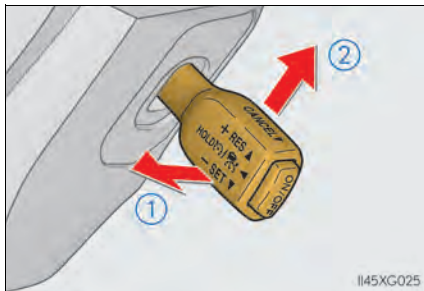

- ① Pulling the lever toward you cancels the speed control.

The speed control is also canceled when the brake pedal is depressed.

- ② Pushing the lever up resumes the cruise control and returns vehicle speed to the set speed.

However, cruise control does not resume when the vehicle speed is approximately 25 mph (40 km/h) or less.

■ Selecting constant speed control mode

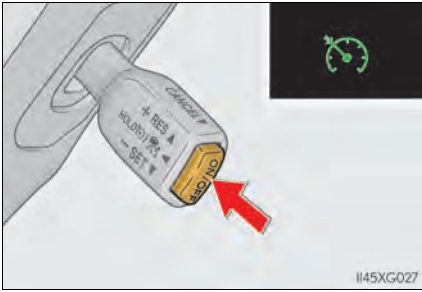

- 1 With the cruise control off, press and hold the “ON/OFF” button for 1.5 seconds or more.

Immediately after the “ON/OFF” button is pressed, the radar cruise control indicator will come on. Afterwards, it switches to the cruise control indicator.

Switching to constant speed control mode is only possible when operating the lever with the cruise control off.

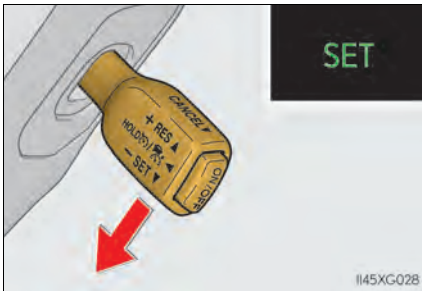

- 2 Accelerate or decelerate, with accelerator pedal operation, to the desired vehicle speed (at or above approximately 25 mph [40 km/h]) and push the lever down to set the speed.

Cruise control “SET” indicator will come on.

The vehicle speed at the moment the lever is released becomes the set speed.

LDA (Lane Departure Alert)

When driving on roads with white (yellow) lines, this function alerts the driver when the vehicle might depart from its lane.

The LDA system recognizes visible white (yellow) lines with the camera sensor on the upper portion of the front windshield.

■ Turning LDA system on

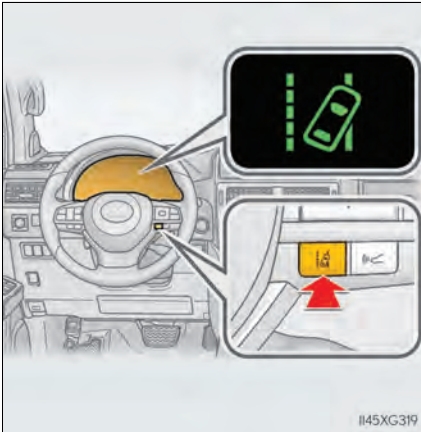

Press the LDA switch to turn the LDA system on.

The LDA indicator illuminates.





Press the LDA switch again to turn the LDA system off.

When the LDA system is turned on or off, operation of the LDA system continues in the same condition the next time the engine is started.

Intuitive Parking Assist

The distance from your vehicle to nearby obstacles when parallel parking or maneuvering into a garage is measured by the sensors and communicated via the multi-information display, the navigation system screen and a buzzer. Always check the surrounding area when using this system.

Turning the intuitive parking assist on/off

- 1 Press **<** or **>** of the meter control switches and select  on the multi-information display.
 - 2 Press **▲** or **▼** of the meter control switches and select , and then press .
 - 3 Press **▲** or **▼** of the meter control switches and select , and then press .
- Each pressing of the switch turns the intuitive parking assist on and off.
When ON is selected, Intuitive parking assist indicator will come on.

Multi-terrain Select (if equipped)

Multi-terrain Select is a system that helps drivability in off-road situations.





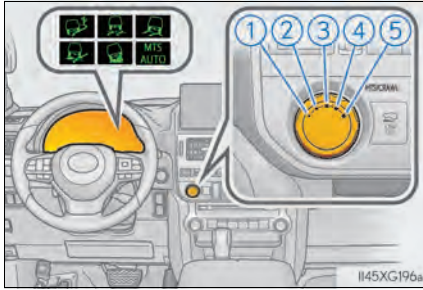

- 1 Multi-information display
The selected Multi-terrain Select mode will be displayed on the multi-information display.
- 2 Multi-terrain Select mode selector dial
- 3 Multi-terrain Select indicator

■ Selectable modes

▶ When the Crawl Control is turned off



A mode which matches the road conditions can be selected from among the following 5 modes.

- ①  : MUD & SAND mode
Suitable for muddy roads, sandy roads, snow-covered roads, dirt trails and other slippery or dirty conditions. The MUD&SAND mode indicator illuminates on the multi-information display.
- ②  : LOOSE & ROCK mode
Suitable for slippery conditions consisting of mixtures of earth and loose rock. The LOOSE & ROCK mode indicator illuminates on the multi-information display.
- ③  : MOGUL mode
Suitable for very bumpy road conditions, such as mogul roads. MOGUL mode indicator illuminates on the multi-information display.
- ④  : ROCK & DIRT mode
Suitable for very bumpy road conditions, such as mogul or rocky roads. ROCK & DIRT mode indicator illuminates on the multi-information display.
- ⑤  : ROCK mode
Suitable for rocky roads. ROCK mode indicator illuminates on the multi-information display.

▶ When the Crawl Control is turned on

 : MTS AUTO mode

The most suitable mode is automatically selected according to the selected Crawl Control mode. MTS AUTO indicator illuminates on the multi-information display.

Multi-terrain Monitor (if equipped)

The Multi-terrain Monitor helps the driver to check the vehicle surroundings. It assists in determining the conditions around the driver in a variety of situations, such as when judging conditions during off-road driving or checking for obstacles when parking.

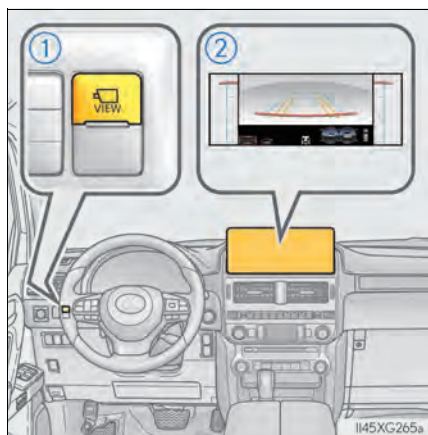

① VIEW switch

② Display

The surroundings area displayed can be switched by pressing the VIEW switch.

Four-wheel Drive System

Use the four-wheel drive control switch and center differential lock/unlock switch to select the following transfer and center differential modes.

Four-wheel drive control switch

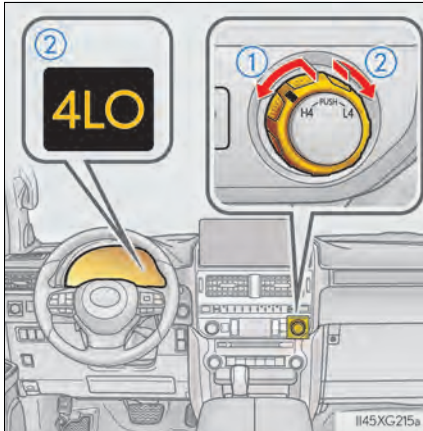

- ① H4 (high speed position)
Normal driving on all types of roads.
- ② L4 (low speed position)
Driving requiring maximum power and traction such as climbing or descending steep hills, off-road driving, and hard pulling in sand or mud, etc.
The low speed four-wheel drive indicator will come on.

Center differential lock/unlock switch

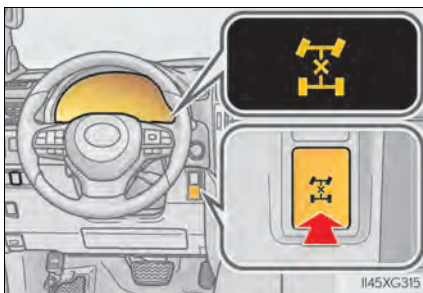

Lock the center differential when your vehicle's wheels get stuck in a ditch or when driving on a slippery or bumpy surface.

The center differential lock indicator will come on.

Unlock the center differential after the wheels have been freed, or after moving to a flat, non-slippery surface.

To unlock the center differential, push the switch again.

Crawl Control (if equipped)

Allows travel on extremely rough off-road surfaces at a fixed low speed without pressing the accelerator or brake pedal. Minimizes loss of traction or vehicle slip when driving on slippery road surfaces, helping for stable driving.

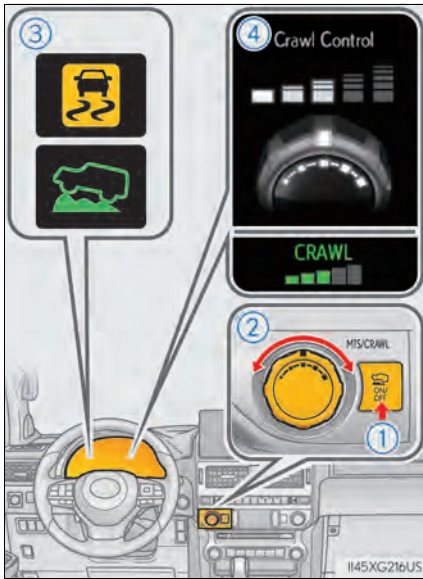

- ① Crawl Control ON/OFF switch
The indicator light on the switch comes on when operating.
- ② Crawl Control speed selector dial
- ③ Crawl Control indicators
The Crawl Control indicator is lit and the slip indicator flashes when operating.
- ④ Multi-information display
The selected multi-terrain select mode will be displayed on the multi-information display.

BSM (Blind Spot Monitor)

The Blind Spot Monitor is a system that has 2 functions;





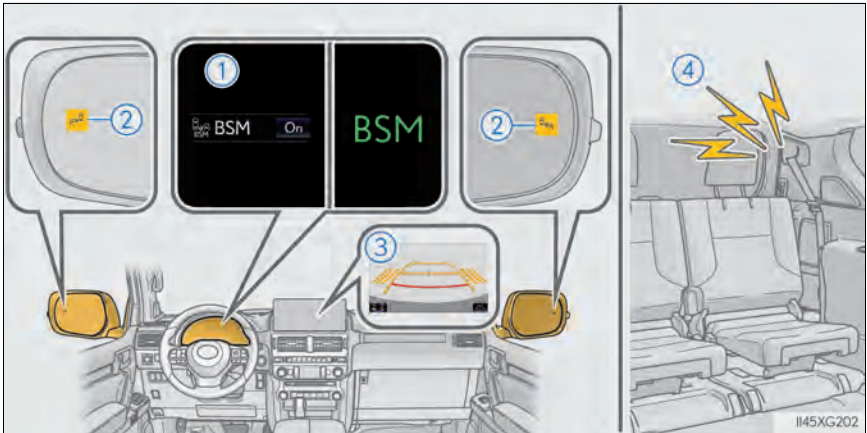

- The Blind Spot Monitor function
Assists the driver in making the decision when changing lanes
- The Rear Cross Traffic Alert function
Assists the driver when backing up

These functions use same sensors.





- ① The Blind Spot Monitor on/off screen and indicator
The Blind Spot Monitor system can be turned on/off on the multi-information display. When the system is set to on, the indicator illuminates in the meter and the buzzer sounds. The Blind Spot Monitor function and the Rear Cross Traffic Alert function are turned on/off simultaneously.
- ② Outside rear view mirror indicator
The Blind Spot Monitor function:
When a vehicle is detected in the blind spot, the outside rear view mirror indicator comes on while the turn signal lever is not operated. If the turn signal lever is operated toward the detected side, the outside rear view mirror indicator flashes.
The Rear Cross Traffic Alert function:
When a vehicle approaching from the right or left rear of the vehicle is detected, the outside rear view mirror indicators flash.
- ③ Monitor screen display (The Rear Cross Traffic Alert function only)
If a vehicle approaching from the right or left at the rear of the vehicle is detected, the Rear Cross Traffic Alert icon for the detected side will be displayed on the monitor screen.
This illustration shows an example of a vehicle approaching from the left at the rear of the vehicle.
- ④ The Rear Cross Traffic Alert buzzer (The Rear Cross Traffic Alert function only)
When a vehicle approaching from the right or left rear of the vehicle is detected, a buzzer sounds from behind the rear seat.

■ Turning the Blind Spot Monitor system on/off

- 1** Press  or  of the meter control switches and select  on the multi-information display.
- 2** Press  or  of the meter control switches and select , and then press . Each pressing of the switch turns the Blind Spot Monitor on and off.

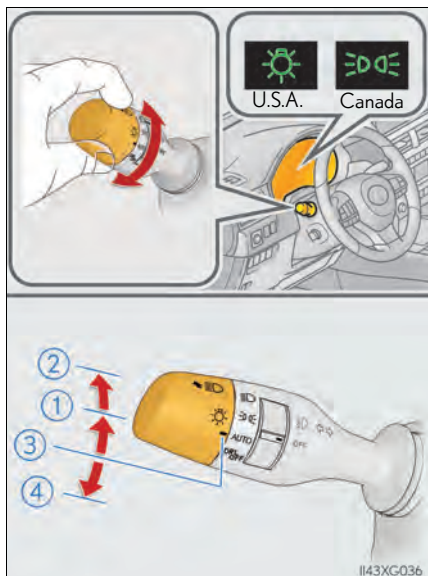
Headlight Switch



-  ① The side marker, parking, tail, license plate, instrument panel lights, and daytime running lights turn on.
-  ② The headlights and all the lights listed above (except daytime running lights) turn on.
- ③ AUTO The headlights, daytime running lights and all the lights listed above turn on and off automatically.
- ④

DRL	Off.
OFF	

(U.S.A. only)

Turning on the high beam headlights



- ① With the headlights on, push the lever away from you to turn on the high beams.
Pull the lever toward you to the center position to turn the high beams off.
- ② Pull the lever toward you and release it to flash the high beams once.
You can flash the high beams with the headlights on or off.

Automatic High Beam

The Automatic High Beam uses an in-vehicle camera sensor to assess the brightness of streetlights, the lights of vehicles ahead etc., and automatically turns the high beam on or off as necessary.

■ Activating the Automatic High Beam system

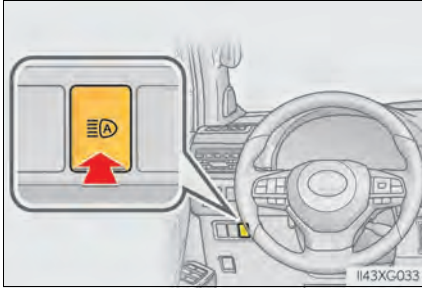

- 1** Press the Automatic High Beam switch.



- 2** Turn the headlight switch to the  or AUTO position. The Automatic High Beam indicator will come on when the system is operating.

■ Turning the high beam on/off manually

- Switching to the high beam



Push the lever away from you.

The Automatic High Beam indicator will turn off and the high beam indicator will turn on.

Pull the lever to its original position to activate the Automatic High Beam system again.

- Switching to the low beam

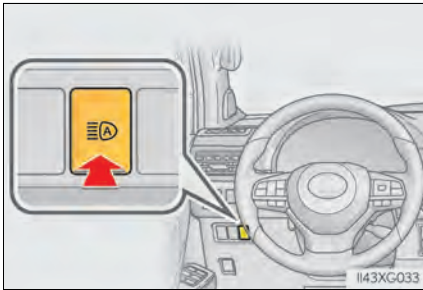

Press the Automatic High Beam switch.

The Automatic High Beam indicator will turn off.

Press the switch to activate the Automatic High Beam system again.

■ Temporarily switching to the low beams

Pull the lever toward you and then return it to its original position.

The high beams are on while the lever is pulled toward you, however, after the lever is returned to its original position, the low beams remain on for a certain amount of time. Afterwards, the Automatic High Beam will be activated again.

Windshield Wipers and Washers

■ Intermittent windshield wipers with interval adjuster

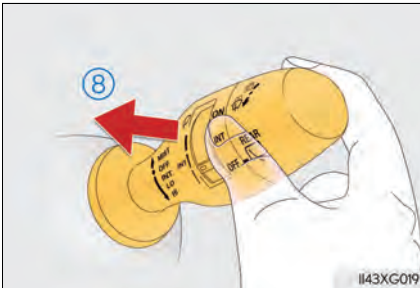
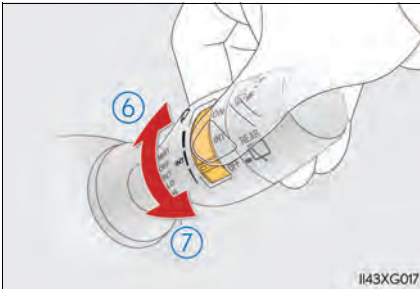
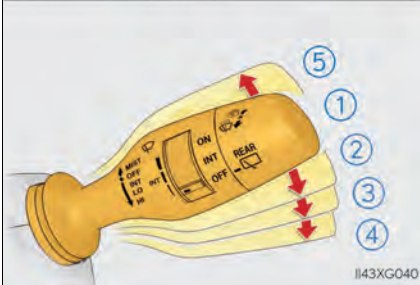
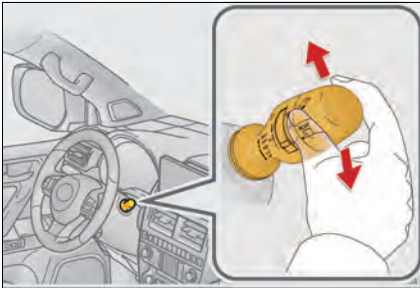

- ① **OFF** Off
- ② **INT** Intermittent operation
- ③ **LO** Low speed operation
- ④ **HI** High speed operation
- ⑤ **MIST** Temporary operation

Wiper intervals can be adjusted when intermittent operation is selected.

- ⑥ Increases the intermittent windshield wiper frequency
- ⑦ Decreases the intermittent windshield wiper frequency

- ⑧  Washer/wiper dual operation
Pulling the lever operates the wipers and washer.

The wipers will automatically operate a couple of times after the washer squirts.

Vehicles with headlight cleaners: If the headlights are on, the headlight cleaners will operate once.

■ Rain-sensing windshield wipers

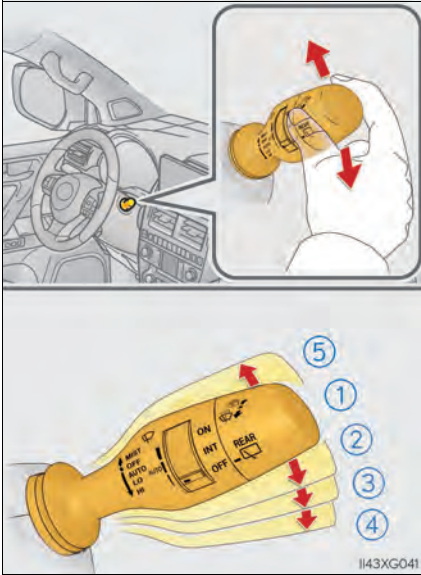

- ① **OFF** *1 or ○ *2 Off
- ② **AUTO** Rain-sensing operation
- ③ **LO** *1 or ▼ *2
Low speed operation
- ④ **HI** *1 or ▼▼ *2
High speed operation
- ⑤ **MIST** *1 or ▲ *2
High speed operation

*1: For the U.S.A.

*2: For Canada

When "AUTO" is selected, the wipers will operate automatically when the sensor detects falling rain. The system automatically adjusts wiper timing in accordance with rain volume and vehicle speed.

The sensor sensitivity can be adjusted when "AUTO" is selected.

- ⑥ Increases the sensitivity
- ⑦ Decreases the sensitivity

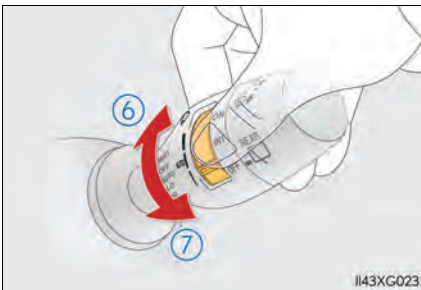

- ⑧  Washer/wiper dual operation
Pulling the lever operates the wipers and washer.
The wipers operate automatically. (After operating several times, the wipers operate one more time after a short delay to prevent dripping.)
Vehicles with headlight cleaners: If the headlights are on, the headlight cleaners will operate once.

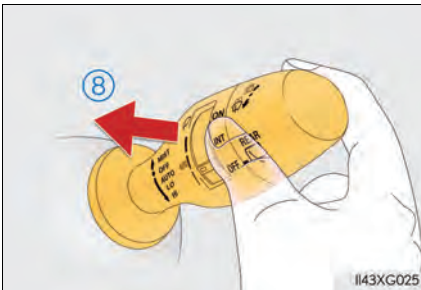

Rear Window Wiper and Washer

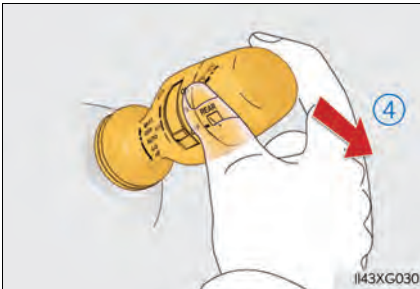
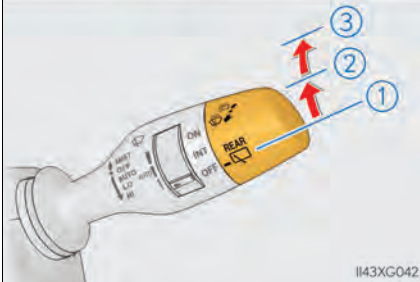

① **OFF** *1 or ○ *2

Off

② **INT** *1 or --- *2

Intermittent operation

③ **ON** *1 or — *2

Normal operation

*1: For the U.S.A.

*2: For Canada

④  Washer/wiper dual operation

Pushing the lever operates the wiper and washer.

The wipers will automatically operate a couple of times after the washer squirts.

Remote Touch

The Remote Touch can be used to operate the Center Display.

Remote Touch is the name for the device that includes the “MAP” button, “MENU” button, back button, touchpad and sub function button.

Names and operations of each part

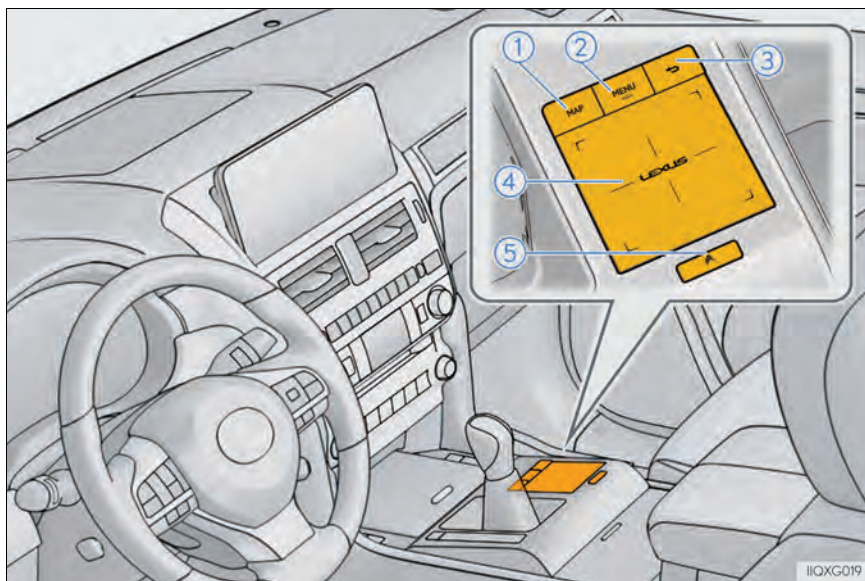

- ① “MAP” button
Press to display the current location.
- ② “MENU” button
Press to display the menu screen.
- ③ Back button
Press to display the previous screen.
- ④ Touchpad
Operate to select/confirm a button on the screen.
Operate to scroll list screens and enlarge/shrink the map.
- ⑤ Sub function button
When  is displayed on the screen, a function screen assigned to the screen can be displayed.

Center Display

Menu screen

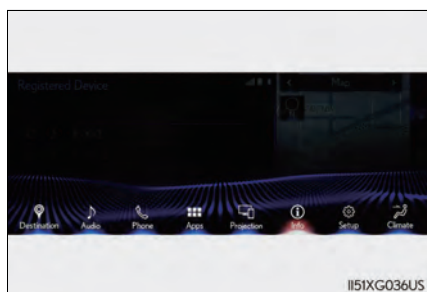

Press the “MENU” button on the Remote Touch to display the menu screen.

This system can also be operated by the touch screen.

For details, refer to “NAVIGATION SYSTEM OWNER’S MANUAL”.

The displays shown in the illustrations are used for example only and may differ from the actual vehicle.

Switch	Function
	Select to display the destination screen.*1 (→P. 43)
	Select to display the audio control screen. (→P. 49)
	Select to display the hands-free control screen. (→P. 45)
	Select to display the “Apps” screen.*2,3
	When an Apple CarPlay/Android Auto connection is established and this button displays “Apple CarPlay”/ “Android Auto”, select to display the home screen of Apple CarPlay/Android Auto.*2,3
	Select to display the information screen.*2,4
	Select to display the general settings screen.*2
	Select to display the air conditioning control screen. (→P. 56)

*1: If equipped

*2: Refer to the “NAVIGATION SYSTEM OWNER’S MANUAL”.

*3: This function is not made available in some countries or areas.

*4: Refer to “OWNER’S MANUAL”.

■ Split-screen display

Different information can be displayed on the left and right of the screen. For example, air conditioning system screen can be displayed and operated while the fuel consumption information screen is being displayed. The large screen on the left of the display is called the main display, and the small screen to the right is called the side display.



■ Side display

The following functions can be displayed and operated on the side display.

Select ◀ or ▶ to display the desired screen.

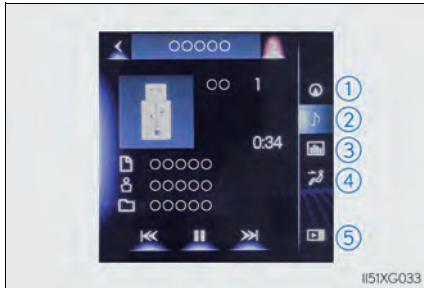

- ① Navigation system (→P. 43)
- ② Audio (→P. 52, 53, 54, 55)
- ③ Vehicle information
- ④ Air conditioning system (→P. 56)
- ⑤ Show/hide the side display

■ Map scroll operation (if equipped)



Select the desired point on the map screen.
Move the desired point on the center of the map screen.

- ① Cursor mark
- ② Distance from the current position to the cursor mark
- ③ Select to register as a memory point
- ④ Select to set as a destination

Press the “MAP” button on the Remote Touch to return to the current position.

■ Editing route (if equipped)

While route guidance is operating, you can change the route using the following method.

- 1 Select  on the map screen.

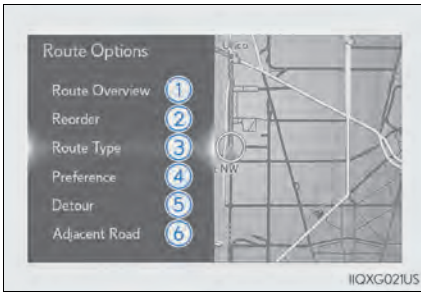

- 2 Select the desired item to be set.
 - ① Select to display the overview of the entire route.
 - ② Select to reorder destinations.
 - ③ Select to change route type.
 - ④ Select to set route preferences.
 - ⑤ Select to set detours.
 - ⑥ Select to start from adjacent road.

- 3 Check that the route overview is displayed.

Some functions are unavailable while the vehicle is in motion. Refer to the “NAVIGATION SYSTEM OWNER’S MANUAL”.

Navigation System

■ Registering home

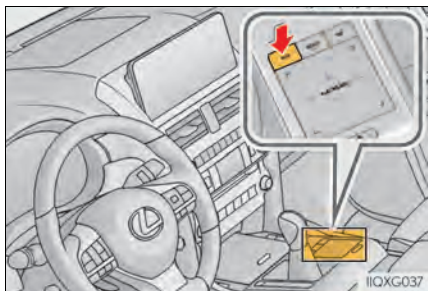

- 1** Press the “MAP” button on the Remote Touch.
- 2** Select .
- 3** Select “Home”.
- 4** Select “Yes”.
- 5** Select “Address” or “Current Location” to search for your home.
- 6** Select “OK”.
Registration of home is complete.

■ Destination search

■ Searching by address

- 1** Display the destination search screen by either operation:
 - “MAP” button → 
 - “MENU” button → “Destination”
- 2** Select “Address”.
If a state (province) has not been selected yet, “State/Province” screen is displayed.
- 3** Enter a house number and select “Search”.
“Change State/Province”: Select to change the search area.
- 4** Enter a street name and select “Search”.
- 5** Select the desired street name.
- 6** Enter a city name and select “Search”.
- 7** Select the desired city name.
If multiple locations with the same address exist, the address list screen will be displayed.
Select the desired address.

■ Searching by point of interest

There are 3 methods to search for a destination by Points of Interest.

1 Display the destination search screen by either operation:

- “MAP” button → 
- “MENU” button → “Destination”

2 Select “Point of Interest”.

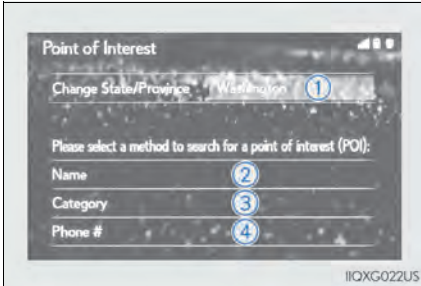

3 Select the desired search method.

- ① Select to change the search area.
- ② Select to search by name.
- ③ Select to search by category.
- ④ Select to search by phone number.

► Searching by name (②)

- 4 Select “Name”.
- 5 Enter a POI name and select “Search”.
- 6 Select the desired POI.

► Searching by category (③)

4 Select “Category”.

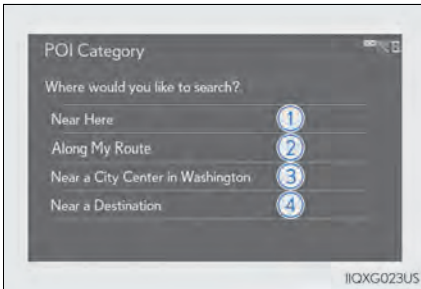

5 Select the desired search point.

- ① Select to search for POIs near your current position.
- ② Select to search for POIs along the set route.
- ③ Select to search for POIs near a specific city center.
- ④ Select to search for POIs near a destination. When more than 1 destination has been set, a list will be displayed on the screen. Select the desired destination.

6 Select the desired POI category.

7 Select the desired POI.

► Searching by phone number (④)

- 4 Select “Phone #”.
- 5 Enter a phone number and select “OK”.

Hands-free System For Cellular Phone

■ Registering/connecting Bluetooth® device

To use the hands-free system, it is necessary to register a Bluetooth® phone with the system. Refer to <http://www.lexus.com/MobileLink> to find approved Bluetooth® phones for this system.

- 1 Turn the Bluetooth® connection setting of your cellular phone on.
- 2 Press the “MENU” button on the Remote Touch.
- 3 Select “Phone”.
- 4 Select “Yes” to register a phone.

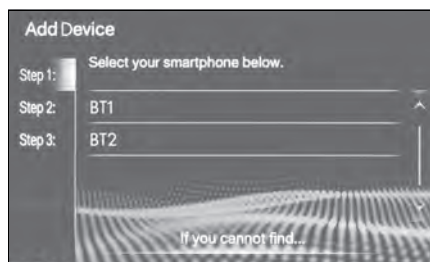

- 5 Select the desired Bluetooth® device.

- 6 Register the Bluetooth® device using your Bluetooth® device.



- 7 Check that the following screen is displayed, indicating pairing was successful.

- The system is connecting to the registered device.
- At this stage, the Bluetooth® functions are not yet available.

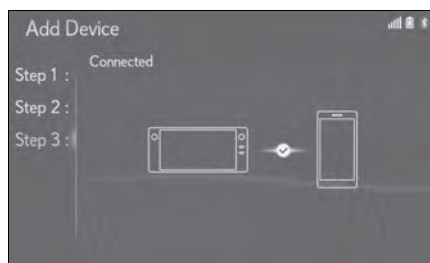

- 8 Check that “Connected” is displayed and registration is complete.

■ Contacts transfer

- 1 Display the phone settings screen:
 - “MENU” button → “Setup” →  “Phone” on the sub menu
- 2 Select “Contacts/Call History”.

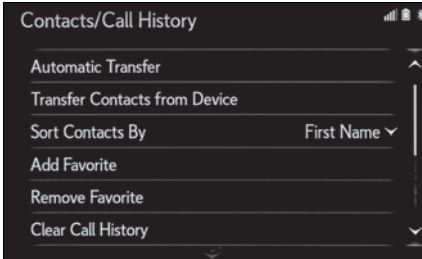

- 3 Select “Transfer Contacts from Device”.
- 4 Select “From Phone (Bluetooth)”.
- 5 Transfer the contact data to the system using a Bluetooth[®] phone.
- 6 Check that a confirmation screen is displayed when the operation is complete.

Depending on the type of Bluetooth[®] phone, certain functions may not be available.

■ Registering the contacts in the favorites list

- 1 Display the phone settings screen:
 - “MENU” button → “Setup” →  “Phone” on the sub menu
- 2 Select “Contacts/Call History”.

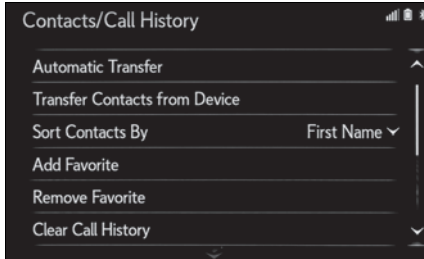



- 3 Select “Add Favorite”.
- 4 Select the desired contact to add to the favorites list.
- 5 Check that a confirmation screen is displayed when the operation is complete.

■ Calling by favorites list

- 1 Press the “MENU” button on the Remote Touch.
- 2 Select “Phone”.
- 3 Select  “Favorites” on the sub menu and select the desired contact.
- 4 Select the desired number.
- 5 Check that the dialing screen is displayed.

■ Calling the message sender

- 1 Display the message screen:
 - “MENU” button → “Phone” →  “Message” on the sub menu
- 2 Select a desired account name that is displayed on the left side of screen.
- 3 Select the desired message from the list.
- 4 Select , or press the  switch on the steering wheel.
- 5 Check that the dialing screen is displayed.

■ Receiving a call

Select "Answer" or press the  switch on the steering wheel to talk on the phone.

► Main display

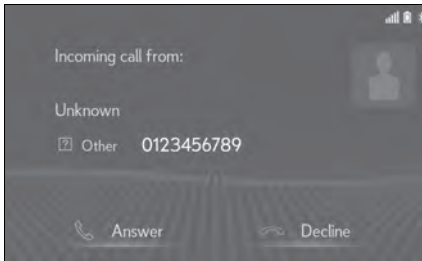

► Side display

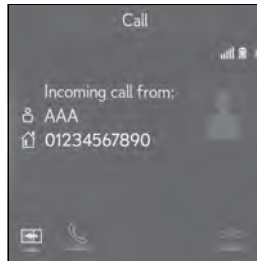

"Decline": Select to refuse to receive the call.

■ Steering switches

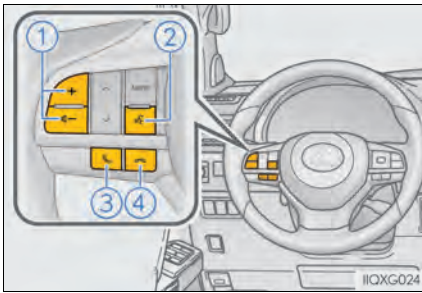

- ① Volume control switch
 - Press the "+" side to increase the volume.
 - Press the "-" side to decrease the volume.
- ② Talk switch
 - Press the talk switch to start the voice command system.
 - To cancel voice recognition, press and hold the talk switch.

③ Off hook switch

- Start talking
- Press to put a call on hold.
- Depending on the system, if the switch is pressed when an Apple CarPlay connection is established, the Apple CarPlay phone application will be displayed on the system screen.*

④ On hook switch

- Press to end talking/dialing.
- Press to refuse to receive the call.

*: This function is not made available in some countries or areas.

Audio System

Audio control screen

The audio control screen can be reached by the following methods:

▶ Using the audio control switch

Press the "RADIO" or "MEDIA" button.

▶ Using the Remote Touch

Press the "MENU" button on the Remote Touch, then select "Audio".

Selecting an audio source

▶ Using the audio control switch

1 Press the "RADIO" or "MEDIA" button.

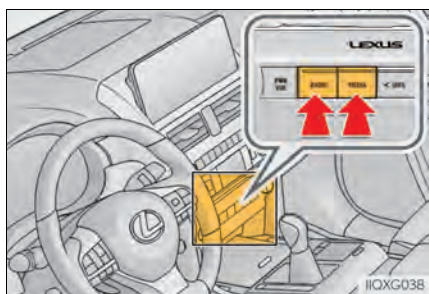

2 "RADIO" button: Press to change radio modes.

"MEDIA" button: Press to change media modes.

Each time the "RADIO" or "MEDIA" button is pressed, the audio source changes.

▶ From the audio source selection screen

1 Display the audio control screen.

2 Select  "Source" on the sub menu.

3 Select the desired source.

Steering switch operation

Some parts of the audio/visual system can be adjusted using the switches on the steering wheel.

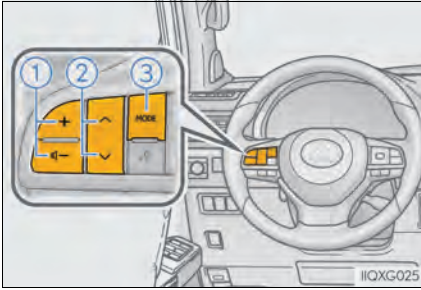

① Volume control switch

② ∨ ∨ switch

③ "MODE" switch

Volume control switch

- Press: Volume up/down
- Press and hold (0.8 sec. or more): Volume up/down continuously

∨ ∨ switch

▶ AM, FM, HD

- Press: Preset station up/down
- Press and hold (0.8 sec. or more): Seek up/down
- Press and hold (1.5 sec. or more): Seek up/down continuously while the switch is being pressed

▶ SXM*1

- Press: Preset channel up/down
- Press and hold (0.8 sec. or more): Seek for stations in the relevant program type/channel category
- Press and hold (1.5 sec. or more): Seek for the channel while the switch is being pressed

▶ CD

- Press: Track up/down
- Press and hold (0.8 sec. or more): Fast forward/rewind

▶ MP3/WMA/AAC disc

- Press: File up/down
- Press and hold (0.8 sec. or more): Fast forward/rewind

▶ DVD

- Press: Chapter up/down
- Press and hold (0.8 sec. or more): Fast forward/rewind

▶ USB*2,3

- Press: File/Track up/down
- Press and hold (0.8 sec. or more): Fast forward/rewind

▶ iPod/iPhone*3

- Press: Track up/down
- Press and hold (0.8 sec. or more): Fast forward/rewind

▶ **Android Auto**^{*2}

- Press: Track up/down

▶ **Bluetooth® audio**^{*2,3}

- Press: Track up/down
- Press and hold (0.8 sec. or more): Fast forward/rewind

*1: This function is not made available in some countries or areas.

*2: When an Apple CarPlay connection is established, this function will be unavailable.

*3: When an Android Auto connection is established, this function will be unavailable.

■ **“MODE” switch**

▶ **AM, FM, SXM**^{*1}

- Press: Change audio modes
- Press and hold (0.8 sec. or more): Mute^{*2} (Press and hold again to resume the sound.)

▶ **AUX**

- Press: Change audio modes
- Press and hold (0.8 sec. or more): Mute

▶ **CD, MP3/WMA/AAC disc, DVD, USB^{*3, 4}, iPod/iPhone^{*4}, Android Auto^{*3}, Bluetooth® audio^{*3,4}, APPS^{*3,4}**

- Press: Change audio modes
- Press and hold (0.8 sec. or more): Pause

*1: This function is not made available in some countries or areas.

*2: If cached radio is enabled, pressing and holding the “MODE” switch pauses the broadcast. (Press and hold again to play back the cached radio program.)

*3: When an Apple CarPlay connection is established, this function will be unavailable.

*4: When an Android Auto connection is established, this function will be unavailable.

Radio

Audio control switch

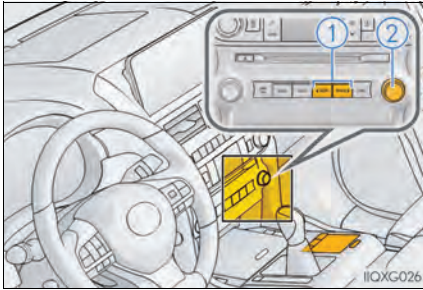

- 1 Press to seek up/down.
- 2 Turn to step up/down frequencies/channels.
Turn to move up/down the list.

Control screen

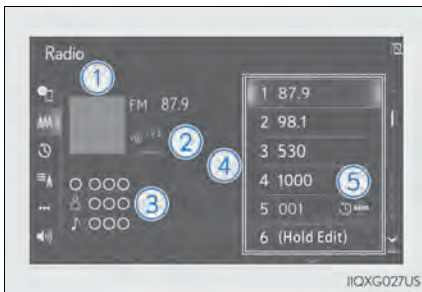

- 1 Displays cover art.*
- 2 Select to display HD) multicast channels available.*
- 3 Displays the artist info and song title or album and genre. Select to change the displayed information. Displays messages when available from RBDS.*
- 4 Select to tune to preset stations/channels.
- 5 Display items on the channels registered to smart favorites.*

*: This function is not made available in some countries or areas.

Presetting a station

Radio mode has a mix preset function, which can store up to 36 stations (6 stations per page x 6 pages) from any of the AM, FM or SXM bands.

- 1 Tune in the desired station.



- 2 Select and hold "(Hold Edit)".
To change the preset station to a different one, select and hold the preset station.

■ CD

■ Audio control switch

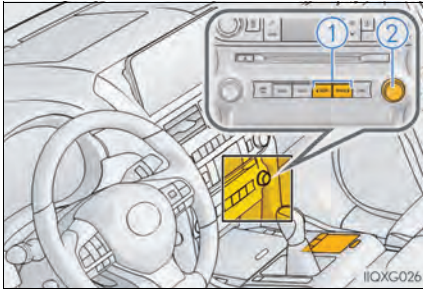

- ① Press to select a track/file.
Press and hold to fast forward/rewind.
- ② Turn to select a track/file.
Turn to move up/down the list.

■ Control screen

▶ Audio CD



- ① Displays cover art.
- ② Select to set repeat playback.
- ③ Select to change the track.
Select and hold to fast rewind.
- ④ Select to play/pause.
- ⑤ Select to change the track.
Select and hold to fast forward.
- ⑥ Select to set random playback.

▶ MP3/WMA/AAC disc



- ① Displays cover art.
- ② Select to change the folder.
- ③ Select to set repeat playback.
- ④ Select to change the file.
Select and hold to fast rewind.
- ⑤ Select to play/pause.
- ⑥ Select to change the file.
Select and hold to fast forward.
- ⑦ Select to set random playback.

■ DVD

■ Audio control switch

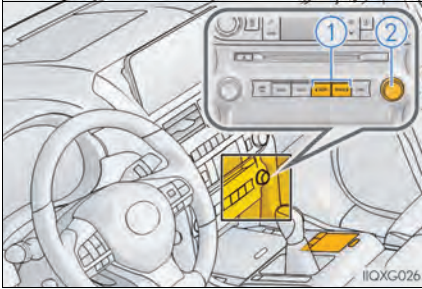

- ① Press to select a chapter.
Press and hold to fast forward/rewind.
- ② Turn to select a chapter.

■ Control screen

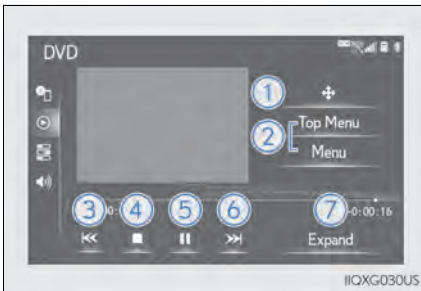

- ① Select to display the menu control key.
- ② Select to display the menu screen.
- ③ Select to change the chapter.
Select and hold to fast rewind.
- ④ Select to stop the video screen.
- ⑤ Select to play/pause.
- ⑥ Select to change the chapter.
During playback: Select and hold to fast forward.
During a pause: Select and hold to slow forward.
- ⑦ Select to display expanded screen video.

■ iPod/iPhone (Apple CarPlay*)

*: This function is not made available in some countries or areas.

■ Audio control switch

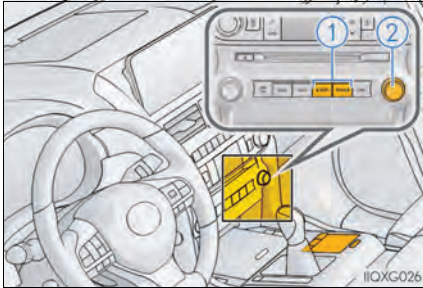

- ① Press to select a track.
Press and hold to fast forward/rewind.
- ② Turn to select a track.
Turn to move up/down the list.

■ Control screen

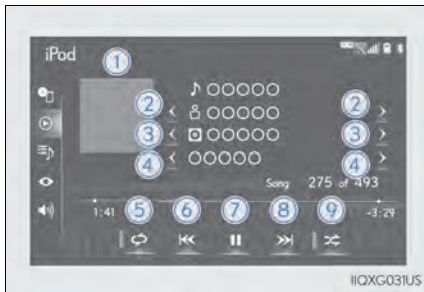

- ① Displays cover art.
- ② Select to change the artist*.
- ③ Select to change the album*.
- ④ Select to change the playlist*.
- ⑤ Select to set repeat playback.
- ⑥ Select to change the track.
Select and hold to fast rewind.
- ⑦ Select to play/pause.
- ⑧ Select to change the track.
Select and hold to fast forward.
- ⑨ Select to set random playback.

*: When an Apple CarPlay connection is established, this switch will not be displayed.

Front Automatic Air Conditioning System

Control panel

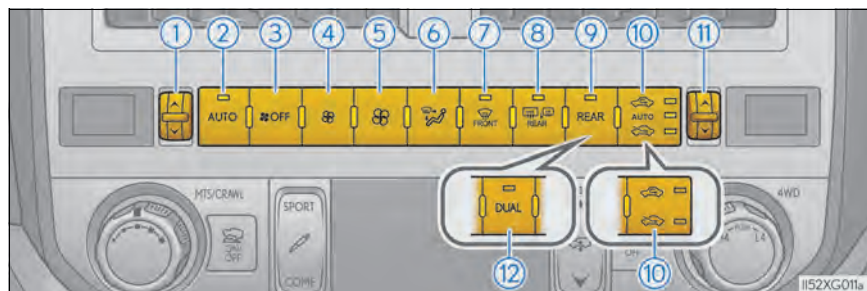

- ① Left-hand side temperature control switch
- ② Automatic mode switch
- ③ OFF switch
- ④ Fan speed decrease switch
- ⑤ Fan speed increase switch
- ⑥ Airflow mode control switch
- ⑦ Windshield defogger switch
- ⑧ Rear window defogger and outside rear view mirror defoggers switch
- ⑨ REAR switch
- ⑩ Outside/recirculated air mode switch
- ⑪ Right-hand side temperature control switch
- ⑫ DUAL switch

■ Control screen

■ Main control screen

Using the touchpad of the Remote Touch, select the button on the screen.
This system can also be operated by the touch screen.

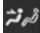

- ① Sub menu
Selecting the sub menu item to switch the main screen.

: Display the air conditioning control screen

: Display the rear air conditioning control screen (vehicles with "3-ZONE" mode) (→P. 61)

: Display the option control screen

- ② Adjust the left-hand side temperature setting
③ Adjust the fan speed setting
④ Select the air flow mode

: Air flows to the upper body

: Air flows to the upper body and feet

: Air flows to the feet

: Air flows to the feet and the windshield defogger operates

- ⑤ Adjust the right-hand side temperature setting
⑥ Function on/off indicators
When the function is on, the indicator illuminates on the control screen.

- ⑦ Sub function menu
When the sub function button on the Remote Touch is pressed, the following functions can be switched on and off.

"AUTO": Set automatic mode on/off (→P. 59)

"Off": Turn the fan off

"A/C": Set cooling and dehumidification function

"DUAL" (if equipped): Adjust the temperature for driver and front passenger seats separately ("DUAL" mode) (→P. 60)

"3-ZONE" (if equipped): Adjust the temperature for the driver, front passenger and rear seats separately ("3-ZONE" mode) (→P. 60)

■ Adjusting the temperature setting

Operate the temperature control switch upwards to increase the temperature and downwards to decrease the temperature.

If the "A/C" indicator is turned off, the system will blow ambient temperature air or heated air.

■ Adjusting the fan speed setting

Operate the fan speed increase switch to increase the fan speed and the fan speed decrease switch to decrease the fan speed.

Press the OFF switch to turn the fan off.

■ Changing the air flow mode

Press the airflow mode control switch.

The mode changes as follows each time the switch is pressed. (→P. 56, 57)

■ Option control screen

Select  on the sub menu to display the option control screen.

The functions can be switched on and off.

When the function is on, the indicator illuminates on the screen.



- ① Adjust the temperature for the driver and front passenger seats separately
 - "DUAL" (if equipped) (→P. 60)
 - "3-ZONE" (if equipped) (→P. 60)
- ② Cooling and dehumidification function
- ③ Prevent ice from building up on the windshield and wiper blades (Windshield wiper de-icer) (if equipped)
- ④ Removing pollen from the air (Micro dust and pollen filter)

■ Side display

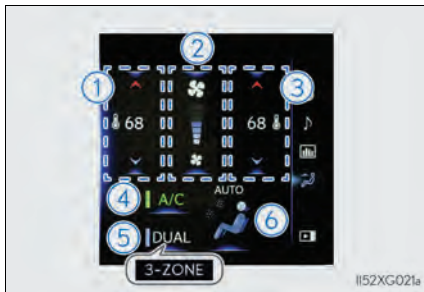

- ① Adjust the left-hand side temperature setting
- ② Adjust the fan speed setting
- ③ Adjust the right-hand side temperature setting
- ④ Set cooling and dehumidification function on/off
- ⑤ Adjust the temperature for the driver's and front passenger's seats separately
 - "DUAL" (if equipped) (→P. 60)
 - "3-ZONE" (if equipped) (→P. 60)
- ⑥ Select the air flow mode

■ Using automatic mode

- 1 Press the automatic mode switch or select "AUTO" on the sub function menu. (→P. 56, 57)
- 2 Press the outside/recirculated air mode switch to switch to automatic air intake mode. (if equipped)
The air conditioning system automatically switches between outside air and recirculated air modes.
- 3 Adjust the temperature setting.
- 4 To stop the operation, press the OFF switch or select "Off" on the sub function menu. (→P. 56, 57)
If the fan speed setting or air flow modes are operated, the automatic mode indicator goes off. However, automatic mode for functions other than that operated is maintained.

■ Adjusting the temperature for driver and passenger seats separately

▶ Vehicles with “DUAL” mode

Adjust the temperature for driver and passenger seats separately.

While in “DUAL” mode, the temperature of the rear air outlets is set at the passenger’s side temperature setting.

To turn on the “DUAL” mode, perform any of the following procedures:

- Press the DUAL switch. (→P. 56)
- Select “DUAL” on the sub function menu. (→P. 57)
- Select “DUAL” on the option control screen. (→P. 58)
- Select “DUAL” on the side display. (→P. 59)
- Adjust the front passenger’s side temperature setting.

The indicator on the main control screen comes on when the “DUAL” mode is on.

▶ Vehicles with “3-ZONE” mode

Adjust the temperature for the driver, front passenger and rear passenger seats separately.

To turn on the “3-ZONE” mode, perform any of the following procedures:

- Select “3-ZONE” on the sub function menu. (→P. 57)
- Select “3-ZONE” on the option control screen. (→P. 58)
- Select “3-ZONE” on the side display. (→P. 59)
- Adjust any passenger seat temperature.

The indicator on the main control screen comes on when the “3-ZONE” mode is on.

Rear Air Conditioning System (if equipped)

Control panel

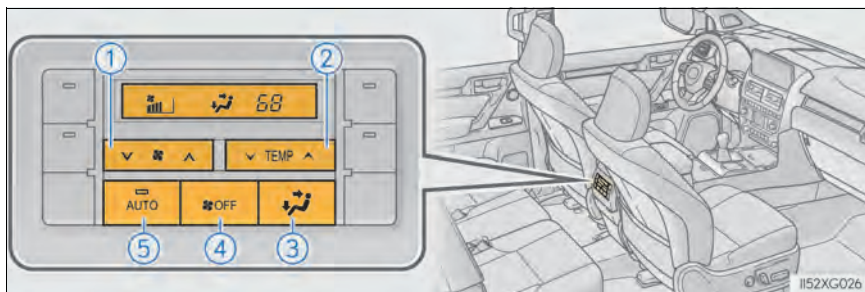

- ① Rear fan speed setting switch
- ② Rear temperature setting switch
- ③ Airflow mode select switch
- ④ OFF switch
- ⑤ Automatic mode switch

When the function is on, the indicator illuminates on the control screen.

Rear air conditioning control screen (if equipped)

Using the touchpad of the Remote Touch, select the button on the screen. This system can also be operated by the touch screen.

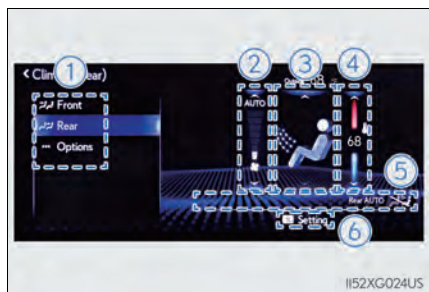



- ① Sub menu
Selecting the sub menu item to switch the main screen.

: Display the air conditioning control screen

: Display the rear air conditioning control screen

: Display the option control screen

- ② Adjust the fan speed setting
- ③ Select the air flow mode
 - : Air flows to the upper body
 - : Air flows to the upper body and feet
 - : Air flows to the feet
- ④ Adjust the temperature setting

⑤ Function on/off indicators

When the function is on, the indicator illuminates on the control screen.

⑥ Sub function menu

When the sub function button on the Remote Touch is pressed, the following functions can be switched on and off.

“Rear AUTO”: Set automatic mode on/off

“Rear Off”: Turn the fan off



: Disables operation of the rear air conditioning system using the Rear air conditioning system control panel.

■ **Adjusting the temperature setting**

Press “^” on the rear temperature setting switch to increase the temperature and “v” to decrease the temperature.



Select on the sub menu to display the option control screen. (→P. 61)

If the “A/C” indicator is turned off, the system will blow ambient temperature air or heated air.

■ **Adjusting the fan speed setting**

Press “^” on the rear fan speed setting switch to increase the fan speed and “v” to decrease the fan speed.

Press the OFF switch to turn the fan off.

■ **Changing the air flow mode**

Press the airflow mode select switch.

The air flow mode change as follows each time the airflow mode select switch is pressed.



: Air flows to the upper body.



: Air flows to the upper body and feet.



: Air flows to the feet.

■ **Using automatic mode**

■ **Using the automatic mode**

- 1 Press the automatic mode switch.
- 2 Adjust the temperature setting.
- 3 To stop the operation, press the OFF switch.

■ **If the system is operated manually in automatic mode**

If the fan speed setting or air flow modes are operated, the automatic mode indicator goes off. However, automatic mode for functions other than that operated are maintained.

Voice Command System

The voice command system enables the radio, phone dialing, etc. to be operated using voice commands. Refer to the command list for samples of voice commands.

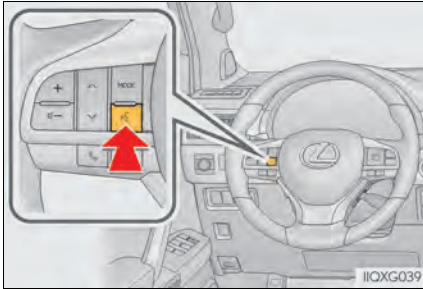

- 1** Press the talk switch.
Voice guidance for the voice command system can be skipped by pressing the talk switch.

- 2** If “Getting Started with Voice” screen is displayed, select “OK” or press the talk switch.
- 3** After hearing a beep, say a supported command.
 - To display sample commands of the desired function, say the desired function or select the desired function button. To display more commands, select “More Commands”.
 - Selecting “Help” or saying “Help” prompts the voice command system to offer examples of commands and operation methods.
 - Registered POIs, registered names in the contacts list etc., can be said in the place of the “<>” next to the commands.

Continue on to pages 64-69 for a detailed list of Voice Commands for the following categories:

Common	P. 64
Top menu	P. 64
Navigation	P. 65
Phone.....	P. 66
Radio	P. 67
Audio	P. 67
Info	P. 68
Apps.....	P. 68
Climate	P. 69

■ Command list

■ Common

Command	Action
"Help"	Displays examples of some of the available commands
"Go Back"	Returns to the previous screen
"Cancel"	Cancels the voice command system
"Start over"	Returns to top menu screen
"Pause"	Temporarily pauses a voice session until it is resumed by pressing the talk switch again.

■ Top menu

Command	Action
"Show command examples for <menu>"	Displays the command list of the selected menu
"More Commands"	Displays more commonly used commands
"Voice Settings"	Displays Voice Setting screen
"Train my voice"	Displays Train Voice Recognition screen*

*: Vehicle must be parked

Navigation

Command	Action
"Get directions to <house #, street, city, state>"*1	Enables setting a destination by saying the address*2,3
"Find a <POI category/POI name>"	Displays a list of <POI category*4/POI name*5> near the current position
"Find a <POI> near my destination"	Displays a list of <POI> near the destination
"Find a <POI category> in a city"*1	Displays a list of <POI> in a specified city and state*3
"Go Home"	Displays the route to home
"Go to Favorite <1-10>"	Sets the location registered to the corresponding favorite number as the destination
"Show Recent Destinations"	Displays recent destinations. Selecting a number from the list will start navigation to the selected recent destination.
"Cancel Route"	Cancels the route guidance
"Delete destinations"	Displays a list of destination to delete*6
"Show <POI category> icons"	Displays the specified point of interest category*4 icons on the map
"Destination Assist"	Connects the system to the Lexus response center

*1: English and French only

*2: Best recognition results occur when saying the full address without the zipcode

*3: When the language is set to French, the supported area is only Quebec Province in Canada

*4: For example; "Gas stations", "Restaurants", etc.

*5: Major national brands are always supported. Local brands are also supported with a subscription to the Lexus Enform. Contact your Lexus dealer for details.

*6: Used when multiple destinations are set on a route

Phone

Command	Action
"Call <contact>"*	Places a call to the specified contact from the phone book
"Call <contact> <phonetype>"*	Places a call to the specified phone type of the contact from the phone book
"Dial <phone number>"	Places a call to the specified phone number
"Redial"	Places a call to the phone number of the latest outgoing call
"Call Back"	Places a call to the phone number of latest incoming call
"Show Recent Calls"	Displays the call history screen
"Send a message to <contacts>"	Sends a text message to specified contact from the phone book

*: If the system does not recognize the name of a contact, create a voice tag. The name of a contact can also be recognized by adding a voice tag.

While in a phone call

Command	Action
"Send <digits>"	Sends DTMF tones has specified
"Mute"	Mutes the microphone (far side cannot hear the conversation)
"Unmute"	Unmutes the microphone

While an incoming message is displayed*

Command	Action
"Read Message"	Reads the incoming message over the vehicle speakers
"Ignore"	Ignores the incoming message notification
"Reply"	Initiates sending a reply to the incoming message
"Call"	Places a call to the phone number of incoming message

*: Full screen message notification must be turned on within the phone settings

Radio

Command	Action
"Tune to <frequency> AM"	Changes the radio to the specified AM frequency
"Tune to <frequency> FM"	Changes the radio to the specified FM frequency
"Play a <genre> station"	Changes the radio to an FM station of the specified genre ^{*1}
"Tune to preset <1-36>"	Changes the radio to the specified preset radio station
"Tune to a <genre> satellite station"	Changes the radio to a satellite radio channel of the specified genre ^{*2}
"Tune to <satellite channel name>"	Changes the radio to the satellite radio channel with the specified name ^{*2}
"Tune to channel <number> on XM"	Changes the radio to a satellite radio channel of the specified number ^{*2}

*1: A station list must be built first using the radio screen

*2: Requires a satellite radio subscription

Audio*

Command	Action
"Play Playlist <name>"	Plays tracks from the selected playlist
"Play Artist <name>"	Plays tracks from the selected artist
"Play Song <name>"	Plays the selected track
"Play Album <name>"	Plays tracks from the selected album
"Play Genre <name>"	Plays tracks from the selected genre
"Play Composer <name>"	Plays tracks from the selected composer
"Play Podcast <name>"	Plays tracks from the selected podcast
"Play Audiobook <name>"	Plays tracks from the selected audiobook
"Audio On"	Turns the audio system on
"Audio Off"	Turns the audio system off
"Change the audio source to <source name>"	Sets the source to the specified audio mode

*: The audio device must be connected via a USB cable to use the functionality in this section

■ Info*1

Command	Action
"Get the Forecast"	Displays weather information
"Get the Forecast for <city>"*2	Displays weather for the specified city
"Show Traffic"	Displays traffic information
"Show Traffic near here"	Displays traffic information near your current location
"Get traffic along my route"	Displays traffic information along your current route
"Show Traffic on this street"	Displays traffic information along road you are currently driving on
"Show Traffic for saved route"	Displays traffic information for a saved route
"Show Predictive Traffic"	Displays the predictive traffic map

*1: This function is not made available in some countries, areas, or on some models.

*2: Only major US cities are supported by voice

■ Apps*1

Command	Action
"Launch <apps>"*2	Activates the Lexus Enform App Suite 2.0 application

*1: This function is not made available in some countries or areas.

*2: When an application is opened and is in full screen mode, pressing the talk switch will start the voice command system and commands for the currently displayed application will be available

■ Climate

Command	Action
"Turn the AC on/Turn the AC off"	Turns air conditioning system on or off
"Change the Fan speed to <#>"	Changes the set fan speed of the air conditioning system to <#>
"Set temperature to <#> degrees"	Changes the set temperature of the air conditioning system to <#> degrees ^{*1}
"Increase Temperature/Decrease Temperature"	Increases or decreases the temperature of the air conditioning system
"Increase Fan speed/Decrease Fan speed"	Increases or decreases the fan speed of the air conditioning system
"Show the front climate control screen/Show the rear climate control screen" ^{*2}	Displays the screen to control the air conditioning system

*1: Only within the possible temperature range of the air conditioning system

*2: If equipped

USB/AUX Ports

There are 2 USB ports and an AUX port in the center console.



1 Slide the lid.



2 Connect a device.

- Turn on the power of the device if it is not turned on.

Garage Door Opener

The garage door opener can be programmed to operate garage doors, gates, entry doors, door locks, home lighting systems, security systems, and other devices.

HomeLink® programming procedure

The programming procedures can also be found at the following URL.

Website: www.homelink.com/lexus



The word “QR Code” is registered trademark of DENSO WAVE INCORPORATED in Japan and other countries.

For support, contact customer support at the following.

Help Line: 1-800-355-3515

Programming HomeLink®

The HomeLink® wireless control system in your vehicle has 3 buttons which can be programmed to operate 3 different devices. Refer to the programming methods on the following pages to determine the method which is appropriate for the device.

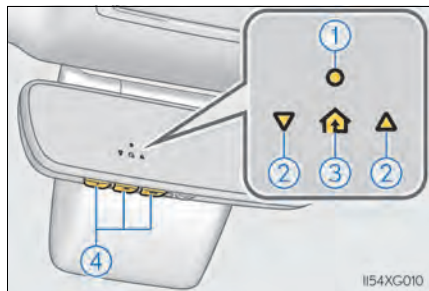

① HomeLink® indicator light

② Garage door operation indicators

③ HomeLink® icon

Illuminates while HomeLink® is operating.

④ Buttons

Before programming HomeLink®

- During programming, it is possible that garage doors, gates, or other devices may operate. For this reason, make sure that people and objects are clear of the garage door or other devices to prevent injury or other potential harm.
- It is recommended that a new battery be placed in the remote control transmitter for more accurate programming.
- Garage door opener motors manufactured after 1995 may be equipped with rolling code protection. If this is the case, you may need a stepladder or other sturdy, safe device to reach the “Learn” or “Smart” button on the garage door opener motor.

■ Programming the HomeLink®

Steps **1** through **3** must be performed within 60 seconds, otherwise the indicator light will stop flashing and programming will not be able to be completed.

1 Press and release the HomeLink® button you want to program and check that the HomeLink® indicator light flashes (orange).

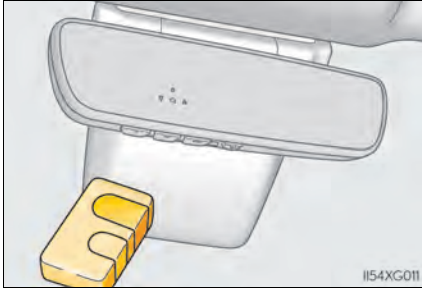

2 Point the remote control transmitter for the device at the rear view mirror, 1 to 3 in. (25 to 75 mm) from the HomeLink® buttons.

Keep the HomeLink® indicator light in view while programming.

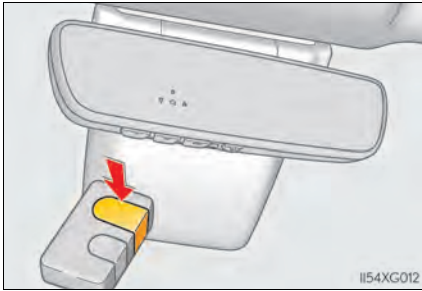

3 Program a device.

► **Programming a device other than an entry gate (for U.S.A. owners)**

Press and hold the remote control transmitter button until the HomeLink® indicator light changes from slowly flashing orange to rapidly flashing green (rolling code) or continuously lit green (fixed code), then release the button.

► **Programming an entry gate (for U.S.A. owners)/Programming a device in the Canadian market**

Press and release the remote control transmitter button at 2 second intervals, repeatedly, until the HomeLink® indicator light changes from slowly flashing (orange) to rapidly flashing (green) (rolling code) or continuously lit (green) (fixed code).

- 4** Test the HomeLink[®] operation by pressing the newly programmed button and observing the indicator light:
 - Indicator light illuminates: Programming of a fixed code device has completed. The garage door or other device should operate when a HomeLink[®] button is pressed and released.
 - Indicator light flashes rapidly: The garage door opener motor or other device is equipped with a rolling code. To complete programming, firmly press and hold the HomeLink[®] button for 2 seconds then release it.
 - If the garage door or other device does not operate, proceed to "Programming a rolling code system".
- 5** Repeat the steps above to program another device for any of the remaining HomeLink[®] buttons.

■ Programming a rolling code system

2 or more people may be necessary to complete rolling code programming.

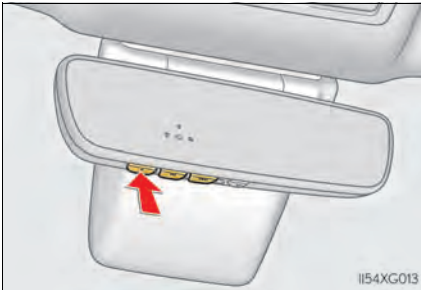
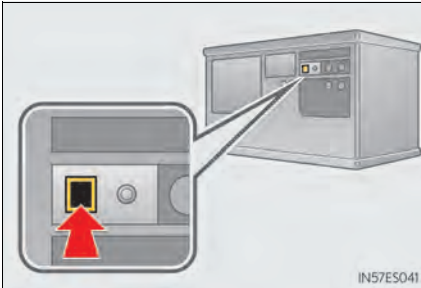
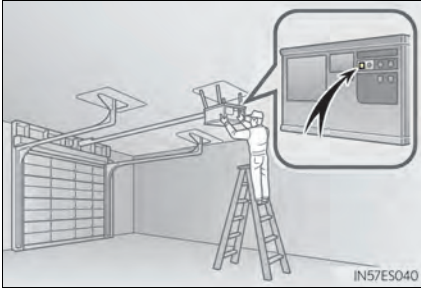

- 1** Locate the “Learn” or “Smart” button on the garage door opener motor in the garage.

This button can usually be found where the hanging antenna wire is attached to the unit. The name and color of the button may vary by manufacturer. Refer to the owner’s manual supplied with the garage door opener motor for details.

- 2** Press and release the “Learn” or “Smart” button.

Perform **3** within 30 seconds after performing **2**.

- 3** Press and hold the desired HomeLink[®] button (inside the vehicle) for 2 seconds and release it. Repeat this sequence (press/hold/release) up to 3 times to complete programming. If the garage door opener motor operates when the HomeLink[®] button is pressed, the garage door opener motor recognizes the HomeLink[®] signal.

LEXUS Enform Safety Connect (if equipped)

Safety Connect is a subscription-based telematics service that uses Global Positioning System (GPS) data and embedded cellular technology to provide safety and security features to subscribers. Safety Connect is supported by Lexus' designated response center, which operates 24 hours per day, 7 days per week.

Safety Connect service is available by subscription on select, telematics hardware-equipped vehicles.

System components

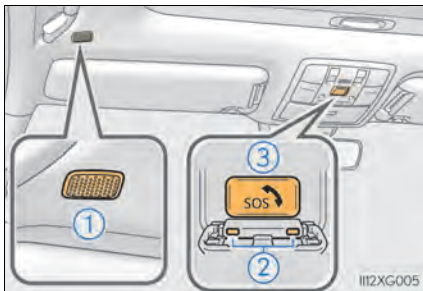

- ① Microphone
- ② LED light indicators
- ③ "SOS" button

Services

Subscribers have the following Safety Connect services available:

● Automatic Collision Notification*

In case of either airbag deployment or severe rear-end collision, the system is designed to automatically call the response center. The responding agent receives the vehicle's location and attempts to speak with the vehicle occupants to assess the level of emergency. If the occupants are unable to communicate, the agent automatically treats the call as an emergency, contacts the nearest emergency services provider to describe the situation, and requests that assistance be sent to the location.

*: U.S. Patent No. 7,508,298 B2

● Stolen Vehicle Location

If your vehicle is stolen, Safety Connect can work with local authorities to assist them in locating and recovering the vehicle. After filing a police report, call the Safety Connect response center at 1-800-25-LEXUS (1-800-255-3987) in the United States, 1-877-539-8777 in Puerto Rico or 1-800-265-3987 in Canada, and follow the prompts for Safety Connect to initiate this service.

In addition to assisting law enforcement with recovery of a stolen vehicle, Safety-Connect-equipped vehicle location data may, under certain circumstances, be shared with third parties to locate your vehicle. Further information is available at Lexus.com.

- **Emergency Assistance Button (SOS)**

In the event of an emergency on the road, push the “SOS” button to reach the Safety Connect response center. The answering agent will determine your vehicle’s location, assess the emergency, and dispatch the necessary assistance required.

If you accidentally press the “SOS” button, tell the response-center agent that you are not experiencing an emergency.

- **Enhanced Roadside Assistance**

Enhanced Roadside Assistance adds GPS data to the already included warranty-based Lexus roadside service.

Subscribers can press the “SOS” button to reach a Safety Connect response-center agent, who can help with a wide range of needs, such as: towing, flat tire, fuel delivery, etc.

For a description of the Roadside Assistance services and their limitations, please see the Safety Connect Terms and Conditions, which are available at Lexus.com.

■ **Subscription**

After you have signed the Telematics Subscription Service Agreement and are enrolled, you can begin receiving services.

A variety of subscription terms is available for purchase. Contact your Lexus dealer, call the following or push the “SOS” button in your vehicle for further subscription details.

- **The United States**

1-800-25-LEXUS (1-800-255-3987)

- **Canada**

1-800-26-LEXUS (1-800-265-3987)

- **Puerto Rico**

1-877-539-8777

Lexus Enform Remote (if equipped)

The functionality of Lexus Enform Remote and Lexus Enform Service Connect are made possible by the use of a DCM and a smart phone.

For details about these services, refer to <http://www.lexus.com/enform/>.

■ Subscription

After you sign the Telematics Subscription Service Agreement, download the Lexus App from your smart phone's app store, and register within the app (or enroll and complete registration at the dealer), you can begin using these services.

A variety of subscription terms are available. Contact your Lexus dealer, or call 1-800-25-LEXUS (1-800-255-3987) for further subscription details.

Lexus Enform Service Connect (if equipped)

Lexus Enform Service Connect uses DCM (Data Communication Module) to collect and transmit vehicle data that allows Lexus to provide:

- Vehicle Health Report (VHR) (Safety Recalls, Service Campaigns, Current Vehicle Alerts, Required Maintenance, and Vehicle Condition Status)
- Maintenance Notifications
- Vehicle Alert Notifications

The functionality of Lexus Enform Remote and Lexus Enform Service Connect are made possible by the use of a DCM and a smart phone.

For details about these services, refer to <http://www.lexus.com/enform/>.

SiriusXM Satellite Radio

Most in-car trials today include SiriusXM's best package—All Access. It includes every channel available on your radio, plus streaming.

For details, refer to the "NAVIGATION SYSTEM OWNER'S MANUAL".

■ Subscription

All SiriusXM services, including satellite radio and data services, plus streaming services, require a subscription, sold separately or as a package by Sirius XM Radio Inc. (or, in Canada, Sirius XM Canada Inc.), after any trial subscription which may be included with your vehicle purchase or lease. To subscribe after your trial subscription, call 1-877-447-0011 (U.S.A.) or 1-877-438-9677 (Canada).

Door Locks

The vehicle can be locked and unlocked using the entry function, wireless remote control, key or door lock switch.

For details the entry function or wireless remote control (→P.11, 12)

■ Door lock switches

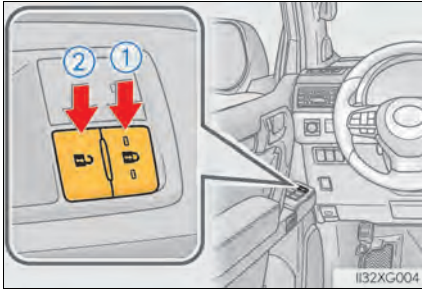

- ① Locks all the doors
- ② Unlocks all the doors

■ Inside lock buttons

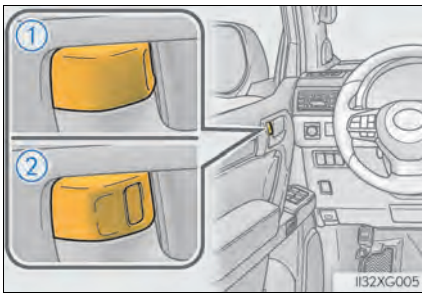

- ① Locks the door
 - ② Unlocks the door
- The front doors can be opened by pulling the inside handles even if the lock buttons are in the lock position.

■ Rear door child-protector lock

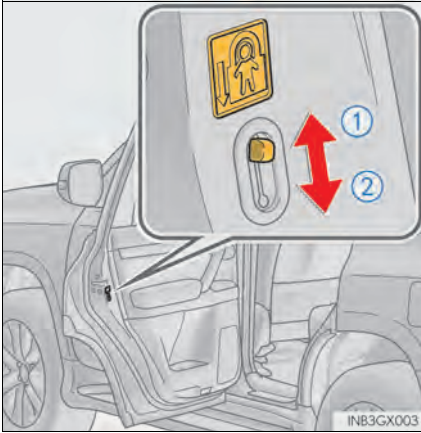

The door cannot be opened from inside the vehicle when the lock is set.

- ① Unlock
- ② Lock

These locks can be set to prevent children from opening the rear doors. Push down on each rear door switch to lock both rear doors.

■ Power Windows

■ Power window switches

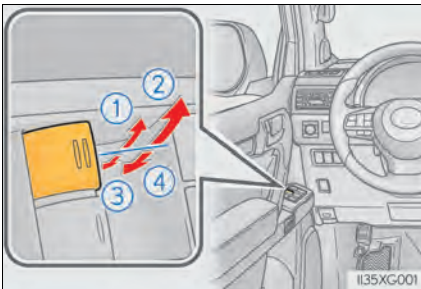

- ① Closing
- ② One-touch closing*
- ③ Opening
- ④ One-touch opening*

*: To stop the window partway, operate the switch in the opposite direction.

■ Window lock switch

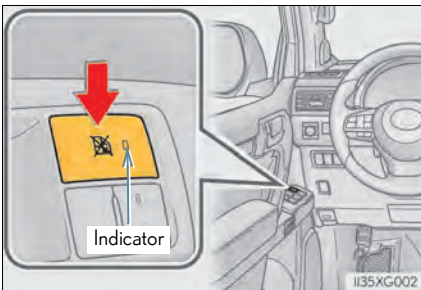

Press the switch down to lock the passenger window switches.

The indicator will come on.

Use this switch to prevent children from accidentally opening or closing a passenger window.

The passenger windows can still be opened and closed using the power window switches on the driver's side even if the lock switch is on.

Moon Roof

■ Opening and closing

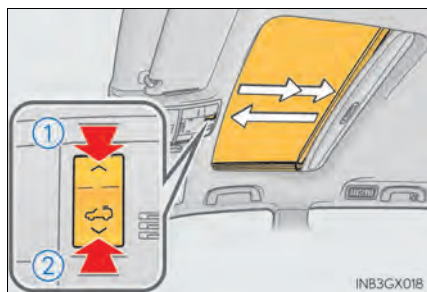

- ① Opens the moon roof*
The moon roof stops slightly before the fully open position to reduce wind noise.
Press the switch again to fully open the moon roof.

- ② Closes the moon roof*
*: Lightly press either end of the moon roof switch to stop the moon roof partway.

■ Tilting up and down

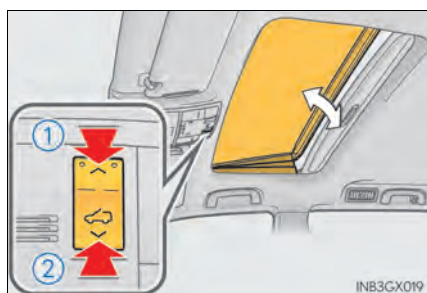

- ① Tilts the moon roof up*
- ② Tilts the moon roof down*
*: Lightly press either end of the moon roof switch to stop the moon roof partway.

Fuel Tank Cap

■ Before refueling the vehicle

- Turn the engine switch off and ensure that all the doors and windows are closed.
- Confirm the type of fuel.

■ Opening the fuel tank cap

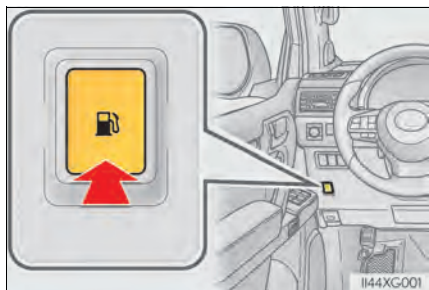

- 1** Press the opener to open the fuel filler door.

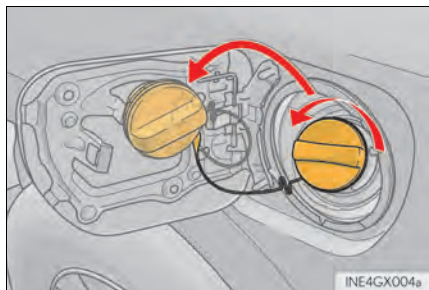

- 2** Turn the fuel tank cap slowly to open, and hang the fuel tank cap on the back of the fuel filler door.

What to do if ...

List of Warning/Indicator Lights

Immediately stop the vehicle in a safe place and contact your Lexus dealer.
Continuing to drive the vehicle may be dangerous.

BRAKE

(U.S.A.)

Brake system warning light



(Canada)

Immediately stop the vehicle in a safe place and contact your Lexus dealer.



Charging system warning light



Low engine oil pressure warning light*1

Have the vehicle inspected by your Lexus dealer immediately.



(U.S.A.)

Malfunction
indicator lamp



(Canada)



SRS warning light

KDSS

Kinetic dynamic suspension
system warning light

4LO

(Flashes)

Low speed four-wheel
drive indicator light



(Flashes)

Center differential lock
indicator light

ABS

(U.S.A.)

ABS warning light



(Canada)



(Blinking and then
continuously on)

Tire pressure warning light



(Flashes or
illuminates)

PCS warning light

PARK

(Flashes)

(U.S.A.)

Parking brake
indicator



(Flashes)

(Canada)



Slip indicator light

For further information, refer to the OWNER'S MANUAL.

What to do if ...

Follow the correction procedures.



Open door warning light



Low fuel level warning light



Driver's and front passenger's seat belt reminder light



(Illuminates without blinking)

Tire pressure warning light*³



LDA indicator*¹



Brake Override System warning light / Drive-Start Control warning light*¹

Stop and check.



High coolant temperature warning light*¹

For further information, refer to the OWNER'S MANUAL.

What to do if ...

See the OWNER'S MANUAL



Turn signal indicator



Headlight indicator

(U.S.A.)



Tail light indicator

(Canada)



Headlight high beam indicator



Automatic High Beam indicator



Fog light indicator *2



Eco Driving Indicator Light



Cruise control indicator *1



Cruise control "SET" indicator *1



Dynamic radar cruise control indicator *1



LDA indicator *1



LDA indicator *1

(Flashes)



Slip indicator



VSC OFF indicator



Multi-terrain Select indicator *1,2



Crawl Control indicator *1,2



Downhill assist control system indicator *2



"2nd STRT" indicator



Low speed four-wheel drive indicator light



Center differential lock indicator



Intuitive parking assist indicator



PCS warning light *4



Security indicator



Smart access system with push-button start indicator *1



BSM indicator



BSM (Blind Spot Monitor) outside rear view mirror indicators



Low outside temperature indicator *1

For further information, refer to the OWNER'S MANUAL.

What to do if ...

See the OWNER'S MANUAL



"PASSENGER AIR BAG" indicator lights



ROCK mode indicator *1,2



TRAC OFF indicator



LOOSE & ROCK mode indicator *1,2



MUD & SAND mode indicator *1,2



ROCK & DIRT mode indicator *1,2



MOGUL mode indicator *1,2



MTS AUTO indicator *1,2



Sport mode indicator *1,2



Comfort mode indicator *1,2

For further information, refer to the OWNER'S MANUAL.

*1: This light is displayed on the multi-information display.

*2: If equipped

*3: The tire pressure warning light may turn on due to natural causes such as natural air leaks or tire inflation pressure changes caused by temperature. In this case, adjusting the tire inflation pressure will turn off the warning light (after a few minutes).

*4: The light comes on when the system is turned off.

What to do if ...

If the electronic key does not operate properly

■ Unlocking and locking the doors

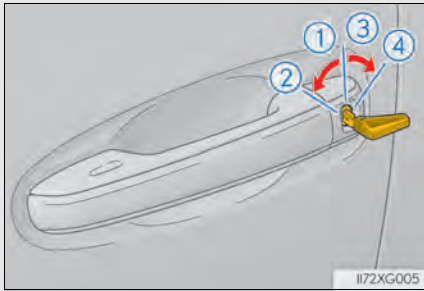

Use the mechanical key (→P.11) in order to perform the following operations (driver's door only):

- ① Locks all the doors
- ② Closes the windows and moon roof* (turn and hold)
- ③ Unlocks the doors
Turning the key rearward unlocks the driver's door. Turning the key once again unlocks the other doors.
- ④ Opens the windows and moon roof* (turn and hold)

*: These settings must be customized at your Lexus dealer.

What to do if ...

■ Starting the engine

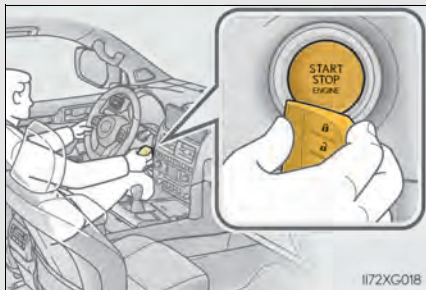

- 1** Ensure that the shift lever is in P and depress the brake pedal.
- 2** Touch the Lexus emblem side of the electronic key to the engine switch.
When the electronic key is detected, a buzzer sounds and the engine switch will turn to IGNITION ON mode.
When the smart access system with push-button start is deactivated in customization setting, the engine switch will turn to ACCESSORY mode.
- 3** Firmly depress the brake pedal and check that  is shown on the multi-information display.
- 4** Press the engine switch shortly and firmly.

In the event that the engine still cannot be started, contact your Lexus dealer.

If the electronic key battery becomes depleted, replace it with a new battery. For instructions on replacing the battery, refer to the "OWNER'S MANUAL". If you need further assistance, contact your Lexus dealer.

What to do if ...



If the engine does not start

Make sure that the correct operating procedures have been followed.

Brake pedal

Make sure that the brake pedal is firmly depressed when attempting to start the engine. (→P.15)

If the engine still does not start, see the "OWNER'S MANUAL" for more information or contact your Lexus dealer.

Memo

A large white rectangular area with horizontal ruling lines, intended for writing a memo. The lines are evenly spaced and extend across the width of the page.



Your Lexus dealer

Your Lexus dealer will provide quality maintenance and any other assistance you may require.

If there is not a Lexus dealer near you, please call the following number:

■ U.S. OWNERS

- In the U.S. mainland or Canada:

Lexus Roadside Assistance

1-800-25-LEXUS or 1-800-255-3987 (Toll-Free)

- In Hawaii:

Servco Automotive Roadside Assistance/Customer Services

1-800-25-LEXUS or 1-800-255-3987 (Toll-Free)

■ CANADIAN OWNERS

- In Canada or the U.S. mainland:

Lexus Roadside Assistance/Customer Service

1-800-26-LEXUS or 1-800-265-3987 (Toll-Free)

Please access our **websites** for further information.

- The U.S. mainland: www.lexus.com
- Hawaii: www.servcolexus.com
- Canada: www.lexus.ca

©2022 TOYOTA MOTOR CORPORATION

All rights reserved. This material may not be reproduced or copied, in whole or in part, without the written permission of Toyota Motor Corporation.



Owner's Manual Quick Guide:

Publication No. OM60U20U

Part No. 01999-60U20

Printed in Japan 01-2208-00 

GX 460 Owner's Manual Quick Guide (北米U)