

PLOT DATE: 7/16/2021 4:17 PM
 PLOT SCALE: 1"=50'
 DRAWING FILE: P:\2019\020622\02\Drawings\Civil\Construction Documents\Building_02019_020622_CE_C200_S016.dwg
 EDITED BY: MMINISLOW
 DATE: 7/16/2021

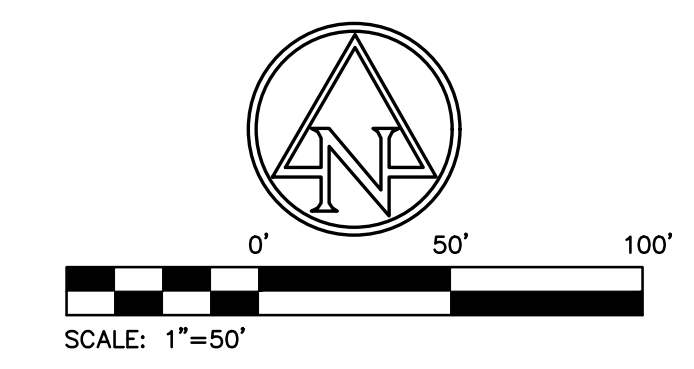
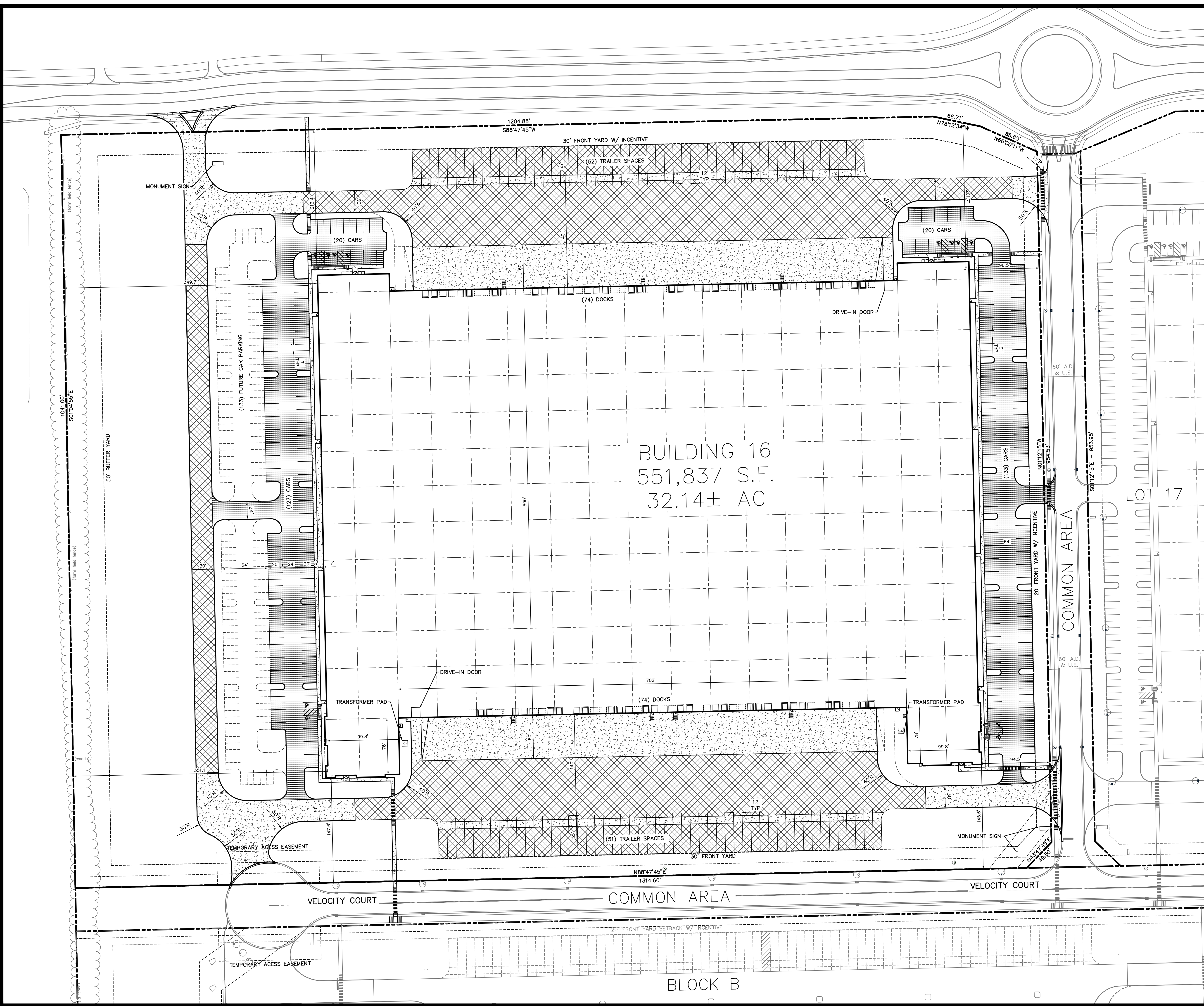

EXISTING LEGEND

⊕ BEEHIVE INLET	● PINE
⊕ BUSH	● POST
⊕ CURB INLET	● POWER POLE
⊕ COMBINATION POLE	⊕ SIGN
○ DELINEATOR	⊕ SANITARY MANHOLE
⊕ DRAINAGE MANHOLE	○ STAND PIPE
⊕ ELECTRIC HANDHOLE	⊕ STUMP
⊕ ELECTRIC METER BOX	⊕ TELEPHONE HANDHOLE
⊕ FIRE HYDRANT	⊕ TELEPHONE POLE
⊕ GAS MARKER SIGN	⊕ TELEPHONE PEDESTAL
⊕ GAS VALVE	⊕ TREE
⊕ GUY WIRE	⊕ VENT
⊕ INLET	⊕ WELL
⊕ LIGHT POLE	⊕ WATER METER
⊕ MAILBOX	⊕ WATER MANHOLE
	⊕ WATER VALVE

SITE LEGEND

[Pattern]	LIGHT DUTY ASPHALT PAVEMENT
[Pattern]	HEAVY DUTY ASPHALT PAVEMENT
[Pattern]	RIGHT OF WAY ASPHALT PAVEMENT
[Pattern]	CONCRETE PAVEMENT

SITE DATA TABLE

PROJECT AREA:	32.14± ACRES
BUILDING AREA:	551,837 SF
REQ'D RATIO WAREHOUSE:	1/3000 SF
REQ'D SPACES =	184 SPACES
PROPOSED CAR PARKING:	288
PROPOSED ADA PARKING:	10 + 2 VAN = 12
TOTAL PROPOSED CAR PARKING:	300
ADDITIONAL FUTURE PARKING:	133
PROPOSED TRAILER STAGING:	103

GENERAL NOTES:

- CONTRACTOR SHALL PROTECT AND NOT DESTROY THE PROPERTY CORNER MONUMENTS DURING CONSTRUCTION.
- CONTRACTOR TO VERIFY LOCATION, SIZE AND DEPTH OF EXISTING UTILITIES PRIOR TO COMMENCING ANY CONSTRUCTION. CONTACT ENGINEER IF VARIATION EXISTS.
- SEE SHEET C002 GENERAL NOTES FOR MORE INFORMATION.

!! CAUTION !!

THE LOCATIONS OF ALL EXISTING UNDERGROUND UTILITIES SHOWN ON THIS PLAN ARE BASED UPON ABOVE GROUND EVIDENCE (including, but not limited to, manholes, inlets, valves, and marks made upon the ground by others) AND ARE SPECULATIVE IN NATURE. THERE MAY ALSO BE OTHER EXISTING UNDERGROUND UTILITIES FOR WHICH THERE IS NO ABOVE GROUND EVIDENCE OR FOR WHICH NO ABOVE GROUND EVIDENCE WAS OBSERVED. THE EXACT LOCATIONS OF SAID EXISTING UNDERGROUND UTILITIES SHALL BE VERIFIED BY THE CONTRACTOR PRIOR TO ANY AND ALL CONSTRUCTION.

CALL TOLL FREE
 811 OR 1-800-382-5844
 - INDIANA UNDERGROUND -

Browning
 Breaking new ground

AMERICAN STRUCTUREPOINT INC.
 8025 RIVER ROAD, SUITE 200
 INDIANAPOLIS, IN 46240
 TEL 317.547.5560 FAX 317.543.0270
 www.structurepoint.com

Revisions:

Date:	07/16/21	Drawn By:	PD	Checked By:	NW
-------	----------	-----------	----	-------------	----

Scale: 1"=50'

ALLPOINTS
 - M I D W E S T -

ALLPOINTS MIDWEST BLDG 16

ALLPOINTS MIDWEST BUILDING 16
 C.R. 100 S & SMITH ROAD
 PLAINFIELD, INDIANA

OVERALL SITE PLAN

Certified By:

APPROVAL PENDING
 NOT FOR CONSTRUCTION

Drawing Number:
C200
 Of
 Sheets

Browning/Date Job Number:
APM 16

A/E Job Number:
2019.02062