

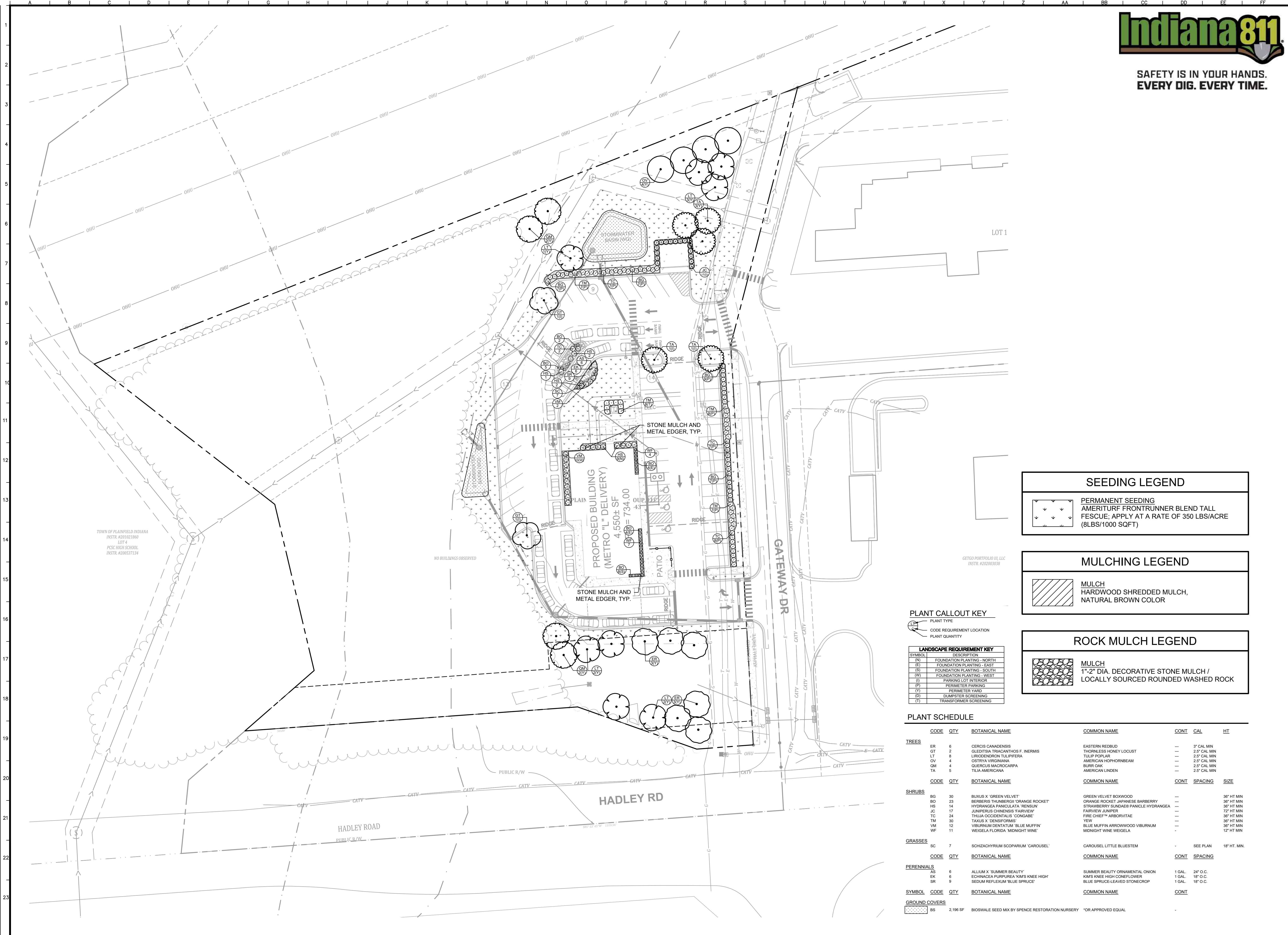

SAFETY IS IN YOUR HANDS.
EVERY DIG. EVERY TIME.

Drawing name: K:\CHL\DEV\16897404\Culver's_PlanSheet_V1.0 - LANDSCAPE PLAN.dwg L1.0 Jan 14, 2026 1:23pm by Brett Hickey
 This document, together with the concepts and designs presented herein, is intended only for the specific purpose and client for which it was prepared. Reuse of and improper reliance on this document without written authorization and adaptation by Kimley-Horn and Associates, Inc. shall be without liability to Kimley-Horn and Associates, Inc.



SEEDING LEGEND

PERMANENT SEEDING
AMERITURF FRONTRUNNER BLEND TALL
FESCUE; APPLY AT A RATE OF 350 LBS/ACRE
(8LBS/1000 SQFT)

MULCHING LEGEND

MULCH
HARDWOOD SHREDDED MULCH,
NATURAL BROWN COLOR

ROCK MULCH LEGEND

MULCH
1"-2" DIA. DECORATIVE STONE MULCH /
LOCALLY SOURCED ROUNDED WASHED ROCK

PLANT CALLOUT KEY
 PLANT TYPE
 CODE REQUIREMENT LOCATION
 PLANT QUANTITY

LANDSCAPE REQUIREMENT KEY

| SYMBOL | DESCRIPTION |
|--------|-----------------------------|
| (N) | FOUNDATION PLANTING - NORTH |
| (E) | FOUNDATION PLANTING - EAST |
| (S) | FOUNDATION PLANTING - SOUTH |
| (W) | FOUNDATION PLANTING - WEST |
| (I) | PARKING LOT INTERIOR |
| (P) | PERIMETER PARKING |
| (Y) | PERIMETER YARD |
| (D) | DUMPSTER SCREENING |
| (T) | TRANSFORMER SCREENING |

PLANT SCHEDULE

| CODE | QTY | BOTANICAL NAME | COMMON NAME | CONT | CAL | HT |
|----------------------|----------|---|--------------------------------------|--------|----------|--------------|
| TREES | | | | | | |
| ER | 6 | CERIS CANADENSIS | EASTERN REDBUD | - | - | 3" CAL MIN |
| GT | 2 | GLEDITSIA TRICANTHOS F. INERMIS | THORNLESS HONEY LOCUST | - | - | 2.5" CAL MIN |
| LT | 8 | LIRIODENDRON TULIPIFERA | TULIP POPLAR | - | - | 2.5" CAL MIN |
| OV | 4 | OSTRYA VIRGINIANA | AMERICAN HOPHORNBEAM | - | - | 2.5" CAL MIN |
| QM | 4 | QUERCUS MACROCARPA | BURR OAK | - | - | 2.5" CAL MIN |
| TA | 5 | TILIA AMERICANA | AMERICAN LINDEN | - | - | 2.5" CAL MIN |
| SHRUBS | | | | | | |
| BO | 30 | BUXUS X GREEN VELVET | GREEN VELVET BOXWOOD | - | - | 36" HT MIN |
| BO | 23 | BERBERIS THUNBERGII 'ORANGE ROCKET' | ORANGE ROCKET JAPANESE BARBERRY | - | - | 36" HT MIN |
| HS | 14 | HYDRANGEA PANICULATA 'RENSUN' | STRAWBERRY SUNDAE® PANICLE HYDRANGEA | - | - | 36" HT MIN |
| JC | 17 | JUNIPERUS CHINENSIS 'FAIRVIEW' | FAIRVIEW JUNIPER | - | - | 72" HT MIN |
| TC | 24 | THUJA OCCIDENTALIS 'CONGARE' | FIRE CHEE™ ARBORVITAE | - | - | 36" HT MIN |
| TM | 30 | TAXUS X DENSIFORMIS | YEW | - | - | 36" HT MIN |
| VM | 12 | VIBURNUM DENTATUM 'BLUE HUFFIN' | BLUE HUFFIN ARROWWOOD VIBURNUM | - | - | 36" HT MIN |
| WF | 11 | WEIGELA FLORIDA 'MIDNIGHT WINE' | MIDNIGHT WINE WEIGELA | - | - | 12" HT MIN |
| GRASSES | | | | | | |
| SC | 7 | SCHIZACHYRIUM SCOPARIUM 'CAROUSEL' | CAROUSEL LITTLE BLUESTEM | - | SEE PLAN | 18" HT. MIN. |
| PERENNIALS | | | | | | |
| AS | 6 | ALLIUM X 'SUMMER BEAUTY' | SUMMER BEAUTY ORNAMENTAL ONION | 1 GAL. | - | 24" O.C. |
| EK | 6 | ECHINACEA PURPUREA 'MIM'S KNEE HIGH' | MIM'S KNEE HIGH CONEFLOWER | 1 GAL. | - | 18" O.C. |
| SR | 9 | SEDUM REFLEXUM 'BLUE SPRUCE' | BLUE SPRUCE-LEAVED STONECROP | 1 GAL. | - | 18" O.C. |
| GROUND COVERS | | | | | | |
| BS | 2,196 SF | BIOSWALE SEED MIX BY SPENCE RESTORATION NURSERY | *OR APPROVED EQUAL | - | - | - |

| No. | REVISIONS | DATE | BY |
|-----|-----------|------|----|
| | | | |
| | | | |

Kimley»Horn
 © 2025, KIMLEY-HORN AND ASSOCIATES, INC.
 111 WEST JACKSON BOULEVARD, STE 1320
 PHOENIX, AZ 85003-4445
 WWW.KIMLEY-HORN.COM

SCALE: AS NOTED
 DESIGNED BY: JTW
 DRAWN BY: JEA
 CHECKED BY: BMH

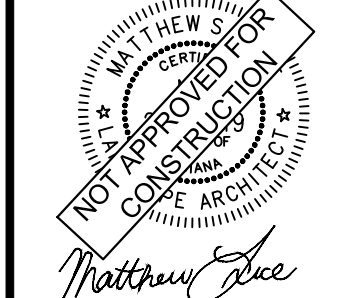

LANDSCAPE PLAN

CULVER'S
 5074 GATEWAY DR
 PLAINFIELD, IN 46168

ORIGINAL ISSUE:
 12/11/2025
 KHA PROJECT NO.
 168974043

SHEET NUMBER
L1.0

