

PLOT DATE: 09/20/2020 3:17 PM  
 PLOT SCALE: 1/2"=80'  
 DRAWING FILE: P:\2017\01143\0 Drawing\Civil\Construction Documents\2017.01143.CE.C200.CSP.dwg  
 EDITED BY: POTTERTY  
 EDIT DATE: 09/20/2020  
 CONSERVATION AREA = 13.04 ACRES

SITE DATA TABLE	
PROPERTY AREA:	±64.63 AC
PROPOSED BUILDING S.F. =	516,790 SF
REQ'D. RATIO WAREHOUSE =	1/3,000 SF
REQ'D. SPACES =	173
PROPOSED CAR PARKING	486
PROPOSED A.D.A. PARKING (INCLUDES 4 VAN ACCESSIBLE)	10
TOTAL PROPOSED CAR PARKING	496
PROPOSED TRAILER STAGING	369
PROPOSED DOCK POSITIONS	122
PROPOSED MOTORCYCLE PARKING	16

**GENERAL NOTES:**

- CONTRACTOR SHALL PROTECT AND NOT DESTROY THE PROPERTY CORNER MONUMENTS DURING CONSTRUCTION.
- CONTRACTOR TO VERIFY LOCATION, SIZE AND DEPTH OF EXISTING UTILITIES PRIOR TO COMMENCING ANY CONSTRUCTION. CONTACT ENGINEER IF VARIATION EXISTS.
- SEE SHEET C002 GENERAL NOTES FOR MORE INFORMATION.

**CAUTION !!**

THE LOCATIONS OF ALL EXISTING UNDERGROUND UTILITIES SHOWN ON THIS PLAN ARE BASED UPON ABOVE GROUND EVIDENCE (including, but not limited to, manholes, inlets, valves, and marks made upon the ground by others) AND ARE SPECULATIVE IN NATURE. THERE MAY ALSO BE OTHER EXISTING UNDERGROUND UTILITIES FOR WHICH THERE IS NO ABOVE GROUND EVIDENCE OR FOR WHICH NO ABOVE GROUND EVIDENCE WAS OBSERVED. THE EXACT LOCATIONS OF SAID EXISTING UNDERGROUND UTILITIES SHALL BE VERIFIED BY THE CONTRACTOR PRIOR TO ANY AND ALL CONSTRUCTION.

CALL TOLL FREE  
 \*811\* OR 1-800-382-5544  
 - INDIANA UNDERGROUND -

EXISTING LEGEND	
BEEHIVE INLET	● PINE
BUSH	○ POST
CURB INLET	□ POWER POLE
COMBINATION POLE	⊥ SIGN
DELINEATOR	○ SANITARY MANHOLE
DRAINAGE MANHOLE	○ STAND PIPE
ELECTRIC HANDHOLE	○ STUMP
ELECTRIC METER BOX	○ TELEPHONE HANDHOLE
FIRE HYDRANT	○ TELEPHONE POLE
GAS MARKER SIGN	○ TELEPHONE PEDESTAL
GAS VALVE	○ TREE
GUY WIRE	○ VENT
INLET	○ WELL
LIGHT POLE	○ WATER METER
MAILBOX	○ WATER MANHOLE
	○ WATER VALVE

SITE LEGEND	
	LIGHT DUTY ASPHALT PAVEMENT
	CONCRETE PAVEMENT

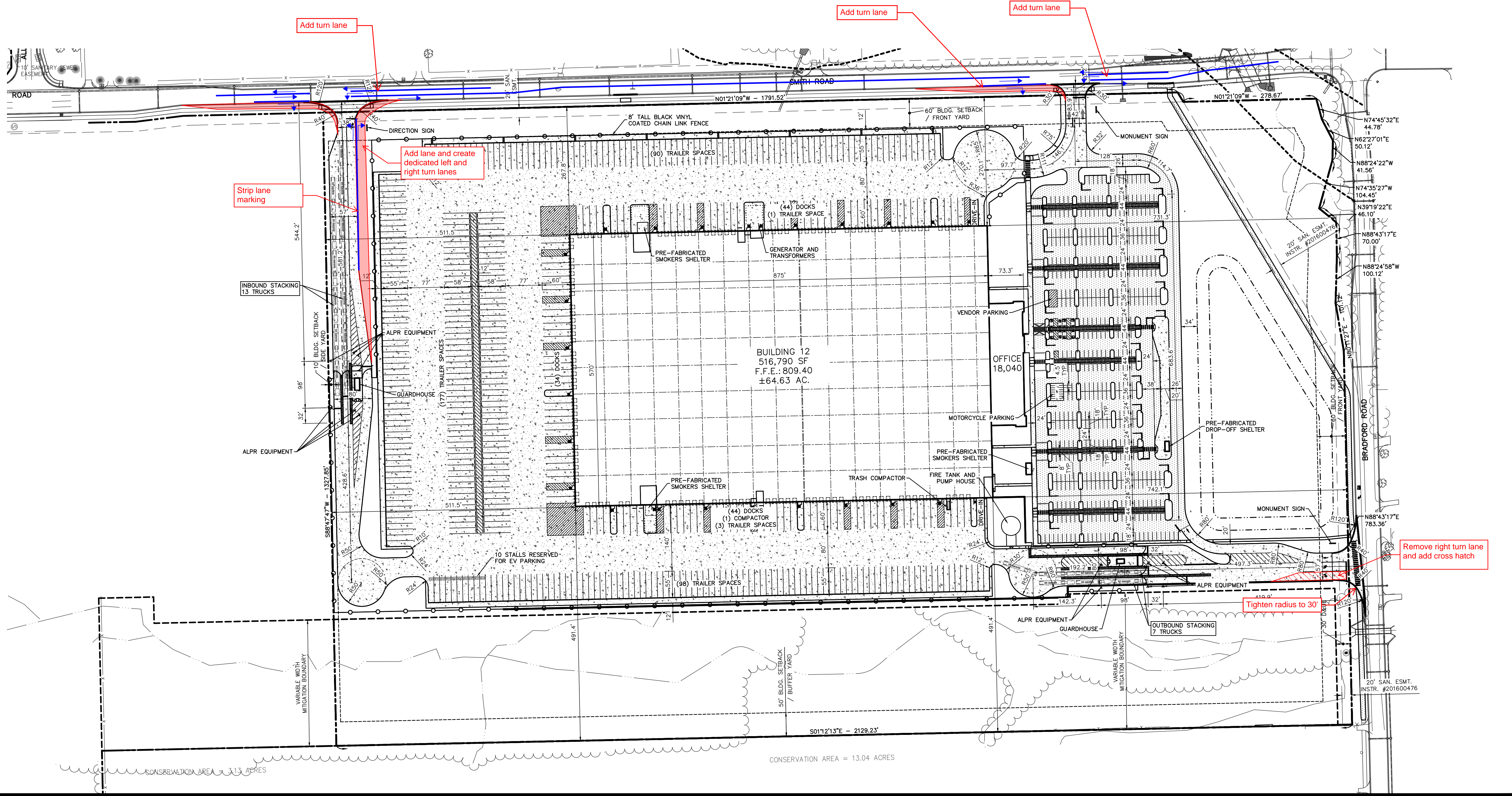
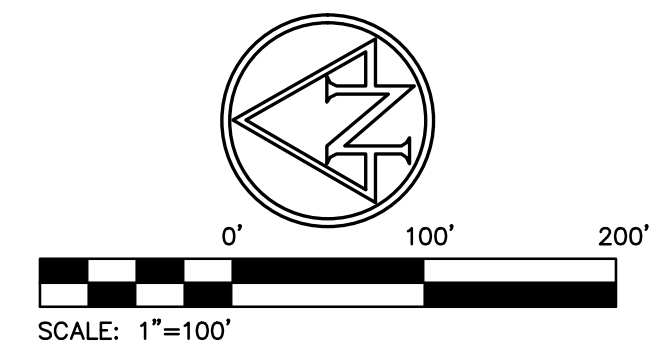

AMERICAN STRUCTUREPOINT INC.  
 6025 RIVER ROAD, SUITE 200  
 INDIANAPOLIS, IN 46240  
 TEL 317.547.5560 FAX 317.543.0270  
 www.structurepoint.com

A Browning-Duke Joint Venture  
 Browning Duke

Scale: 09/09/20  
 Date: 09/09/20  
 Drawn By: PED  
 Checked By: NW

ALLPOINTS  
 - M I D W E S T -  
 ALLPOINTS MIDWEST BLDG 12  
 OVERALL SITE PLAN

ALLPOINTS MIDWEST BUILDING 12  
 BRADFORD RD & SMITH RD  
 PLAINFIELD, INDIANA

Certified By:

Drawing Number:  
**C200**  
 Of Sheets

Browning/Duke Job Number:  
**APM12**  
 A/E Job Number:  
**2017.01143**