

Chick-fil-A  
5200 Buffington Road  
Atlanta, Georgia 30349-2998

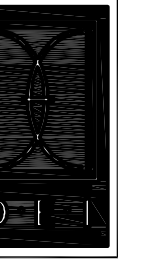

DICKERSON ENGINEERING, INC.  
Professional Electrical Engineers  
3343 NORTH RIDGE AVENUE  
ARLINGTON HEIGHTS, IL 60004  
TEL (847) 966-0290  
WWW.DEI-PE.COM

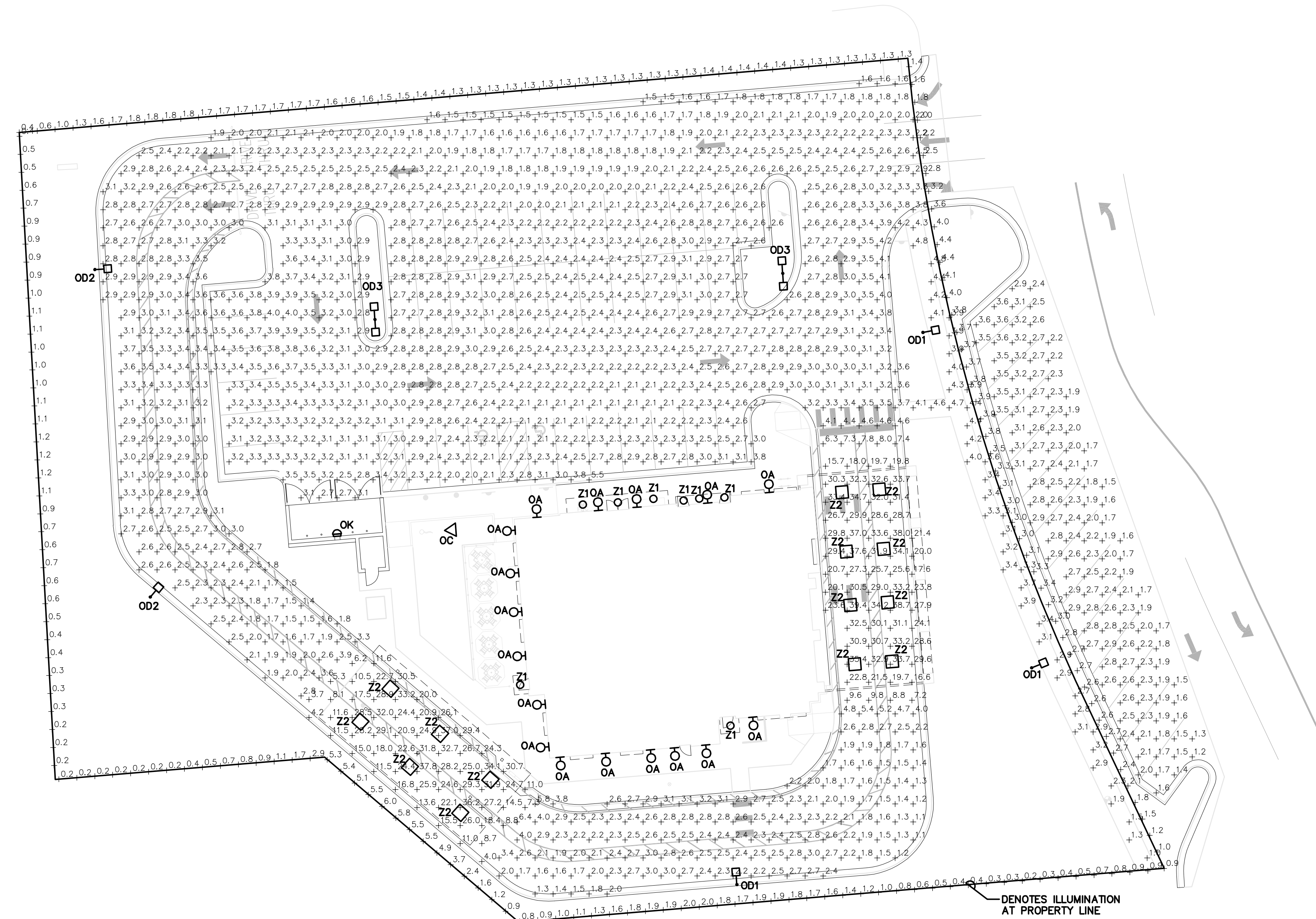

1 PHOTOMETRIC PLAN  
SCALE: 1"=20'-0"

PHOTOMETRIC STATISTICS (MAINTAINED) IN PARKING LOT (NOT INCLUDING UNDER CANOPY LIGHTING)

AVERAGE	2.7 FC
MAX	8.0 FC
MIN	1.0 FC
MAX/MIN	8.0:1 FC

FIXTURE	HEIGHT (UNLESS NOTED OTHERWISE)	LIGHT LOSS FACTOR	COLOR	LIGHT FIXTURE SPECIFICATION	POLE	COMMENTS
OD1	27'	.9	4000K	COOPER/LUMARK - PRV-C40-D-UNV-T3-SA-BZ	SSS-4A-25-SFM-1-4 (SINGLE LUMINAIRE)	
OD2	27'	.9	4000K	COOPER/LUMARK - PRV-C40-D-UNV-T4-SA-BZ	SSS-4A-25-SFM-1-4 (SINGLE LUMINAIRE)	
OD3	27'	.9	4000K	COOPER/LUMARK - (2) PRV-C60-D-UNV-T5-SA-BZ	SSS-4A-25-SFM-2-4 (TWO LUMINAIRES AT 180°)	
OA	8'	.9	3000K	PROGRESS LIGHTING - P5675-31 WITH TOP COVER LENS		
OC	ON GROUND	.9	4000K	HUBBELL - FLL-42L-95-3K-7-N-U-K-DB		FLOODLIGHT AIMED AT FLAG AFTER DARK
OK	8'	.9	3000K	HUBBELL - LNC-5L-U-3K-3		
Z1	10'	.9	3000K	PROVIDED WITH CANOPY		
Z2	9'-6"	.9	3000K	LSI - CRUS-SC-LED-LW30-UE-WHT		

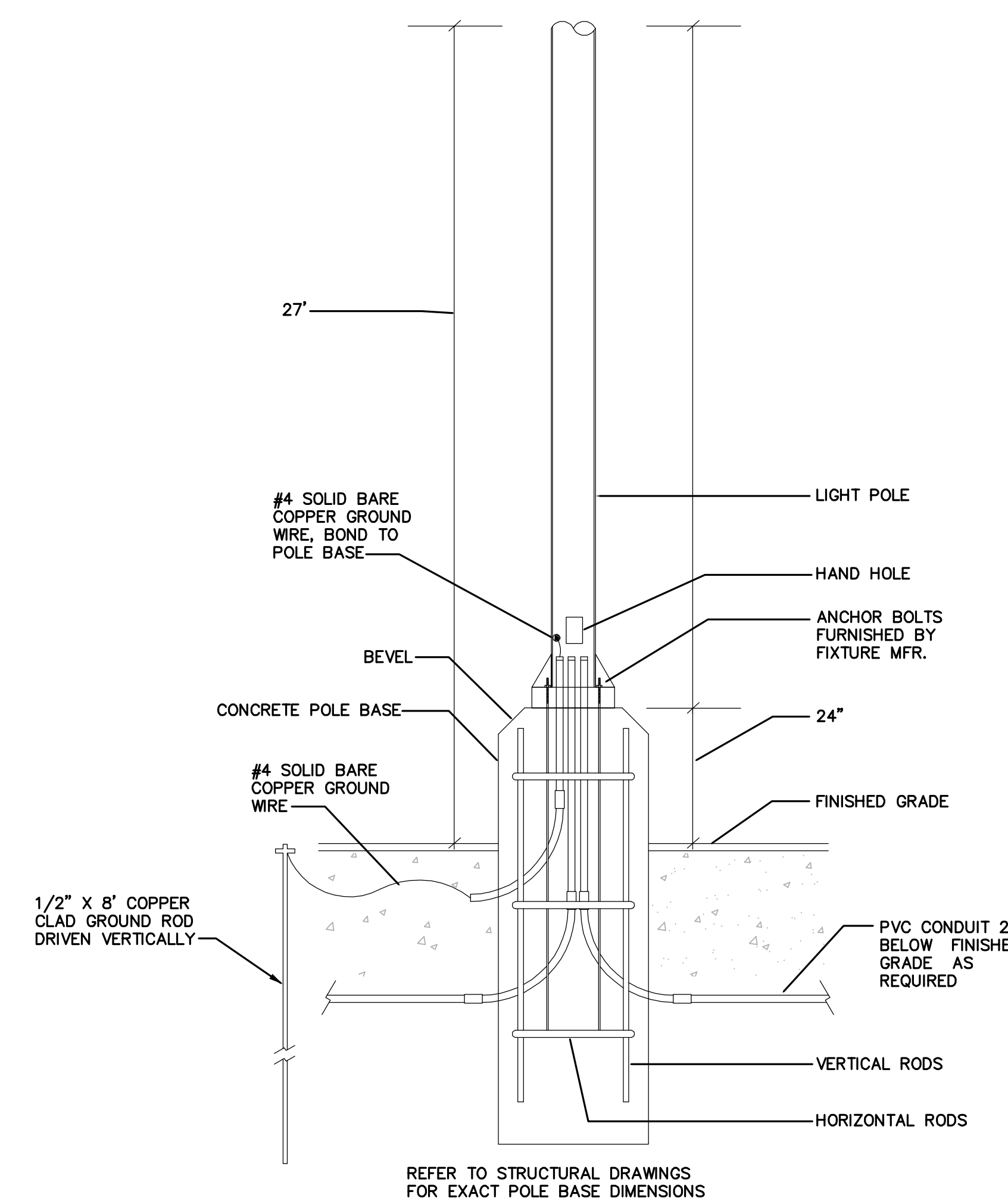

2 TYPICAL POLE BASE DETAIL  
NOT TO SCALE

**CHICK-FIL-A**  
PLAINFIELD FSU  
6102 CAMBRIDGE WAY  
PLAINFIELD, IN 46168

FSR# 05219

REVISION SCHEDULE

NO.	DATE	DESCRIPTION
-----	------	-------------

ENGINEER'S PROJECT # 23009.01  
PRINTED FOR REVIEW  
DATE 09/11/2025  
DRAWN BY BM  
SHEET

Project: \_\_\_\_\_

Fixture Type: \_\_\_\_\_

Location: \_\_\_\_\_

Contact: \_\_\_\_\_

## P5713-31 Cylinder

5" downlight non-metallic wall cylinder in a Black finish.

- Black finish.
- Interior or exterior use.
- Non-corrosive components withstand salt, wind, water & sun damage.
- Ideal for coastal locations.

**Category:** Outdoor

**Finish:** Black (Powder Coat Paint)

**Construction:** polycarbonate Construction

Width: 5 in  
Height: 14 in  
Depth: 7-3/4 in  
H/CTR: 7 in



MOUNTING	ELECTRICAL	LAMPING	ADDITIONAL INFORMATION
Wall mounted	Prewired	Quantity:	UL-CUL Damp Location Listed
Mounting strap for outlet box included	6 inches of wire supplied	two 65 W max. BR-30 or LED equivalent	1-year Limited Warranty
back plate covers a standard 4" recessed outlet box: 4.5" W.,	120 V	E26 base ceramic sockets	

# FLL LED FLOODLIGHT

Cat.#

Job

Type



**HUBBELL**  
Outdoor Lighting

Approvals

## SPECIFICATIONS

### Intended Use:

Large LED flood with beam distribution for lighting applications such as safety/security, facade, area, or signs

### Construction:

- Corrosion resistant, rugged die-cast aluminum housing with powder coat paint finish
- Tempered glass lens protects LEDs and allows for cleaning/debris removal
- Vented housing isolates LED module from driver, maximizing product life and performance
- Visor, louver and vandal accessories available

### LED:

- 28 high power LED's (Stock/MTO)
- 42 high power LED's (MTO)
- 140 high power LED's (Stock)
- Ambient operating temperature -35°C to 40°C
- Stock Versions: 4000K and 5000K CCT
- MTO Versions: 3000K nominal with 80 CRI, 4000K and 5000K CCT nominal with 70 CRI

### Optical/Electrical:

- Variety of NEMA distributions - N (3x3), M (4x4), RM (5x4) and W (6x6) - for wide range of lighting applications; Stock version Wide (6x6) only
- 120-277V operation, 50/60Hz, 95W, 1050mA, 100 LPW (Stock/MTO - 28LED)
- 120-277V operation, 50/60Hz, 150W, 158mA, 98 LPW (Stock only - 140LED)

### Optical/Electrical (Cont.)

- 120-277V, 347V, and 480V operation, 50/60Hz, 95W, 700mA, up to 119 LPW (MTO only - 42LED)
- IP65 fixture, Driver IP66 and RoHS compliant
- 10KV surge protector comes standard
- 0-10V dimming driver standard, continuous dimming option to have leads pulled out for easy connection

### Installation:

- Knuckle mount 15' aiming angle increments for precise aiming and control, fits 2-3/8" tenons or pipes
- Heavy duty steel yoke with adjustable stainless steel hardware, mounting holes for one center - 3/4" bolt or two side - 3/8" bolts
- 3' SE00W cord with yoke mount

### Listings:

- IP65, Listed to UL1598 for use in wet locations.
- DLC Qualified (4000K and 5000K models only); Consult DLC website for more details: <https://www.designlights.org/QPL>
- EPA = 1.0ft<sup>2</sup>

### Warranty:

For more information visit:  
<http://www.hubbellighting.com/resources/warranty/>

## PRODUCT IMAGE(S)



## DIMENSIONS

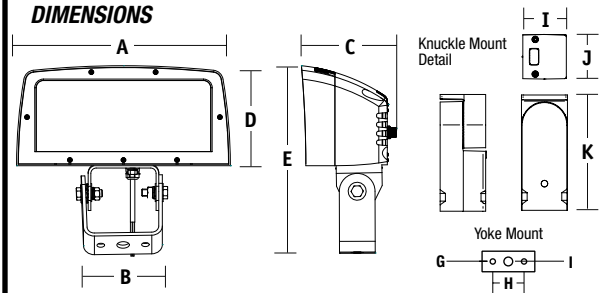

A	B	C	D	E	F	G	H	I	J	K
14.9"	5.5"	6.0"	7.0"	14.57"	17.32"	7/8"	3-1/8"	3.0"	2.9"	7.57"
378mm	140mm	152mm	177mm	370mm	14mm	22mm	79mm	77mm	75mm	192mm

## CERTIFICATIONS/LISTINGS



## SHIPPING INFORMATION

Catalog Number	G.W.(kg)/CTN	Carton Dimensions		
		Length Inch (cm)	Width Inch (cm)	Height Inch (cm)
FLL (Single Carton)	25 (12.3) lbs	17.72" (45)	13.0" (33)	10.00" (25.5)

Carton dimensions for shipping purposes only

## ORDERING INFORMATION - STOCK VERSION

Catalog Number	Mount	Max Candle Power	Beam Pattern	Wattage	# Drivers/ Current	Voltage	Color Temperature/ CRI	Lumens	LPW	Weight lbs. (kg)	Finish
FLL-95-Y	Yoke	7789	Wide	97w	1@700mA	120-277V	5000K/70	10600	109	20 (9.0)	Bronze
FLL-95-4K-Y	Yoke	7265	Wide	97w	1@700mA	120-277V	4000K/70	10173	105	20 (9.0)	
FLL-150-4K-U-Y	Yoke	5627	Wide	150w	1@158mA	120-277V	4000K/80	14665	98	20 (9.0)	
FLL-150-5K-U-Y	Yoke	5731	Wide	150w	1@158mA	120-277V	5000K/80	14764	98.4	20 (9.0)	
FLL-150-4K-U-K	Knuckle	5627	Wide	150w	1@158mA	120-277V	4000K/80	14665	98	20 (9.0)	
FLL-150-5K-U-K	Knuckle	5731	Wide	150w	1@158mA	120-277V	5000K/80	14764	98.4	20 (9.0)	

## ORDERING INFORMATION - MADE TO ORDER

FLL - [ ] - [ ] - [ ] - 7 - [ ] - [ ] - [ ] - [ ] - [ ] - [ ] - [ ]

FAMILY	# LEDS	WATTS	CCT	CRI	DISTRIBUTION	VOLTAGE	MOUNTING	FINISH	CONTROL OPTION	OPTIONS
FLL	28L 28 LED 42L 42 LED	95 95W	3K 3000K 4K 4000K 5K 5000K	7 70 CRI	N 3x3 M 4x4 RM 5x4 W 6x6	U 120V-277V 1 120V 2 208V 3 240V 4 277V 5 <sup>1</sup> 480V F <sup>1</sup> 347V	K Knuckle Y Yoke	DB Bronze BL Black WH White GR Gray PS Platinum silver CC Custom Color	PC Photocontrol (voltage specified and determined by voltage field) CD Continuous dimming	F Fusing 120 or 277V only (determined by voltage field)

<sup>1</sup> 42L only



Hubbell Outdoor Lighting • 701 Millennium Boulevard • Greenville, SC 29607 • Phone: 864-678-1000

Due to our continued efforts to improve our products, product specifications are subject to change without notice.

© 2017 HUBBELL OUTDOOR LIGHTING, All Rights Reserved • For more information visit our website: [www.hubbelloutdoor.com](http://www.hubbelloutdoor.com) • Printed in USA FLL-SPEC SEPTEMBER 20, 2017 10:28 AM

## ACCESSORIES & REPLACEMENT PARTS - Order Separately

Catalog Number	Description
<b>FLL-VISOR-DB</b>	Bronze top visor (Tap holes in lens frame for field installation)
93053186	FLL28, 95w, 120-277V Dimming driver, 1050mA (1 Qty)
93053187	FLL140, 95w, 120-277V Dimming driver, 700mA (1 Qty)
<b>FLL-LOUVER-BL</b>	Black adjustable louver
<b>ARF-SPC</b>	Polycarbonate vandal shield
4024C	Steel slipfitter for 2" pipe, 2 3/8" OD yoke mount, bronze finish
4040	Heavy-duty steel wall/pole bracket, bronze Lektrocote®



FLL-LOUVER-BL



ARF-SPC



FLL-VISOR-XX

## PERFORMANCE DATA - Stock

# OF LEDS	DRIVE CURRENT (MILLIAMPS)	SYSTEM WATTS	DISTRIBUTION TYPE	4K (4000K nominal)				5K (5000K nominal)			
				NEMA	LUMENS	LPW	MAX BEAM CANDLEPOWER	LUMENS	LPW	MAX BEAM CANDLEPOWER	
28	1050mA	95W	W	6 x 6	8992	94.5	6805	9557	100.6	6935	
140	158mA	150W	W	7 x 7	14665	98	5627	14764	98.4	5731	

Lumen values are from photometric tests performed in accordance with IESNA LM-79-08. Data is considered to be representative of the configurations shown. Actual performance may differ as a result of end-user environment, application and inherent performance tolerances of the electrical components.

## PERFORMANCE DATA - MTO

# OF LEDS	DRIVE CURRENT	SYSTEM WATTS	DIST. TYPE	NEMA	FIELD ANGLE H° X V°	5K (5000K nominal, 70 CRI)			4K (4000K nominal, 70 CRI)			3K (3000K nominal, 80 CRI)		
						LUMENS	LPW <sup>1</sup>	MAX BEAM CANDLEPOWER	LUMENS	LPW <sup>1</sup>	MAX BEAM CANDLEPOWER	LUMENS	LPW <sup>1</sup>	MAX BEAM CANDLEPOWER
28	1050mA	95W	W	6 x 6	107° x 107°	9557	100.6	6935	-	-	-	-	-	-
42	700mA	97W	N	3 x 3	32° x 32°	10860	114	91770	10263	108	85000	7473	80	63093
			M	4 x 4	53° x 53°	11400	119	46836	10335	108	33566	7654	81	26201
			RM	5 x 5	84° x 86°	9806	102	17388	8889	93	14733	6702	71	11395
			W	6 x 6	107° x 107°	10967	113	8024	10173	105	7265	7694	79	5475

Lumen values are from photometric tests performed in accordance with IESNA LM-79-08. Data is considered to be representative of the configurations shown. Actual performance may differ as a result of end-user environment and application.

## PROJECTED LUMEN MAINTENANCE

AMBIENT TEMP.	OPERATING HOURS - FLL-28L					
	0	25,000	50,000	<sup>1</sup> TM-21-11 60,000	100,000	Calculated L70 (HOURS)
25°C / 77°F	1.00	0.94	0.91	0.88	0.79	>149,000
40°C / 104°F	1.00	0.92	0.90	0.87	0.76	>132,000

Nichia 219B, 1080mA, 85°C

AMBIENT TEMP.	OPERATING HOURS - FLL-42L					
	0	25,000	50,000	<sup>1</sup> TM-21-11 60,000	100,000	Calculated L70 (HOURS)
25°C / 77°F	1.00	0.98	0.96	0.96	0.94	>625,000
40°C / 104°F	1.00	0.96	0.94	0.93	0.90	>435,000

AMBIENT TEMP.	OPERATING HOURS - FLL-150					
	0	25,000	50,000	<sup>1</sup> TM-21-11 60,000	100,000	Calculated L70 (HOURS)
25°C / 77°C	1.00	0.96	0.94	0.93	0.89	>331,000
40°C / 104°F	1.00	0.95	0.92	0.90	0.85	>237,000

Nichia NFSL757DT-V1, 150mA, 85°C

## ELECTRICAL DATA

# OF LEDS	NUMBER OF DRIVERS	DRIVE CURRENT (mA)	INPUT VOLTAGE (V)	CURRENT (Amps)	SYSTEM POWER (W)
28	1	1050mA	120	0.82	95
			277	0.36	95
42	1	700mA	120	.80	96
			277	.35	96
140	1	158mA	120	1.25	150
			277	0.54	150

## LUMINAIRE AMBIENT TEMPERATURE FACTOR (LATF)

AMBIENT TEMPERATURE	LUMEN MULTIPLIER
0°C	1.02
10°C	1.01
20°C	1.00
25°C	1.00
30°C	1.00
40°C	0.99

Use these factors to determine relative lumen output for average ambient temperatures from 0-40°C (32-104°F).

Project		Catalog #		Type	
Prepared by		Notes		Date	



# Lumark

## PRV / PRV-XL Prevail LED

Area / Site Luminaire

### Typical Applications

Outdoor • Parking Lots • Walkways • Roadways • Building Areas

### Interactive Menu

- Ordering Information [page 2](#)
- Mounting Details [page 3](#)
- Optical Configurations [page 3](#)
- Product Specifications [page 3](#)
- Energy and Performance Data [page 4](#)
- Control Options [page 5](#)

### Product Certifications



### Product Features



### Quick Facts

- Lumen packages range from 7,100 - 48,600 lumens (50W - 350W)
- Replaces 70W up to 1,000W HID equivalents
- Efficacies up to 148 lumens per watt
- Energy and maintenance savings up to 85% versus HID solutions
- Standard universal quick mount arm with universal drill pattern

### Dimensional Details

#### Prevail

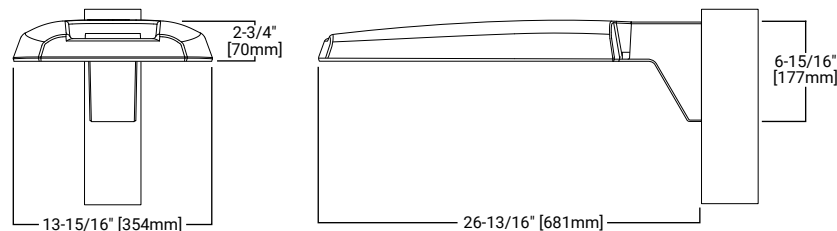

#### Prevail XL

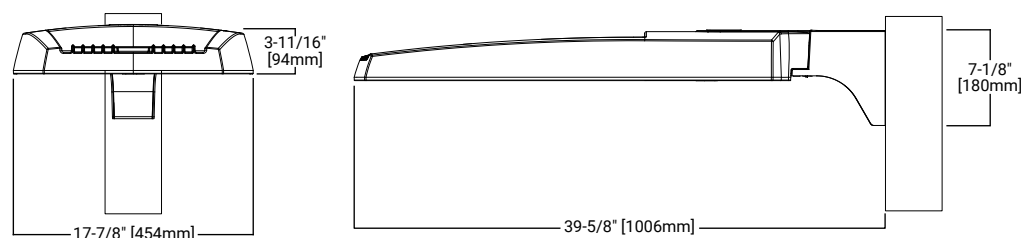

Ordering Information

SAMPLE NUMBER: PRV-XL-C75-D-UNV-T4-SA-BZ

Product Family 1,2	Light Engine 3	Driver	Voltage	Distribution	Mounting (Included)	Color
PRV=Prevail	C15=(1 LED) 7,100 Nominal Lumens C25=(2 LEDs) 13,100 Nominal Lumens C40=(2 LEDs) 17,100 Nominal Lumens C60=(2 LEDs) 20,000 Nominal Lumens	D=Dimming (0-10V)	UNV=Universal (120-277V) 347=347V 480=480V 4	T2=Type II T3=Type III T4=Type IV T5=Type V	SA=Standard Versatile Arm MA=Mast Arm WM=Wall Mount Arm	AP=Grey BZ=Bronze BK=Black DP=Dark Platinum GM=Graphite Metallic WH=White CC=Coastal Construction
PRV-XL=Prevail XL	C75=(4 LED) 26,100 Nominal Lumens C100=(4 LED) 31,000 Nominal Lumens C125=(4 LED) 36,000 Nominal Lumens C150=(6 LED) 41,100 Nominal Lumens C175=(6 LED) 48,600 Nominal Lumens					

Options (Add as Suffix)	Accessories (Order Separately) 18
<p>7030=70 CRI / 3000K CCT 5 7050=70 CRI / 5000K CCT 5 HSS=House Side Shield 6 L90=Optics Rotated 90° Left R90=Optics Rotated 90° Right 10K=10kV UL 1449 Fused Surge Protective Device 20MSP=20kV MOV Surge Protective Device 20K=20kV UL 1449 Fused Surge Protective Device HA=50°C High Ambient Temperature 7 PER=NEMA 3-PIN Twistlock Photocontrol Receptacle PER7=NEMA 7-PIN Twistlock Photocontrol Receptacle MSP/DIM-L12=Integrated Sensor for Dimming Operation, 8' - 12' Mounting Height 8,9 MSP/DIM-L30=Integrated Sensor for Dimming Operation, 12' - 30' Mounting Height 8,9 MSP-L12=Integrated Sensor ON/OFF Operation, 8' - 12' Mounting Height 8,9 MSP-L30=Integrated Sensor ON/OFF Dimming Operation, 12' - 30' Mounting Height 8,9 MS/DIM-L20=Motion Sensor for Dimming Operation, 9' - 20' Mounting Height 9,10 MS/DIM-L40W=Motion Sensor for Dimming Operation, 21' - 40' Mounting Height 9,10 MS-L20=Motion Sensor for ON/OFF Operation, 9' - 20' Mounting Height 9,10 MS-L40W=Motion Sensor for ON/OFF Operation, 21' - 40' Mounting Height 9,10 ZD=DALI-enabled 4-PIN Twistlock Receptacle 9,11,12 ZW=Wavelinx-enabled 4-PIN Twistlock Receptacle 9,11,12 SWPD4XX=Wavelinx Wireless Sensor, 7' - 15' Mounting Height 9,11,12,13,14 SWPD5XX=Wavelinx Wireless Sensor, 15' - 40' Mounting Height 9,11,12,13,14 LWR-LW=Enlighted Wireless Sensor, Wide Lens for 8' - 16' Mounting Height 9,15 LWR-LN=Enlighted Wireless Sensor, Narrow Lens for 16' - 40' Mounting Height 9,15 (See Table Below)=LumenSafe Integrated Network Security Camera 16,17</p>	<p>PRVWM-XX=Wall Mount Kit 8 PRVMA-XX=Mast Arm Mounting Kit 8 PRVSA-XX=Standard Arm Mounting Kit 8 PRVXLSA-XX=Standard Arm Mounting Kit (for Prevail XL) 16 PRVXLWM-XX=Wall Mount Kit (for Prevail XL) 16 PRVXLMA-XL=Mast Arm Mounting Kit (for Prevail XL) 16 MA1010-XX=Single Tenon Adapter for 3-1/2" O.D. Tenon MA1011-XX=2@180° Tenon Adapter for 3-1/2" O.D. Tenon MA1017-XX=Single Tenon Adapter for 2-3/8" O.D. Tenon MA1018-XX=2@180° Tenon Adapter for 2-3/8" O.D. Tenon HS/VERD=House Side Shield 6,19 VGS-F/B=Vertical Glare Shield, Front/Back 19 VGS-SIDE=Vertical Glare Shield, Side 19 OA/RA1013=Photocontrol Shorting Cap OA/RA1014=NEMA Photocontrol - 120V OA/RA1016=NEMA Photocontrol - Multi-Tap 105-285V OA/RA1201=NEMA Photocontrol - 347V OA/RA1027=NEMA Photocontrol - 480V ISHH-01=Integrated Sensor Programming Remote 20 FSIR-100=Wireless Configuration Tool for Occupancy Sensor 21 SWPD4-XX=Wavelinx Wireless Sensor, 7' - 15' Mounting Height 12,13,14 SWPD5-XX=Wavelinx Wireless Sensor, 15' - 40' Mounting Height 12,13,14 WOLC-7P-10A=Wavelinx Outdoor Control Module (7-PIN) 22</p>

NOTES:

- DesignLights Consortium® Qualified. Refer to www.designlights.org Qualified Products List under Family Models for details.
- Customer is responsible for engineering analysis to confirm pole and fixture compatibility for applications. Refer to installation instructions and pole white paper WP513001EN for additional support information.
- Standard 4000K CCT and 70CRI.
- Only for use with 480V Wye systems. Per NEC, not for use with ungrounded systems, impedance grounded systems or corner grounded systems (commonly known as Three Phase Three Wire Delta, Three Phase High Leg Delta and Three Phase Corner Grounded Delta systems).
- Use dedicated IES files on product website for non-standard CCTs.
- Option will come factory-installed. House Side Shield not suitable with T5 distribution or C60 lumen package.
- Not available with C60 lumen package.
- Only available in PRV configurations C15, C25, C40 or C60.
- Controls system is not available with photocontrol receptacle (PER or PER7) or other controls systems (MS, MSP, ZW, ZD or LWR).
- Utilizes the Wattstopper sensor FSP-211.
- Sensor passive infrared (PIR) may be overly sensitive when operating below -20°C (-4°F).
- For the device to be field-configurable, requires WAC Gateway components WAC-PoE and WPOE-120 in appropriate quantities. Only compatible with WaveLinx system and software and requires system components to be installed for operation. See website for more Wavelinx application information.
- Replace XX with sensor color (WH, BZ, or BK).
- Requires 4-PIN twistlock receptacle (ZD or ZW) option.
- Enlighted wireless sensors are factory installed and require network components LWP-EM-1, LWP-GW-1, and LWP-PoE8 in appropriate quantities. See website for application information.
- Only available in PRV-XL configurations C75, C100, C125, C150, or C175.
- Not available with 347V, 480V, or HA options. Consult LumenSafe system product pages for additional details and compatibility information.
- Replace XX with paint color.
- Must order one per optic/LED when ordering as a field-installable accessory (1, 2, 4, or 6).
- This tool enables adjustment to Integrated Sensor (MSP) parameters including high and low modes, sensitivity, time delay, cutoff and more. Consult your lighting representative at Eaton for more information.
- This tool enables adjustment to Motion Sensor (MS) parameters including high and low modes, sensitivity, time delay, cutoff and more. Consult your lighting representative at Eaton for more information.
- Requires 7-PIN NEMA twistlock photocontrol receptacle (PER7) option. The WOLC-7 cannot be used in conjunction with other controls systems (MS, MSP, ZW, ZD or LWR). Operates on 120-347V input voltages.

LumenSafe Integrated Network Security Camera Technology Options (Add as Suffix)

Product Family	Camera Type	Data Backhaul
L=LumenSafe Technology 	D=Dome Camera	C=Cellular, Customer Installed SIM Card A=Cellular, Factory Installed AT&T SIM Card V=Cellular, Factory Installed Verizon SIM Card S=Cellular, Factory Installed Sprint SIM Card E=Ethernet Networking

Stock Ordering Information

Product Family 1	Light Engine	Voltage	Distribution	Options (Add as Suffix)
PRVS=Prevail	C15=(1 LED) 7,100 Nominal Lumens C25=(2 LEDs) 13,100 Nominal Lumens C40=(2 LEDs) 17,100 Nominal Lumens C60=(2 LEDs) 20,000 Nominal Lumens	UNV=Universal (120-277V) 347=347V 2	T3=Type III T4=Type IV	MSP/DIM-L30=Integrated Sensor for Dimming Operation, Maximum 30' Mounting Height 2
PRVS-XL=Prevail XL	C75=(4 LED) 26,100 Nominal Lumens C100=(4 LED) 31,000 Nominal Lumens C125=(4 LED) 36,000 Nominal Lumens C150=(6 LED) 41,100 Nominal Lumens C175=(6 LED) 48,600 Nominal Lumens			

NOTES:

- All stock configurations are standard 4000K/70CRI, bronze finish, and include the standard versatile mounting arm.
- Only available in PRVS configurations C15, C25, C40 or C60.

## Mounting Details

### Pole Mount Arm (PRV)

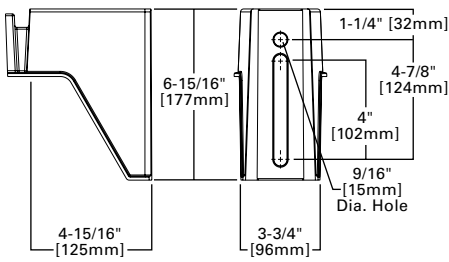

### Pole Mount Arm (PRV-XL)

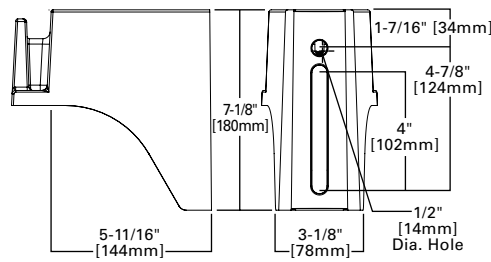

### Versatile Mount System

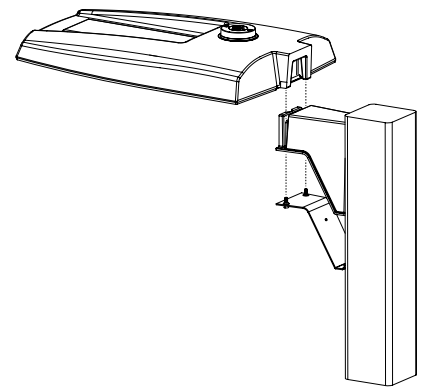

### Wall Mount (PRV)

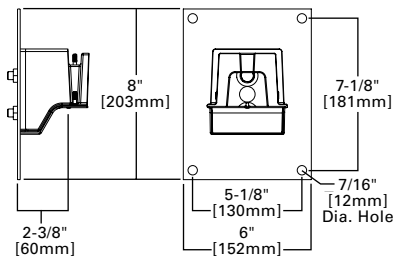

### Wall Mount (PRV-XL)

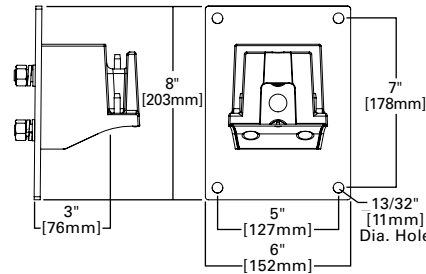

### Mast Arm Mount (PRV)

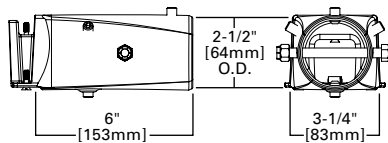

### Mast Arm Mount (PRV-XL)

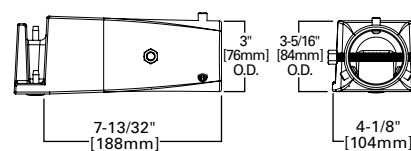

### Mounting Configurations and EPAs

**NOTE:** For 2 PRV's mounted at 90°, requires minimum 3" square or 4" round pole for fixture clearance. For 2 PRV-XL's mounted at 90°, requires minimum 4" square or round pole for fixture clearance. Customer is responsible for engineering analysis to confirm pole and fixture compatibility for applications.

Wall Mount	Arm Mount Single	Arm Mount 2 @ 180°	Arm Mount 2 @ 90°	Arm Mount 3 @ 90°	Arm Mount 4 @ 90°
	EPA 0.92 (PRV) EPA 1.12 (PRV-XL)	EPA 1.35 (PRV) EPA 2.25 (PRV-XL)	EPA 1.42 (PRV) EPA 2.13 (PRV-XL)	EPA 1.63 (PRV) EPA 2.52 (PRV-XL)	EPA 1.63 (PRV) EPA 2.52 (PRV-XL)

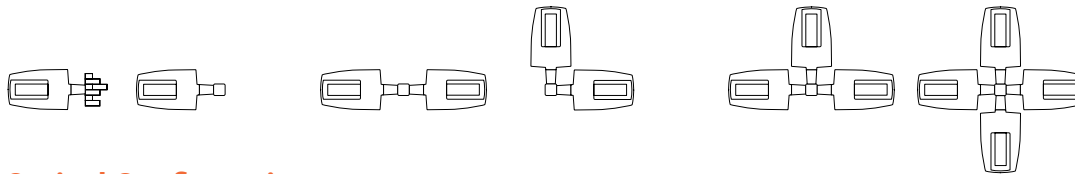

## Optical Configurations

PRV-C15	PRV-C25/C40/C60	PRV-XL-C75/C100/C125	PRV-XL-C150/C175
(7,100 Nominal Lumens)	(13,100/17,100/20,000 Nominal Lumens)	(26,100/31,000/36,300 Nominal Lumens)	(41,100/48,600 Nominal Lumens)

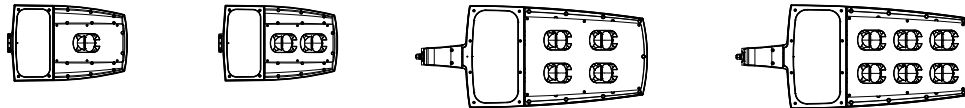

## Product Specifications

### Construction

- Single-piece die-cast aluminum housing
- Tethered die-cast aluminum door

### Optics

- Dark Sky Approved (3000K CCT and warmer only)
- Precision molded polycarbonate optics

### Electrical

- -40°C minimum operating temperature
- 40°C maximum operating temperature
- >.9 power factor
- <20% total harmonic distortion

- Class 1 electronic drivers have expected life of 100,000 hours with <1% failure rate
- 0-10V dimming driver is standard with leads external to the fixture

### Mounting

- Versatile, patented, standard mount arm accommodates multiple drill patterns ranging from 1-1/2" to 4-7/8"
- A knock-out on the standard mounting arm enables round pole mounting
- Prevail: 3G vibration rated
- Prevail XL Mast Arm: 3G vibration rated
- Prevail XL Standard Arm: 1.5G vibration rated

### Finish

- Five-stage super TGIC polyester powder coat paint, 2.5 mil nominal thickness

### Shipping Data

- Prevail: 20 lbs. (9.09 kgs.)
- Prevail XL: 45 lbs. (20.41 kgs.)

## Energy and Performance Data

### Power and Lumens (PRV)

 [View PRV IES files](#)

Light Engine	C15	C25	C40	C60	
<b>Power (Watts)</b>	52	96	131	153	
<b>Input Current @ 120V (A)</b>	0.43	0.80	1.09	1.32	
<b>Input Current @ 277V (A)</b>	0.19	0.35	0.48	0.57	
<b>Input Current @ 347V (A)</b>	0.17	0.30	0.41	0.48	
<b>Input Current @ 480V (A)</b>	0.12	0.22	0.30	0.35	
<b>Distribution</b>					
<b>Type II</b>	4000K Lumens	7,123	13,205	17,172	20,083
	BUG Rating	B2-U0-G2	B2-U0-G2	B3-U0-G3	B3-U0-G3
	3000K Lumens	6,994	12,965	16,860	19,718
<b>Type III</b>	4000K Lumens	7,111	13,183	17,144	20,050
	BUG Rating	B1-U0-G2	B2-U0-G3	B3-U0-G4	B3-U0-G4
	3000K Lumens	6,982	12,944	16,832	19,686
<b>Type IV</b>	4000K Lumens	7,088	13,140	17,087	19,984
	BUG Rating	B1-U0-G3	B2-U0-G4	B2-U0-G4	B3-U0-G5
	3000K Lumens	6,959	12,901	16,777	19,621
<b>Type V</b>	4000K Lumens	7,576	14,045	18,264	21,360
	BUG Rating	B3-U0-G3	B4-U0-G3	B4-U0-G4	B5-U0-G4
	3000K Lumens	7,438	13,790	17,932	20,972

### Lumen Maintenance

Configuration	TM-21 Lumen Maintenance (50,000 Hours)	Theoretical L70 (Hours)
Up to PRV-C60 at 25°C	91.30%	194,000
Up to PRV-C60 at 40°C	87.59%	134,000
Up to PRV-XL-C175 at 25°C	91.40%	204,000
Up to PRV-XL-C175 at 40°C	89.41%	158,000

### Lumen Multiplier

Ambient Temperature	Lumen Multiplier
10°C	1.02
15°C	1.01
25°C	1.00
40°C	0.99

### Power and Lumens (PRV-XL)

 [View PRV-XL IES files](#)

Light Engine	C75	C100	C125	C150	C175	
<b>Power (Watts)</b>	176	217	264	285	346	
<b>Input Current @ 120V (A)</b>	1.50	1.84	2.21	2.38	2.92	
<b>Input Current @ 277V (A)</b>	0.66	0.82	0.97	1.04	1.25	
<b>Input Current @ 347V (A)</b>	0.54	0.66	0.79	0.84	1.02	
<b>Input Current @ 480V (A)</b>	0.40	0.48	0.57	0.62	0.74	
<b>Distribution</b>						
<b>Type II</b>	4000K Lumens	26,263	31,231	36,503	41,349	48,876
	BUG Rating	B3-U0-G3	B3-U0-G4	B4-U0-G4	B4-U0-G4	B4-U0-G5
	3000K Lumens	25,786	30,664	35,840	40,598	47,989
<b>Type III</b>	4000K Lumens	26,120	31,061	36,304	41,124	48,610
	BUG Rating	B3-U0-G5	B3-U0-G5	B3-U0-G5	B4-U0-G5	B4-U0-G5
	3000K Lumens	25,646	30,497	35,645	40,377	47,727
<b>Type IV</b>	4000K Lumens	26,098	31,035	36,274	41,089	48,569
	BUG Rating	B3-U0-G5	B3-U0-G5	B3-U0-G5	B3-U0-G5	B4-U0-G5
	3000K Lumens	25,624	30,471	35,615	40,343	47,687
<b>Type V</b>	4000K Lumens	28,129	33,450	39,097	44,287	52,349
	BUG Rating	B5-U0-G5	B5-U0-G5	B5-U0-G5	B5-U0-G5	B5-U0-G5
	3000K Lumens	27,618	32,843	38,387	43,483	51,398

## Control Options

**0-10V (D)** The dimming option provides 0-10V dimming wire leads for use with a lighting control panel or other control method.

**Photocontrol (PER and PER7)** Photocontrol receptacles provide a flexible solution to enable "dusk-to-dawn" lighting by sensing light levels. Advanced control systems compatible with NEMA 7-pin standards can be utilized with the PER7 receptacle.

**Dimming Occupancy Sensor (MSP and MS)** These sensors are factory installed in the luminaire housing. When a sensor for dimming operation (/DIM) option is selected, the luminaire will dim down to approximately 50 percent power after five minutes of no activity detected. When activity is detected, the luminaire returns to full light output. When a sensor for ON/OFF operation is selected, the luminaire will turn off after five minutes of no activity.

These occupancy sensors include an integral photocell that can be activated or inactivated with the programming remote / configuration tool for "dusk-to-dawn" control or "daylight harvesting". **Note:** For MSP sensors, the factory preset is ON (Enabled), and for MS sensors, the factory preset is OFF (Disabled). The programming remote / tool is a wireless tool that can be utilized to change the dimming level, time delay, sensitivity and other parameters. A variety of sensor lenses are available to optimize the coverage pattern for mounting heights from 8'-40'.

For mounting heights from 8' to 12' (-L12)

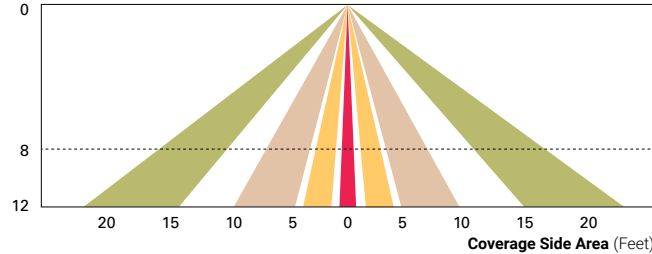

For mounting heights from 12' to 30' (-L30)

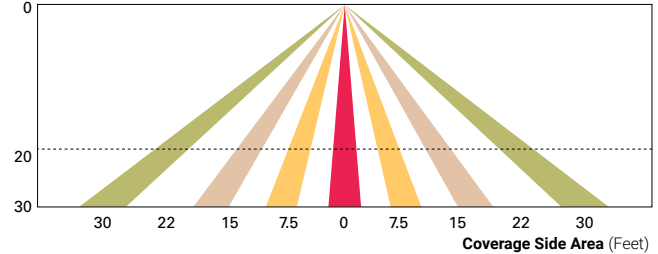

For mounting heights from 9' to 20' (-L20)

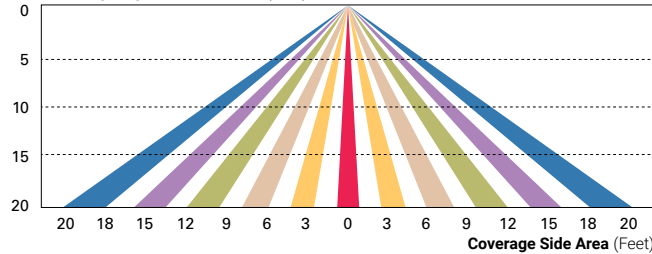

For mounting heights from 21' to 40' (-L40W)

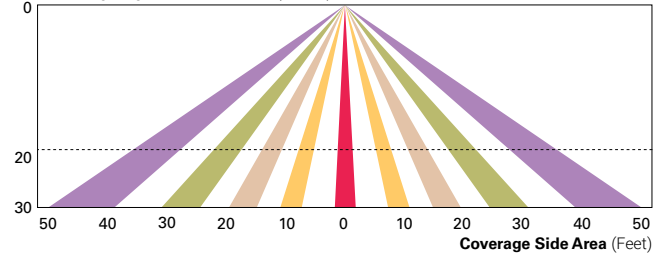

**WaveLinx Wireless Control and Monitoring System** Available in 7-PIN or 4-PIN configurations, the WaveLinx Outdoor control platform operates on a wireless mesh network based on IEEE 802.15.4 standards enabling wireless control of outdoor lighting. Use the WaveLinx Mobile application for set-up and configuration. At least one Wireless Area Controller (WAC) is required for full functionality and remote communication (including adjustment of any factory pre-sets).

**WaveLinx Outdoor Control Module (WOLC-7P-10A)** A photocontrol that enables astronomical or time-based schedules to provide ON, OFF and dimming control of fixtures utilizing a 7-PIN receptacle. The out-of-box functionality is ON at dusk and OFF at dawn.

**WaveLinx Wireless Sensor (SWPD4 and SWPD5)** These outdoor sensors offer passive infrared (PIR) occupancy and a photocell for closed loop daylight sensing. These sensors can be factory installed or field-installed via simple, tool-less integration into luminaires equipped with the Zhaga Book 18 compliant 4-PIN receptacle (ZD or ZW). These sensors are factory preset to dim down to approximately 50 percent power after 15 minutes of no activity detected. These occupancy sensors include an integral photocell for "dusk-to-dawn" control or daylight harvesting that is factory-enabled. A variety of sensor lenses are available to optimize the coverage pattern for mounting heights from 7'-40'.

For mounting heights from 16' to 40' (SWPD)

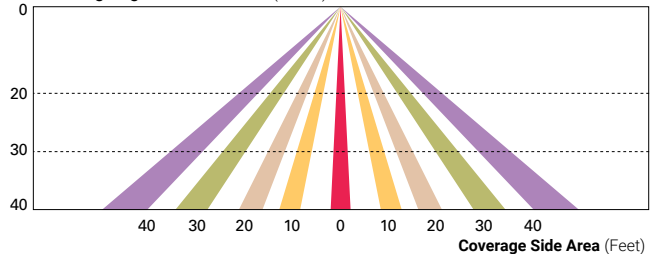

**Enlighted Wireless Control and Monitoring System (LWR-LW and LWR-LN)** The Enlighted System is a connected lighting solution that combines LED luminaires with an integrated wireless sensor system. The sensor controls the lighting system in compliance with the latest energy codes and collects valuable data about building performance and use. Software applications turn the granular data into information through energy dashboards and specialized apps that make it simple and help optimize the use of other resources beyond lighting.

For mounting heights from 8' to 16' (LWR-LW)

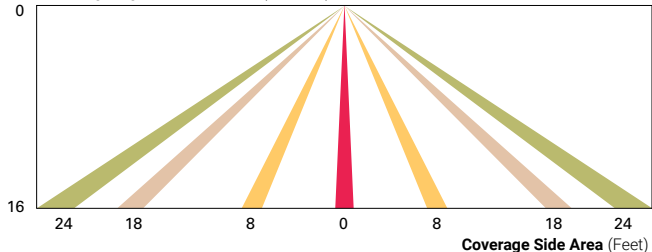

For mounting heights from 16' to 40' (LWR-LN)

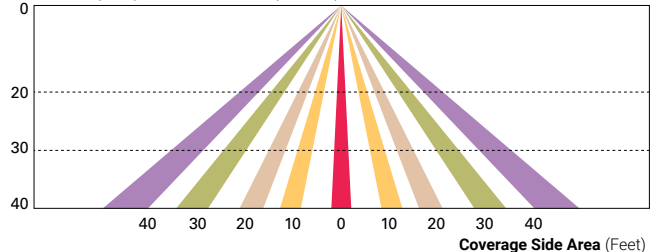

**LumenSafe (LD)** The LumenSafe integrated network camera is a streamlined, outdoor-ready camera that provides high definition video surveillance. This IP camera solution is optimally designed to integrate into virtually any video management system or security software platform of choice. No additional wiring is needed beyond providing line power to the luminaire. LumenSafe features factory-installed power and networking gear in a variety of networking options allowing security integrators to design the optimal solution for active surveillance.

# Steel Poles



## SSS SQUARE STRAIGHT STEEL

Catalog #		Type
Project		
Comments		Date
Prepared by		

### FEATURES

- ASTM Grade steel base plate with ASTM A366 base cover
- Hand hole assembly 3" x 5" on 5" and 6" pole; and 2" x 4" on 4" pole
- 10'-39" mounting heights
- Drilled or tenon (specify)

### DESIGN CONSIDERATIONS - VIBRATIONS AND NON-GROUND MOUNTED INSTALLATIONS

The information contained herein is for general guidance only and is not a replacement for professional judgment. Design considerations for wind-induced vibrations and non-ground mounted installations (e.g., installations on bridges or buildings) are not included in this document. Consult with a professional, and local and federal standards, before ordering to ensure product is appropriate for the intended purpose and installation location. Refer to the Cooper Lighting Solutions Light Pole White Paper for risk factors and design considerations. [Learn more.](#)

**NOTE:** The Limited Warranty for this product specifically excludes fatigue failure or similar damage resulting from vibration, harmonic oscillation or resonance.

Specifications and dimensions subject to change without notice. Consult your lighting representative at Cooper Lighting Solutions or visit [www.cooperlighting.com](http://www.cooperlighting.com) for available options, accessories and ordering information.

### ORDERING INFORMATION

SAMPLE NUMBER: SSA5A20SFM1XG

Product Family	Shaft Size (Inches) <sup>1</sup>	Wall Thickness (Inches)	Mounting Height (Feet)	Base Type	Finish	Mounting Type	Number and Location of Arms	Arm Lengths (Feet)	Options (Add as Suffix)
SSS=Square Straight Steel	4=4"	A=0.120"	10=10'	S=Square Steel Base	F=Dark Bronze	2=2-3/8" O.D. Tenon (4" Long)	1=Single	X=None	A=1/2" Tapped Hub <sup>3</sup> B=3/4" Tapped Hub <sup>3</sup> C=Convenience Outlet <sup>4</sup> E=GFCI Convenience Outlet <sup>4</sup> G=Ground Lug H=Additional Hand Hole <sup>5</sup> V=Vibration Dampener
	5=5"	M=0.188"	15=15'		G=Galvanized Steel	3=3-1/2" O.D. Tenon (5" Long)	2=2 at 180°	2=2'	
	6=6"	X=0.250"	20=20'		J=Summit White	4=4" O.D. Tenon (6" Long)	3=Triple <sup>2</sup>	3=2.5'	
			25=25'		K=Carbon Bronze	9=3" O.D. Tenon (4" Long)	4=4 at 90°	4=4"	
			30=30'	L=Dark Platinum	6=2-3/8" O.D. Tenon (6" Long)	5=2 at 90°	6=6"		
			35=35'	R=Hartford Green	7=4" O.D. Tenon (10" Long)	X=None	8=8"		
			39=39'	S=Silver	A=Type A Drilling				
				T=Graphite Metallic	C=Type C Drilling				
				V=Grey	E=Type E Drilling				
				W=White	F=Type F Drilling				
				X=Custom Color	G=Type G Drilling				
				Y=Black	J=Type J Drilling				
					K=Type K Drilling				
					M=Type M Drilling				
					N=Type N Drilling				
					R=Type R Drilling				
					S=Standard Upsweep Arm <sup>6</sup>				
					Z=Type Z Drilling				

**NOTES:** 1. All shaft sizes nominal. 2. Square poles are 3 at 90°, round poles are 3 at 120°. 3. Tapped Hub is located 5' below the pole top and on the same side of pole as hand hole, unless specified otherwise. 4. Outlet is located 4' above base and on same side of pole as hand hole, unless specified otherwise. Receptacle not included, provision only. 5. Additional hand hole is located 12" below pole top and 90° from standard hand hole location, unless otherwise specified. 6. Arm must be ordered separately.

### ANCHORAGE DATA

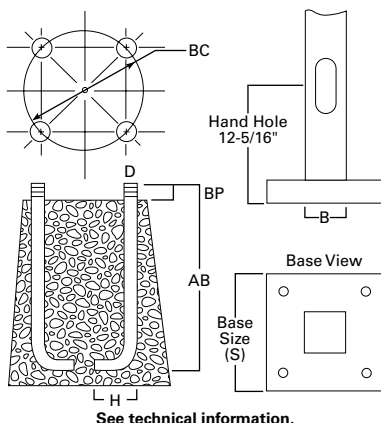

Pole	Template Number	Bolt Number	Bolt Circle (inches)	Number of Bolts	Bolt Size (inches)
SSS4	TMP1	AB1	8.5 - 11.0	4	3/4 x 25 x 3
SSS5	TMP1	AB1	11.0	4	3/4 x 25 x 3
SSS6	TMP2	AB3	12.5	4	1 x 36 x 4

**EFFECTIVE PROJECTED AREA (At Pole Top)**

Mounting Height (Feet)	Catalog Number <sup>1,2</sup>	Wall Thickness (Inches)	Base Square <sup>3</sup> (Inches)	Bolt Circle Diameter (Inches)	Anchor Bolt Projection <sup>3</sup> (Inches)	Shaft Size <sup>3</sup> (Inches)	Anchor Bolt Diameter x Length x Hook (Inches)	Net Weight (Pounds)	Maximum Effective Projected Area (Square Feet) <sup>4</sup>				Max. Fixture Load - Includes Bracket (Pounds)
									80 mph	90 mph	100 mph	110 mph	
MH			S	BC	BP	B	D x AB x H						
10	SSS4A10S	0.120	10-1/2	11	4-1/2	4	3/4 x 25 x 3	85	30.0	22.0	17.0	13.0	100
15	SSS4A15S	0.120	10-1/2	11	4-1/2	4	3/4 x 25 x 3	118	15.0	11.5	8.7	6.5	100
20	SSS4A20S	0.120	10-1/2	11	4-1/2	4	3/4 x 25 x 3	150	8.7	5.9	3.9	2.5	150
20	SSS5A20S	0.120	10-1/2	11	4-1/2	5	3/4 x 25 x 3	183	15.4	11.1	7.9	5.5	150
25	SSS4A25S	0.120	10-1/2	11	4-1/2	4	3/4 x 25 x 3	181	3.7	1.7	0.3	--	200
25	SSS5A25S	0.120	10-1/2	11	5	5	3/4 x 25 x 3	222	9.3	6.0	3.5	1.6	200
25	SSS6A25S	0.120	12-1/2	12-1/2	5	6	1 x 36 x 4	284	9.9	6.1	3.5	1.2	200
30	SSS5A30S	0.120	10-1/2	11	4-1/2	5	3/4 x 25 x 3	260	4.7	2.1	--	--	200
30	SSS5M30S	0.188	10-1/2	11	4-1/2	5	3/4 x 25 x 3	392	10.4	6.4	3.5	1.5	200
30	SSS6A30S	0.120	12-1/2	12-1/2	5	6	1 x 36 x 4	330	4.3	1.4	--	--	200
30	SSS6M30S	0.188	12-1/2	12-1/2	5	6	1 x 36 x 4	489	19.0	13.0	8.7	5.6	200
35	SSS5M35S	0.188	10-1/2	11	4-1/2	5	3/4 x 25 x 3	453	5.8	2.8	--	--	200
35	SSS6M35S	0.188	12-1/2	12-1/2	5	6	1 x 36 x 4	564	12.8	7.2	3.7	1.0	200
35	SSS6X35S	0.250	12-1/2	12-1/2	5	6	1 x 36 x 4	738	16.5	11.0	6.8	3.5	200
39	SSS6M39S	0.188	12-1/2	12-1/2	5	6	1 x 36 x 4	618	7.3	3.0	--	--	300
39	SSS6X39S	0.250	12-1/2	12-1/2	5	6	1 x 36 x 4	816	13.0	7.0	3.7	0.8	300

**EFFECTIVE PROJECTED AREA (Two Feet Above Pole Top)**

Mounting Height (Feet)	Catalog Number <sup>1,2</sup>	Wall Thickness (Inches)	Base Square <sup>3</sup> (Inches)	Bolt Circle Diameter (Inches)	Anchor Bolt Projection <sup>3</sup> (Inches)	Shaft Size <sup>3</sup> (Inches)	Anchor Bolt Diameter x Length x Hook (Inches)	Net Weight (Pounds)	Maximum Effective Projected Area (Square Feet) <sup>4</sup>				Max. Fixture Load - Includes Bracket (Pounds)
									80 mph	90 mph	100 mph	110 mph	
MH			S	BC	BP	B	D x AB x H						
10	SSS4A10S	0.120	10-1/2	11	4-1/2	4	3/4 x 25 x 3	85	23.0	17.5	14.0	11.0	100
15	SSS4A15S	0.120	10-1/2	11	4-1/2	4	3/4 x 25 x 3	118	13.4	10.0	7.5	5.7	100
20	SSS4A20S	0.120	10-1/2	11	4-1/2	4	3/4 x 25 x 3	150	7.6	5.2	3.4	2.1	150
20	SSS5A20S	0.120	10-1/2	11	4-1/2	5	3/4 x 25 x 3	183	13.8	9.9	7.1	4.9	150
25	SSS4A25S	0.120	10-1/2	11	4-1/2	4	3/4 x 25 x 3	181	3.4	1.6	0.3	--	200
25	SSS5A25S	0.120	10-1/2	11	5	5	3/4 x 25 x 3	222	8.5	5.5	3.2	1.5	200
25	SSS6A25S	0.120	12-1/2	12-1/2	5	6	1 x 36 x 4	284	9.1	5.6	3.0	1.2	200
30	SSS5A30S	0.120	10-1/2	11	4-1/2	5	3/4 x 25 x 3	260	1.8	--	--	--	200
30	SSS5M30S	0.188	10-1/2	11	4-1/2	5	3/4 x 25 x 3	392	9.6	5.9	1.9	0.2	200
30	SSS6A30S	0.120	12-1/2	12-1/2	5	6	1 x 36 x 4	330	4.1	1.3	--	--	200
30	SSS6M30S	0.188	12-1/2	12-1/2	5	6	1 x 36 x 4	489	18.5	12.5	8.4	5.3	200
35	SSS5M35S	0.188	10-1/2	11	4-1/2	5	3/4 x 25 x 3	453	5.5	2.4	--	--	200
35	SSS6M35S	0.188	12-1/2	12-1/2	5	6	1 x 36 x 4	564	11.8	7.0	3.5	1.0	200
35	SSS6X35S	0.250	12-1/2	12-1/2	5	6	1 x 36 x 4	738	16.0	10.5	6.4	3.4	200
39	SSS6M39S	0.188	12-1/2	12-1/2	5	6	1 x 36 x 4	618	7.0	2.4	--	--	300
39	SSS6X39S	0.250	12-1/2	12-1/2	5	6	1 x 36 x 4	816	12.0	6.7	3.0	0.5	300

- NOTES:
1. Catalog number includes pole with hardware kit. Anchor bolts not included. Before installing, make sure proper anchor bolts and templates are obtained.
  2. Tenon size or machining for rectangular arms must be specified. Hand hole position relative to drill location.
  3. Shaft size, base square, anchor bolts and projections may vary slightly. All dimensions nominal.
  4. EPAs based on shaft properties with wind normal to flat. EPAs calculated using base wind velocity as indicated plus 30% gust factor.

## VIBRATION

---

Vibrations may cause damage to structures, including poles. Vibrations are unpredictable, and there are many factors and variables that can cause damaging vibrations. Many wind conditions exist that can create damaging vibrations to poles and luminaires, such as constant winds between 10-30 mph. Although all pole types can experience vibration, straight square poles seem to be most prone. Vibration dampers and/or a round tapered design may be used to mitigate damage from vibrations, but there is no guarantee damaging vibrations will be prevented. Vibration dampers are not included with this pole but can be ordered separately. Consult with a professional, and local and federal standards, to ensure this pole is appropriate for the intended purpose and installation location. Refer to Cooper Lighting Solutions' Light Pole White Paper for risk factors and design considerations.

## MAINTENANCE

---

Perform inspections periodically. A prudent inspection schedule would be: one week after installation, one month after installation, yearly after installation, and following any major wind event. During the inspection, check the poles for cracks. If cracks are detected, remedial action is required. Recheck anchor bolt torques and re-tighten according to the recommended torque values. Check for missing covers and pole caps and replace as necessary. Check the pole for corrosion and deterioration of the finish. Should there be corrosion or deterioration, take remedial action to correct.

**WARNING:** Customer is responsible for engineering analysis to confirm pole and fixture compatibility for all applications. Refer to pole white paper WP513001EN for additional support information. Before installing, make sure proper anchor bolts and templates are obtained. The use of unauthorized accessories such as banners, signs, cameras or pennants for which the pole was not designed voids the pole warranty and may result in pole failure causing serious injury or property damage. Information regarding total loading capacity can be supplied upon request. The pole warranty is void unless poles are used and installed as a complete pole and luminaire combination. This warranty specifically excludes failure as the result of a third party act or omission, misuse, unanticipated uses, fatigue failure or similar phenomena resulting from induced vibration, harmonic oscillation or resonance associated with movement of air currents around the product.

Specifications and dimensions subject to change without notice. Consult your lighting representative at Cooper Lighting Solutions or visit [www.cooperlighting.com](http://www.cooperlighting.com) for available options, accessories and ordering information.

DATE: \_\_\_\_\_ LOCATION: \_\_\_\_\_  
 TYPE: \_\_\_\_\_ PROJECT: \_\_\_\_\_  
 CATALOG #: \_\_\_\_\_

# LNC

COMPACT LED LITEPAK

## FEATURES

- Compact LNC LED is designed for perimeter illumination and available in 3 lumen packages for safety, security and identity
- 3000K, 4000K, 5000K and Amber color temperatures
- Up to 4:1 spacing to mounting height ratio means fewer fixtures to install
- Acrylic diffuser included! Use for applications near entrances or locations where reduced brightness is desired. (Maximum spacing with diffuser 30ft)
- Die-cast aluminum housing with decorative Laredo styling
- Full cut-off neighbor friendly
- Listed to UL1598 for use in wet locations

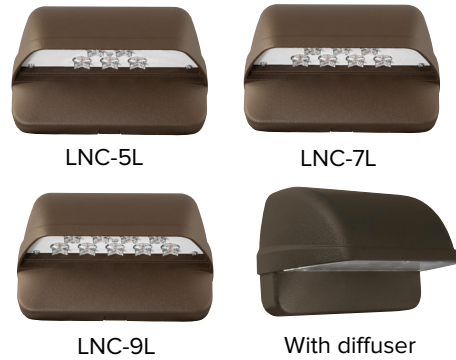

### RELATED PRODUCTS

- [LNC2](#)     
 [INC3](#)     
 [LNC4](#)

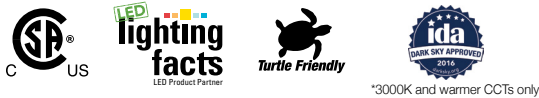

## SPECIFICATIONS

### CONSTRUCTION

- Decorative die-cast aluminum housing and door
- Rugged design protects internal components and provides excellent thermal management for long life
- Powder paint finishes provide lasting appearance in outdoor environments
- Full cut-off distribution; Ambient diffuser included, use for applications near entrances or locations where reduced brightness is desired

### OPTICS

- Drivers are 120-277V, 50/60Hz Type II, III and Type IV lenses provide wide lateral spread
- 3000K - 80 CRI, 4000K - 70 CRI, and 5000K - 70 CRI, CCT nominal
- Drivers have greater than .90 power factor and less than 20% Total Harmonic Distortion

### INSTALLATION

- Quick mount adapter provides quick installation, designed for recessed box 4" square junction box

### ELECTRICAL

- 60,000 hours minimum LED life at L96 rating per IESNA TM-21-11
- Minimum operating temperature is -40°C/-40°F
- 0-10V dimming 120-277V only
- LNC5L – 5 LEDs, Types II, III or IV available, see page 2 for electrical details
- LNC7L – 7 LEDs, Type II, III or IV available, see page 2 for electrical details
- LNC9L – 9 LEDs, Types II, III or IV available, see page 2 for electrical details

### CONTROLS

- Photocontrol option is available to provide dusk-to-dawn control for additional energy savings

### CERTIFICATIONS

- Listed and labeled to UL 1598 for wet locations, 25°C ambient environments

### WARRANTY

- 5 year limited warranty
- See [HLI Standard Warranty](#) for additional information

KEY DATA	
Lumen Range	800–2100
Wattage Range	13–22
Efficacy Range (LPW)	64–95
Fixture Projected Life (Hours)	L96>60K
Weights lbs. (kg)	9.6 (24.5)

# LNC

COMPACT LED LITEPAK

## ORDERING GUIDE

Example: LNC-5L-U-3K-2-BLT-PCU

CATALOG #

### ORDERING INFORMATION

Series	# LEDs	Voltage	CCT/CRI	IES Distribution	Finish	Mounting
<b>LNC</b> LNC Zero Uplight	<b>5L</b> 5 LEDs <b>7L</b> 7 LEDs <b>9L</b> 9 LEDs	<b>U</b> 120-277V 1 120V 2 208V 3 240V 4 277V	<b>3K</b> 3000K nominal, 70 CRI <b>4K</b> 4000K nominal, 70 CRI <b>5K</b> 5000K nominal, 70 CRI <b>AM</b> Amber (590 μm available for "Turtle Friendly"/ observatory applications, 350mA (consult factory) <sup>1</sup>	2 Type II <b>3 Type III</b> 4 Type IV	<b>BLT</b> Black Matte Textured <b>BLS</b> Black Gloss Smooth <b>DBT</b> Dark Bronze Matte Textured <b>DBS</b> Dark Bronze Gloss Smooth <b>GTT</b> Graphite Matte Textured <b>LGS</b> Light Grey Gloss Smooth <b>PSS</b> Platinum Silver Smooth <b>WHT</b> White Matte Textured <b>WHS</b> White Gloss Smooth <b>VGT</b> Verde Green Textured <b>Color Option</b> <b>CC</b> Custom Color	<b>PCU</b> Universal Button Photocell

Notes:  
 1 Amber LEDs only available on 7L and 9L configurations, 350mA

## REPLACEMENT PARTS AND ACCESSORIES

Catalog Number	Description
<input type="checkbox"/> 93039574	Frosted comfort shield, improved uniformity with only 5% reduction

## PERFORMANCE DATA

# Of LEDs	Nominal Wattage	System Watts	Dist. Type	5K (5000K NOMINAL 70 CRI)		4K (4000K NOMINAL 70 CRI)		3K (3000K NOMINAL 80 CRI)		AM (<580 nm wave-length)		
				Lumens	LPW*	Lumens	LPW	Lumens	LPW	Lumens	System Watts	LPW*
5	STD. (700mA) AM (350mA)	13W	2	1,150	88.5	1,052	81	883	68	-	-	-
			3	1,132	87	1,077	83	833	64	-	-	-
			4	1,146	88	1,053	81	849	65	-	-	-
7		17W	2	1,515	89	1,369	80.5	1,272	75	-	-	-
			3	1,500	88	1,539	90.5	1,392	82	268	6.6	59
			4	1,557	91.5	1,535	90	1,425	84	-	-	-
9	22W	2	2,069	94	2,033	92	1,588	72	-	-	-	
		3	2,024	92	1,989	90	1,623	74	-	-	-	
		4	2,095	95	2,059	93.5	1,680	76	382	8.3	46	

\* Lumen values are from photometric tests performed in accordance with IESNA LM-79-08. Data is considered to be representative of the configurations shown. Actual performance may differ as a result of end-user environment and application. Please consult IES files for BUG ratings.

## PROJECTED LUMEN MAINTENANCE

Ambient Temperature	OPERATING HOURS					
	0	25,000	50,000	TM-21-11* L96 60,000	100,000	L70 (Hours)
25°C / 77°F	1.00	0.97	0.97	0.96	0.95	>791,000
40°C / 104°F	0.99	0.96	0.96	0.96	0.94	>635,000

\* Projected per IESNA TM-21-11\* (Nichia 219B, 700mA, 85°C Ts, 10,000hrs) Data references the extrapolated performance projections for the LNC-12LU-5K base model in a 40°C ambient, based on 10,000 hours of LED testing per IESNA LM-80-08

# LNC

COMPACT LED LITEPAK

## ELECTRICAL DATA

# OF LEDS	Drive Current (mA)	Input Voltage (V)	Oper. Current (Amps)	System Power (W)
9	STD. (700mA)	120	0.11	13
		277	0.05	
12	STD. (700mA)	120	0.14	17
		277	0.07	
12	STD. (700mA)	120	0.17	22
		277	0.09	

## LUMINAIRE AMBIENT TEMPERATURE FACTOR (LATF)

Ambient Temperature		Lumen Multiplier
0° C	32° F	1.02
10° C	50° F	1.01
20° C	68° F	1.00
25° C	77° F	1.00
30° C	86° F	1.00
40° C	104° F	0.99
50° C	122° F	0.98

Use these factors to determine relative lumen output for average ambient temperatures from 0-50°C (32-122°F).

## PHOTOMETRY

The following diagrams represent the general distribution options offered for this product. For detailed information on specific product configurations, see [website photometric test reports](#).

LNC9LU – Type II

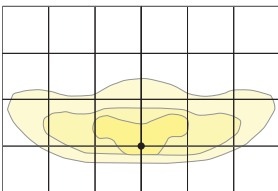

LNC9LU – Type III

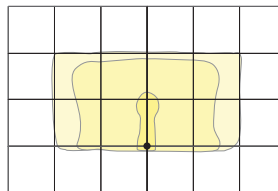

LNC9LU – Type IV

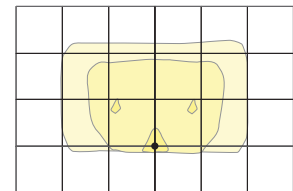

## DIMENSIONS

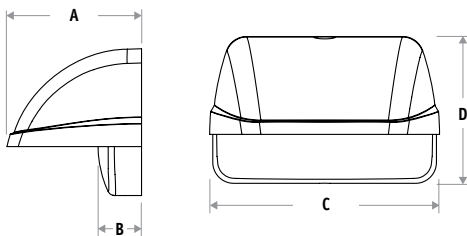

A	B	C	D
4.81" (122 mm)	1.55" (39 mm)	8.22" (209 mm)	5.25" (133 mm)

## ADDITIONAL INFORMATION

### SHIPPING INFORMATION

Catalog Number	G.W(kg)/CTN	Carton Dimensions			Carton Qty. per Master Pack
		Length Inch (cm)	Width Inch (cm)	Height Inch (cm)	
LNC-5LU	9.6 (4.36)	14.5 (37)	9.6 (24.5)	6.8 (17.5)	2
LNC-7LU	9.6 (4.36)	14.5 (37)	9.6 (24.5)	6.8 (17.5)	2
LNC-9LU	9.6 (4.36)	14.5 (37)	9.6 (24.5)	6.8 (17.5)	2

## USE OF TRADEMARKS AND TRADE NAMES

All product and company names, logos and product identifies are trademarks™ or registered trademarks® of Hubbell Lighting, Inc. or their respective owners. Use of them does not necessarily imply any affiliation with or endorsement by such respective owners.

## DESCRIPTION

The Halo Surface LED Downlight (SLD) uses advanced LED technology to create an ultra-low profile **Z1** with the performance and look of a traditional downlight. SLD4 is designed for installation in many 3-1/2" and 4" round or octagon junction boxes. May also retrofit in 4" aperture IC and Non-IC recessed housings\*. Dedicated LED wiring connector meets high-efficacy code requirement in recessed downlighting. Suitable for residential or commercial installations. Ideal for closets, storage areas, attics and basements. Compliant with NFPA® 70, NEC® Section 410.16 (A)(3) and 410.16 (C)(5).

## SPECIFICATION FEATURES

### CONSTRUCTION

- Die cast aluminum trim ring and die formed aluminum frame

### OPTICS

- WaveStream™ technology provides uniform luminance from a low profile flat lens
- AccuAim™ optics provide directional control for the "cone-of-light" beam distribution of a traditional downlight
- Precision molded lens features high transmission polymer with UV stabilized protecting film

### DESIGNER TRIMS

Accessories (sold separately) SLD designer trims are accessory rings that attach to the SLD for a permanent finish. Refer to SLD accessories specification sheet for details.

- White (Paintable)
- Satin Nickel
- Tuscan Bronze

### ELECTRICAL JUNCTION BOX MOUNTING

- SLD may be used in compatible electrical junction boxes in direct contact with insulation including spray foam insulation
- Suitable for installation in many 3-1/2" and 4" octagon and round electrical junction boxes. **Note:** Driver consumes 3 cubic inches of junction box.
- Installer must ensure compatibility of fit, wiring and proper mounting in the electrical junction box. This includes all applicable national and local electrical and building codes.
- Proprietary Slot-N-Lock quick installation system for junction box installation

- T-bracket with Slot-N-Lock mounting tabs included.

### RECESSED HOUSING MOUNTING Friction Blade

- Pre-installed precision formed friction blades included
- Friction blade design allows the SLD to be installed in any position within the housing aperture (360 degrees)
- \* Note:** Not for use in recessed housings in direct contact with spray foam insulation refer to NEMA LSD 57-2013

### LED

- Trilateral linear LED assembly is integrated in trim perimeter.
- Color Temperature: 2700K, 3000K, 3500K, 4000K
- CRI options: 80 and 90\*
  - 90 CRI can be used to comply with California Title 24 High Efficacy requirements. Certified to California Appliance Efficiency Database under JA8
- L70 at 50,000 hours projected in accordance with TM-21

### WARRANTY

Eaton provides a five year limited warranty on the SLD LED

### LED CHROMATICITY

- A tight chromaticity specification ensures LED color uniformity, sustainable Color Rendering Index (CRI) and Correlated Color Temperature (CCT) over the useful life of the LED
- LED chromaticity of 3 SDCM exceeds ENERGY STAR® color standards per ANSI C78.377-2008
- 90 CRI model features high color performance with R9 greater than 50

Catalog #		Type
Project		
Comments		Date
Prepared by		

- Every Halo LED is quality tested, measured, and serialized in a permanent record to register lumens, wattage, CRI and CCT.
- Halo LED serialized testing and measurement ensures color and lumen consistency on a per-unit basis, and validates long-term product consistency over time

### ELECTRICAL CONNECTIONS

#### Junction Box

- Compatible with many 3-1/2" x 2" and 4" x 1-1/2" round and octagon boxes (2-1/8" deep boxes recommended)
  - Supply Wire Adapter with LED quick connector included
- #### Recessed Housings
- LED connector is compatible with Halo 4" H995 and H245 Series LED Housings
  - LED Connector meets California Title-24 high-efficacy luminaire standard as a non-screw base
  - The included E26 Edison screw-base adapter provides capability for retrofit\*
  - LED connector is a non-screwbase luminaire disconnect for tool-less installation

### LED DRIVER

- Driver is a 120V input high efficiency, dimmable electronic power supply providing DC power to the LED array
- Driver features high power factor, low THD, and has integral thermal protection in the event of over temperature or internal failure.
- Driver is replaceable if it should be required



**SLD4058xxWH**  
80CRI  
2700K, 3000K, 3500K,  
and 4000K

**SLD4059xxWH**  
90CRI  
2700K, 3000K, 3500K,  
and 4000K

**4" Surface LED Downlight**

**Suitable for ceiling or wall electrical junction boxes**

**Suitable for 4" recessed housing retrofit (IC, Non-IC & AIR-TITE™)**

## ENERGY DATA

	80 CRI	90 CRI
Lumens (4000K models)	800	710
Input Voltage	120V	120V
Frequency	50/60 Hz	50/60 Hz
Input Current	0.10 A	0.10 A
Input Power	12.2 W	12 W
Efficiency (4000K models)	66 lm/W	59 lm/W
THD	≤ 20%	
Power Factor	≥ 0.90	
T Ambient	-30 - +40°C	
Sound Rating	Class A	

## NOMENCLATURE

**SLD405830WH**  
405 = 4" SLD  
8 = >80 CRI  
30 = 3000K  
WH = Matte White

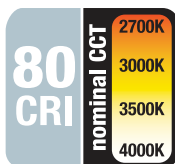

Refer to ENERGY STAR® Certified Products List.



Refer to ENERGY STAR® Qualified Products List. Can be used to comply with California Title 24 High Efficacy requirements. Certified to California Appliance Efficiency Database under JA8. Indoor LED nominal CCT of 4000K or less.

**DIMMING**

- Designed for continuous dimming capability to nominally 5% with many 120V Leading Edge (LE) and Trailing Edge (TE) phase control dimmers. Dimming to 5% is best assured using dimmers with low end trim adjustment. Consult dimmer manufacturer for compatibility and conditions of use. (Note some dimmers require a neutral in the wallbox.)

**COMPLIANCE**

- cULus Listed ceiling and wall
- cULus Damp Location listed ceiling and wall
- cULus Wet Location Listed, ceiling only (shower rated)
- Suitable for use in closets, compliant with NFPA® 70, NEC® Section 410.16 (A)(3) and 410.16 (C)(5)

- SLD may be used in compatible electrical junction boxes in direct contact with insulation including spray foam insulation
- May be installed in IC recessed housings in direct contact with insulation (Not for use in recessed housings in direct contact with spray foam insulation. Refer to NEMA LSD 57-2013)
- UL Classified when used in retrofit with listed housings (See Housing Compatibility)
- EMI/RFI: meets FCC 47CFR Part 15 Class B limits, and is suitable for use in residential and commercial installations
- Airtight certified per ASTM E283 (not exceeding 2.0 CFM under 57 Pascals pressure difference)
- 90 CRI: Can be used to comply with California Title 24 High Efficacy requirements.
- 80 CRI: Can be used to comply with California Title 24 Non-Residential Lighting Controls requirements as a LED luminaire.
- Can be used for International Energy Conservation Code (IECC)
- ENERGY STAR® Certified luminaire - consult ENERGY STAR® Certified Product List
- Contains no mercury or lead and RoHS compliant.
- Photometric testing in accordance with IES LM-79
- Lumen maintenance projections in accordance with IES LM-80 and TM-21



**SLD4058xxWH**  
80CRI  
2700K, 3000K, 3500K,  
and 4000K

**SLD4059xxWH**  
90CRI  
2700K, 3000K, 3500K,  
and 4000K

**4" Surface LED Downlight**

**Suitable for ceiling or wall electrical junction boxes**

**Suitable for 4" recessed housing retrofit (IC, Non-IC & AIR-TITE™)**

**DIMENSIONS**

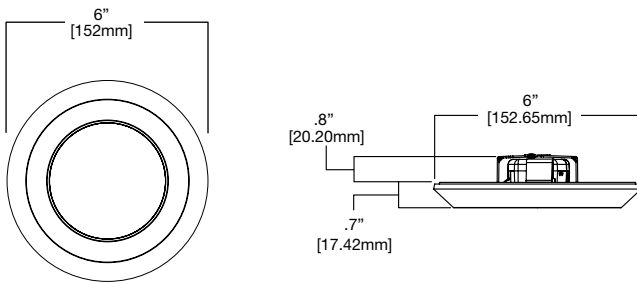

**ORDERING INFORMATION**

**SAMPLE NUMBER:** SLD405927WH SLD4TRMSN

**Junction Box Installation:** Order junction box separately, as supplied by others, to complete installation.

**Recessed Installation:** Order Halo recessed housing separately to complete installation.

Models	Color Rendering Index	Color Temperature (CCT)	Finish	Accessories
<b>SLD405= 4" Surface LED Downlight, 120V</b>  California non-E26 Models <b>SLD405927WH-CA</b> <b>SLD405930WH-CA</b> <b>SSLD405935WH-CA</b> <b>SSLD405940WH-CA</b>	<b>8=80 CRI</b> <b>9=90 CRI</b>	<b>27=2700K</b> <b>30=3000K</b> <b>35=3500K</b> <b>40=4000K</b>	<b>WH=White</b>	<b>Designer Trims</b> Fit over the SLD4 for a designer finish <b>SLD4TRMSN=4"</b> SLD Satin Nickel <b>SLD4TRMTBZ=4"</b> SLD Tuscan Bronze <b>SLD4TRMWH=4"</b> SLD White (paintable)  <b>J-Box Spacer Extension Ring</b> Add 15/16" depth when SLD driver cannot fit into installed junction box <b>SLD4EXT=4"</b> Surface LED J-Box Extender, 7.75" O.D.  <b>RAD Adapters</b> When junction box is mounted flat on a ceiling or beam surface (not recessed in ceiling) <b>SLD4RAD=4"</b> SLD Round Surface J-Box Adapter, 6.15" O.D. (For 4-inch round or octagon junction boxes)  <b>Spare Parts</b> <b>SLD4ACCKIT=4"</b> Accessory Parts Replacement Kit (Screwbase adapter, torsion springs, friction blades) <b>SLD4BRKT=4"</b> Junction Box Bracket & Screws  Refer to SLD Accessories specification sheet for further information.

**HOUSING COMPATIBILITY**

The SLD4 is UL Listed in Halo recessed housings, and is UL Classified for use with any 4 inch diameter recessed housing constructed of steel or aluminum with an internal volume that exceeds 62.3 in<sup>3</sup> in addition to those noted below:

<b>Compatible Halo LED Housings with LED luminaire connector (high-efficacy compliant)</b>		
<b>HALO LED</b>	<b>Recessed Can Size</b>	<b>Catalog Number</b>
		<b>4"</b>
<b>Compatible Halo Incandescent E26 Screwbase Housings</b>		
<b>HALO</b>	<b>Recessed Can Size</b>	<b>Catalog Number</b>
	<b>4"</b>	H99ICAT, H99TAT, H99RTAT, E4ICATSB, E4TATSB, E4RTATSB

**COMPATIBLE WITH EATON'S CROUSE-HINDS JUNCTION BOXES**

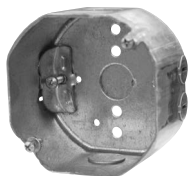

**TP316**  
for non-metallic cable  
4" x 4" x 2-1/8"  
(102mm x 102mm x 54mm)

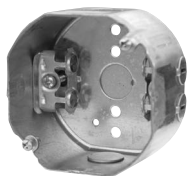

**TP317**  
for metal clad cable  
4" x 4" x 2-1/8"  
(102mm x 102mm x 54mm)

- TP316 - for non-metallic cable
- TP317 - for metal clad cable
- UL Listed
- Refer to [www.crouse-hinds.com](http://www.crouse-hinds.com)

**COMPATIBLE WITH MANY OTHER JUNCTION BOXES\***



**4" octagon light fixture/fan steel box**  
4" x 4" x 2-1/8"  
(102mm x 102mm x 54mm)



**4" octagon steel box**  
4" x 4" x 1-1/2"  
(102mm x 102mm x 38mm)

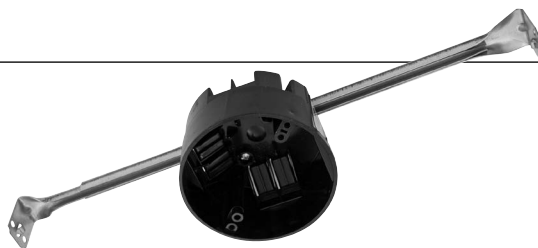

**4" round new work non-metallic box with hanger bar assembly**  
4" diameter x 2-3/16" (102mm x 56mm)



**4" round new work non-metallic light fixture/fan box**  
4" diameter x 2-3/16"  
(102mm x 56mm)



**3-1/2" round new work non-metallic ceiling box**  
3-1/2" diameter x 2-3/4"  
(89mm x 70mm)



**3-1/2" round old work non-metallic box**  
4-1/4" O.D. flange, 3-1/2" I.D. x 2-5/8"  
(108mm O.D., 89mm I.D. x 67mm)



**4" round surface mount box**  
4" diameter x 1-1/2"  
(102mm x 38mm)  
Requires SLD4RAD adapter

\*This is a representative list of compatible junction boxes only. Information contained in this literature about other manufacturers' products is from published information made available by the manufacturer and is deemed to be reliable, but has not been verified. Eaton makes no specific recommendation on product selection and there are no warranties of performance or compatibility implied. Installer must determine that site conditions are suitable to allow proper installation of the SLD mounting bracket in the box.

**PRODUCT DATA**

Cat No.	CRI	CCT	Lumens	Power (W)	LPW
SLD405827WH	81	2700	720	12.2	59
SLD405830WH	81	3000	750	12.2	61
SLD405835WH	81	3500	780	12.2	64
SLD405840WH	81	4000	800	12.2	66
SLD405927WH	92	2700	650	12	54
SLD405930WH	92	3000	670	12	56
SLD405935WH	92	3500	690	12	58
SLD405940WH	92	4000	710	12	59

Performance values are presented as typical for the model(s) indicated. Field results may vary.

**LIGHTING FACTS®**

**SLD405827WH - 80 CRI**

**Lighting facts®**  
A Program of the U.S. DOE

Light Output (Lumens) 720  
Watts 12.2  
Lumens per Watt (Efficacy) 59.02

Color Accuracy  
Color Rendering Index (CRI) 81

Light Color  
Correlated Color Temperature (CCT) 2700 (Warm White)

2700K 3000K Bright White 4500K Daylight 6500K

Registration Number: F4QJ-78R3JK (4/17/2015)  
Model Number: SLD405827WH  
Type: Luminaire - Downlight

**SLD405830WH - 80 CRI**

**Lighting facts®**  
A Program of the U.S. DOE

Light Output (Lumens) 750  
Watts 12.2  
Lumens per Watt (Efficacy) 61.48

Color Accuracy  
Color Rendering Index (CRI) 81

Light Color  
Correlated Color Temperature (CCT) 3000 (Bright White)

2700K 3000K Bright White 4500K Daylight 6500K

Registration Number: F4QJ-C7D2C3 (5/7/2015)  
Model Number: SLD405830WH (Upgrade 942015)  
Type: Luminaire - Downlight

**SLD405835WH - 80 CRI**

**Lighting facts®**  
A Program of the U.S. DOE

Light Output (Lumens) 780  
Watts 12.2  
Lumens per Watt (Efficacy) 63.93

Color Accuracy  
Color Rendering Index (CRI) 81

Light Color  
Correlated Color Temperature (CCT) 3500 (Bright White)

2700K 3000K Bright White 4500K Daylight 6500K

Registration Number: F4QJ-B618FN (4/17/2015)  
Model Number: SLD405835WH  
Type: Luminaire - Downlight

**SLD405840WH - 80 CRI**

**Lighting facts®**  
A Program of the U.S. DOE

Light Output (Lumens) 800  
Watts 12.2  
Lumens per Watt (Efficacy) 65.57

Color Accuracy  
Color Rendering Index (CRI) 81

Light Color  
Correlated Color Temperature (CCT) 4000 (Bright White)

2700K 3000K Bright White 4500K Daylight 6500K

Registration Number: F4QJ-M8ZDPK (4/17/2015)  
Model Number: SLD405840WH  
Type: Luminaire - Downlight

**SLD405927WH - 90 CRI**

**Lighting facts®**  
A Program of the U.S. DOE

Light Output (Lumens) 650  
Watts 12  
Lumens per Watt (Efficacy) 54.17

Color Accuracy  
Color Rendering Index (CRI) 92

Light Color  
Correlated Color Temperature (CCT) 2700 (Warm White)

2700K 3000K Bright White 4500K Daylight 6500K

Registration Number: F4QJ-Q8MBG (4/17/2015)  
Model Number: SLD405927WH  
Type: Luminaire - Downlight

**SLD405930WH - 90 CRI**

**Lighting facts®**  
A Program of the U.S. DOE

Light Output (Lumens) 670  
Watts 12  
Lumens per Watt (Efficacy) 55.83

Color Accuracy  
Color Rendering Index (CRI) 92

Light Color  
Correlated Color Temperature (CCT) 3000 (Bright White)

2700K 3000K Bright White 4500K Daylight 6500K

Registration Number: F4QJ-14JH1 (5/7/2015)  
Model Number: SLD405930WH (Upgrade 042015)  
Type: Luminaire - Downlight

**SLD405935WH - 90 CRI**

**Lighting facts®**  
A Program of the U.S. DOE

Light Output (Lumens) 690  
Watts 12  
Lumens per Watt (Efficacy) 57.5

Color Accuracy  
Color Rendering Index (CRI) 92

Light Color  
Correlated Color Temperature (CCT) 3500 (Bright White)

2700K 3000K Bright White 4500K Daylight 6500K

Registration Number: F4QJ-2DFUT (4/17/2015)  
Model Number: SLD405935WH  
Type: Luminaire - Downlight

**SLD405940WH - 90 CRI**

**Lighting facts®**  
A Program of the U.S. DOE

Light Output (Lumens) 710  
Watts 12  
Lumens per Watt (Efficacy) 59.17

Color Accuracy  
Color Rendering Index (CRI) 92

Light Color  
Correlated Color Temperature (CCT) 4000 (Bright White)

2700K 3000K Bright White 4500K Daylight 6500K

Registration Number: F4QJ-1K230B (4/17/2015)  
Model Number: SLD405940WH  
Type: Luminaire - Downlight



# Scottsdale® Legacy (CRUS)

## LED Canopy Luminaire



### OVERVIEW

Lumen Package	6,000 - 22,000
Wattage Range	61 - 159
Efficacy Range (LPW)	95 - 148
Weight lbs(kg)	27 (12.2)

### QUICK LINKS

[Ordering Guide](#)[Performance](#)[Photometrics](#)[Dimensions](#)

## FEATURES & SPECIFICATIONS

### Construction

- Features a ultra-slim 3/4" profile die-cast housing, with flat glass lens. Unit is water-resistant, sealed and IP67 rated. Integral designed heat sink does not trap dirt and grime, ensuring cool running performance over the life of the fixture.
- Standard color is white and is finished with LSI's DuraGrip® polyester powder coat process. DuraGrip withstands extreme weather changes without cracking or peeling.
- Luminaire assembly incorporates a pressure stabilizing vent breather to prevent seal fatigue and failure.

### Optical System

- Features an array of select, mid-power, high brightness, high efficiency LED chips; 5000K, 4000K, 3000K color temperature, 70 CRI.
- Choice of Symmetrical or Asymmetrical, which directs light through a clear tempered glass lens, to provide a uniform distribution.
- Five Lumen Packages: VLW (9,000), LW (10,000), SS (13,000), HO (18,000), VHO (22,000).

### Electrical

- High performance factory programmable driver features over-voltage, under voltage, short-circuit and over temperature protection with integral surge protection

that meets IEEE C62.41.2 and ANSI C82.77-5 Location Category C Low standards. Additional 10kV surge protection device meets a minimum Category C Low standards (per ANSI/IEEE C62.41.2).

- Driver components are fully encased in potting for moisture resistance. Complies with IEC and FCC standards. 0-10 V dimming supplied standard with all drive currents.
- Die-cast aluminum, wet location rated driver/electrical enclosure is elevated above canopy deck to prevent water entry, provide easy "knock-out" connection of primary wiring and contributes to attaining the lowest operating temperatures available. Seals to optical housing via one-piece molded silicone gasket.
- Universal voltage power supply, 120-277 VAC, 50/60 HZ and 347-480 VAC, 50/60 HZ input.
- -40°C to 50°C (-40°F to +122°F) ambient operating temperature.
- Minimum 60,000 to 100,000 hours depending upon the ambient temperature of the installation location. See LSI website for specific guidance.

### Hazardous Location

- Designed for lighter than air fuel applications. Product is suitable for Class 1 Divisions 2 only when properly installed per LSI installation instructions. See lsi-industries.com for specific guidance. LW

and SS lumen packages only.

### Installation

- One-person installation.
- Installs in a 12" or 16" deck pan. Deck penetration consists of a 4" hole, simplifying installation and water sealing. Unit is designed to quickly retrofit into existing Scottsdale (4") hole as well as openings for Encore and Encore Top Access and to reconnect wiring for the SC/ECTA without having to relocate the conduit.
- Retro panels are available for existing Encores as well as kits for recessed and 2x2 installations (see separate spec sheets). Support brackets are provided standard, to prevent sagging of deck.

### Warranty

- LSI LED Fixtures carry a 5-year warranty or 10-year warranty with registration for petroleum applications only (contact your LSI representative for details).

### Listings

- UL and ETL listed to UL 1598, UL 8750 and other U.S. and International safety standards. Suitable for wet locations.
- Meets Buy American Act requirements.





# Scottsdale® Legacy LED Canopy Luminaire

## ORDERING GUIDE

[Back to Quick Links](#)

TYPICAL ORDER EXAMPLE: **CRUS SC LED SS 50 UE WHT**

Prefix	Distribution	Light Source	Drive Current	Color Temp	Input Voltage	Finish	Options
CRUS - LED Canopy Luminaire	SC - Symmetric	LED	VLW - Very Low Watt	50 - 5,000K	UE - Universal Voltage (120 - 277V)  347 - 480V	WHT - White BRZ - Bronze BLK - Black	HL <sup>2</sup> - Hazardous Location
	AC <sup>1</sup> - Asymmetric		LW - Low Watt	40 - 4,000K			
			SS - Super Saver HO - High Output VHO - Very High Output	30 - 3,000K			

### Notes:

- 1 - AC distribution utilizes a reflector which alters the look from a standard SC distribution.
- 2 - LW and SS lumen packages only

## PERFORMANCE

[Back to Quick Links](#)

DELIVERED LUMENS*											
Lumen Package	Distribution	3000K CCT			4000K CCT			5000K CCT			Avg. Watts
		Delivered Lumens	Efficacy	BUG Ratings	Delivered Lumens	Efficacy	BUG Ratings	Delivered Lumens	Efficacy	BUG Ratings	
VLW	SC	7933	130	B3-U0-G1	7977	131	B3-U0-G1	9055	148	B3-U0-G1	61
	AC	6687	110	B2-U0-G1	6723	110	B2-U0-G1	7632	125	B2-U0-G2	
LW	SC	9221	125	B3-U0-G1	9272	125	B3-U0-G1	10525	142	B3-U0-G1	74
	AC	7783	105	B2-U0-G1	7826	106	B2-U0-G1	8884	120	B2-U0-G2	
SS	SC	11980	122	B3-U0-G1	12046	128	B3-U0-G1	13674	140	B3-U0-G1	98
	AC	10159	104	B3-U0-G2	10215	104	B3-U0-G2	11595	118	B3-U0-G2	
HO	SC	16325	124	B3-U0-G1	16415	124	B3-U0-G1	18633	141	B3-U0-G1	132
	AC	13269	101	B3-U0-G2	13342	101	B3-U0-G2	15145	115	B3-U0-G2	
VHO	SC	19641	124	B4-U0-G2	19749	124	B4-U0-G2	22418	141	B4-U0-G2	159
	AC	15124	95	B3-U0-G2	15207	96	B3-U0-G2	17262	109	B3-U0-G2	

\*LED Chips are frequently updated therefore values are nominal.

RECOMMENDED LUMEN MAINTENANCE					
Ambient Temperature C	0 hrs.	25K hrs.	50K hrs.	75K hrs.	100K hrs
25	25	100%	97%	92%	88%
30	30	100%	97%	92%	88%
35	40	100%	95%	90%	85%
40	50	100%	94%	89%	83%

### FOOTNOTES:

- 1 - Lumen maintenance values at 25°C are calculated per TM-21 based on LM-80 data and in-situ luminaire testing.
- 2 - In accordance with IESNA TM-21-11, Projected Values represent interpolated value based on time durations that are within six times (6X) the IESNA LM-80-08 total test duration (in hours) for the device under testing ((DUT) i.e. the packaged LED chip).
- 3 - In accordance with IESNA TM-21-11, Calculated Values represent time durations that exceed six times NA LM-80-08 total test duration (in hours) for the device under testing ((DUT) i.e. the packaged LED chip).





## PHOTOMETRICS

[Back to Quick Links](#)

Luminaire photometry has been conducted by an accredited testing laboratory in accordance with IESNA LM-79-08. As specified by IESNA LM-79-08 the entire luminaire is tested as the source resulting in a luminaire efficiency of 100%.

See <http://www.lsi-industries.com/products/led-lighting-solutions.aspx> for detailed photometric data.

### CRUS-SC-SS-50

#### LUMINAIRE DATA

Wide Distribution	
Description	5000 Kelvin, 70 CRI
Delivered Lumens	13,674
Watts	97.9
Efficacy	140
IES Type	Type VS - Very Short
BUG Rating	B3-U0-G1

#### Zonal Lumen Summary

Zone	Lumens	%Luminaire
Low (0-30)°	3652.2	26.7%
Medium (30-60)°	7382.4	54.0%
High (60-80)°	2489.8	18.2%
Very High (80-90)°	149.4	1.1%
Uplight (90-180)°	0.0	0.0%
Total Flux	13673.8	100%

#### ISO FOOTCANDLE PLOT

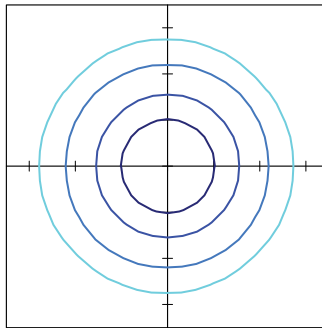

15' Mounting Height / 10' Grid Spacing

■ 10 FC ■ 5 FC ■ 2 FC ■ 1 FC

#### POLAR CURVE

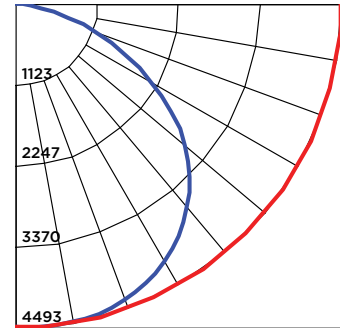

### CRUS-AC-SS-50

#### LUMINAIRE DATA

Wide Distribution	
Description	5000 Kelvin, 70 CRI
Delivered Lumens	11595
Watts	98.8
Efficacy	117
IES Type	Type III - Very Short
BUG Rating	B2-U0-G2

#### Zonal Lumen Summary

Zone	Lumens	%Luminaire
Low (0-30)°	2766.0	23.9%
Medium (30-60)°	5868.8	50.6%
High (60-80)°	2712.2	23.4%
Very High (80-90)°	248.1	2.1%
Uplight (90-180)°	0.0	0.0%
Total Flux	11595.1	100%

#### ISO FOOTCANDLE PLOT

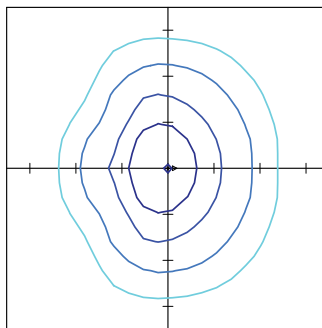

15' Mounting Height / 10' Grid Spacing

■ 10 FC ■ 5 FC ■ 2 FC ■ 1 FC

#### POLAR CURVE

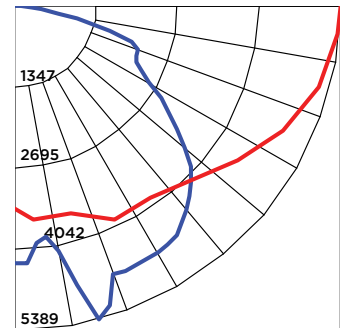

## PRODUCT DIMENSIONS

[Back to Quick Links](#)

