

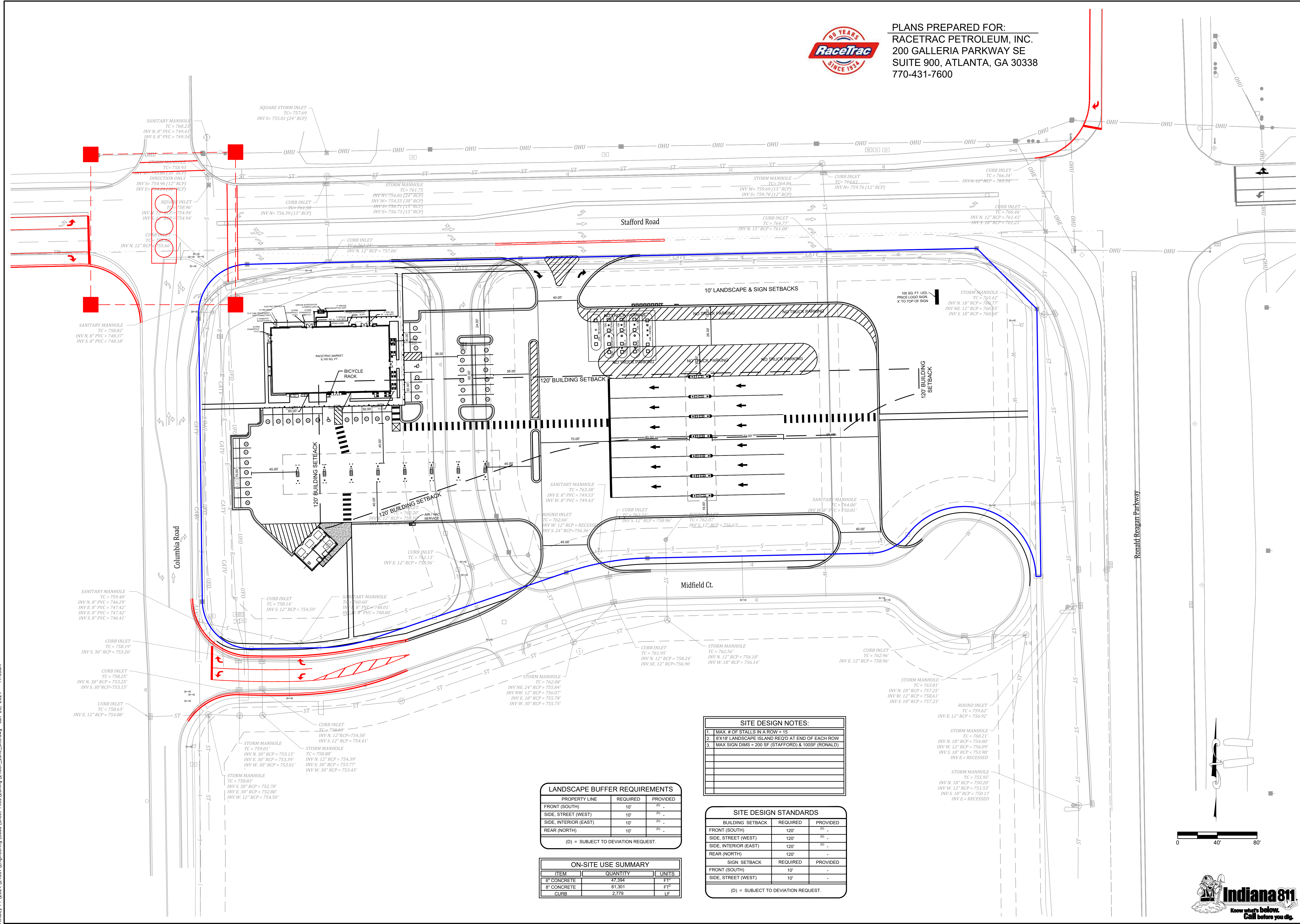

PLANS PREPARED FOR:  
**RACETRAC PETROLEUM, INC.**  
 200 GALLERIA PARKWAY SE  
 SUITE 900, ATLANTA, GA 30338  
 770-431-7600



**LANDSCAPE BUFFER REQUIREMENTS**

PROPERTY LINE	REQUIRED	PROVIDED
FRONT (SOUTH)	10'	10'
SIDE, STREET (WEST)	10'	10'
SIDE, INTERIOR (EAST)	10'	10'
REAR (NORTH)	10'	10'

(D) = SUBJECT TO DEVIATION REQUEST.

**ON-SITE USE SUMMARY**

ITEM	QUANTITY	UNITS
6" CONCRETE	47,394	FT <sup>2</sup>
8" CONCRETE	81,301	FT <sup>2</sup>
CURB	2,779	LF

**SITE DESIGN NOTES:**

- MAX # OF STALLS IN A ROW = 15
- 6'X18' LANDSCAPE ISLAND REQ'D AT END OF EACH ROW
- MAX SIGN DIMS = 200 SF (STAFFORD) & 100SF (RONALD)

**SITE DESIGN STANDARDS**

BUILDING SETBACK	REQUIRED	PROVIDED
FRONT (SOUTH)	120'	120'
SIDE, STREET (WEST)	120'	120'
SIDE, INTERIOR (EAST)	120'	120'
REAR (NORTH)	120'	120'

SIGN SETBACK	REQUIRED	PROVIDED
FRONT (SOUTH)	10'	10'
SIDE, STREET (WEST)	10'	10'

(D) = SUBJECT TO DEVIATION REQUEST.

<p>Project No: 24051</p> <p>Sheet No: C100</p>	<p style="text-align: center;"><b>NOT FOR CONSTRUCTION</b></p> <p style="text-align: center;"><b>SITE PLAN</b></p> <p style="text-align: center;"><b>RACETRAC</b></p> <p style="text-align: center;"><b>GUILFORD TOWNSHIP</b></p> <p style="text-align: center;"><b>PLAINFIELD, INDIANA</b></p>
------------------------------------------------	-------------------------------------------------------------------------------------------------------------------------------------------------------------------------------------------------------------------------------------------------------------------------------------------------

853 COLUMBIA ROAD, SUITE #101  
 PLAINFIELD, IN 46166  
 BUS: (317) 707-3700 FAX: (317) 707-3800  
 E-MAIL: Banning@BanningEngineering.com  
 WEB: www.BanningEngineering.com

I:\Projects\24051\Engineering\Cadd\Sheet Files\Zoning\24051\_som\_site.dwg Jun 20, 2024 - 11:03am