

PLAINFIELD HIGH SCHOOL - ADDITIONS

NW 1/4, SEC. 01-T14N-R2E, HENDRICKS COUNTY, GUILFORD TOWNSHIP, PLAINFIELD, INDIANA

PROJECT ADDRESS: ONE RED PRIDE DRIVE

ZONED: S

PLANS PREPARED FOR:

PLAINFIELD COMMUNITY

SCHOOL CORPORATION

985 LONGFELLOW LN.

PLAINFIELD, IN 46168

317-839-2578

CONTACT: MARK SHAYOTOVICH

EMAIL: mshayotovich@plainfield.k12.in.us



PROJECT LOCATION

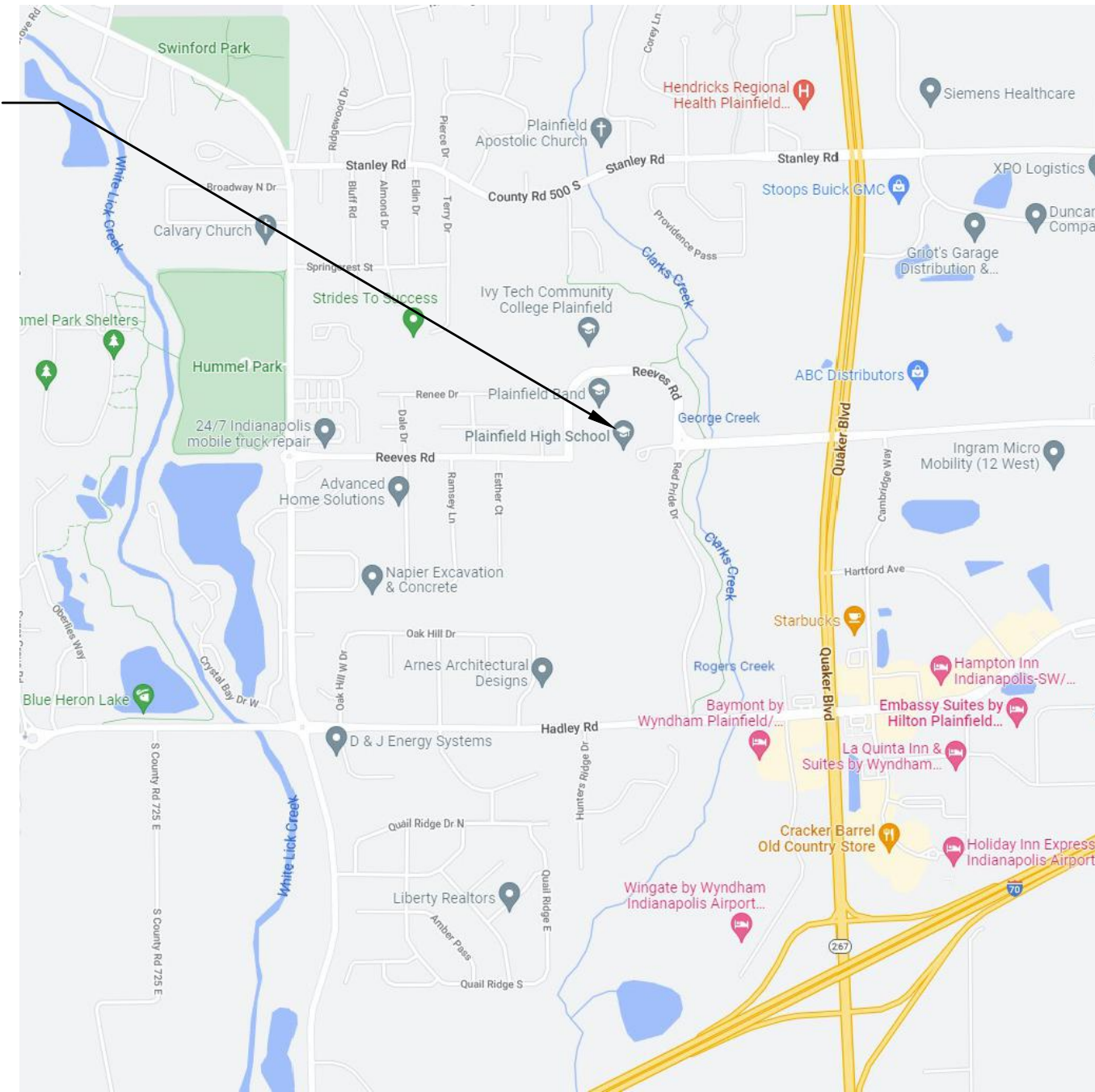

VICINITY MAP
NO SCALE

PROJECT LOCATION

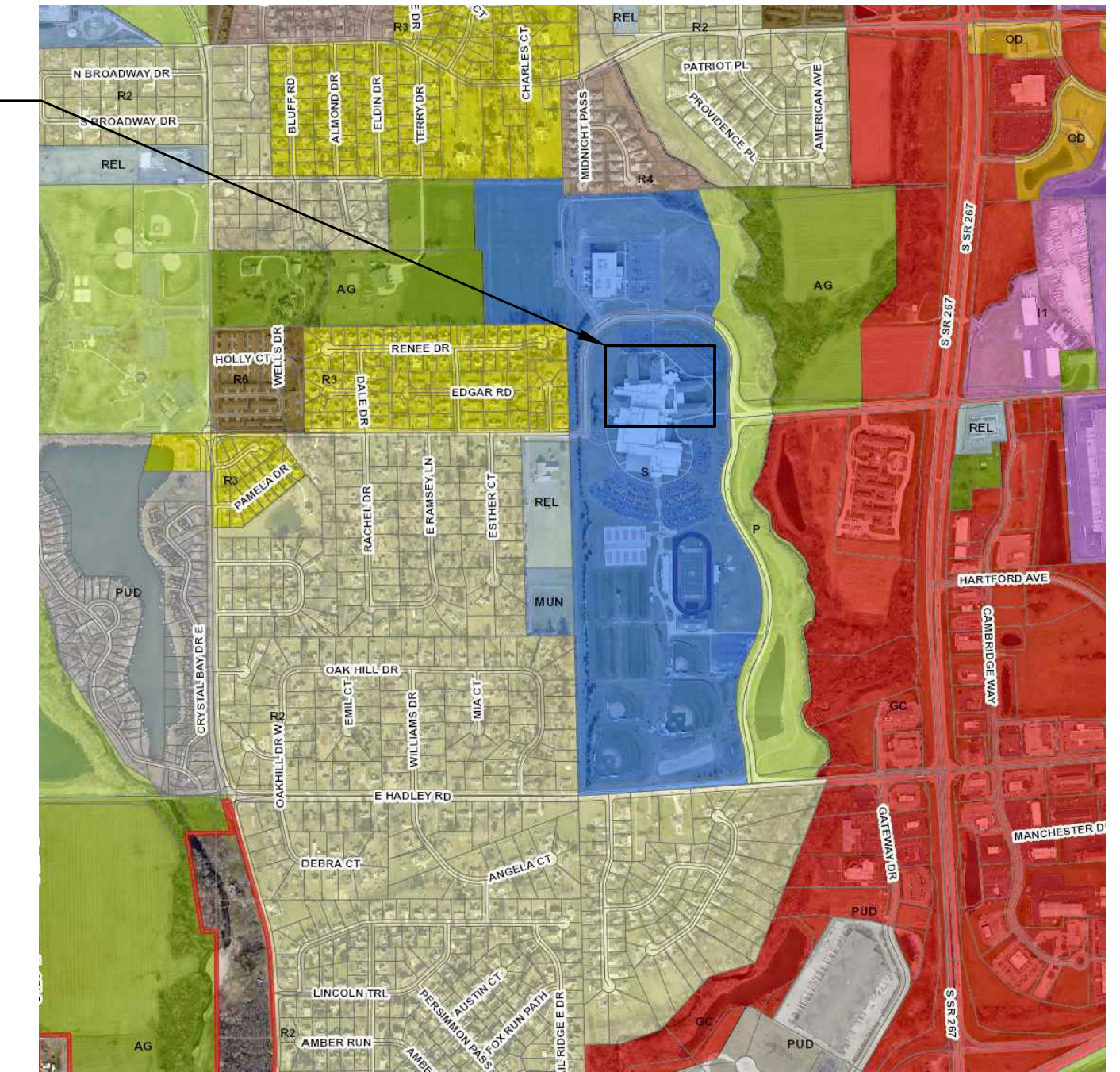

LOCATION MAP
NO SCALE

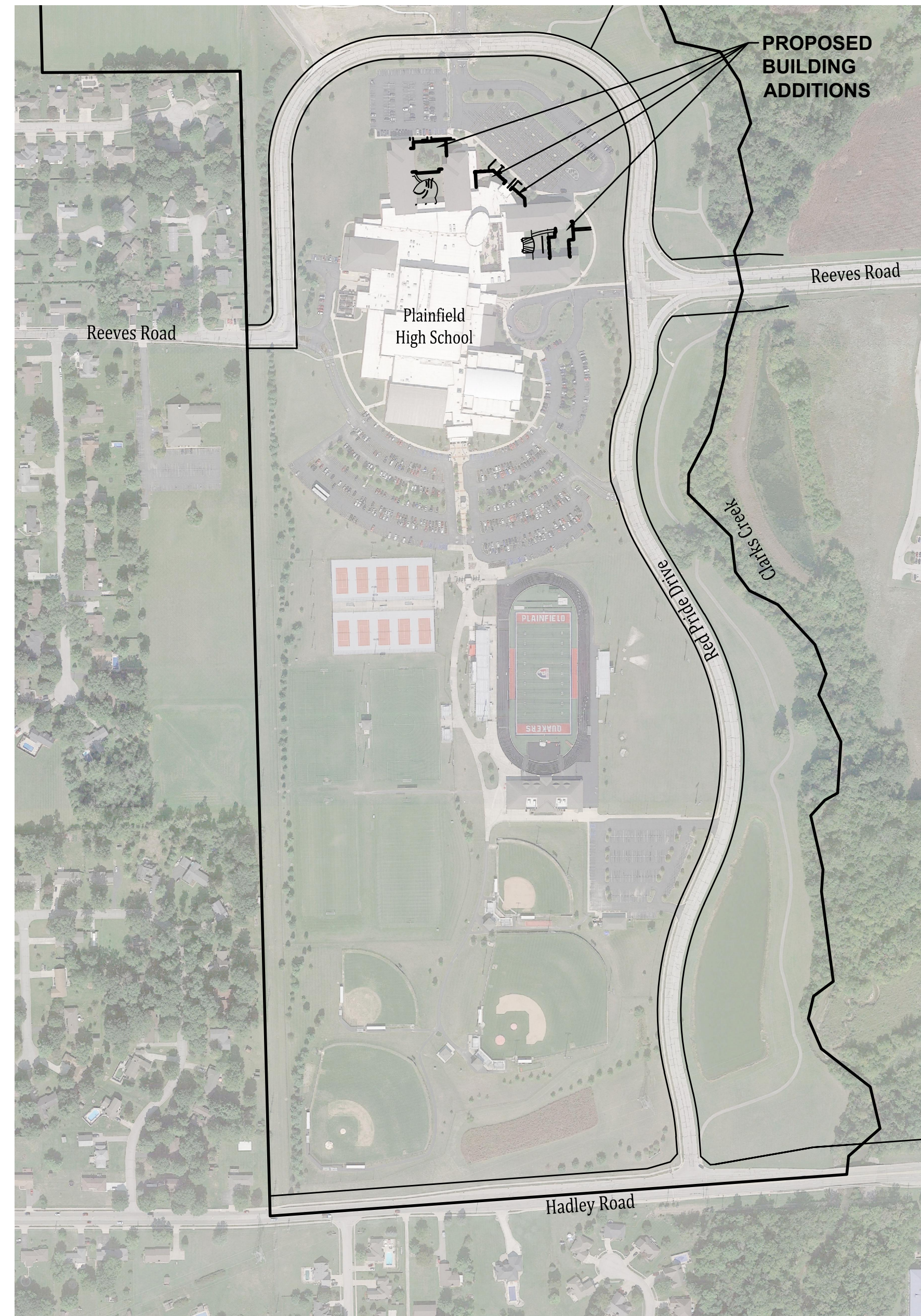

SITE MAP

SCALE: 1" = 300'

OPERATING AUTHORITIES

GAS CenterPoint Energy 1995 E. Main Street Danville, IN 46122 317-718-3617	CABLE TELEVISION Comcast of Indiana P.O. Box 20911 Indianapolis, IN 46220 317-594-8509	WATER Plainfield Public Works Dept. 986 S. Center Street Plainfield, IN 46168 317-839-3490
ELECTRIC Duke Energy 5095 E. Main Street P.O. Box 29 Danville, IN 46122 317-745-4481	CABLE TELEVISION BrightHouse 3030 Roosevelt Avenue Indianapolis, IN 46204 317-632-9077	TELEPHONE AT&T 240 N. Meridian St. Indianapolis, IN 46204 317-722-2299
SANITARY Plainfield Public Works Dept. 986 S. Center Street Plainfield, IN 46168 317-839-3490	STORM Plainfield Public Works Dept. 986 S. Center Street Plainfield, IN 46168 317-839-3490	FIRE DEPARTMENT Plainfield Fire Territory 591 Moon Road Plainfield, IN 46168 317-839-6939
SCHOOL DISTRICT Plainfield Community School Corporation 985 Longfellow Lane Plainfield, IN 46168 317-839-2578		

LAND DESCRIPTION

Lot 1 of that subdivision known as PCS High School as shown on that Final Plat, Part of Section 1 and 2, recorded on December 6, 2005, as Instrument No. 2005-37134 in Plat Cabinet 6, Slide 95, Pages 2 ABC and D in the office of the Recorder of Hendricks County, Indiana.

PLANS PREPARED BY:

BANNING ENGINEERING

853 COLUMBIA ROAD, SUITE #101
PLAINFIELD, IN 46168
BUS: (317) 707-3700, FAX: (317) 707-3800
E-MAIL: Banning@BanningEngineering.com
WEB: www.BanningEngineering.com

CONTACT: RYAN LINDLEY
EMAIL: rlindley@banning-eng.com

SITE DEVELOPMENT PLANS

CONSTRUCTION DOCUMENTS

PROJECT MANAGER: _____ DATE: _____
THESE PLANS ARE NOT TO BE CONSIDERED FINAL OR TO BE UTILIZED FOR CONSTRUCTION UNLESS SIGNED AND DATED BY THE APPROPRIATE BANNING ENGINEERING PROJECT MANAGER.
THESE PLANS ARE NOT INTENDED TO BE REPRESENTED AS A RETRACEMENT OR ORIGINAL BOUNDARY SURVEY, A ROUTE SURVEY, OR A SURVEYOR LOCATION REPORT.

NOT FOR CONSTRUCTION

CERTIFIED BY: _____

REVISIONS		
NUMBER	DESCRIPTION	DATE

SHEET INDEX	
SHEET NO	DESCRIPTION
C100	TITLE SHEET
C101	EXISTING TOPOGRAPHY
C102	SITE LAYOUT PLAN
C103	UTILITY PLAN
L100	SITE REFERENCE PLAN
L101-L103	MATERIALS PLAN
L401-L403	PLANTING PLAN
L410	PLANTING DETAILS
L600-L601	SITE DETAILS

Date: 04-28-2023
Project No: 22390
Sheet No:
C100



PROJECT BENCHMARK

THE VERTICAL DATUM FOR THIS PROJECT WAS BASED UPON NORTH AMERICAN VERTICAL DATUM OF 1988 (NAVD 88), UTILIZING GEOID 18 EPOCH 2010.00 AND WAS ESTABLISHED BY AN OPUS SOLUTION ON CONTROL POINT #1.

SITE BENCHMARKS

TBM #13
CUT SQUARE ON SOUTH CURB LINE OF RED PRIDE DRIVE, 110' WEST OF RED PRIDE DRIVE AND REEVES ROAD INT., 320' EAST OF EAST HIGH SCHOOL MAIN ENTRANCE.
ELEV. = 727.74' (NAVD 88)

TBM #12
CUT SQUARE ON THE SOUTH TOP OF CONCRETE LIGHT POLE BASE, 240' SOUTHWEST OF REEVES ROAD AND NORTH PARKING ENTRANCE, 140' NORTHEAST OF NORTHWEST HIGH SCHOOL BUILDING CORNER.
ELEV. = 732.56' (NAVD 88)

TBM #11
CUT SQUARE ON THE SOUTH TOP OF CONCRETE LIGHT POLE BASE, 390' NORTHWEST OF REEVES ROAD AND RED PRIDE DRIVE, 110' NORTHEAST OF NORTHEAST MOST HIGH SCHOOL BUILDING CORNER.
ELEV. = 731.44' (NAVD 88)

NOTES:
THE SURVEY DATA SHOWN HEREON IS ON HORIZONTAL DATUM OF NAD 83 (2011) EPOCH 2010.00, INDIANA STATE PLANE COORDINATES, WEST ZONE.

ELEVATIONS SHOWN ON NATURAL SURFACES (GRASSED OR TREED AREAS, AGRICULTURAL FIELDS, ETC.) WERE OBTAINED BY SEILER ROBOTIC TOTAL STATIONS WITH DATA COLLECTOR APPLYING STANDARD RADIAL SURVEYING TECHNIQUES, GLOBAL POSITIONING SYSTEMS (GPS) EQUIPMENT APPLYING RTK (REAL TIME KINEMATIC) CORRECTIONS, AND UAV (UNMANNED AERIAL VEHICLE) EQUIPPED WITH LIDAR, RTK GPS AND PHOTOGRAMMETRIC MAPPING EQUIPMENT AND ARE ACCURATE TO WITHIN 0.10 FEET.

GPS OBSERVATIONS WERE OBTAINED FROM THE VRS (VIRTUAL REFERENCE STATION) CONTROL NETWORK ESTABLISHED BY SEILER COMPANY. THE ELEVATIONS WERE ESTABLISHED FOR THIS NETWORK BY CONTINUOUSLY STREAMING DATA THROUGH FIXED REFERENCE STATIONS (CORS)-CONTINUOUSLY OPERATING REFERENCE STATION) DISTRIBUTED THROUGHOUT THE NETWORK AREA TO A CENTRAL SERVER RUNNING TRIMBLE GPSNET AND RTKNET SOFTWARE.

THE CONTOURS SHOWN HEREON WERE PLOTTED BASED UPON INTERPOLATION OF SPOT ELEVATIONS AND OTHER TOPOGRAPHIC INFORMATION AND ARE ACCURATE TO WITHIN ONE HALF OF THE CONTOUR INTERVAL.

PER IAC 1-12-12 THIS DRAWING IS NOT INTENDED TO BE REPRESENTED AS A RETRACEMENT OR ORIGINAL BOUNDARY SURVEY, A ROUTE SURVEY, OR A SURVEYOR LOCATION REPORT.

LEGEND

EXISTING

- T UNDERGROUND TELEPHONE LINE
- E UNDERGROUND ELECTRIC LINE
- OHU OVERHEAD UTILITY LINE
- Tree/Bush Line
- ST STORM SEWER PIPE
- RD ROOF DRAIN
- S SANITARY SEWER PIPE
- EDGE OF LANDSCAPING
- 4 SIGN
- Storm Sewer Structure
- Sanitary Sewer Structure
- CLEANOUT
- HAND HOLE
- LIGHT POLE
- BUSH
- DECIDUOUS TREE
- VAULT GENERAL

Control Point Table

Pt. #	Northing	Easting	Elev.	Description
1	1616074.145	3151268.234	730.42	5/8" rebar w/Banning Control Cap
2	1615868.922	3151663.779	728.40	5/8" rebar w/Banning Control Cap
3	1616141.868	3151054.896	730.69	5/8" rebar w/Banning Control Cap

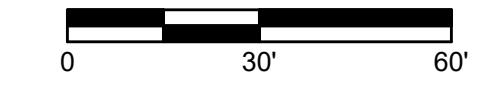

Revisions

Sym.	Design:	Drawn:	Checked:	Scale:	Date:
				1"=30'	04-28-2023

EXISTING TOPOGRAPHY
PLAINFIELD HIGH SCHOOL - ADDITIONS
GUILFORD TOWNSHIP
PLAINFIELD, INDIANA

NOT FOR CONSTRUCTION

BANNING ENGINEERING
863 COLUMBIA ROAD, SUITE #101
PLAINFIELD, IN 46169
BUS: (317) 707-3700 FAX: (317) 707-3800
E-MAIL: Banning@BanningEngineering.com
WEB: www.BanningEngineering.com

Project No: 22390
Sheet No:

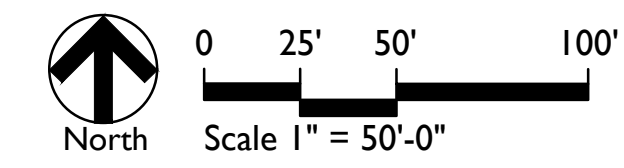
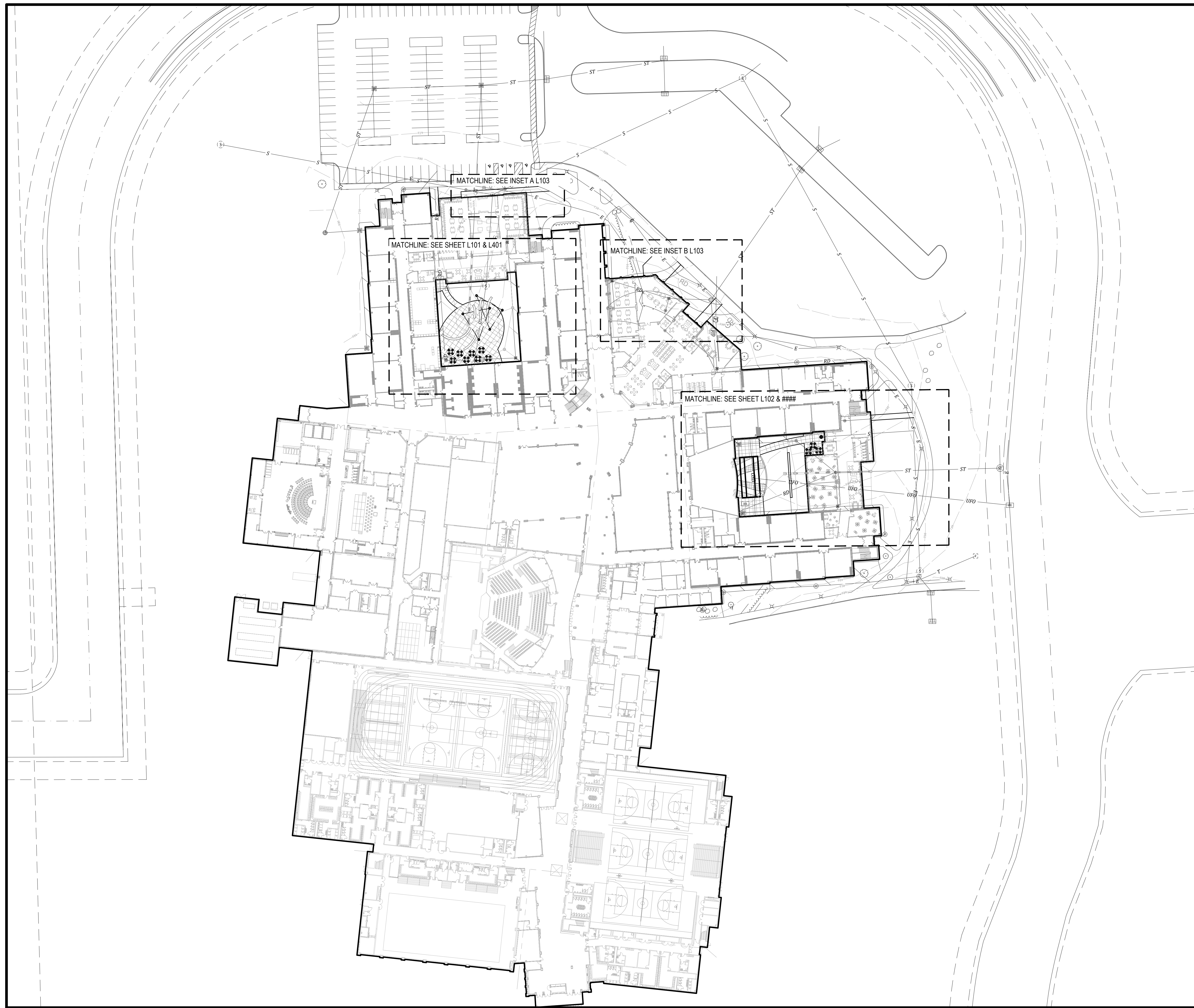

CONCEPTUAL DESIGN FOR THE
PLAINFIELD HIGH SCHOOL COURTYARDS
1 Red Pride Dr., Plainfield, Indiana 46168

SITE REFERENCE PLAN

Revision	Date	Description

Date: 2023/04/13
Project No: 23-1650
Drawn by: AY
Checked by: FP

These Drawings and Specifications, and all copies thereof are and shall remain the property and copyright of the Landscape Architect. They shall be used only with respect to this Project and are not to be used on any other Project or Work without prior written permission from the Landscape Architect.

Sheet No:
L100



FURNISHINGS KEYNOTES	
KEY	DESCRIPTION / REFERENCE
F01	MOVABLE TABLES AND CHAIRS
F02	SEAT WALLS
F03	TRIANGULAR SHADE SAILS
F04	RECTILINEAR SHADE STRUCTURE

PAVING KEYNOTES	
KEY	DESCRIPTION / REFERENCE
P01	CONCRETE, TYPE 01, REFER TO SITE DETAILS
P02	CONCRETE, TYPE 02, REFER TO SITE DETAILS
P03	CONCRETE, BAND, REFER TO SITE DETAILS
P04	PAVERS, REFER TO SITE DETAILS NOT USED

LANDSCAPE KEYNOTES	
KEY	DESCRIPTION / REFERENCE
L01	LAWN AREAS
L02	SYNTHETIC TURF AREAS NOT USED

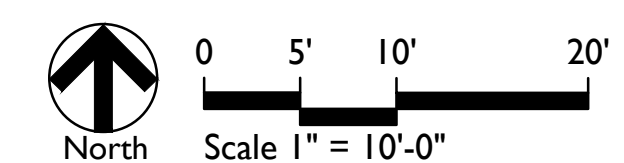

CONCEPTUAL DESIGN FOR THE
PLAINFIELD HIGH SCHOOL COURTYARDS
 1 Red Pride Dr., Plainfield, Indiana 46168
MATERIALS PLAN

Revision	Date	Description

Date: 2023/04/13
 Project No: 23-1650
 Drawn by: AY
 Checked by: FP

These Drawings and Specifications, and all copies thereof are and shall remain the property and copyright of the Landscape Architect. They shall be used only with respect to this Project and are not to be used on any other Project or Work without prior written permission from the Landscape Architect.

Sheet No:
L101

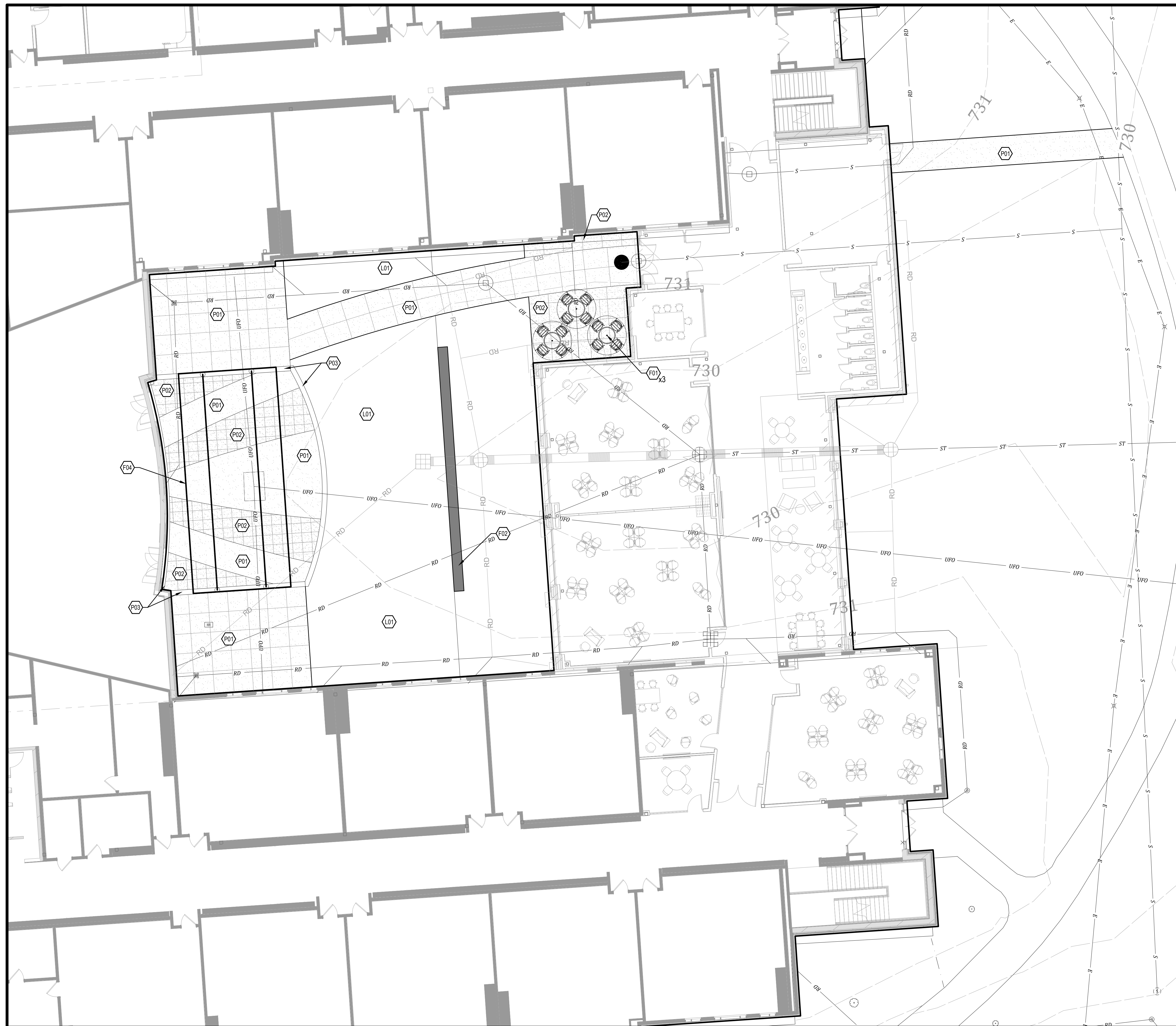

FURNISHINGS KEYNOTES	
KEY	DESCRIPTION / REFERENCE
F01	MOVABLE TABLES AND CHAIRS
F02	SEAT WALLS
F03	TRIANGULAR SHADE SAILS
F04	RECTILINEAR SHADE STRUCTURE

PAVING KEYNOTES	
KEY	DESCRIPTION / REFERENCE
P01	CONCRETE, TYPE 01, REFER TO SITE DETAILS
P02	CONCRETE, TYPE 02, REFER TO SITE DETAILS
P03	CONCRETE, BAND, REFER TO SITE DETAILS
P04	PAVERS, REFER TO SITE DETAILS NOT USED

LANDSCAPE KEYNOTES	
KEY	DESCRIPTION / REFERENCE
L01	LAWN AREAS
L02	SYNTHETIC TURF AREAS NOT USED

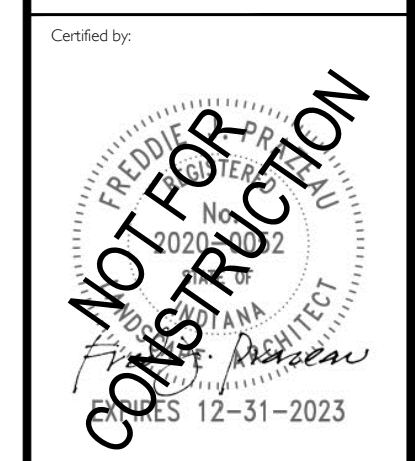

CONCEPTUAL DESIGN FOR THE
PLAINFIELD HIGH SCHOOL COURTYARDS
1 Red Pride Dr., Plainfield, Indiana 46168
MATERIALS PLAN

Revision	Date	Description

Date: 2023/04/13
Project No: 23-1650
Drawn by: AY
Checked by: FP

These Drawings and Specifications, and all copies thereof are and shall remain the property and copyright of the Landscape Architect. They shall be used only with respect to this Project and are not to be used on any other Project or Work without prior written permission from the Landscape Architect.

Sheet No:
L102

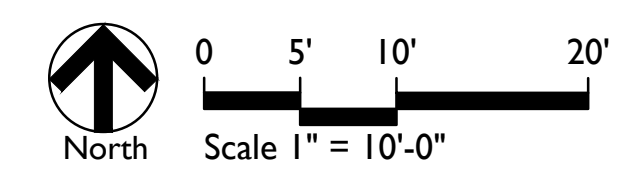

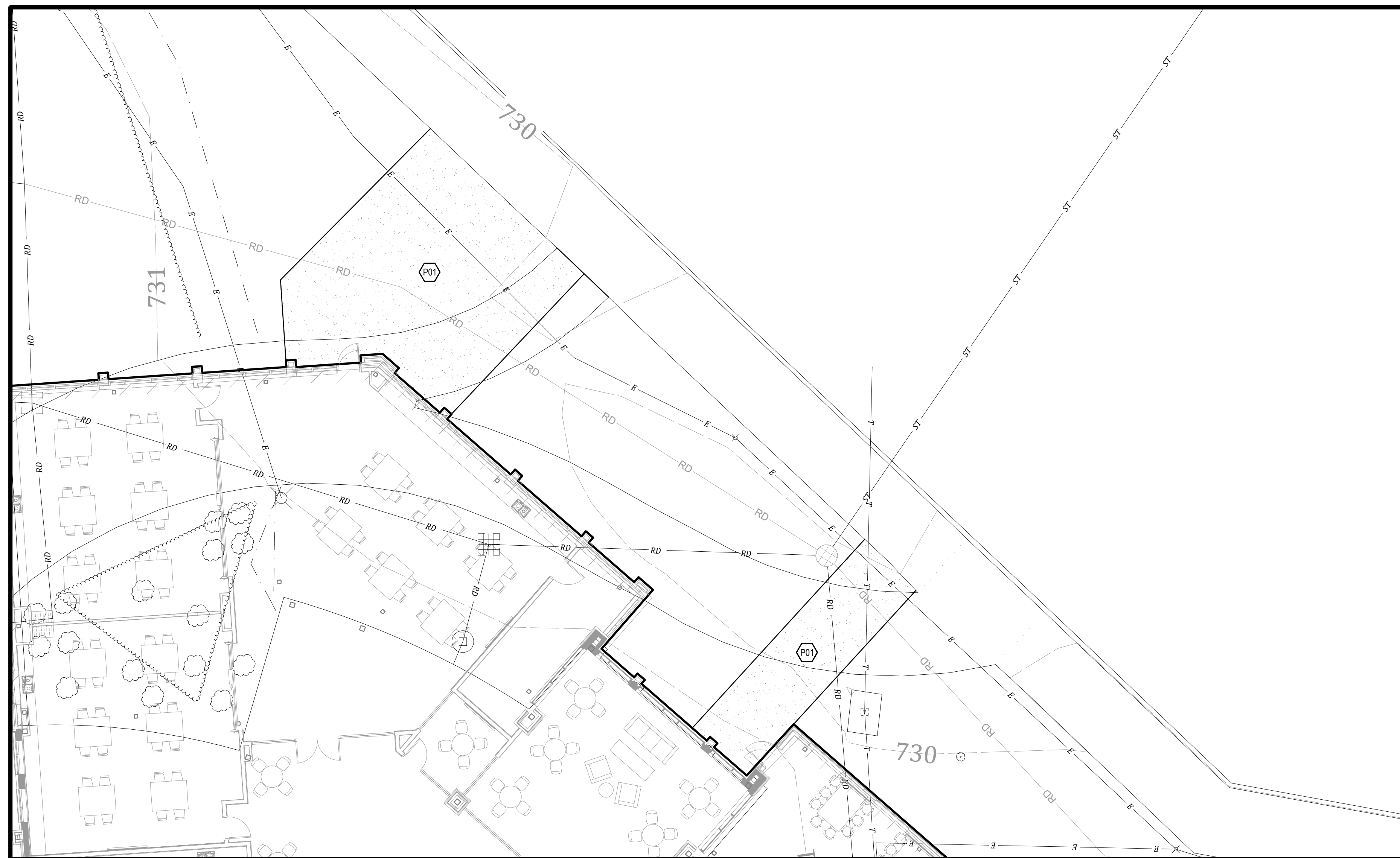

INSET B

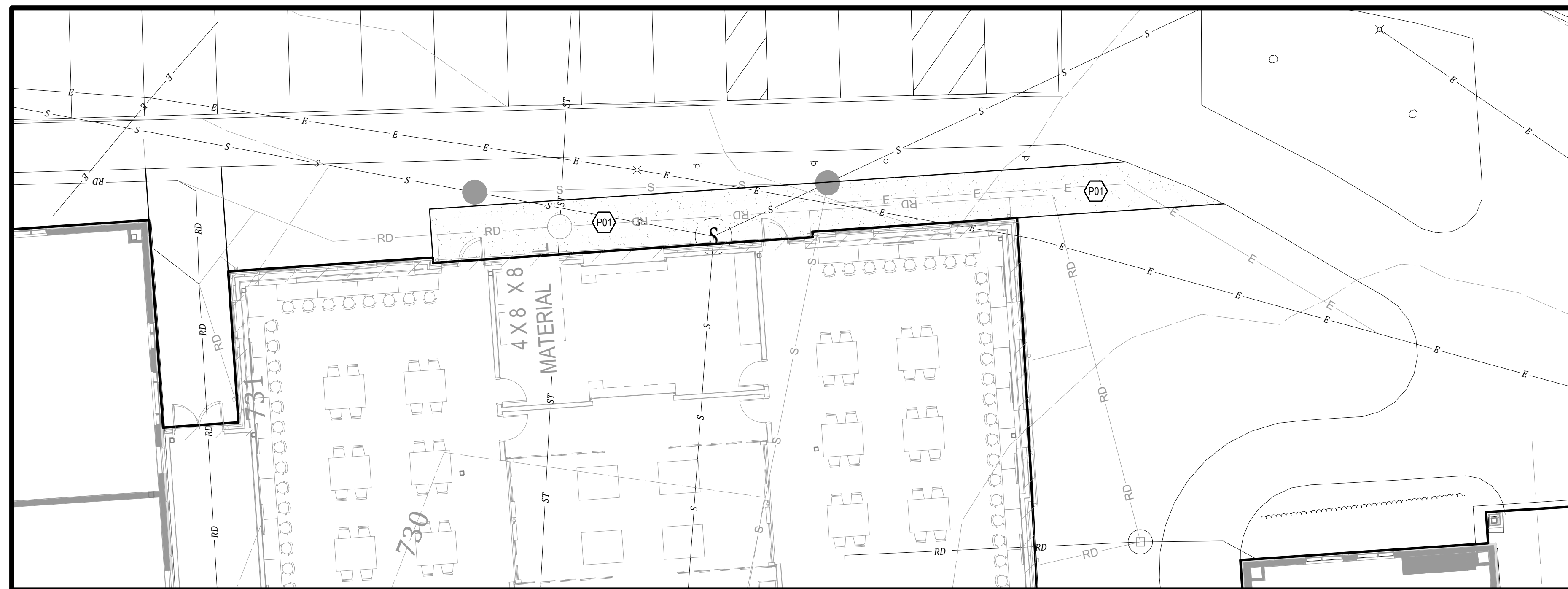

INSET A

FURNISHINGS KEYNOTES	
KEY	DESCRIPTION / REFERENCE
F01	MOVABLE TABLES AND CHAIRS
F02	SEAT WALLS
F03	TRIANGULAR SHADE SAILS
F04	RECTILINEAR SHADE STRUCTURE

PAVING KEYNOTES	
KEY	DESCRIPTION / REFERENCE
P01	CONCRETE, TYPE 01, REFER TO SITE DETAILS
P02	CONCRETE, TYPE 02, REFER TO SITE DETAILS
P03	CONCRETE, BAND, REFER TO SITE DETAILS
P04	PAVERS, REFER TO SITE DETAILS NOT USED

LANDSCAPE KEYNOTES	
KEY	DESCRIPTION / REFERENCE
L01	LAWN AREAS
L02	SYNTHETIC TURF AREAS NOT USED



CONCEPTUAL DESIGN FOR THE
PLAINFIELD HIGH SCHOOL COURTYARDS
 | Red Pride Dr., Plainfield, Indiana 46168
MATERIALS PLAN

Revision	Date	Description

Date: 2023/04/13
 Project No: 23-1650
 Drawn by: AY
 Checked by: FP

These Drawings and Specifications, and all copies thereof are and shall remain the property and copyright of the Landscape Architect. They shall be used only with respect to this Project and are not to be used on any other Project or Work without prior written permission from the Landscape Architect.

Sheet No:
L103

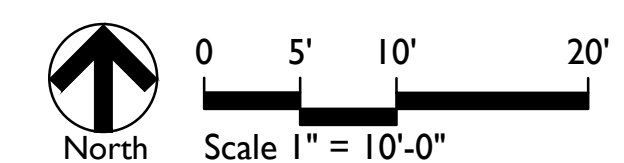

GENERAL LANDSCAPE AND PLANTING NOTES

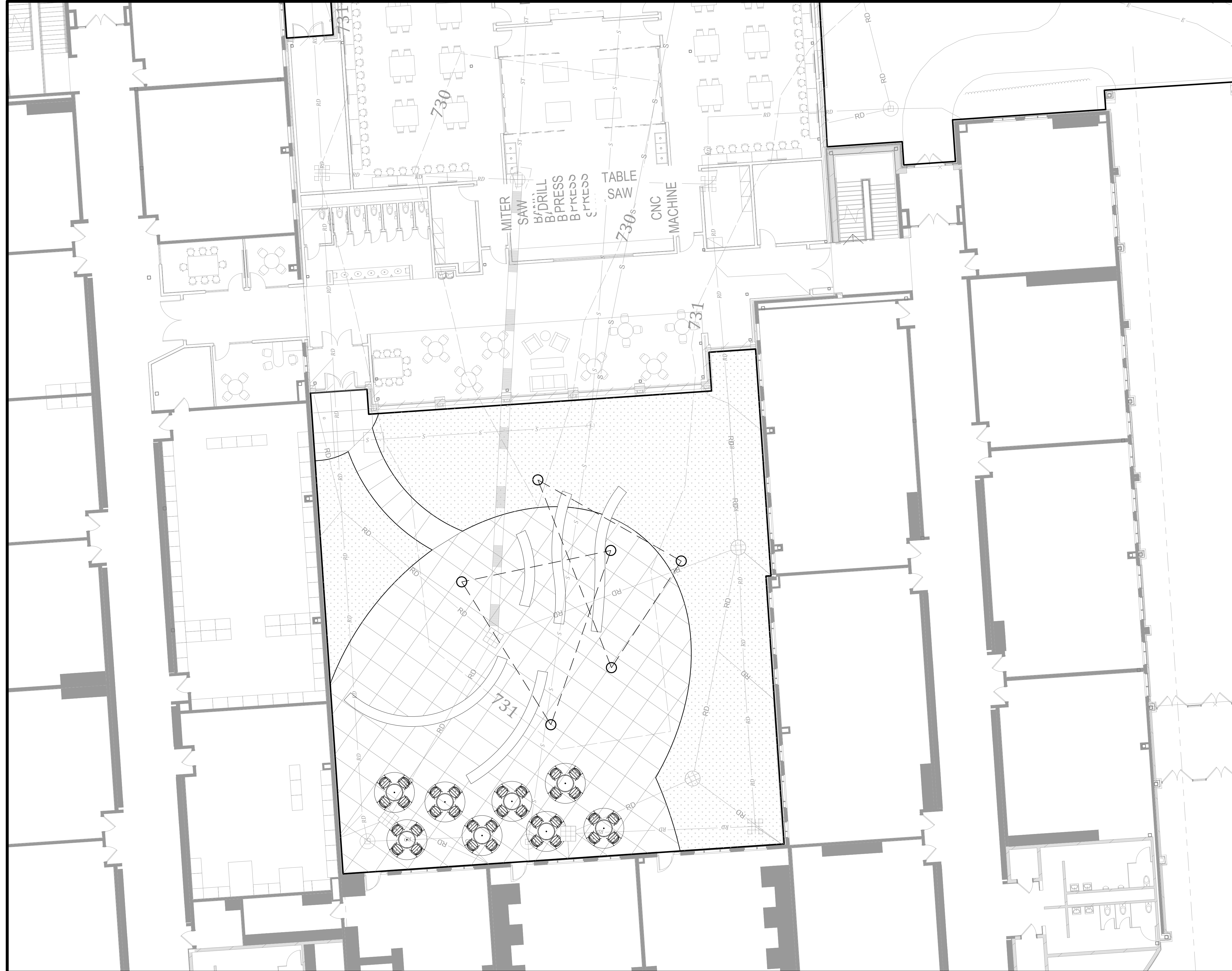

1. Refer to Project Manual for Planting Specifications and Topsoil requirements. Refer to Plant Schedule and Planting Details for additional information.
2. All materials are subject to the approval of the Landscape Architect and Owner at any time. Landscape Architect to inspect all plant locations and plant bed conditions prior to installation. On-site adjustments may be required.
3. Rootballs shall meet or exceed size standards as set forth in 'American Standards for Nursery Stock'. MAIN LEADERS OF ALL TREES SHALL REMAIN INTACT.
4. Remove from the site any plant material that turns brown or defoliates within five (5) days after planting. Replace immediately with approved, specified material.
5. Plant counts indicated on drawings are for Landscape Architect's use only. Contractor shall make own plant quantity takeoffs using drawings, specifications, and plant schedule requirements (i.e., spacing), unless otherwise directed by Landscape Architect.
6. Contractor to verify bed measurements and install appropriate quantities as governed by plant spacing per schedule. Plant material quantities shown on plan are minimum quantities. Additional material may be needed to meet spacing requirements and field conditions.
7. Seed all areas disturbed by construction activities that are not otherwise noted to receive pavement, planting bed, or sod treatment.
8. The Contractor shall install and/or amend topsoil in all proposed bed areas to meet Specifications. Contractor shall coordinate quantity and placement of topsoil.
9. Landscaper shall verify depth of topsoil prior to plant installation. (Refer to specifications for topsoil source and placement requirements)
10. All tree locations shall be marked with 2x2" stakes prior to planting for review and approval by the Landscape Architect. Any plant material installed in an incorrect location, by the judgment of the Landscape Architect, shall be reinstalled at the Contractor's expense.
11. All plant beds shall receive 3" minimum of shredded hardwood bark mulch (unless otherwise noted).
12. Verify all utility locations in the field prior to beginning work. Repair all damaged utilities to Owner's satisfaction at no additional cost.
13. The Contractor shall maintain all plant material and lawns until the project is fully accepted by the Landscape Architect, unless otherwise noted.
14. All workmanship and materials shall be guaranteed by the Contractor for a period of one calendar year after Final Acceptance.
15. Install all plant material in accordance with all local codes and ordinances. Coordinate with the Owner to obtain any required permits necessary to complete work.
16. Contractor shall test all tree pits for drainage. Any tree pit that holds water for more than 24 hours shall be installed using tree pit drainage.
17. Tree Protection Fencing is the responsibility of the Contractor. Minimum protected area shall include the full drip line of the canopy. NO construction activities, material storage, etc. may occur within that area. The Contractor shall ensure that no soil compaction or tree damage occurs in any Protected areas, at any time during the construction process.
18. Trees shall be matched in groups unless otherwise noted.



5825 Lawton Loop E. Dr. | Indianapolis, IN 46216
317-485-6900 | www.context-design.com

Certified by:



CONCEPTUAL DESIGN FOR THE
PLAINFIELD HIGH SCHOOL COURTYARDS
1 Red Pride Dr., Plainfield, Indiana 46168

PLANTING PLAN

Revision	Date	Description

Date: 2023/04/13
Project No: 23-1650
Drawn by: AY
Checked by: FP

These Drawings and Specifications, and all copies thereof are and shall remain the property and copyright of the Landscape Architect. They shall not be used only with respect to this Project and are not to be used on any other Project or Work without prior written permission from the Landscape Architect.

Sheet No:
L401

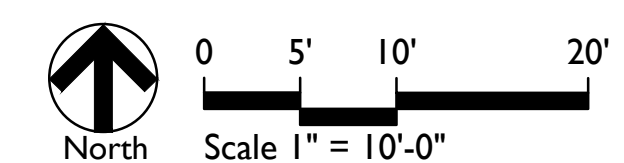

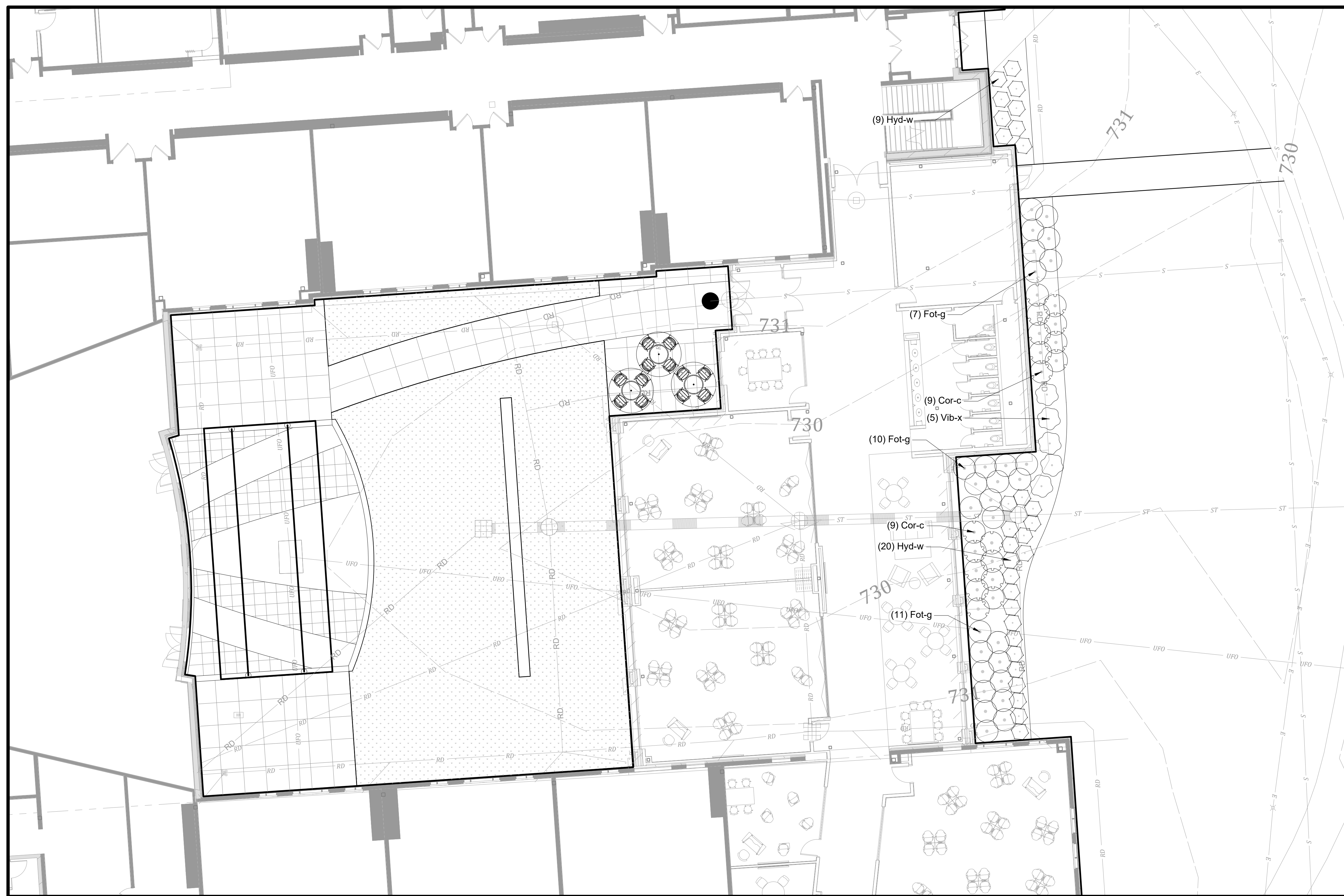

GENERAL LANDSCAPE AND PLANTING NOTES

1. Refer to Project Manual for Planting Specifications and Topsoil requirements. Refer to Plant Schedule and Planting Details for additional information.
2. All materials are subject to the approval of the Landscape Architect and Owner at any time. Landscape Architect to inspect all plant locations and plant bed conditions prior to installation. On-site adjustments may be required.
3. Rootballs shall meet or exceed size standards as set forth in 'American Standards for Nursery Stock'. MAIN LEADERS OF ALL TREES SHALL REMAIN INTACT.
4. Remove from the site any plant material that turns brown or defoliates within five (5) days after planting. Replace immediately with approved, specified material.
5. Plant counts indicated on drawings are for Landscape Architect's use only. Contractor shall make own plant quantity takeoffs using drawings, specifications, and plant schedule requirements (i.e., spacing), unless otherwise directed by Landscape Architect. Contractor to verify bed measurements and install appropriate quantities as governed by plant spacing per schedule. Plant material quantities shown on plan are minimum quantities. Additional material may be needed to meet spacing requirements and field conditions.
6. Seed all areas disturbed by construction activities that are not otherwise noted to receive pavement, planting bed, or sod treatment.
7. The Contractor shall install and/or amend topsoil in all proposed bed areas to meet Specifications. Contractor shall coordinate quantity and placement of topsoil. Landscaper shall verify depth of topsoil prior to plant installation. (Refer to specifications for topsoil source and placement requirements)
8. All tree locations shall be marked with 2x2" stakes prior to planting for review and approval by the Landscape Architect. Any plant material installed in an incorrect location, by the judgment of the Landscape Architect, shall be reinstalled at the Contractor's expense.
9. All plant beds shall receive 3" minimum of shredded hardwood bark mulch (unless otherwise noted).
10. Verify all utility locations in the field prior to beginning work. Repair all damaged utilities to Owner's satisfaction at no additional cost.
11. The Contractor shall maintain all plant material and lawns until the project is fully accepted by the Landscape Architect, unless otherwise noted.
12. All workmanship and materials shall be guaranteed by the Contractor for a period of one calendar year after Final Acceptance.
13. Install all plant material in accordance with all local codes and ordinances. Coordinate with the Owner to obtain any required permits necessary to complete work.
14. Contractor shall test all tree pits for drainage. Any tree pit that holds water for more than 24 hours shall be installed using tree pit drainage.
15. Tree Protection Fencing is the responsibility of the Contractor. Minimum protected area shall include the full drip line of the canopy. NO construction activities, material storage, etc. may occur within that area. The Contractor shall ensure that no soil compaction or tree damage occurs in any Protected areas, at any time during the construction process.
16. Trees shall be matched in groups unless otherwise noted.



5825 Lawlor Loop E. Dr. | Indianapolis, IN 46216
317-485-6900 | www.context-design.com

Certified by:



CONCEPTUAL DESIGN FOR THE
PLAINFIELD HIGH SCHOOL COURTYARDS
1 Red Pride Dr., Plainfield, Indiana 46168

PLANTING PLAN

Revision	Date	Description

Date: 2023/04/13
Project No: 23-1650
Drawn by: AY
Checked by: FP

These Drawings and Specifications, and all copies thereof are and shall remain the property and copyright of the Landscape Architect. They shall be used only with respect to this Project and are not to be used on any other Project or Work without prior written permission from the Landscape Architect.

Sheet No:

L402

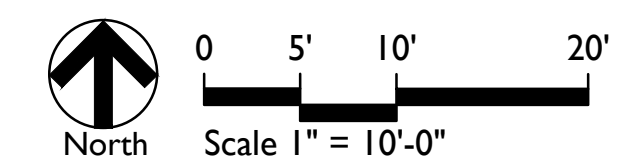

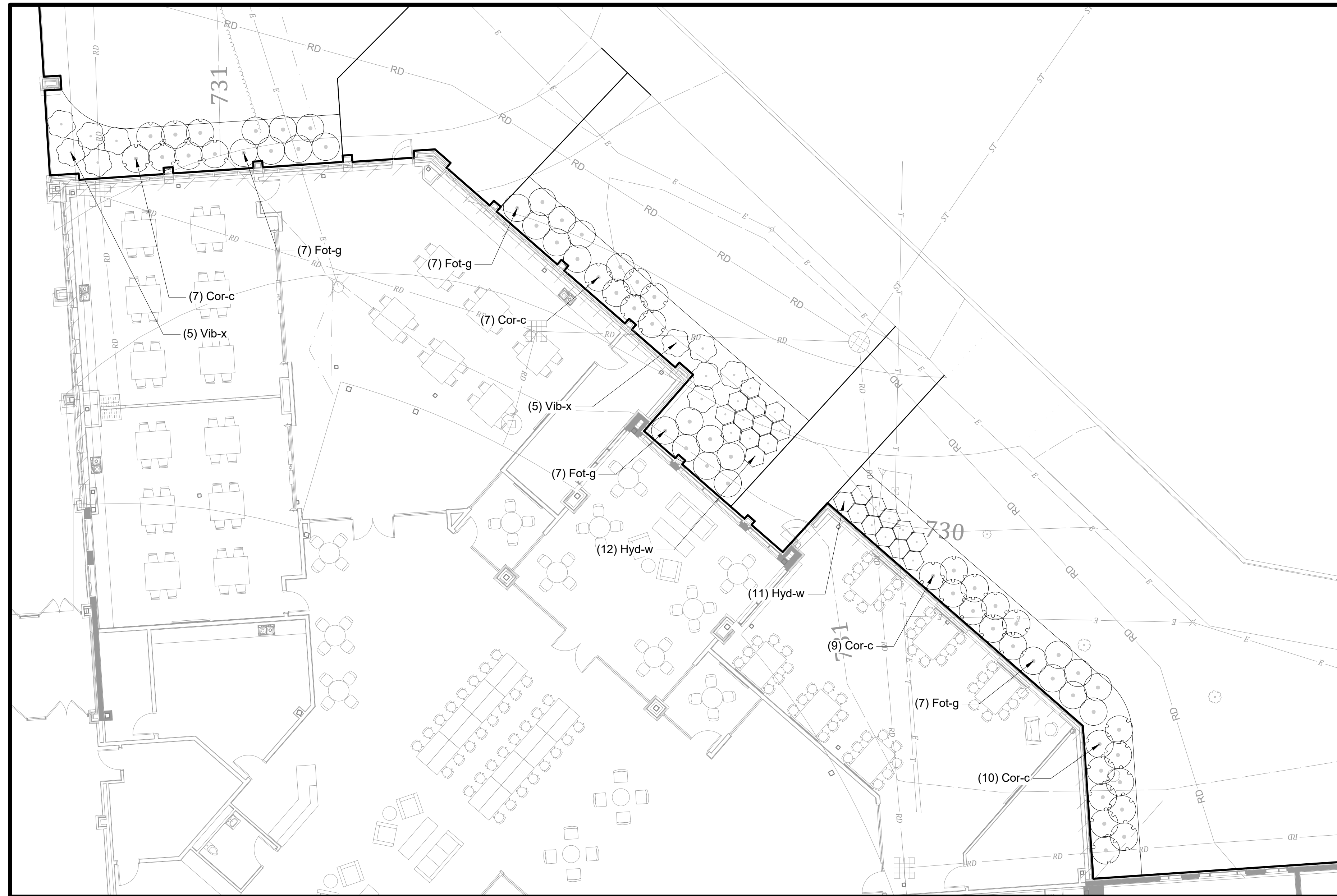

INSET B



INSET A

GENERAL LANDSCAPE AND PLANTING NOTES

1. Refer to Project Manual for Planting Specifications and Topsoil requirements. Refer to Plant Schedule and Planting Details for additional information.
2. All materials are subject to the approval of the Landscape Architect and Owner at any time. Landscape Architect to inspect all plant locations and plant bed conditions prior to installation. On-site adjustments may be required.
3. Rootballs shall meet or exceed size standards as set forth in 'American Standards for Nursery Stock'. MAIN LEADERS OF ALL TREES SHALL REMAIN INTACT.
4. Remove from the site any plant material that turns brown or defoliates within five (5) days after planting. Replace immediately with approved, specified material.
5. Plant counts indicated on drawings are for Landscape Architect's use only. Contractor shall make own plant quantity takeoffs using drawings, specifications, and plant schedule requirements (i.e., spacing), unless otherwise directed by Landscape Architect. Contractor to verify bed measurements and install appropriate quantities as governed by plant spacing per schedule. Plant material quantities shown on plan are minimum quantities. Additional material may be needed to meet spacing requirements and field conditions.
6. Seed all areas disturbed by construction activities that are not otherwise noted to receive pavement, planting bed, or sod treatment.
7. The Contractor shall install and/or amend topsoil in all proposed bed areas to meet Specifications. Contractor shall coordinate quantity and placement of topsoil. Landscaper shall verify depth of topsoil prior to plant installation. (Refer to specifications for topsoil source and placement requirements)
8. All tree locations shall be marked with 2x2" stakes prior to planting for review and approval by the Landscape Architect. Any plant material installed in an incorrect location, by the judgment of the Landscape Architect, shall be reinstalled at the Contractor's expense.
9. All plant beds shall receive 3" minimum of shredded hardwood bark mulch (unless otherwise noted).
10. Verify all utility locations in the field prior to beginning work. Repair all damaged utilities to Owner's satisfaction at no additional cost.
11. The Contractor shall maintain all plant material and lawns until the project is fully accepted by the Landscape Architect, unless otherwise noted.
12. All workmanship and materials shall be guaranteed by the Contractor for a period of one calendar year after Final Acceptance.
13. Install all plant material in accordance with all local codes and ordinances. Coordinate with the Owner to obtain any required permits necessary to complete work.
14. Contractor shall test all tree pits for drainage. Any tree pit that holds water for more than 24 hours shall be installed using tree pit drainage.
15. Tree Protection Fencing is the responsibility of the Contractor. Minimum protected area shall include the full drip line of the canopy. NO construction activities, material storage, etc. may occur within that area. The Contractor shall ensure that no soil compaction or tree damage occurs in any Protected areas, at any time during the construction process.
16. Trees shall be matched in groups unless otherwise noted.



5825 Lawton Loop E. Dr. | Indianapolis, IN 46216
317-485-6900 | www.context-design.com



CONCEPTUAL DESIGN FOR THE
PLAINFIELD HIGH SCHOOL COURTYARDS
1 Red Pride Dr., Plainfield, Indiana 46168
PLANTING PLAN

Revision	Date	Description

Date: 2023/04/13
Project No: 23-1650
Drawn by: AY
Checked by: FP

These Drawings and Specifications, and all copies thereof are and shall remain the property and copyright of the Landscape Architect. They shall not be used on any other Project or Work without prior written permission from the Landscape Architect.

Sheet No:

L403

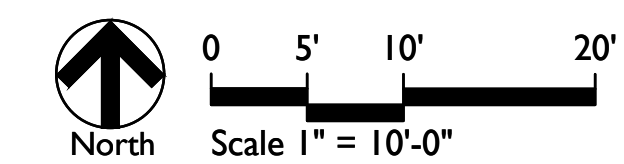

PLANT SCHEDULE

TREES	QTY	BOTANICAL NAME	COMMON NAME	CONT	CAL	REMARKS
Gle-s	3	Gleditsia triacanthos inermis 'Shademaster'	Shademaster Thornless Honeylocust	B & B	2"Cal	full, strong central leader, matched
SHRUBS	QTY	BOTANICAL NAME	COMMON NAME	SIZE	HEIGHT	REMARKS
Cor-c	51	Cornus sericea 'Arctic Fire'	Arctic Fire Red Twig Dogwood	Container	18"	space @ 4'-0" o.c.
Fot-g	60	Fothergilla gardenii	Dwarf Fothergilla	Container	18"	space @ 4'-0" o.c.
Hyd-w	62	Hydrangea quercifolia 'Pee Wee'	Pee Wee Oakleaf Hydrangea	Container	18"	space @ 3'-0" o.c.
Rhu-a	26	Rhus aromatica 'Gro-Low'	Gro-Low Fragrant Sumac	Container	18" spread	space @ 10'-0" o.c., allow to mass
Vib-x	15	Viburnum x juddii	Judd Viburnum	container	24"	space @ 5'-0" o.c.

Ordinance Compliance Plan
Zone: "School" (follows commercial rules)

Foundation planting areas required:

Foundation planting areas shall be required for all new buildings and building additions in the R-6 District, the R-U District for multi-family dwellings or any special exception use, all commercial districts and all industrial districts.

Foundation planting areas shall be subject to the following requirements:

- Location. Foundation planting areas shall be calculated individually for each applicable front, side or rear of a building and shall be located along such front, side or rear of a building (except for those portions of the front or side of a building devoted to pedestrian ingress/egress, vehicular ingress/egress, loading or drop-off zones);

Required: foundation planting along all sides of the new addition to the building.

Proposed: foundation planting along all sides of the new addition to the building.

- Area. Foundation planting areas shall have a total area in square feet of not less than two feet times the length of the wall (**two feet X length of wall = area for foundation planting**) to which the foundation planting is oriented;

Required: foundation planting areas to be 2' x the length of the wall

Proposed: foundation planting areas are 2' x the length of the wall at 6 feet planting beds.

- Relationship to buildings. Foundation planting areas shall be located:

Required:

- Adjacent to the building; or
- So as to begin within 15 feet of the building (in the case of a sidewalk which runs adjacent to the building).

Proposed: all foundation plantings are adjacent to the building.

- Minimum dimension. Foundation planting areas shall maintain a minimum depth in the smallest dimension of six feet;

Required: minimum 6' deep planting bed at all times

Proposed: kept a minimum of 6' deep planting bed at all times.

- Plant unit value. Foundation planting areas shall be landscaped with grass and shrubbery, trees or hedge, or in combination with other suitable ground cover materials and maintained as a foundation planting strip in compliance with the requirements for a Level 1 plantings as set forth in Table 4.7-B

Required: Level 1 = Any combination of plants selected from the plant categories listed in Table 4.7-C which equals or exceeds a plant unit value of 1.0 for each 100 lineal feet (foundation plantings = .025 each)

Building Addition East: bldg wall length: 205 LF = 2.0 units = 80 plants

Proposed: 80 foundation shrubs

Building Addition North - East: bldg wall length: 236 LF = 2.3 units = 94 plants

Proposed: 94 foundation shrubs

Building Addition North: bldg wall length: 26 LF applicable wall space = .26 units = 10 plants

Proposed: 14 foundation shrubs

- Overlap with perimeter yards. Foundation planting areas may overlap required perimeter yards landscaping provided that the plant unit value in such perimeter yard landscaping is equal to or greater than the total plant unit value required for the perimeter yard plus the overlapping foundation landscaping area.

Required: N/A - no perimeter yard required.

NOTE:
Tabular data provided in response to Staff Comments. Plainfield Schools is filing Plans in conformance with landscape standards for building base planting requirements. However, ongoing discussions between Town staff and school administrators will determine if required plant material (i.e. the total plant unit value) may be redistributed elsewhere on school property. Plainfield High School has concerns about building base plantings potentially creating hiding areas and/or obstructing surveillance sight lines. Pending the agreement and cooperation of Town officials, planting commitments may be redistributed. If no agreement can be filed, the Plans will remain as-filed.

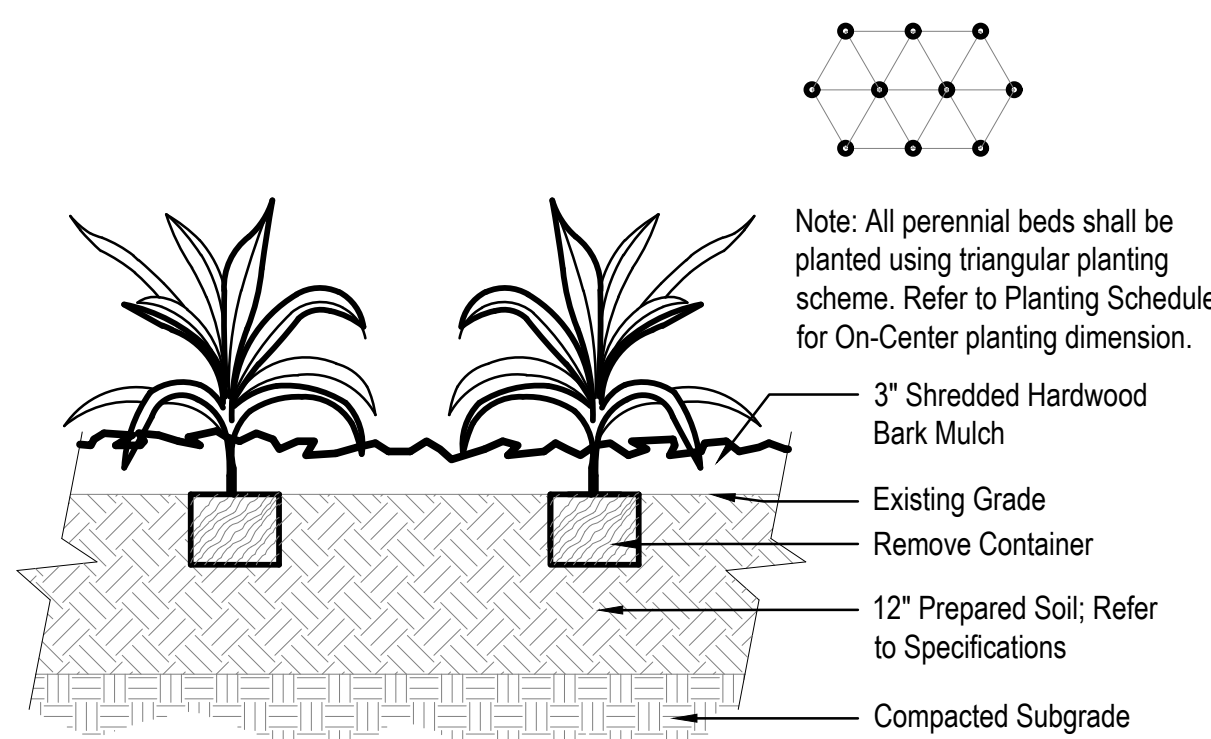

4 PERENNIAL or ORNAMENTAL GRASS
Scale: Not to Scale

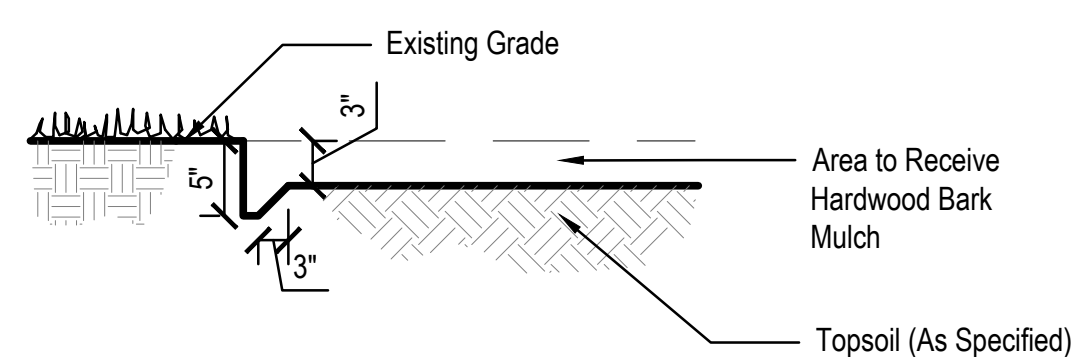

3 SPADED EDGE
Scale: Not to Scale

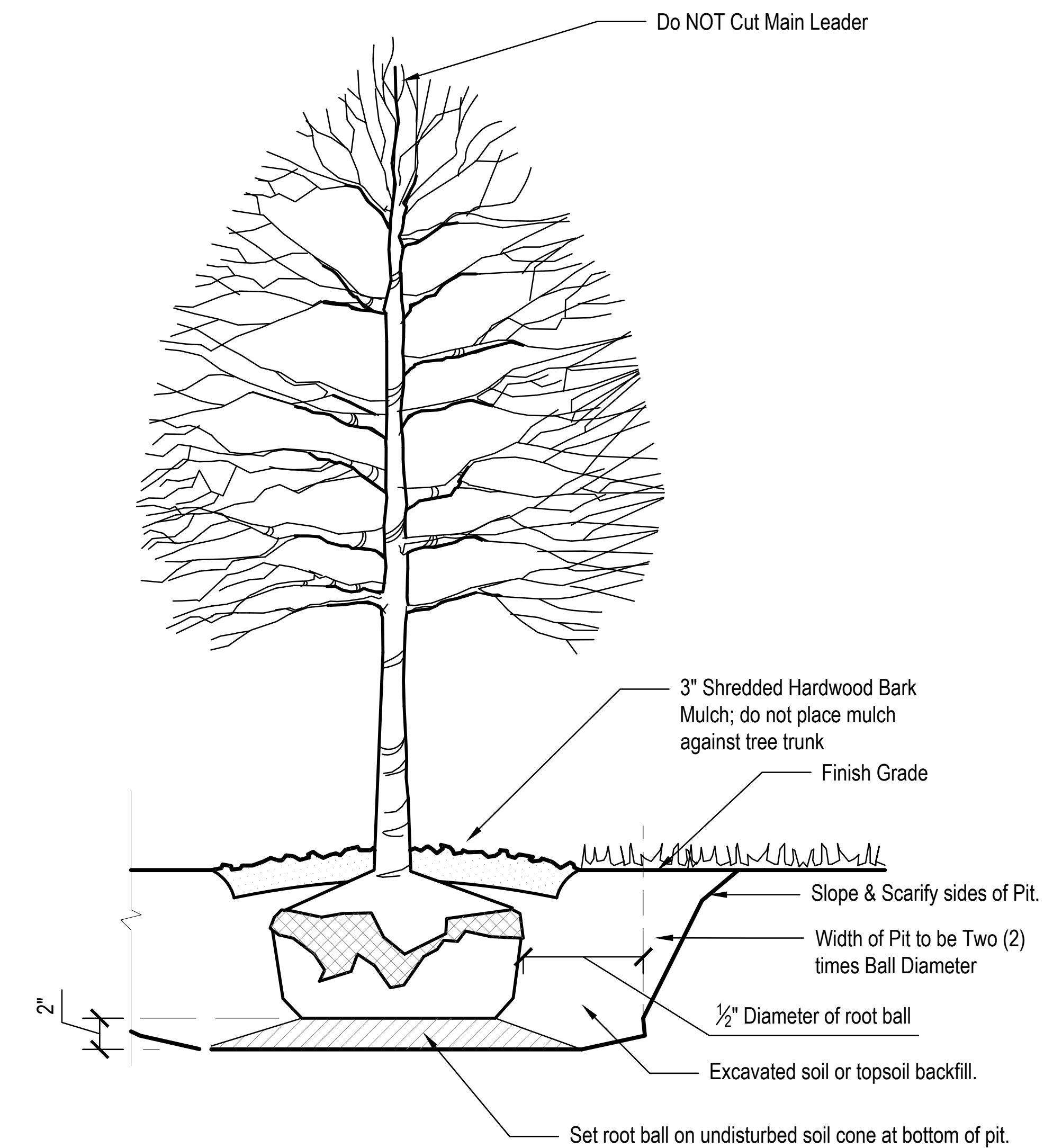

2 SHADE TREE
Scale: Not to Scale

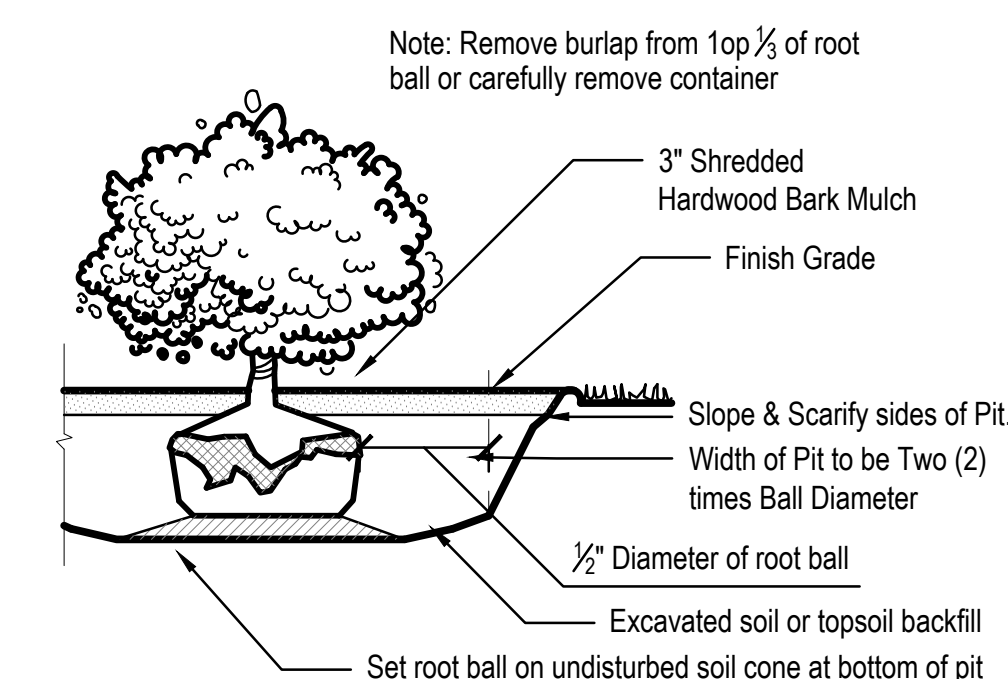

1 SHRUB
Scale: Not to Scale



Revision	Date	Description

Date: 2023/04/13
Project No: 23-1650
Drawn by: AY
Checked by: FP

These Drawings and Specifications, and all copies thereof are and shall remain the property and copyright of the Landscape Architect. They shall be used only with respect to this Project and are not to be used on any other Project or Work without prior written permission from the Landscape Architect.

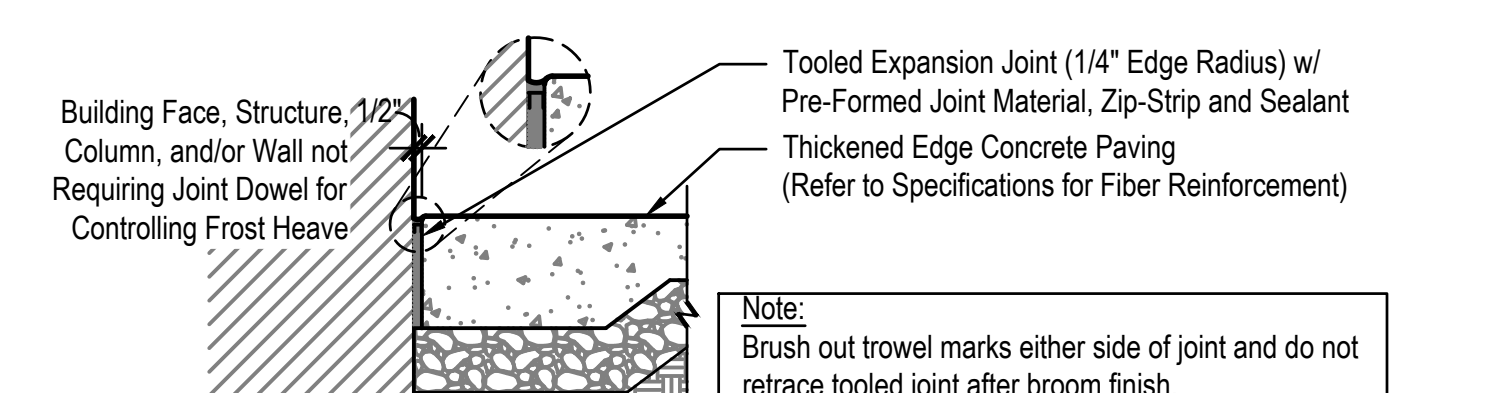
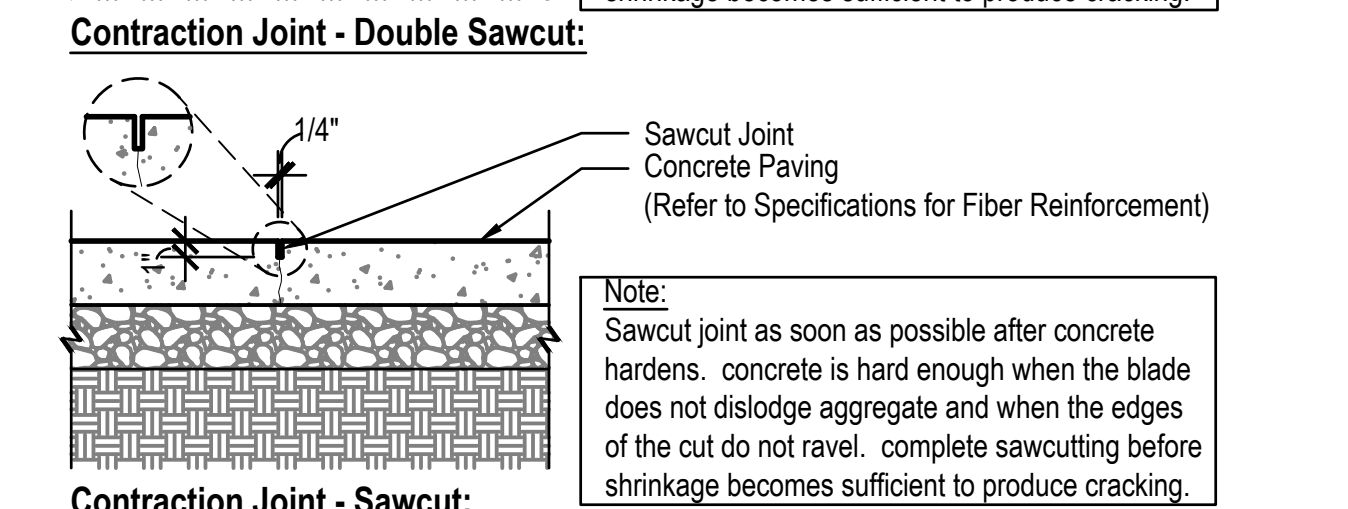
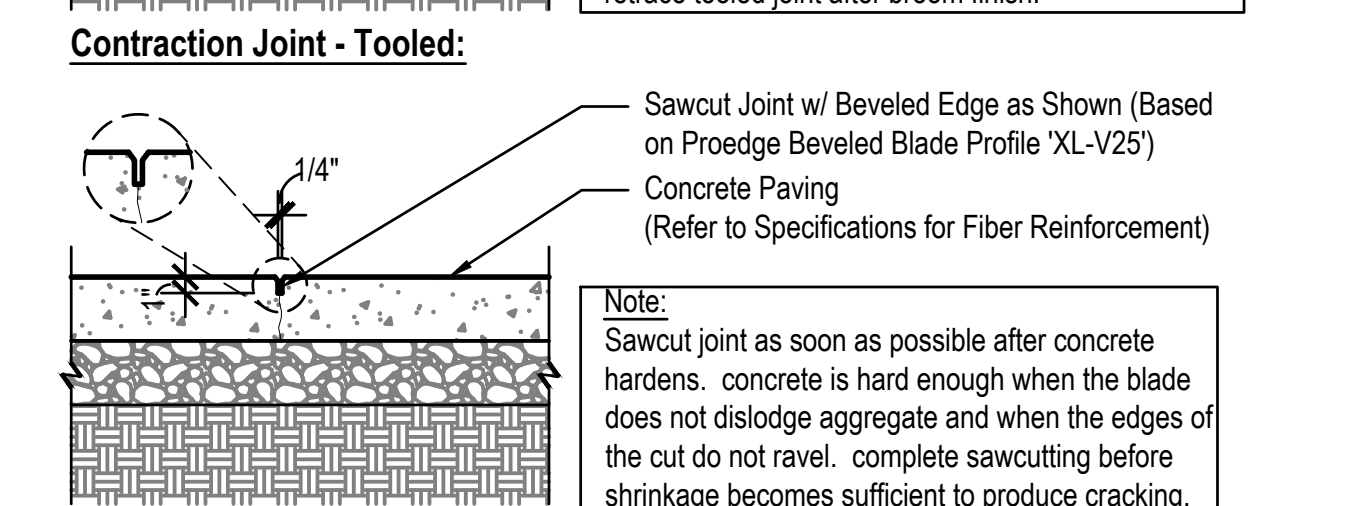
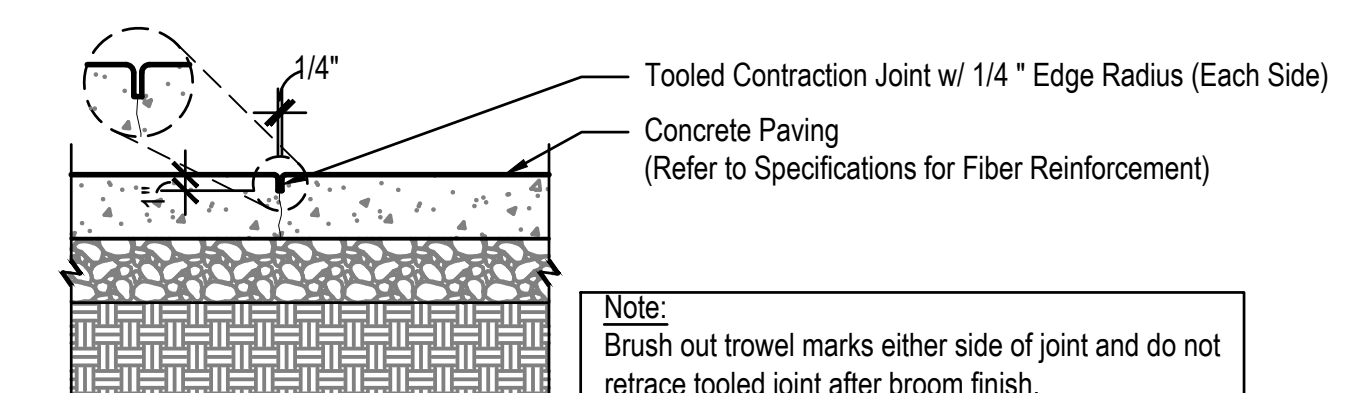
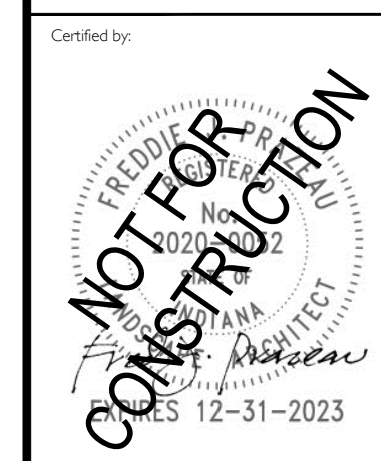

Expansion Joint @ Vertical Construction (Not @ Building Entry):

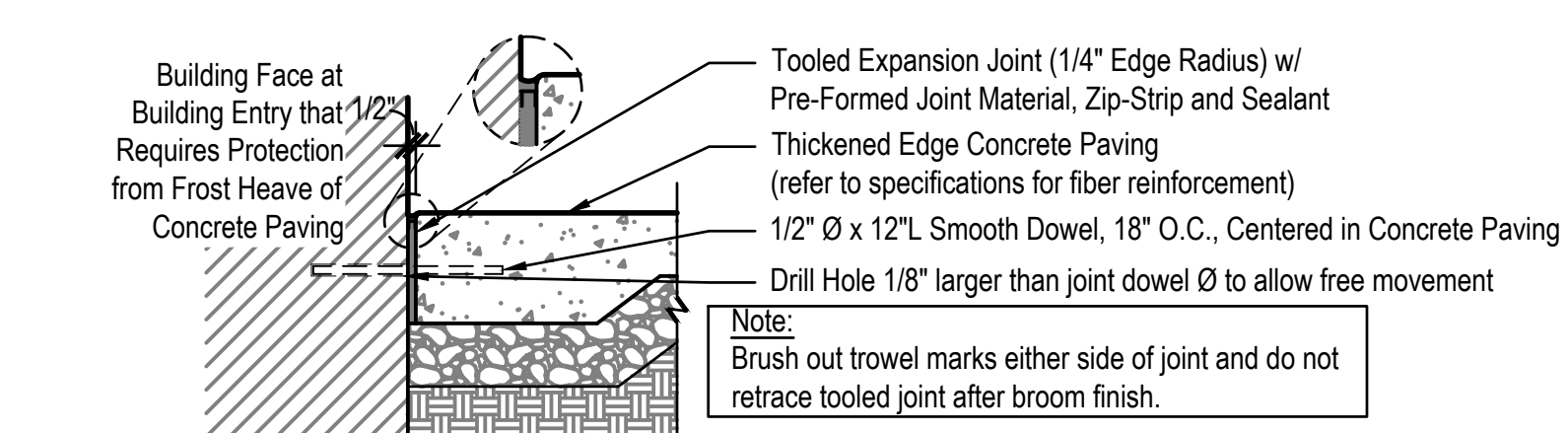

Expansion Joint @ Vertical Construction (For Building Entry):

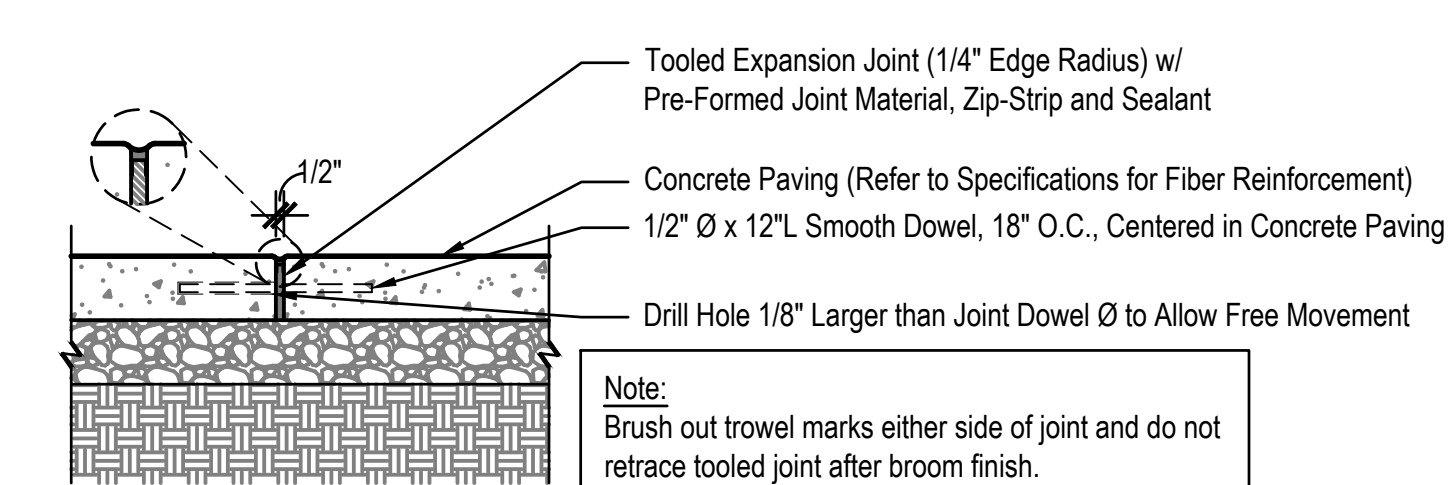

Expansion Joint within Paving:

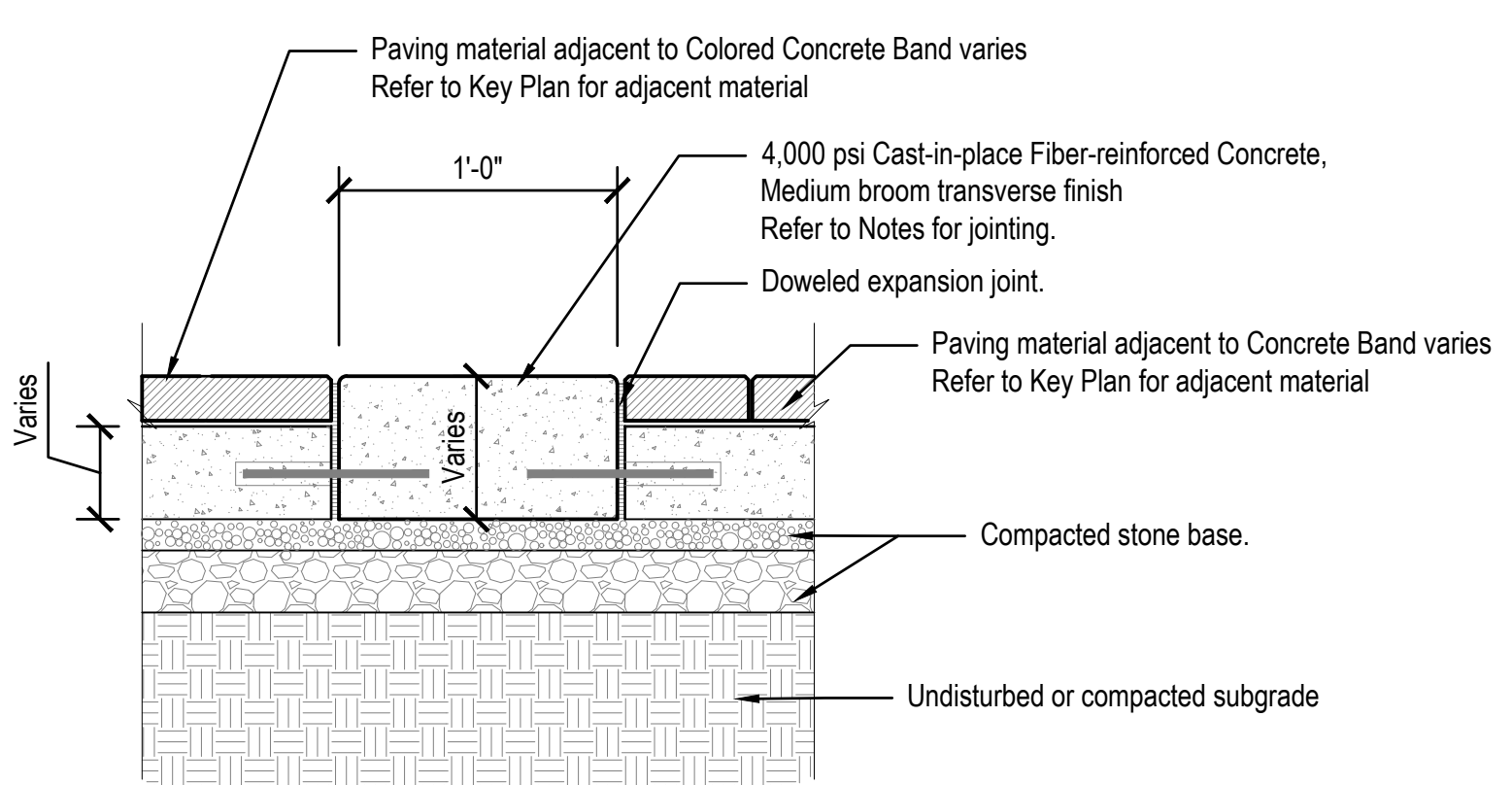

- NOTES:**
- Concrete bands shall have 1/2" wide expansion joints at 40'-0" max., where bands abut adjacent concrete curbs or other concrete pavements, and as otherwise noted on the plans.
 - Control joints shall be cut 1/4" depth of total thickness of the band, and be spaced at 1'-6".
 - Fiber additive: Virgin nylon fibers, 3/4" length, Nycon by Nycon Inc., or Forta Nylon by Forta Corporation, added at the batch plant at 1 lb. per cu. yd. of concrete.

4 CONCRETE BAND AT PAVERS
1" = 1'-0"

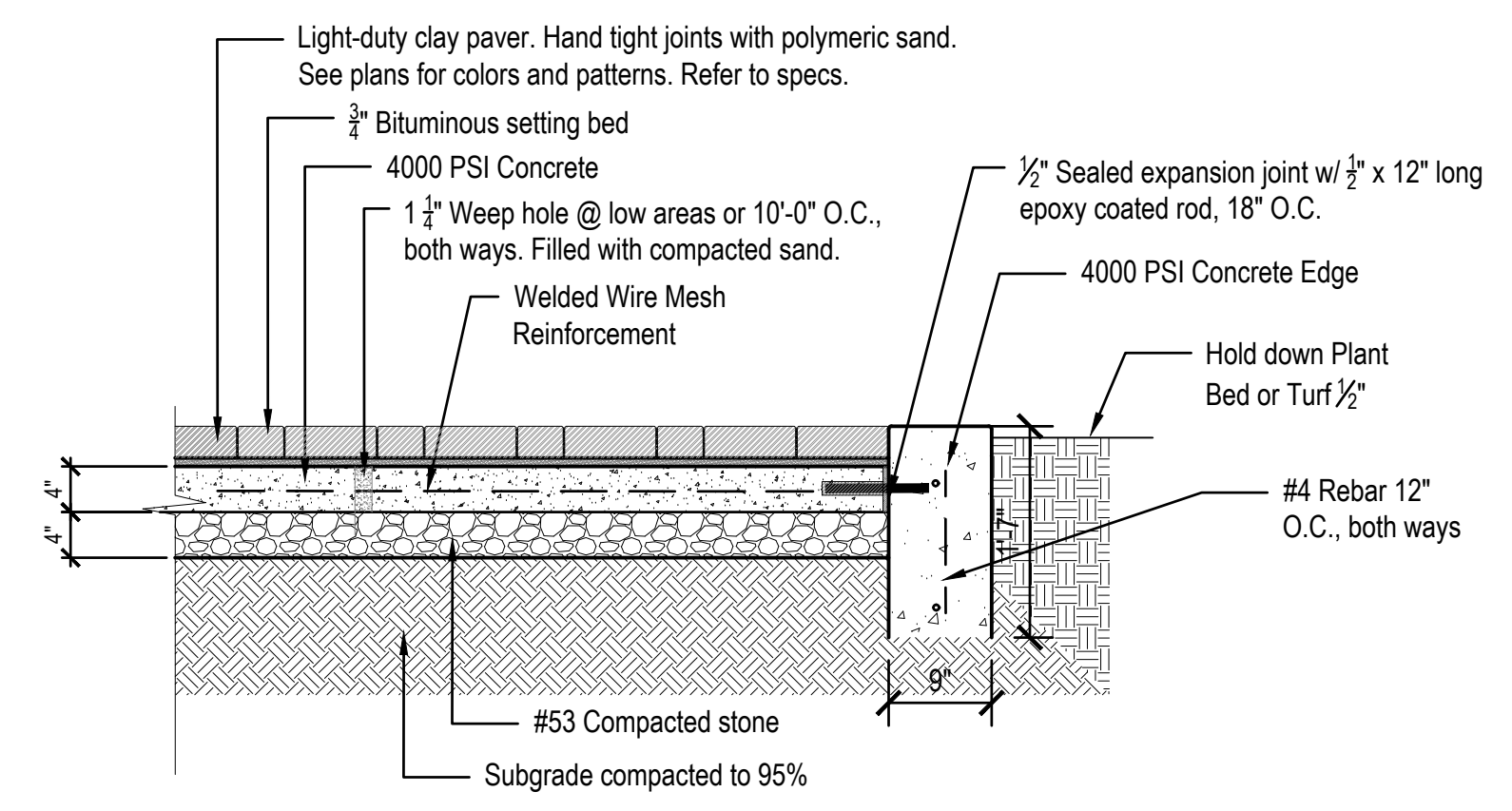

NOTE: Refer to Detail X this sheet for additional conditions.

3 PAVER, LIGHT DUTY ON BITUM w/ CONCRETE EDGE
Scale: 3/4" = 1'-0"

2 CONCRETE JOINTING
Scale: 1" = 1'-0"

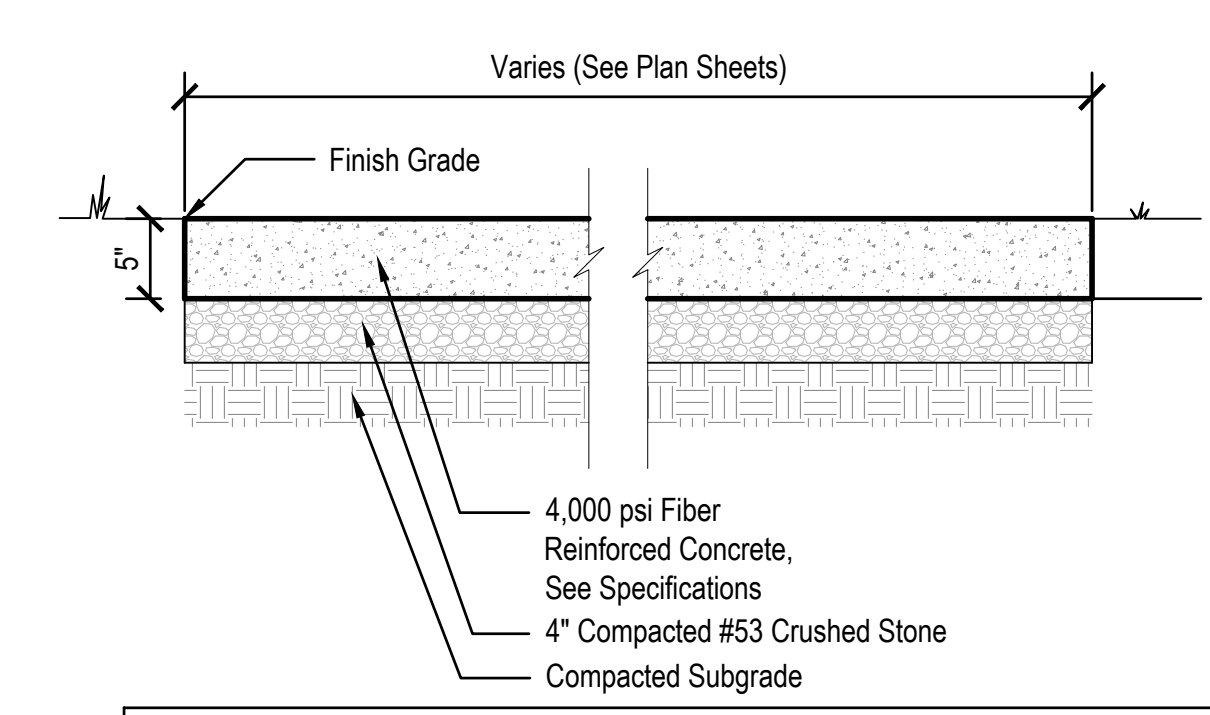

- Notes:**
- Provide expansion joints at intersection with another sidewalk, between walks and building slabs, and at other points as indicated on the drawings.
 - Refer to plan drawings for locations of control and expansion joints.
 - Refer to specification section 32 for additional information, including integral color information.

1 STANDARD DUTY CONCRETE PAVEMENT
Scale: 1" = 1'-0"

Revision	Date	Description

Date: 2023/04/13
Project No: 23-1650
Drawn by: AY
Checked by: FP

These Drawings and Specifications, and all copies thereof are and shall remain the property and copyright of the Landscape Architect. They shall be used only with respect to the Project and are not to be used on any other Project or Work without prior written permission from the Landscape Architect.

Revision	Date	Description

Date: 2023/04/13
Project No: 23-1650
Drawn by: AY
Checked by: FP

These Drawings and Specifications, and all copies thereof are and shall remain the property and copyright of the Landscape Architect. They shall not be used in any other Project or Work without prior written permission from the Landscape Architect.

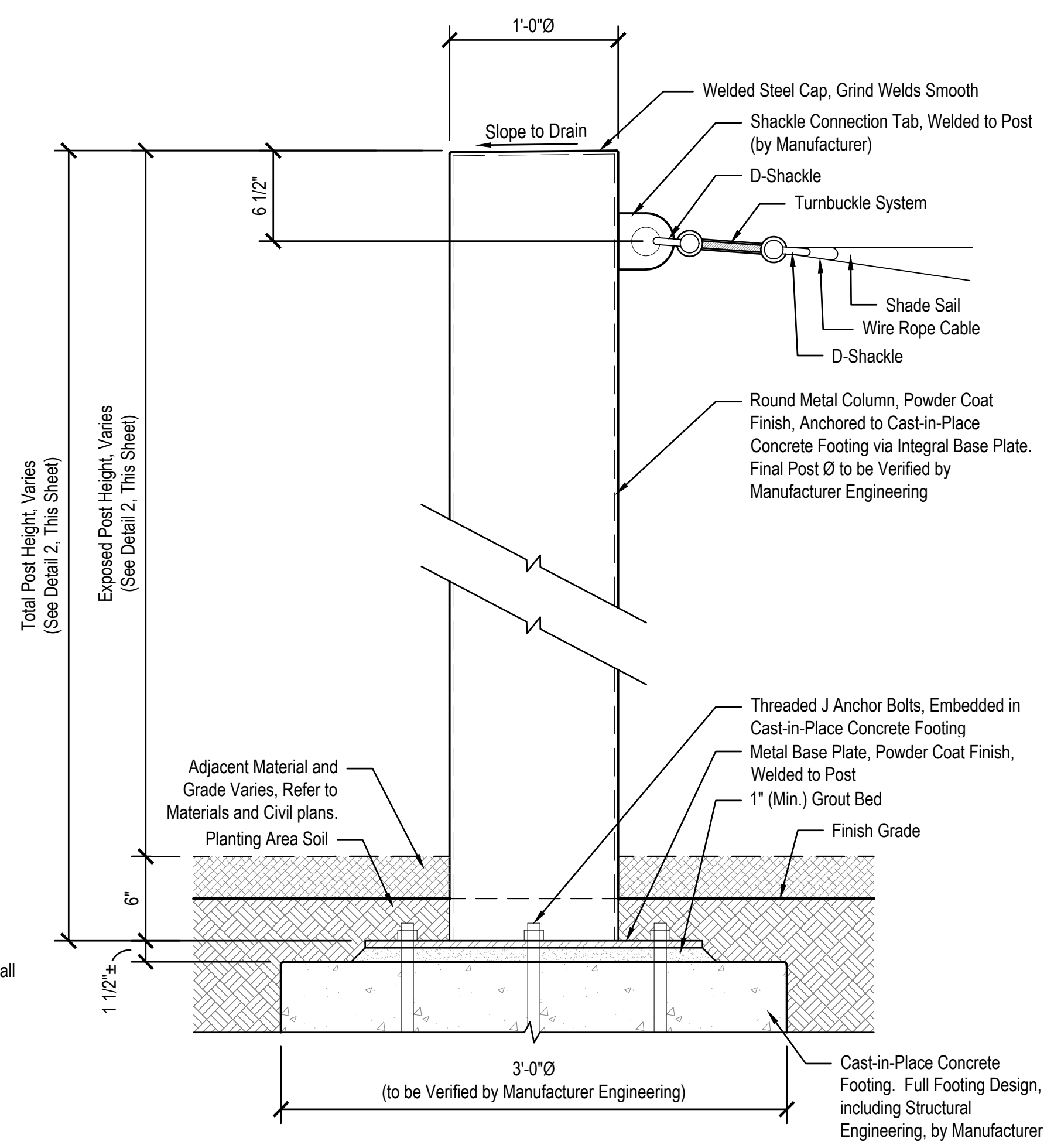

2 SHADE SAIL POST
Scale: 1-1/2" = 1'-0"

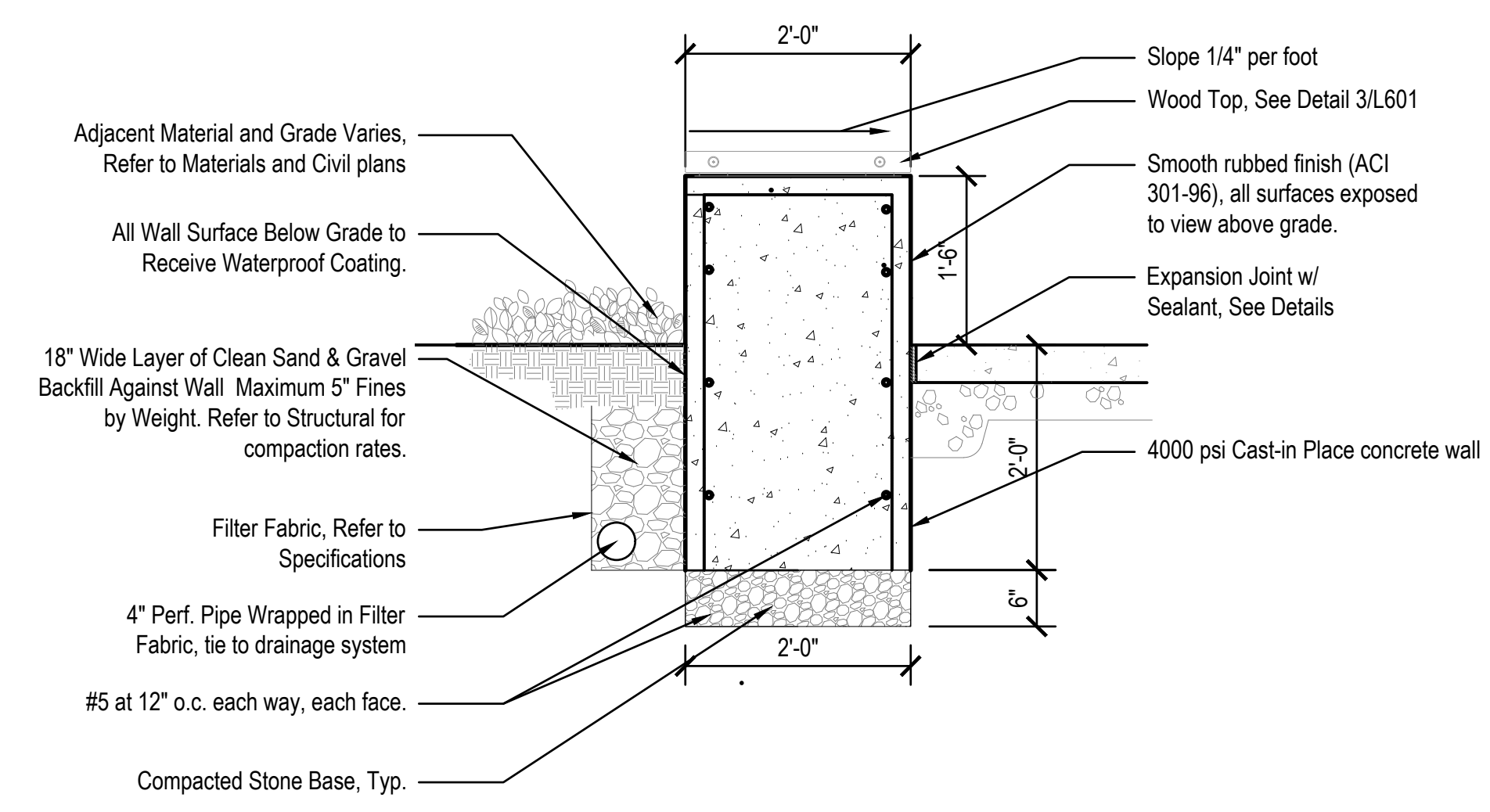

4 CIP CONCRETE PLANTER WALL SECTION
Scale: 3/4" = 1'-0"

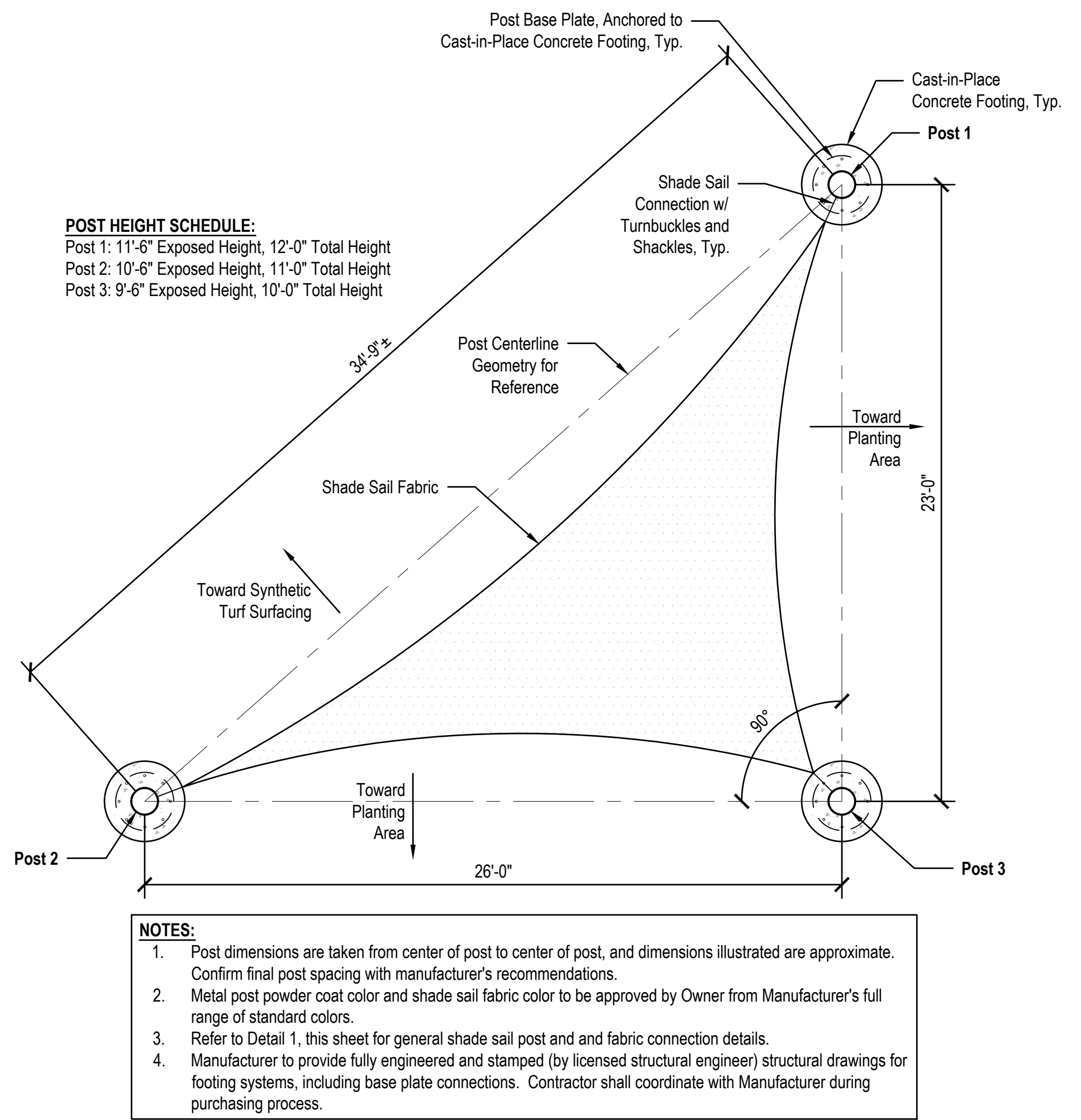

POST HEIGHT SCHEDULE:
Post 1: 11'-6" Exposed Height, 12'-0" Total Height
Post 2: 10'-6" Exposed Height, 11'-0" Total Height
Post 3: 9'-6" Exposed Height, 10'-0" Total Height

- NOTES:**
- Post dimensions are taken from center of post to center of post, and dimensions illustrated are approximate. Confirm final post spacing with manufacturer's recommendations.
 - Metal post powder coat color and shade sail fabric color to be approved by Owner from Manufacturer's full range of standard colors.
 - Refer to Detail 1, this sheet for general shade sail post and fabric connection details.
 - Manufacturer to provide fully engineered and stamped (by licensed structural engineer) structural drawings for footing systems, including base plate connections. Contractor shall coordinate with Manufacturer during purchasing process.

1 TYPICAL SHADE SAIL PLAN
Scale: 1/4" = 1'-0"

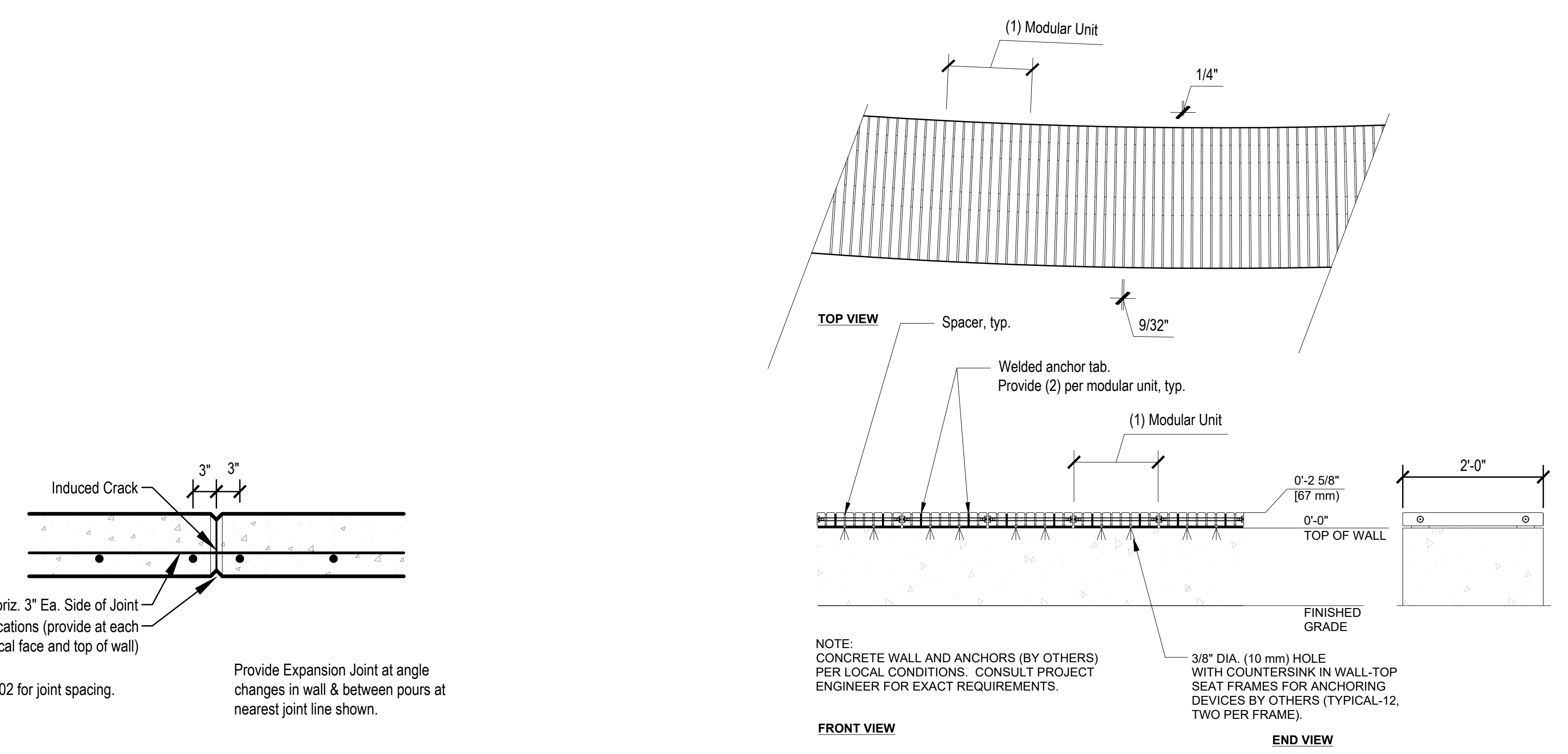

3 CONTRACTOR/CUSTOM FABRICATED SEAT TOP
Scale: 3/4" = 1'-0"

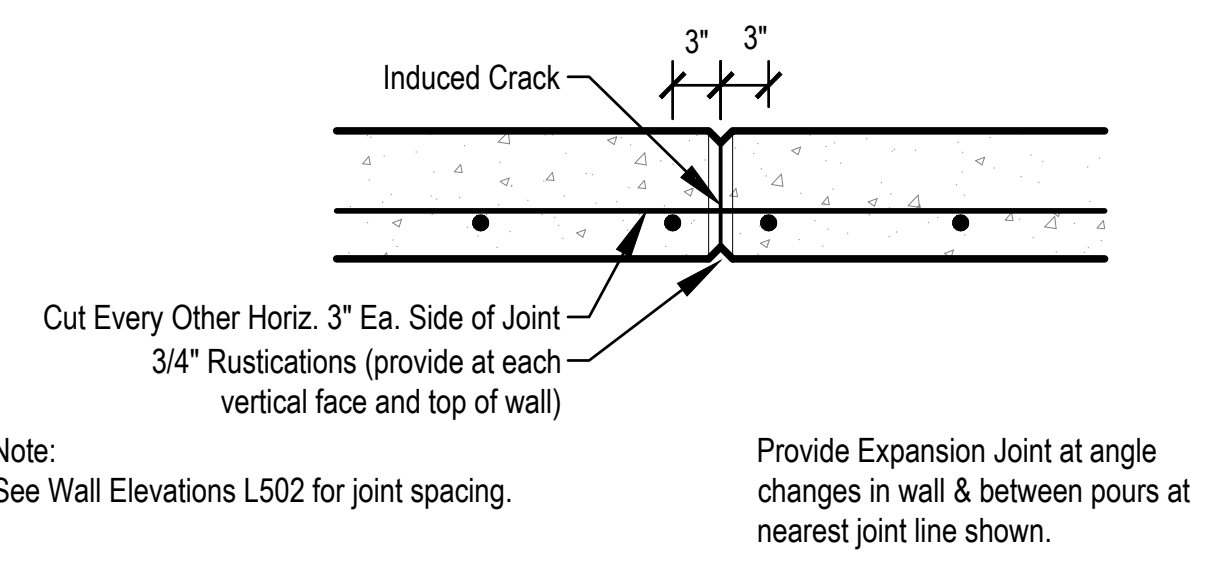

5 SITE WALL CONTROL JOINT DETAIL
Scale: 1" = 1'-0"

Note: See Wall Elevations L502 for joint spacing.

Provide Expansion Joint at angle changes in wall & between pours at nearest joint line shown.