

LEGEND

- OHE — OVERHEAD ELECTRIC
- BUSH
- ⊗ CONIFEROUS TREE
- DECIDUOUS TREE
- FLAGPOLE/BASKEBALL
- ⊗ LIGHT POLE
- POST
- UTILITY POLE

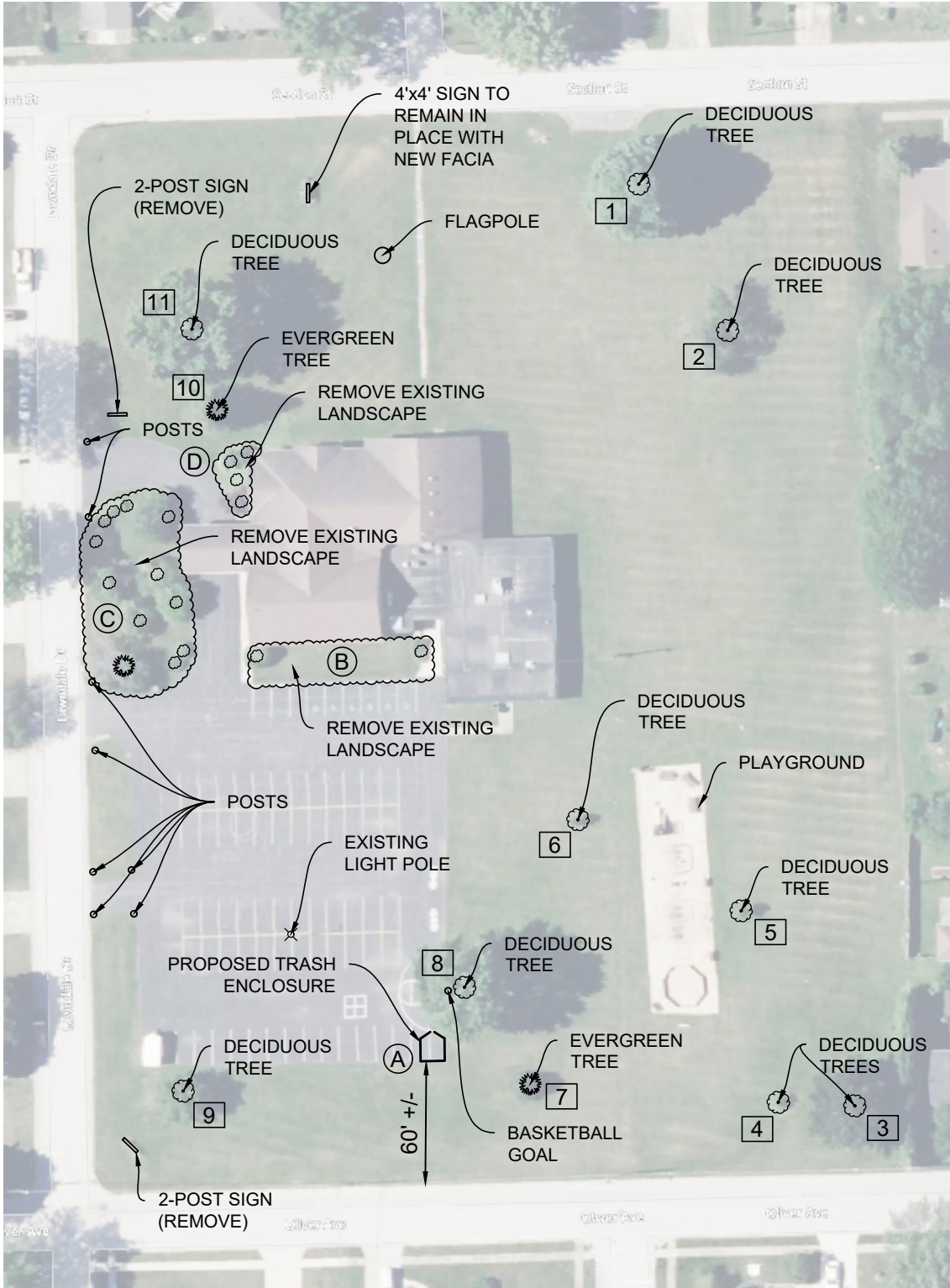

PROPOSED LANDSCAPING

- (A) 10 - SHRUBS
- (B) 16 - SHRUBS
- (C) 24 - SHRUBS & 3 - 4' TALL EVERGREENS
- (D) 8 - SHRUBS

EXISTING TREES

NOTE: IF TREES ARE DESTROYED, REMOVED, OR ARE DECEASED WITHIN 5 YEARS OF APPROVAL, RECOMMENDED REPLACEMENT WILL BE AS FOLLOWS:

- 1 3 - 1 1/2" CALIPER DECIDUOUS TREE
- 2 2 - 1 1/2" CALIPER DECIDUOUS TREE
- 3 3 - 1 1/2" CALIPER DECIDUOUS TREE
- 4 1 - 1 1/2" CALIPER DECIDUOUS TREE
- 5 1 - 1 1/2" CALIPER DECIDUOUS TREE
- 6 1 - 1 1/2" CALIPER DECIDUOUS TREE
- 7 2 - 4' EVERGREEN TREE
- 8 3 - 1 1/2" CALIPER DECIDUOUS TREE
- 9 2 - 1 1/2" CALIPER DECIDUOUS TREE
- 10 2 - 4' EVERGREEN TREE
- 11 3 - 1 1/2" CALIPER DECIDUOUS TREE