

EAST SIDE BUILDING PLANTINGS

GENERAL NOTES

- IN CASE OF DISCREPANCIES BETWEEN THE PLAN AND THE PLANT LIST, THE PLAN SHALL DICATE. IF IN QUESTION, CONTACT THE LANDSCAPE ARCHITECT.
- IT SHALL BE THE RESPONSIBILITY OF THE CONTRACTOR TO VERIFY ALL EXISTING UTILITIES PERTAINING TO THEIR PHASE OF WORK. UTILITIES ARE SHOWN TO BE APPROXIMATE. CALL UTILITY LOCATE PRIOR TO ANY PLACEMENT OF PLANT MATERIAL OR OTHER LANDSCAPE MATERIAL.
- THE CONTRACTOR SHALL OBTAIN AND PAY FOR ALL PERMITS AND FEES THAT MAY BE REQUIRED FOR HIS PORTION OF WORK.
- ANY EXISTING TREES(S) AND/OR PLANTINGS THAT MAY REQUIRE REMOVAL BUT ARE NOT SHOWN ON THE PLAN AS BEING REMOVED SHALL BE PROTECTED AND BROUGHT TO THE ATTENTION OF THE LANDSCAPE ARCHITECT TO DETERMINE IF TREE(S) AND/OR PLANTINGS SHOULD BE 1) REMOVED, 2) SAVED AND INTEGRATED INTO THE LANDSCAPE DESIGN, OR 3) RELOCATED.
- CONTRACTOR TO REVIEW THE SWPPP SERIES PLANS FOR STABILIZATION (SEEDING/SOD/MULCH) REQUIREMENTS.
- PLANTING BEDS AND PLANT MATERIAL SHALL BE LOCATED AS INDICATED ON LANDSCAPE PLAN. IN THE EVENT FIELD CHANGES OR CONDITIONS REQUIRE MODIFICATION TO THE LANDSCAPE DESIGN, THE CONTRACTOR SHALL CONSULT LANDSCAPE ARCHITECT AS TO PROPOSED MODIFICATIONS PRIOR TO PLANTING. THE LANDSCAPE ARCHITECT RESERVES THE RIGHT TO ADJUST PLANT LOCATIONS ON SITE IF NECESSARY.
- ALL PLANTS ARE TO MEET OR EXCEED AMERICAN STANDARD FOR NURSERY STOCK, LATEST EDITION, AS SET FORTH BY AMERICAN ASSOCIATION OF NURSEYMEN.
- PLANTS SHALL BE CERTIFIED BY THE STATE OF INDIANA DEPARTMENT OF NATURAL RESOURCES AND FREE FROM DISEASE OR HAZARDOUS INSECTS.
- PLANTS SHALL BE UNAVAILABLE, THE CONTRACTOR SHALL NOTIFY LANDSCAPE ARCHITECT PRIOR TO BID DATE IN WRITING. THE CONTRACTOR SHALL COMPENSATE THE LANDSCAPE ARCHITECT FOR THE TIME REQUIRED FOR REVIEW AND INSPECTION OF PROPOSED PLANT SUBSTITUTIONS BID AWARD.
- ALL PLANT MATERIAL SHALL BE SPECIMEN QUALITY. SUBMIT COLOR OR PHOTOGRAPHS OF PROPOSED PLANT MATERIAL TAKEN IN THE NURSERY WHERE THEY ARE GROWING. THE LANDSCAPE ARCHITECT RESERVES THE RIGHT TO INSPECT PLANT MATERIALS AT NURSERY OR CONTRACTOR YARD PRIOR TO DELIVERY TO THE SITE. THE LANDSCAPE ARCHITECT MAY ALSO INSPECT AND APPROVE OR REJECT PLANT MATERIAL ON THE JOB SITE. IN THE EVENT PLANT MATERIAL IS NOT THE SPECIFIED SIZE OR QUALITY, PLANTS WILL BE REMOVED AND REPLACED AT THE CONTRACTOR'S EXPENSE.
- PLANTS AND OTHER LANDSCAPE MATERIALS TO BE STORED ON SITE WILL BE PLACED WHERE THEY WILL BE PROTECTED AND NOT CONFLICT WITH CONSTRUCTION OPERATIONS.
- COMPOST SHALL BE A WELL DECOMPOSED, STABLE, WEE FREE ORGANIC MATTER SOURCE. IT SHALL BE DERIVED FROM: AGRICULTURAL FOOD, OR INDUSTRIAL RESIDUALS; BIOSOLIDS (TREATED SEWAGE SLUDGE); YARD TRIMMINGS; SOURCE SEPARATED OR MIXED SOLID WASTE. THE PRODUCT SHALL CONTAIN NO SUBSTANCES TOXIC TO PLANTS AND SHALL BE REASONABLY FREE (< 1% BY DRY WEIGHT) OF MAN-MADE FOREIGN MATTER. THE COMPOST WILL POSSESS NO OBJECTIONABLE ODORS AND SHALL NOT RESEMBLE THE RAW MATERIAL FROM WHICH IT WAS DERIVED.
- SHRUB AND PERENNIAL BEDS SHALL BE PREPARED BY PLACING 3" OF APPROVED COMPOST OVER PULVERIZED TOPSOIL AND ROTOTILLING TO A DEPTH OF 6".
- PRE-EMERGENT HERBICIDE SHALL BE APPLIED IN ANY PLANTING AND GROUND COVER BEDS PRIOR TO MULCHING AT RATES SPECIFIED BY MANUFACTURER FOR EACH VARIETY OF PLANT. PRE-EMERGENT HERBICIDE SHALL BE APPROVED BY THE LANDSCAPE ARCHITECT PRIOR TO APPLICATION.
- ALL TREE AND SHRUB PLANTING AREAS TO BE COVERED WITH 3" THICK LAYER OF SHREDDED HARDWOOD BARK MULCH. ALL GROUND COVER BEDS SHALL BE COVERED WITH 1" SHREDDED HARDWOOD BARK MULCH. BARK MULCH SHALL BE APPROVED BY THE LANDSCAPE ARCHITECT. MULCH SHALL BE UNIFORM IN TEXTURE AND COLOR AND SHALL BE FREE OF STICKS, LEAVES, SOIL AND FOREIGN MATERIAL. NO UTILITY MULCH OR PROCESSED TREE TRIMMINGS WILL BE ALLOWED.
- CONTRACTOR SHALL MAINTAIN ALL LAWN AREAS AND PLANT MATERIAL UNTIL ALL PUNCH LIST WORK HAS BEEN COMPLETED AND WRITTEN FINAL ACCEPTANCE BY THE LANDSCAPE ARCHITECT OR OWNER. MAINTENANCE SHALL BEGIN IMMEDIATELY AFTER EACH PLANT IS INSTALLED AND SHALL INCLUDE BUT NOT LIMITED TO: WATERING, WEEDING, PRUNING, DISEASE AND INSECT CONTROL, MOWING, RESETTING OF PLANTS TO PROPER GRABES OR UPRIGHT POSITION, AND ANY OTHER PROCEDURE CONSISTENT WITH GOOD HORTICULTURAL PRACTICES.
- ALL NEW LANDSCAPE PLANTINGS SHALL BE GUARANTEED FOR A PERIOD OF ONE YEAR FOLLOWING FINAL ACCEPTANCE AS DETERMINED BY LANDSCAPE ARCHITECT OR OWNER. AT THE END OF THIS PERIOD, PLANT MATERIAL DETERMINED TO BE DEAD OR UNSATISFACTORY BY LANDSCAPE ARCHITECT OR OWNER SHALL BE REPLACED AT NO ADDITIONAL CHARGE BY THE CONTRACTOR.

LANDSCAPE ORDINANCE REQUIREMENTS

REQUIREMENT:	REQUIRED:	PROVIDED:
SECTION 4.7.D. FOUNDATION PLANTING = 2' X WALL LENGTH PER SIDE -NE - TOTAL WALL LENGTH: 237' REQUIRED AREA: 474 S.F. (LEVEL 1 = 1.0 PER 100 L.F.) -SW - TOTAL WALL LENGTH: 181' (15% OF WALL WILL BE COVERED BY FUTURE PHASE. NO FOUND PLNTS SHN) REQUIRED AREA: 362 S.F. AREA -NW & SE WALLS WILL BE COVERED BY FUTURE PHASE(S) - NO FOUND PLANTINGS SHOWN	-474 S.F. AREA -2.40 POINTS	-618 S.F. AREA -2.50 POINTS
SECTION 4.7.E.1. INTERIOR PARKING LOT = 1 INTERIOR ISLAND PER 15 PARKING STALLS -24 PROPOSED PARKING STALLS -2 REQUIRED ISLANDS -3 PROPOSED ISLANDS (2 ARE END ISLANDS)	-2 TREES	-3 TREES
SECTION 4.7.E.2. PERIMETER PARKING LANDSCAPING -REQUIRED HEDGE ROW PLANTED 3' O.C. AND 24"-30" AT TIME OF PLANTING -OR PLANT UNIT VALUE OF 1.5 IF COMBINED WITH ORNAMENTAL TREES	-X SHRUBS -X TREES -X TREE	-Y SHRUBS -Y TREES -X TREE
TABLE 4.7.A. PERIMETER LANDSCAPE YARDS -WEST (GC): LEVEL 1 = 2 TREES (SHADE, ORNAMENTAL OR EVERGREEN) PER 100 L.F. -NORTH (GC): LEVEL 1 = 2 TREES (SHADE, ORNAMENTAL OR EVERGREEN) PER 100 L.F. -EAST (GC): LEVEL 1 = 2 TREES (SHADE, ORNAMENTAL OR EVERGREEN) PER 100 L.F. -SOUTH (1/2 SOUTH OF I-70): LEVEL 1 = 2 TREES (SHADE, ORNAMENTAL OR EVERGREEN) PER 100 L.F.	-2 TREES	-3 TREES

PLANT SCHEDULE							
PLAN KEY	BOTANICAL NAME	COMMON NAME	SIZE	QUANTITY	ROOT BALL CONT.	MATURE SIZE	SPECIAL INSTRUCTIONS
DECIDUOUS TREES							
A/O	ACER RUBRUM 'OCTOBER GLORY'	OCTOBER GLORY RED MAPLE	2 1/2"	10	X	40T x 30W	X
AgG	ACER SACCHARUM 'GREEN MOUNTAIN'	GREEN MOUNTAIN SUGAR MAPLE	2 1/2"	9	X	40T x 25W	X
G/H	GLEDISIA TRIACANTHOS 'SKYLINE'	SKYLINE HONEYLOCUST	2 1/2"	10	X	35T x 25W	X
QaW	QUERCUS ALBA	WHITE OAK	2 1/2"	8	X	50T x 50W	X
QaL	QUERCUS RUBRA	NORTHERN RED OAK	2 1/2"	9	X	50T x 50W	X
Tn	TILIA CORDATA 'GREENSPIRE'	GREENSPIRE LINDEN	2 1/2"	26	X	50T x 35W	X
EVERGREEN TREES							
AcW	ABIES CONCOLOR	WHITE FIR	8' HT.	30	X	40T x 20W	X
PnN	PICEA ABIES	NORWAY SPRUCE	8' HT.	35	X	40T x 25W	X
PnA	PINUS NIGRA	AUSTRIAN PINE	8' HT.	18	X	40T x 20W	X
PpB	PICEA PUNGENS 'GLAUC'A'	COLORADO BLUE SPRUCE	8' HT.	20	X	37T x 10W	X
PpG	PICEA PUNGENS	COLORADO GREEN SPRUCE	8' HT.	29	X	30T x 10W	X
ORNAMENTAL UNDERSTORY TREES							
CcE	CERCIS CANADENSIS	EASTERN REDBUD	1 1/2"	24	X	20T x 20W	X
CcT	CRATAEGUS CRUS-GALLI 'NERMES'	THORNLESS COCKSPUR HAWTHORN	1 1/2"	18	X	20T x 20W	X
CcK	CORNUS KOUSA	KOUSA DOGWOOD	1 1/2"	4	X	15T x 15W	MULTI-STEM
Msa	MALUS SPECIES 'ADAMS'	ADAMS CRABAPPLE	1 1/2"	21	X	15T x 15W	X
Msp	MALUS SPECIES 'PRAIRIE FIRE'	PRAIRIE FIRE CRABAPPLE	1 1/2"	13	X	15T x 15W	X
SrT	SYRINGA RETICULATA 'TVORY SILK'	TREE JAPANESE LILAC	1 1/2"	20	X	20T x 15W	X
DECIDUOUS SHRUBS							
HmP	HYDRANGEA MACROPHYLLA 'PIA'	PIA COMPACT HYDRANGEA	18"	10	X	21T x 2W	X
PpG	PHYSOCARPUS OPULIFOLIUS 'CENTER GLOW'	CENTER GLOW COMMON NINEBARK	24"	8	X	6T x 6W	X
VjJ	VIBURNUM x JUDDII	JUDD VIBURNUM	24"	15	X	6T x 6W	X
EVERGREEN SHRUBS							
BkG	BUXUS x KOREANA 'GREEN VELVET'	GREEN VELVET BOXWOOD	18"	14	X	3T x 3W	X
TmD	TAXUS x MEDIA 'DENSIFORMIS'	DENSE JAPANESE YEW	18"	43	X	3T x 4W	X

LANDSCAPE PLAN NOTES

- SEED / SOD (ALTERNATE) - FOR SEED, REFER TO PERMANENT SEEDING CHART ON SHEET L201 LANDSCAPE DETAIL SHEET. SOD SHALL BE CERTIFIED GRADE CULTIVATED GRASS SOD OF "ADVENTURE BLEND" TURF TYPE TALL FESCUE (BY GENERAL CONTRACTOR).
- LANDSCAPE BED EDGE (TYP.)
- MULCH

LEGEND



PLAN CERTIFICATE NOTE:

ORIGINAL ALTA, PLAT, TOPOGRAPHY, UTILITIES, STORM SEWERS, AND ALL OTHER EXISTING CONDITIONS ITEMS WERE PREPARED BY HAMILTON DESIGN GROUP, HORN, WEIHE ENGINEERS INC. AND RUSSELL L. WEBSTER II ACCEPT RESPONSIBILITY ONLY FOR THE SITE IMPROVEMENTS RELATED TO THE LIMITED ENGINEERING SCOPE SHOWN ON THESE PLANS.

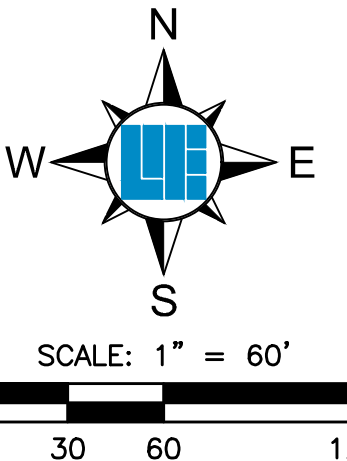

811
Know what's below. Call before you dig.
Within Indiana Call 811 or 300-332-5544 24 Hours a Day, 7 Days a Week.
PER INDIANA STATE LAW IC 8-1-26, IT IS AGAINST THE LAW TO EXCAVATE WITHOUT NOTIFYING THE UNDERGROUND LOCATION SERVICE TWO (2) WORKING DAYS BEFORE COMMENCING WORK.

10505 N. College Avenue
Indianapolis, Indiana 46280
weihe.net
317 | 846 - 6611
800 | 452 - 6408
317 | 843 - 0546 fax
ALLAN H. WEIHE, P.E., L.S., FOUNDER

WEIHE ENGINEERS
Land Surveying | Civil Engineering
Landscape Architecture
Build with confidence.

REVISIONS AND ISSUES	DATE	BY	PROJECT NO.	DWG NAME	DESIGNED BY	DRAWN BY	CHECKED BY	DATE
ISSUED FOR 100% REVIEW	03-25-2022	M.L.T.	W21.0415	W210415-100	MARK L. THORPE	J.L.K.	M.L.T.	03-25-2022

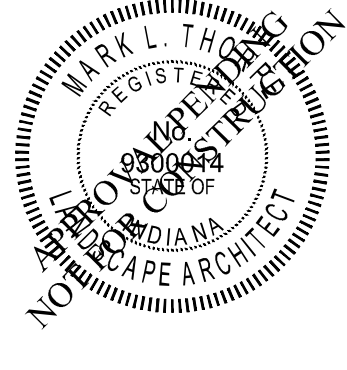

MARK L. THORPE, R.L.A. No. 9300014

PREPARED FOR:
VERIZON PLAINFIELD
17.58 ACRES ADJACENT TO 6295 GATEWAY DRIVE, PLAINFIELD, INDIANA, 46168
LANDSCAPE PLAN
Part of the W21 of Section 12, Township 14 North, Range 1 East, Guilford Township, Hendricks County, Indiana

SHEET NO.
L100
PROJECT NO.
W21.0415

LOCATION: W:\2021\W21.0415\Engineering\Design\Layout\W21.0415-1-100.dwg
DATE/TIME: April 14, 2022 - 11:45am
PLOTTER: HP DesignJet T1100ps