

DRG PLAINFIELD SPEC BUILDING

SE 1/4, SEC. 18 - T15N - R2E, HENDRICKS COUNTY, WASHINGTON TOWNSHIP, PLAINFIELD, INDIANA
 ADDRESS: 9500 E. COUNTY ROAD 200 SOUTH
 ZONED: I2

PLANS PREPARED FOR:
 ARCO DESIGN/BUILD
 101 W. OHIO STREET, SUITE 1150
 INDIANAPOLIS, IN 46204
 317-308-2700
 CONTACT: BEN TITUS

PROJECT LOCATION

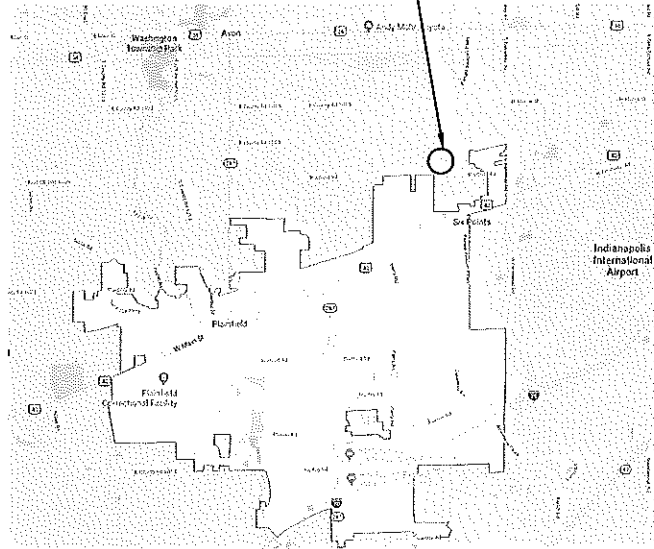

VICINITY MAP
NO SCALE

PROJECT LOCATION

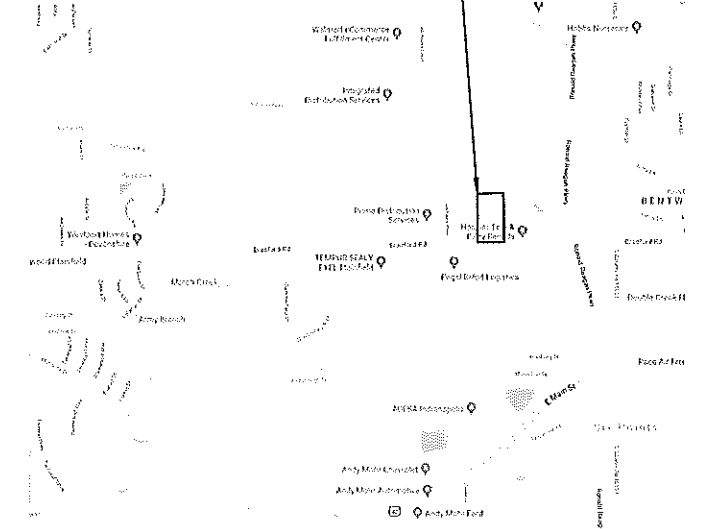

LOCATION MAP
NO SCALE

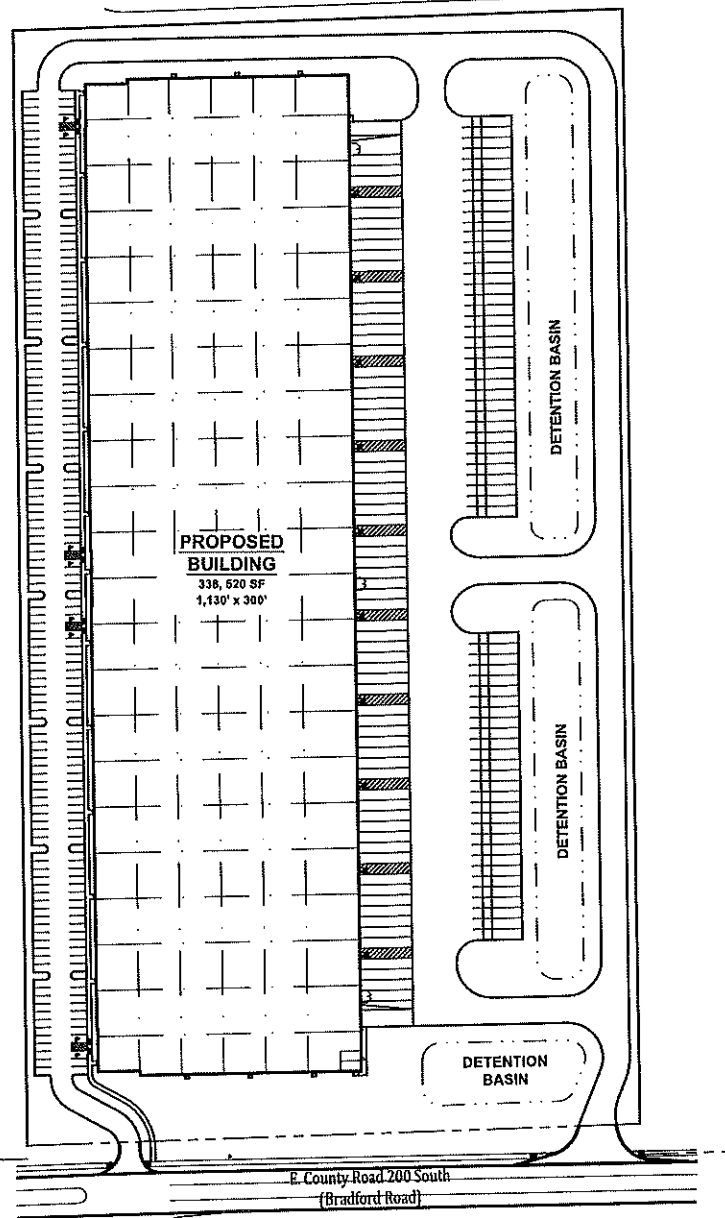

SITE MAP
SCALE: 1" = 100'

OPERATING AUTHORITIES

GAS Vectron 1995 East Main Street Danville, IN 46122 317-718-3516	CABLE TELEVISION Bright House Networks 3030 Roosevelt Ave. Indianapolis, IN 46218 317-632-9077	WATER Plainfield DPW 986 S. Center Street Plainfield, IN 46168 317-839-3490
SANITARY Plainfield DPW 986 S. Center Street Plainfield, IN 46168 317-839-3490	ELECTRIC Duke Energy 5905 E. Main Street Danville, IN 46122 317-745-4481	TELEPHONE AT&T 240 N. Meridian Street Indianapolis, IN 46204 317-722-2299
SCHOOL DISTRICT Avon Community School Corporation 7203 E US Hwy 36 Avon, IN 46123 317-544-6000	STORM Plainfield DPW 986 S. Center Street Plainfield, IN 46168 317-839-3490	FIRE DEPARTMENT Plainfield Fire Territory 581 Moon Road Plainfield, IN 46168 317-839-6939

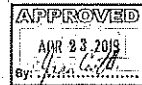

PLANS PREPARED BY:
BANNING ENGINEERING
 853 COLUMBIA ROAD, SUITE #101
 PLAINFIELD, IN 46168
 BUS: (317) 707-3700, FAX: (317) 707-3800
 E-MAIL: Banning@BanningEngineering.com
 WEB: www.BanningEngineering.com
 CONTACT: RYAN LINDLEY

CONSTRUCTION DOCUMENTS
 PROJECT MANAGER: Ryan Lindley DATE: 4-22-19
 THESE PLANS ARE NOT TO BE CONSIDERED FINAL OR TO BE UTILIZED FOR CONSTRUCTION UNLESS SIGNED AND DATED BY THE APPROPRIATE BANNING ENGINEERING PROJECT MANAGER.
 THESE PLANS ARE NOT INTENDED TO BE REPRESENTED AS A RETRACEMENT OR ORIGINAL BOUNDARY SURVEY, A ROUTE SURVEY, OR A SURVEYOR LOCATION REPORT.



CERTIFIED BY: *W. Chad Ziegler*

RECEIVED
 APR 22 2019
 BF&S Plainfield

SHEET NO	DESCRIPTION
C100	TITLE SHEET
C101	OVERALL PLAN
C102	EXISTING TOPOGRAPHY AND DEMO PLAN
C103 - C104	SITE LAYOUT PLAN
C110	OVERALL GRADING AND DRAINAGE PLAN
C111 - C112	GRADING AND DRAINAGE PLAN
C200	TRAFFIC MAINTENANCE PLAN
C300	UTILITY PLAN
C310 - C311	SANITARY SEWER PLAN AND PROFILE
C320 - C323	STORM SEWER PLAN AND PROFILES
C324	ROOF DRAIN PLAN
C400	INITIAL EROSION CONTROL
C401	FINAL EROSION CONTROL
C402	STORM SEWER POLLUTION PREVENTION PLAN
C500 - C501	MISCELLANEOUS DETAILS
L100 - L101	LANDSCAPE PLAN
1 - 25	TOWN OF PLAINFIELD DETAILS

REVISIONS		
NUMBER	DESCRIPTION	DATE
1	REVISED STORM SEWERS	06-12-19



Date: 04-22-19
 Project No: 18332
 Sheet No:
C100

DRG PLAINFIELD SPEC BUILDING

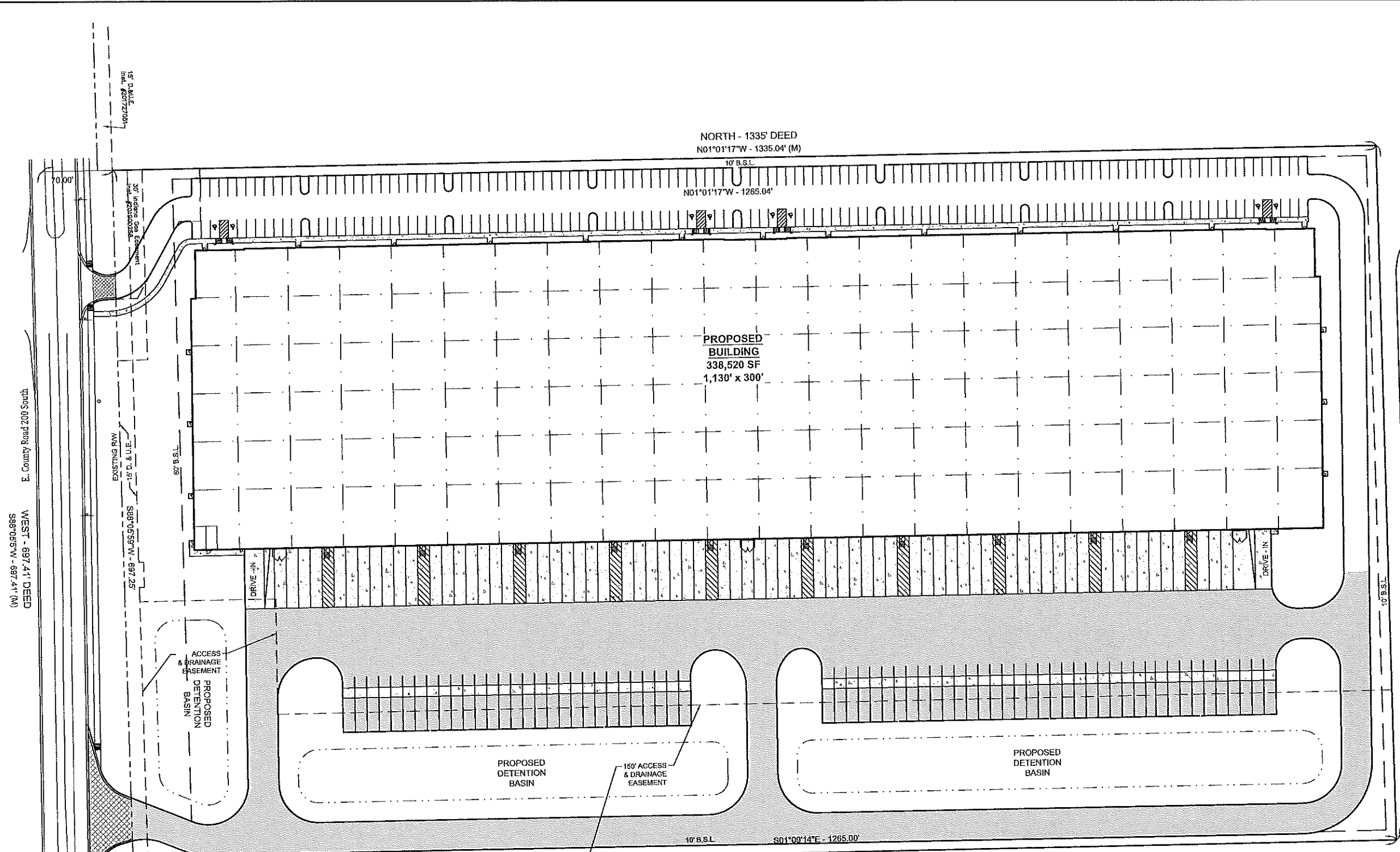
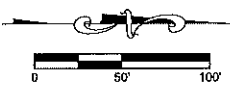

SOUTH - 1335.00' DEED
S01°09'14"E - 1335.00' (M)

LAND DESCRIPTION

Land Description (based on survey by American Structurepoint, Inc.)
Part of the Southeast Quarter of Section 18, Township 15 North, Range 2 East, In Hendricks County, Indiana, more particularly described as follows:
Commencing at the southwest corner of said quarter section; thence North 01 degrees 01 minutes 17 seconds West (assumed bearing) along the west line of said quarter section 70.01 feet to the northwest corner of the right of way land tract conveyed to the Town of Plainfield by Instrument number 201523769 as recorded in the Office of the Hendricks County Recorder, being the Point of Beginning; thence continue North 01 degrees 01 minutes 17 seconds West along the west line of said quarter section a distance of 1265.03 feet; thence North 88 degrees 05 minutes 59 seconds East parallel with the south line of said quarter section 694.32 feet; thence South 01 degrees 09 minutes 14 seconds East 1264.99 feet to the northeast corner of said Town of Plainfield right of way land tract; thence South 88 degrees 05 minutes 59 seconds West parallel with the south line of said quarter section and along the north line of said right of way land tract 697.25 feet to the Point of Beginning.
Containing 20.204 acres, more or less.

DEVELOPMENT SUMMARY

BUILDING
1,130 x 300 = 338,520 SF

PARKING REQUIRED
1 SPACE / 3000 SF
338,520 / 3000 = 113 SPACES

PARKING SHOWN
222 SPACES + 8 HIC = 230 SPACES

EAST - 694.3' DEED
N88°05'59"E - 694.32' (M)

E. County Road 200 South
WEST - 697.41' DEED
S88°05'59"W - 697.41' (M)

CONSULTING ENGINEERS
BANNER ENGINEERING
243 COLUMBIA ROAD, SUITE 101
P.O. BOX 101
P. 317.707.5200
SMITH/ROBERTS AND ASSOCIATES
STRUCTURAL
MECHANICAL
ELECTRICAL
PLUMBING
FIRE PROTECTION

CONTRACTOR
ARCO MURRAY
1817 PATTERSON ST. SUITE 201
NASHVILLE, TENNESSEE 37203
P: 615-368-1820
WWW.ARCOMURRAY.COM

ARCHITECT
GMA
800 NORTH ROCK HILL ROAD
ST. LOUIS, MISSOURI 63116
P: 314-822-5181 F: 314-890-8714
WWW.GMALARCHITECT.COM

NEW FACILITY FOR:
DRG
DISTRIBUTION REALTY GROUP
9500 EAST CR 200 S
PLAINFIELD, INDIANA

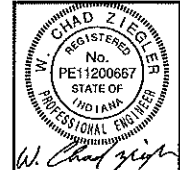

JOB NO: 18332
PA:
DATE: 04-22-2019

REVISIONS
STORM SEWERS
06-13-19

SHEET NUMBER
OVERALL
PLAN
C101

