



HSL WORLDWIDE
LIGHTING CORP.

FLAT PANEL LEDs



KEY:



cULus Listed



DLC Listed



DLC Premium Listed



FCC Certified



RoHS Compliant



0-10v Dimming



DALI Protocol Compatible



5-year Warranty

HSL Worldwide Lighting Corp. www.WorldwideLighting.net

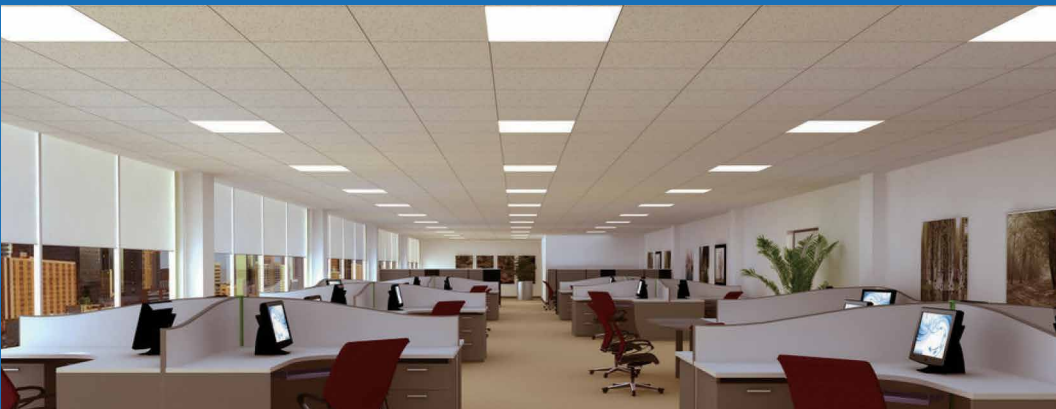

HSL Worldwide Lighting Corp.

Is thrilled to announce a range of Flat Panel LED (FPL) luminaires for Commercial, Hospitality, Institutional, and Residential applications.

FPLs are among the latest wave in Energy Efficient technologies. As the world shifts inevitably closer to clean energy and energy independence, our FPLs embody the best of LED technology. When coupled with networked protocols, these move LEDs squarely to the Internet of Things (IoT), enabling state-of-the-art, whole-building solutions in automation and extended efficiency. Whether new or remodel construction, interior illumination has come of age.

With this offering, Worldwide Lighting is pleased and proud to join the energy revolution.





FPL22

- 2x2' (603mm x 603mm) square.
- .4" (10mm) height (at panel). 1.8" (46mm) height (at detachable j-box).
- Quick and Easy Installation via Recessed (T-Bar), Surface or Suspension Mount Options.
- **Optional** 32W, at Efficient 130 LM/W. PF >0.95, THD <15% (DLC Premium)
- **Optional** 40W, at 110 LM/W. PF >0.95, THD <15%. (DLC listed)
- Available in 3500K, 4000K, 5000K CCT. CRI >80, std.
- Universal 100-277VAC capable.
- 0-10V Dimmable. (DALI available, for networked energy management solutions.)
- Edge-lit LEDs and an Optical Polycarbonate Diffuser system provide uniform, glare- and flicker-free illumination and a symmetrical, 120° beamspread.
- Clean & seamless, extruded aluminum frame in powdercoat Matte White, prevents light leakage.
- c-UL-us, DLC or DLC Premium listed.
- LM80 9000 Hrs.
- Life to 70% Lumen Maintenance (L70) 50,000 Hrs.
- Dry Rated (IP40), std. (Relative Humidity (RH) >80%). Water resistant (IP65) (not submersible) also available.
- 5-year Warranty.



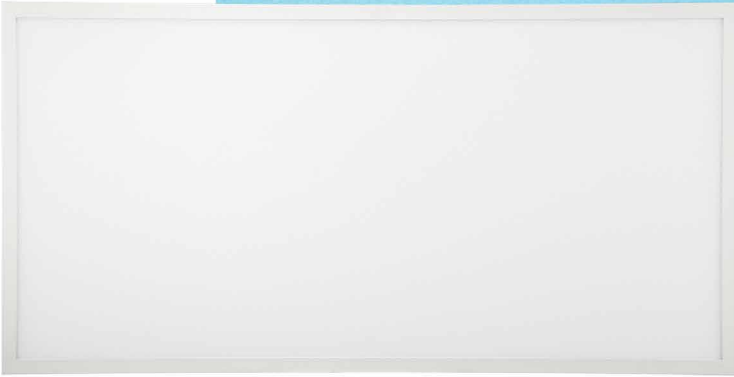

FPL24

- 2x4' (603mm x 1213mm) footprint.
- .4" (10mm) height (at panel). 1.8" (46mm) height (at detachable j-box).
- Quick and Easy Installation via Recessed (T-Bar) , Surface or Suspension Mount Options.
- **Optional** 50W, at Efficient 130 LM/W. PF >0.95, THD <15%. (DLC Premium)
- **Optional** 60W, at 110 LM/W. PF >0.95, THD <15%. (DLC listed)
- Available in 3500K, 4000K, 5000K CCT. CRI >80, std.
- Universal 100-277VAC capable.
- 0-10V Dimmable. (DALI available, for networked energy management solutions.)
- Edge-lit LEDs and an Optical Polycarbonate Diffuser system provide uniform, glare- and flicker-free illumination and a symmetrical, 120° beamspread.
- Clean & seamless, extruded aluminum frame in powdercoat Matte White, prevents light leakage.
- c-UL-us, DLC or DLC Premium listed.
- LM80 9000 Hrs.
- Life to 70% Lumen Maintenance (L70) 50,000 Hrs.
- Dry Rated (IP40), std. (Relative Humidity (RH) >80%). Water resistant (IP65) (not submersible) also available.
- 5-year Warranty



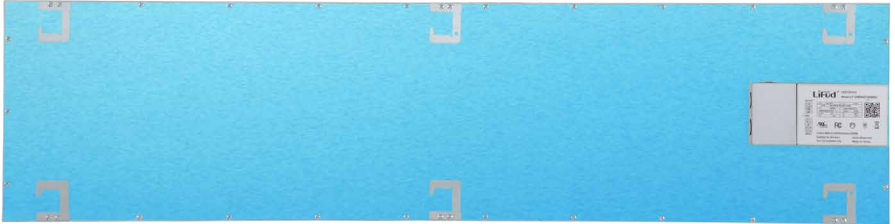

FPL14

- 1x4' (303mm x 1213mm) footprint.
- .4" (10mm) height (at panel). 1.8" (46mm) height (at detachable j-box).
- Quick and Easy Installation via Recessed (T-Bar) , Surface or Suspension Mount Options.
- **Optional** 32W, at Efficient 130 LM/W. PF >0.95, THD <15%. (DLC Premium)
- **Optional** 40W, at 110 LM/W. PF >0.95, THD <15%. (DLC listed)
- Available in 3500K, 4000K, 5000K CCT. CRI >80, std.
- Universal 100-277VAC capable.
- 0-10V Dimmable. (DALI available, for networked energy management solutions.)
- Edge-lit LEDs and an Optical Polycarbonate Diffuser system provide uniform, glare- and flicker-free illumination and a symmetrical, 120° beamspread.
- Clean & seamless, extruded aluminum frame in powdercoat Matte White, prevents light leakage.
- c-UL-us, DLC or DLC Premium listed.
- LM80 9000 Hrs.
- Life to 70% Lumen Maintenance (L70) 50,000 Hrs.
- Dry Rated (IP40), std. (Relative Humidity (RH) >80%). Water resistant (IP65) (not submersible) also available.
- 5-year Warranty.



Available Options

Emergency version

1.5 / 2 / 3 hours' Emergency time
30% or 50% Emergency power
Switch time <1s in Emergency lighting



DALI Protocol-configured version

DALI-capable, for an intelligent, networked energy management solution

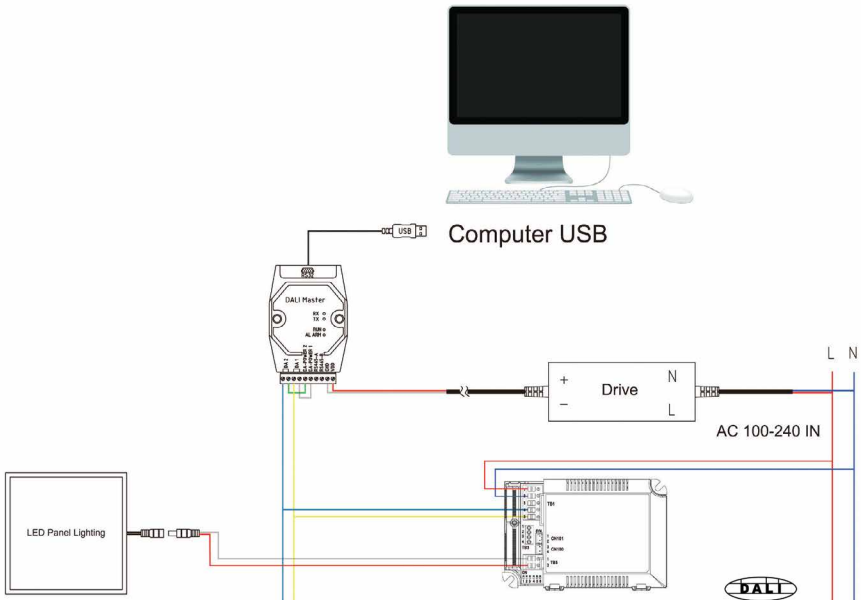

Fast & Simple Installation

Unlike other lighting solutions, Flat Panel LEDs can be quickly and easily installed in many environments, with three installation options.

Recessed

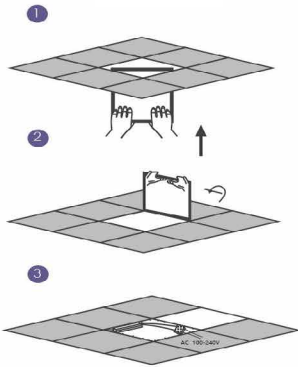

Suspended

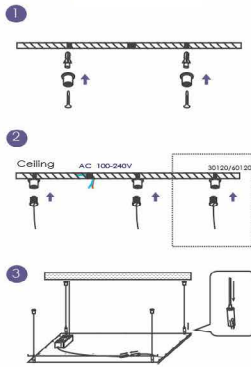

Ceiling Mounted

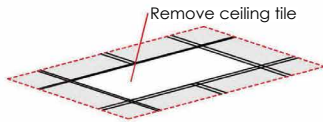
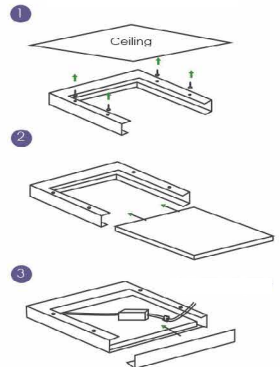

1. Remove ceiling tile and install / arrange main power supply.

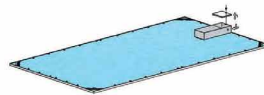

2. Remove cover & open side hole in detachable j-box.

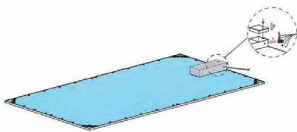

3. Insert power input wire and dimming wire into terminal via side hole, and replace power supply cover.



3. Install Flat Panel in ceiling.

Quick-connect Wiring

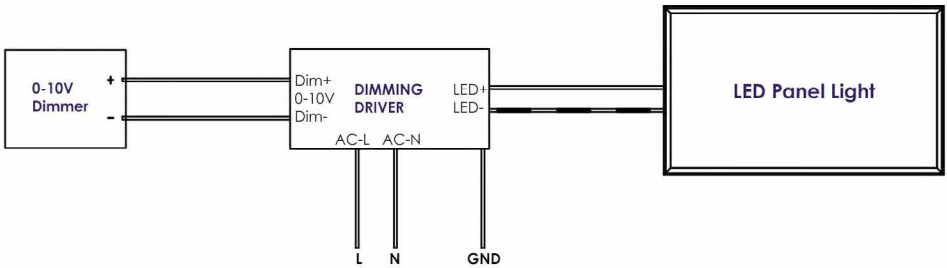
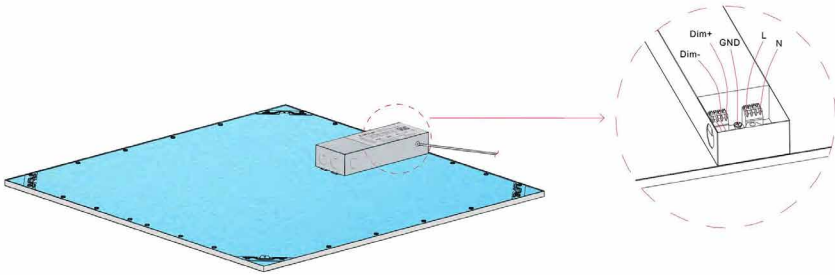

Available Mounting Accessories

2 x 2'	FPL22-FRAME-WH	FLUSH FRAME FOR FPL22
2 x 4'	FPL24-FRAME-WH	FLUSH FRAME FOR FPL24
1 x 4'	FPL14-FRAME-WH	FLUSH FRAME FOR FPL14
(universal)	FPL-SUS	SUSPENSION CABLE KIT

Notes: Frame height 2" (50mm)
 Suspension cable length (field cuttable) 39" (1m), std.

Standard Products

Size Model Number, Description & Specifications

130 Lumens per Watt (130LM/W)

- FPL22-835-32W-130LW-UNV-DIM1-WH**, 2x2' Flat Panel LED, 3500K CCT, 80 CRI, 32 watt 130LM/W, universal 100-277VAC, 0-10V dimming driver. Flat, Matte White frame.
- 2 x 2'** **FPL22-840-32W-130LW-UNV-DIM1-WH**, 2x2' Flat Panel LED, 4000K CCT, 80 CRI, 32 watt 130LM/W, universal 100-277VAC, 0-10V dimming driver. Flat, Matte White frame.
- FPL22-850-32W-130LW-UNV-DIM1-WH**, 2x2' Flat Panel LED, 5000K CCT, 80 CRI, 32 watt 130LM/W, universal 100-277VAC, 0-10V dimming driver. Flat, Matte White frame.
-
- FPL24-835-50W-130LW-UNV-DIM1-WH**, 2x4' Flat Panel LED, 3500K CCT, 80 CRI, 50 watt 130LM/W, universal 100-277VAC, 0-10V dimming driver. Flat, Matte White frame.
- 2 x 4'** **FPL24-840-50W-130LW-UNV-DIM1-WH**, 2x4' Flat Panel LED, 4000K CCT, 80 CRI, 50 watt 130LM/W, universal 100-277VAC, 0-10V dimming driver. Flat, Matte White frame.
- FPL24-850-50W-130LW-UNV-DIM1-WH**, 2x4' Flat Panel LED, 5000K CCT, 80 CRI, 50 watt 130LM/W, universal 100-277VAC, 0-10V dimming driver. Flat, Matte White frame.
-
- FPL14-835-32W-130LW-UNV-DIM1-WH**, 1x4' Flat Panel LED, 3500K CCT, 80 CRI, 32 watt 130LM/W, universal 100-277VAC, 0-10V dimming driver. Flat, Matte White frame.
- 1 x 4'** **FPL14-840-32W-130LW-UNV-DIM1-WH**, 1x4' Flat Panel LED, 4000K CCT, 80 CRI, 32 watt 130LM/W, universal 100-277VAC, 0-10V dimming driver. Flat, Matte White frame.
- FPL14-850-32W-130LW-UNV-DIM1-WH**, 1x4' Flat Panel LED, 5000K CCT, 80 CRI, 32 watt 130LM/W, universal 100-277VAC, 0-10V dimming driver. Flat, Matte White frame.

110 Lumens per Watt (110LM/W)

- FPL22-835-40W-110LW-UNV-DIM1-WH**, 2x2' Flat Panel LED, 3500K CCT, 80 CRI, 40 watt 110LM/W, universal 100-277VAC, 0-10V dimming driver. Flat, Matte White frame.
- 2 x 2'** **FPL22-840-40W-110LW-UNV-DIM1-WH**, 2x2' Flat Panel LED, 4000K CCT, 80 CRI, 40 watt 110LM/W, universal 100-277VAC, 0-10V dimming driver. Flat, Matte White frame.
- FPL22-850-40W-110LW-UNV-DIM1-WH**, 2x2' Flat Panel LED, 5000K CCT, 80 CRI, 40 watt 110LM/W, universal 100-277VAC, 0-10V dimming driver. Flat, Matte White frame.
-
- FPL24-835-60W-110LW-UNV-DIM1-WH**, 2x4' Flat Panel LED, 3500K CCT, 80 CRI, 60 watt 110LM/W, universal 100-277VAC, 0-10V dimming driver. Flat, Matte White frame.
- 2 x 4'** **FPL24-840-60W-110LW-UNV-DIM1-WH**, 2x4' Flat Panel LED, 4000K CCT, 80 CRI, 60 watt 110LM/W, universal 100-277VAC, 0-10V dimming driver. Flat, Matte White frame.
- FPL24-850-60W-110LW-UNV-DIM1-WH**, 2x4' Flat Panel LED, 5000K CCT, 80 CRI, 60 watt 110LM/W, universal 100-277VAC, 0-10V dimming driver. Flat, Matte White frame.
-
- FPL14-835-40W-110LW-UNV-DIM1-WH**, 1x4' Flat Panel LED, 3500K CCT, 80 CRI, 40 watt 110LM/W, universal 100-277VAC, 0-10V dimming driver. Flat, Matte White frame.
- 1 x 4'** **FPL14-840-40W-110LW-UNV-DIM1-WH**, 1x4' Flat Panel LED, 4000K CCT, 80 CRI, 40 watt 110LM/W, universal 100-277VAC, 0-10V dimming driver. Flat, Matte White frame.
- FPL14-850-40W-110LW-UNV-DIM1-WH**, 1x4' Flat Panel LED, 5000K CCT, 80 CRI, 40 watt 110LM/W, universal 100-277VAC, 0-10V dimming driver. Flat, Matte White frame.

Mounting Accessories

2 x 2'	FPL22-FRAME-WH	FLUSH FRAME FOR FPL22
2 x 4'	FPL24-FRAME-WH	FLUSH FRAME FOR FPL24
1 x 4'	FPL14-FRAME-WH	FLUSH FRAME FOR FPL14
(universal)	FPL-SUS	SUSPENSION CABLE KIT



Energy Rebate Info

Model Number	Description	DLC Premium Product ID	PG&E "QPL" Product ID	PG&E Rebate Classification
FPL22-835-32W-130LW-UNV-DIM1-WH	2x2' Flat Panel LED, >80 CRI @3500K CCT, 32w, 130LM/W	PT7K3ZCA	22AP3235A	Deemed LT150 (\$4.25 per Kilolumen) (\$17.68 per fixture)
FPL22-840-32W-130LW-UNV-DIM1-WH	2x2' Flat Panel LED, >80 CRI @4000K CCT, 32w, 130LM/W	P7EV735F	22AP3240A	Deemed LT150 (\$4.25 per Kilolumen) (\$17.85 per fixture)
FPL22-850-32W-130LW-UNV-DIM1-WH	2x2' Flat Panel LED, >80 CRI @5000K CCT, 32w, 130LM/W	PIC57NOB	24AP5035A	Deemed LT148 (\$4.25 per Kilolumen) (\$18.06 per fixture)
FPL24-835-50W-130LW-UNV-DIM1-WH	2x4' Flat Panel LED, >80 CRI @3500K CCT, 50w, 130LM/W	PT7K3ZCA	22AP3235A	Deemed LT150 (\$5 per Kilolumen) (\$22.50 per fixture)
FPL24-840-50W-130LW-UNV-DIM1-WH	2x4' Flat Panel LED, >80 CRI @4000K CCT, 50w, 130LM/W	PYBGFUJ9	24AP5040A	Deemed LT148 (\$5 per Kilolumen) (\$22.50 per fixture)
FPL24-850-50W-130LW-UNV-DIM1-WH	2x4' Flat Panel LED, >80 CRI @5000K CCT, 50w, 130LM/W	PRGZUH4D	24AP5050A	Deemed LT148 (\$5 per Kilolumen) (\$22.50 per fixture)
FPL14-835-32W-130LW-UNV-DIM1-WH	1x4' Flat Panel LED, >80 CRI @3500K CCT, 32w, 130LM/W	P8EFZOTR	14AP3235A	Deemed LT152 (\$5 per Kilolumen) (\$20.80 per fixture)
FPL14-840-32W-130LW-UNV-DIM1-WH	1x4' Flat Panel LED, >80 CRI @4000K CCT, 32w, 130LM/W	PUZ1MBP2	14AP3240A	Deemed LT152 (\$5 per Kilolumen) (\$21 per fixture)
FPL14-850-32W-130LW-UNV-DIM1-WH	1x4' Flat Panel LED, >80 CRI @5000K CCT, 32w, 130LM/W	PPPWD4VN	14AP3250A	Deemed LT152 (\$5 per Kilolumen) (\$21.25 per fixture)

Further information:

www.designlights.org/search

www.caioulightingqpl.com/?WT.mc_id=Vanity_Jedqpl



CORPORATE OFFICE

2304 Lincoln Ave.,
Hayward, CA 94545
T: 510.293.8999
F: 510.293.0999

www.WorldwideLighting.net