

OUTBUILDING
12 X 12

ENTRY LEVE*

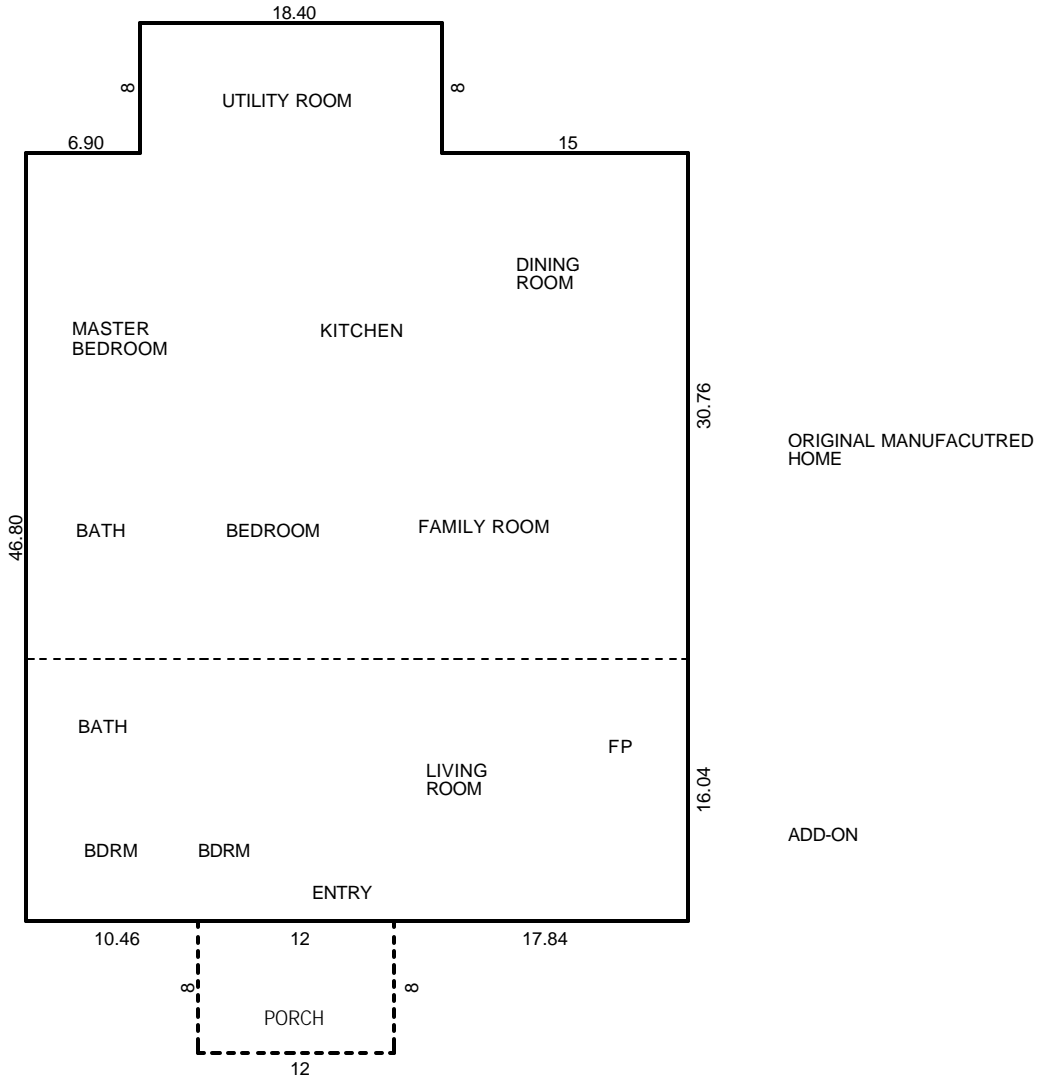

ENTRY LEVE*

6.90 x 46.80 = 322.92

18.40 x 54.80 = 1008.32

15 x 46.80 = 702

Subtotal* 2033.24 SF

PORCH

8 x 12 = 96 SF

Total* 2033.24 SF

* Total G.L.A. 2033.24 SF