



601 GENOME WAY LAB AND OFFICE FOR LEASE

Cummings Research Park Biotech Campus

YOUR BIOSCIENCE COMPANY DESTINATION

Next door to discovery - with space, talent & bandwidth to grow.

Locating on HudsonAlpha's campus offers life sciences companies of any stage or size:

- access to the cutting edge of biotechnology
- flexibility to grow and space for expansion
- superior shared amenities
- a support network to power your progress

Culture of Collaboration.

HudsonAlpha offers turnkey and build to suit laboratory and office space in an energizing environment that blends research, education, medicine and commercialization.

Unrivaled Inspiration & Business Advantages.

- shared spaces and centralized services
- labs built to NIH standards for biosafety, with single pass air and emergency power
- strategic support: investor forums, job postings, marketing resources, networking
- world-class human and plant sequencing and analysis services
- atrium/cafe, security and meeting spaces
- waste management and recycling, shipping/receiving
- LEED certified space and electric vehicle (EV) charging stations on campus
- on-site IT services with multiple, diverse path ISP up to 200G providing reliability, control, capacity and speed

[Schedule your site visit today!](#)

Carter Wells

Vice President for
Economic Development
cwells@hudsonalpha.org
256.327.5241

Amy Sturdivant

Director of Business Recruitment
asturdivant@hudsonalpha.org
256.327.9591





HUDSONALPHA

INSTITUTE FOR BIOTECHNOLOGY



Executive Lounge



Lab space for lease

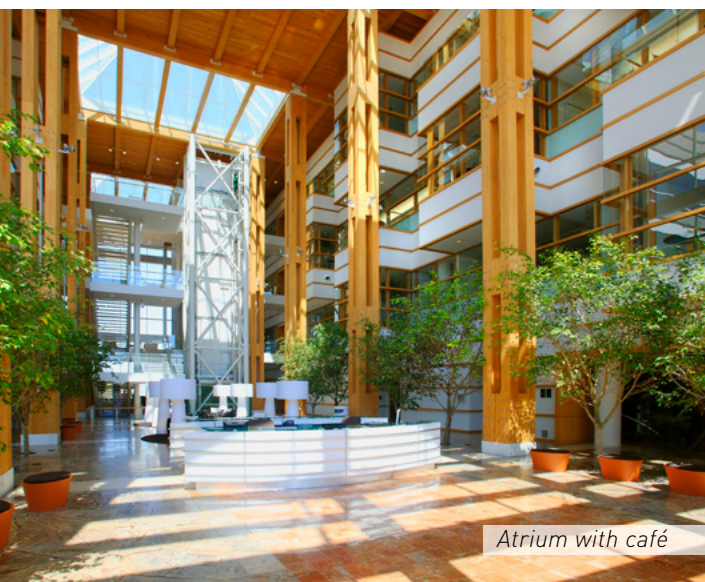

Atrium with café

HudsonAlpha Campus

601 Genome Way
Huntsville, AL 35806



BUILDING DETAILS

- 270,000 SF
- Opened 2008
- Cafe, Vending
- Auditorium, Classroom, Lounge, Library & other Shared Meeting Rooms

AVAILABLE SPACE

- Workstations for Lease (1st & 3rd Floors)
- Up to 10,000 SF contiguous (Fall 2018)
- Office 85-421 SF (3rd Floor)
- Lab 336 SF

CAMPUS HIGHLIGHTS

- In Cummings Research Park, 2nd largest in the U.S.
- Building 4 under construction (800 Hudson Way)
- Leading-edge intellectual talent
- Superior physical space
- Longest double helix pathway in the world
- Biosciences incentives and custom tax packages from the state
- Alabama is top 5 in workforce recruitment and training

PROPERTY INFORMATION

County: Madison

City Limits: Huntsville

Zoning: Cummings Research Park West



grow with us.