

Roller Shade Installation Instruction
(without top treatment)

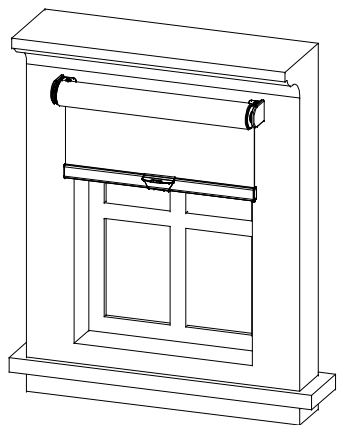

Single unit

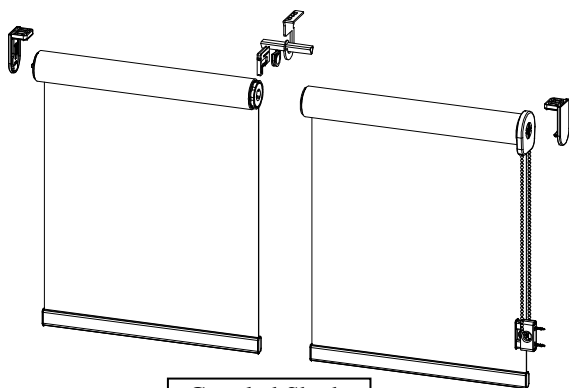

Coupled Shade

Recommended Tools

- Screw gun / Drill
- Tape Measure
- Screwdriver
- Level
- Pencil



Hardware Included

1、Screws needed for installing

Hardware	Drawing	Usage
1 1/4" Hexagon screw		To install bracket
2" Flat head screw		To install safety tension device
3/4" Round head screw		To install hold down bracket

2、Hardware for single unit Roller shade

Hardware	Drawing	Usage
Shade bracket		To install shade (on Clutch end/ Tension Dial end /Motor end)
Shade bracket		To install shade (on End Plug end)
Shade bracket cover		Shade bracket cover

Installation Template		Used for single unit to mark bracket installation position before installing bracket. * Not available for Inside-Side Mount
-----------------------	--	--

2、Hardware for Coupled Roller shade

Hardware	Drawing	Usage
6mm Extension		Used for Coupled Shade
Link bracket		
Link rod		
Link bearing		
Link adapter		
Installation Template		

3、Extra hardware depending on extra ordered

Hardware	Drawing	Usage
Spacer Block		Used for installing the bracket

Shade Bracket Installation

For Inside-Top Mount

Tear off double- side tape on Installation Template and stick the Installation Template to the desired position on top of the window. Use a pencil to mark the installation position of screw hole, and then remove the Installation Template, finally install bracket by aligning with the marked hole position. Each bracket needs two 1 1/4" hexagon screws for installing, the distance from the bracket's front mounting hole to the front edge of the window frame should be at least 3/4".Make sure both shade brackets line up with each other horizontally.

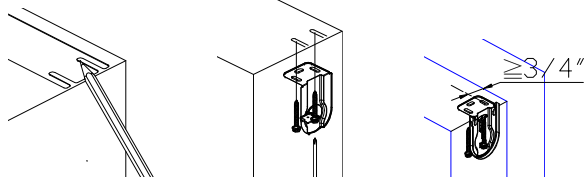

Inside-Top Mount

For Inside- Side Mount

Stick the brackets to the desired position on side of Window. The top & bottom & front & back of left & right brackets should be at the same horizontal line. Then install each bracket by using two 1 1/4" hexagon screws. the distance from the bracket's front mounting hole to the front edge of the window frame should be at least 3/4".Make sure both shade brackets line up with each other horizontally. The shade brackets covers bracket first, and then screw brackets into wall, brackets covers will be screwed with holes during your installing.

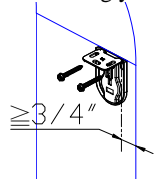

Inside-Side Mount

For Outside Mount

When installing the shade bracket, the top of each shade bracket needs to be parallel with the edge of the window frame. The distance from the shade bracket's mounting holes to the front edge of the window frame should be at least 3/4". Make sure all the shade brackets are level and aligned with each other. Each shade bracket will require two 1 1/4" hexagon screws for the installation.

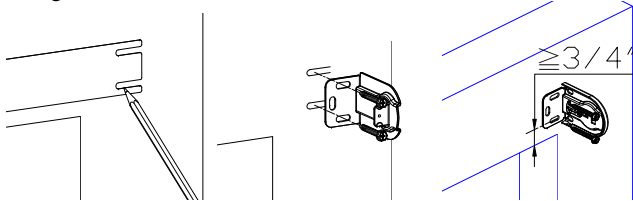

For Coupled Shade

Use Installation Template to mark the installation position of screw hole on the wall and then install bracket when installing the coupled shade link bracket, make sure that the center of both the link bracket and the shade bracket line up and are level with each other. For inside mount, make sure the link bracket's opening faces the front. For outside mount, the link bracket opening needs to face up. Each shade bracket will require two 1 1/4" hexagon screws for the installation. Coupled shades must be installed with a 6mm extension on each of the brackets both the left and the right.

Inside Mount

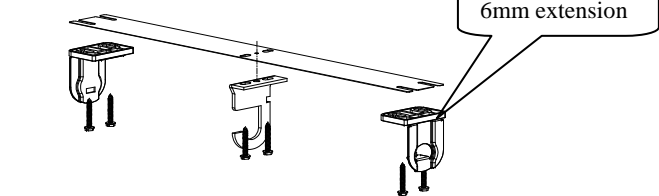

Outside Mount

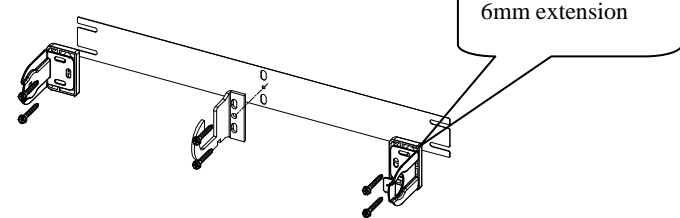

Shade Brackets Installation Tips

①The top & bottom of left & right shade brackets should be at the same horizontal line.

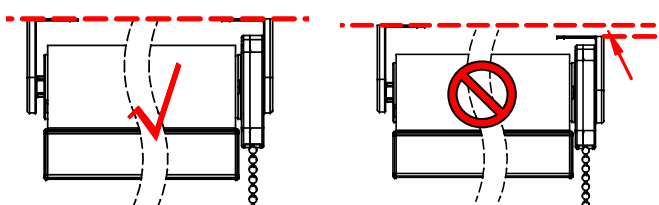

②The front & back of left & right shade brackets should be at the same horizontal line.

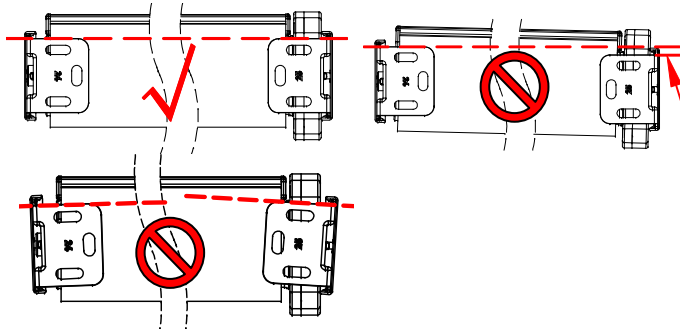

Shade Installation and Removal

※ Installation of Regular Roller Shade

- ① First, insert the Clutch end/Motor end/Tension Dial end into the tongue of clutch bracket
- ② Second, press the end plug and insert the End Plug end into the hole of bracket of the other side.
- ③ And then locate the pin, which can be found on the bracket cover, and use it to join the bracket pieces and the shade.

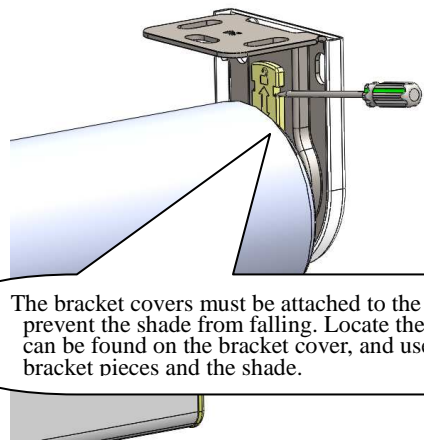
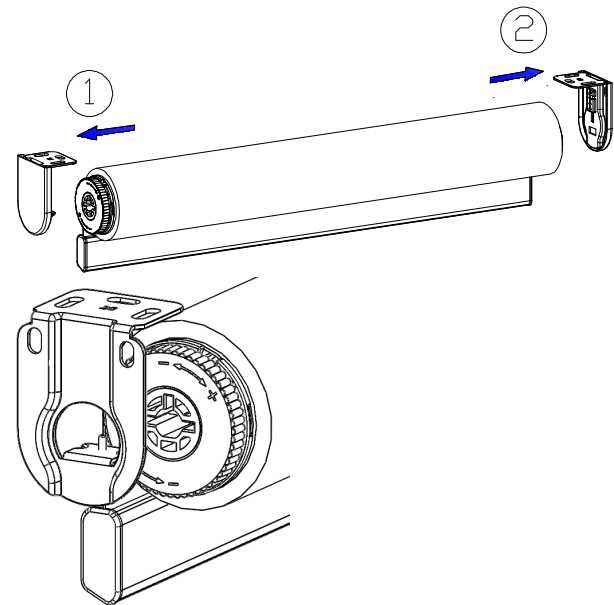

Shade Installation Tips: After shade is installed into shade brackets, use a Level to check if the tube of shade is horizontal; if not, please adjust the position of shade brackets to keep the tube level.

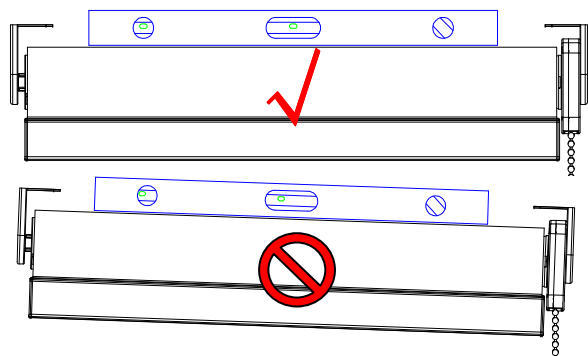

The tube of shade needs to be level.

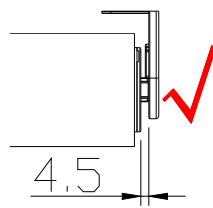

The gap on End Plug end needs to be about 4.5 mm.

✖ Removal of Regular Roller Shade

- ① First remove bracket cover from bracket on the End Plug end
- ② Then use a straight screwdriver to detach End Plug from bracket
- ③ Finally remove Clutch end from the bracket of the other side.

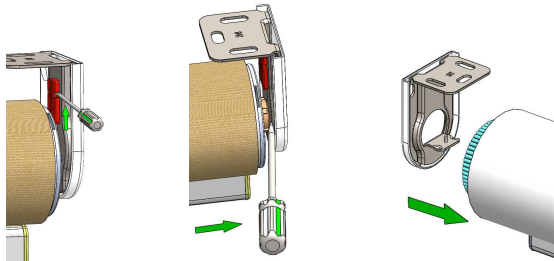

How to install or remove Handle for Cordless Shade

● Attach Handle to Hem Bar

- Turn over hem bar and you can see a label attached at the center of hem bar. Align the center of the bottom of handle with the label and hook the handle to the hem bar from top to bottom.
- Press the handle from top to bottom to make the top of handle clip into the hem bar.
- Finally tear off the label from hem bar.

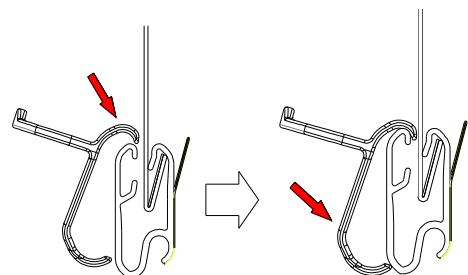
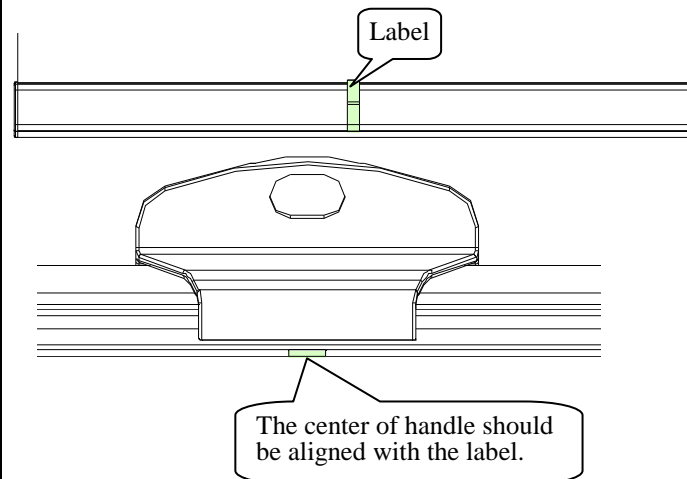

● Remove handle from hem bar

Use straight screwdriver to pry the bottom of Handle from hem bar and then handle can be removed.

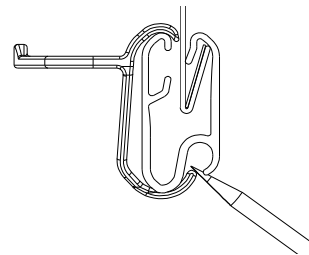

Install Safety Tension Device

Use two 2" flat screws to install the safety device

The chain should be fully extended upon installation of the device

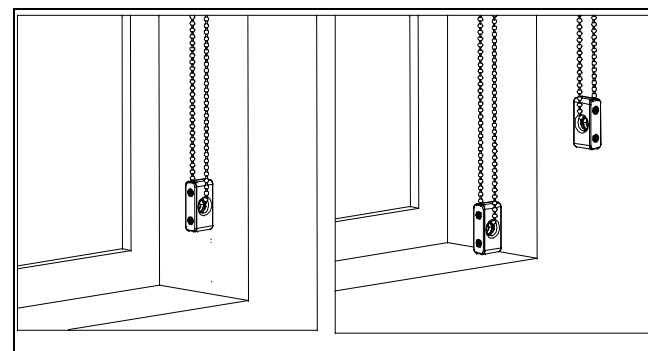

Roller Shade Operation

Continuous Cord Loop & Operation

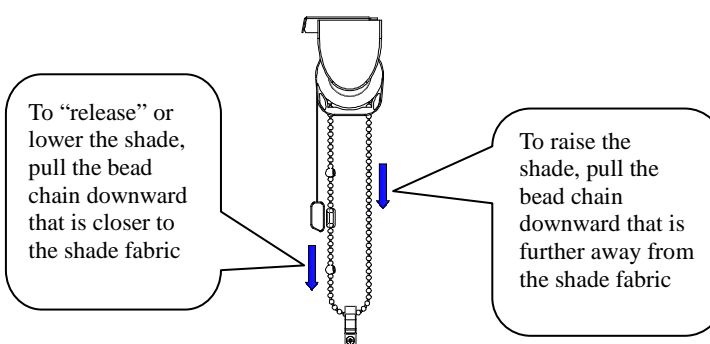

Cordless Operation

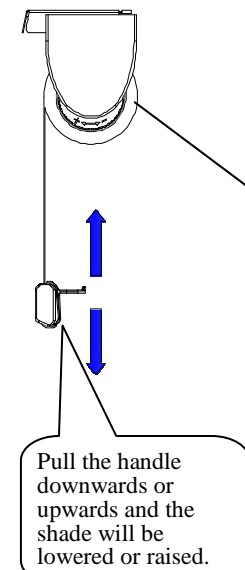

The tension in our cordless roller shades can be adjusted to provide optimal light control and to ensure easy and dependable operation on a variety of window types and sizes. If a cordless shade has been tending to slide down on its own or it fails to roll up, the issue can be easily fixed by turning the adjustment dial towards "+" to increase the tension. Conversely, if the cordless shade cannot stop at the desired height and tends to roll up by itself, the tension can be decreased by turning the adjustment dial towards the "-".

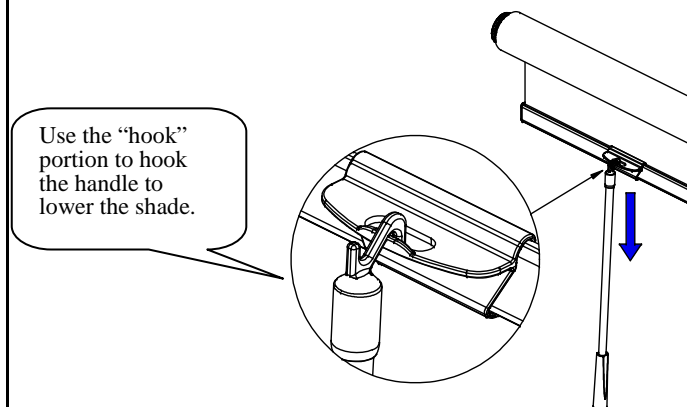
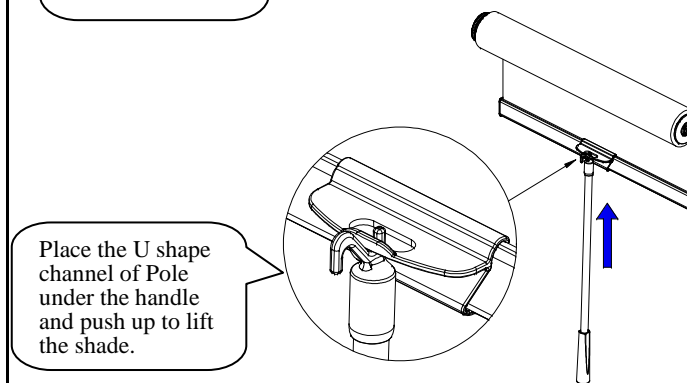
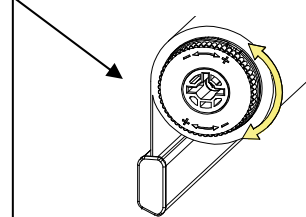

Motorized Operation

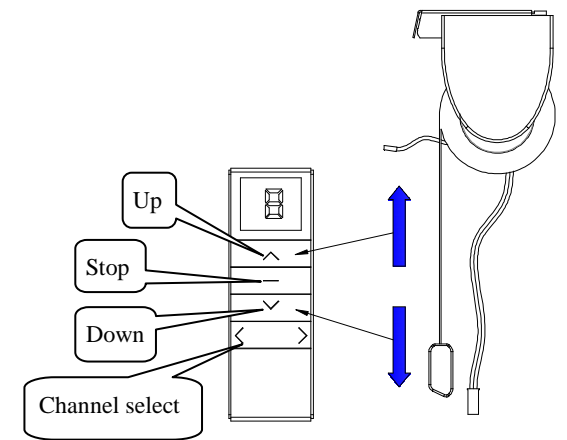

Roller Shade Installation Instruction
With Top Treatment

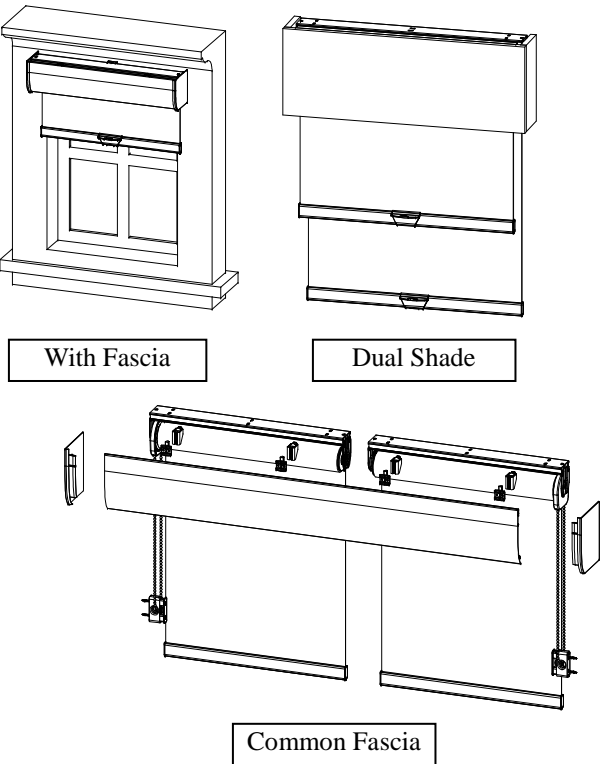

Recommended Tools

- Screw gun / Drill
- Tape Measure
- Screwdriver
- Level
- Pencil



Hardware Included

1、Screws needed for installing

Hardware	Drawing	Usage
1 1/4" Hexagon screw		To install bracket
2" Flat head screw		To install safety tension device
3/4" Round head screw		To install hold down bracket

2、Hardware for Roller shade with top treatment

Hardware	Drawing	Usage
Shade bracket		To install shade (on Clutch end/ Tension Dial end /Motor end)
Shade bracket		To install shade (on End Plug end)
Shade bracket cover		Shade bracket cover
6mm Extension		Used for Coupled Shade

3、Hardware for Roller shade with Raceway System

Hardware	Drawing	Usage
Mounting bracket		To install Raceway (for outside mount middle of raceway when raceway length is over 40")
		To install Raceway (for outside mount)
Valance bracket		To install Fascia / Valance (mounted on raceway)
Valance clip		To install Fascia / Valance (placed on Fascia/Valance)
Square Fascia end cap		For Square Fascia
Curved Fascia end cap		For Curved Fascia
Valance return connector		To connect fabric valance returns
Valance return connector		To connect wood valance returns
Handle		For Cordless Shades

Mounting Bracket Installation

When installing the mounting bracket, the distance from the bracket's screw hole near the edge of the window frame to the edge of the window frame should be at least 3/4".

Inside mount

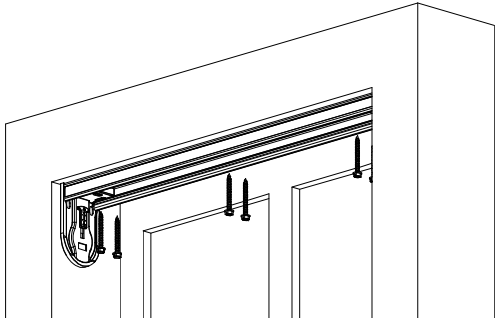

Outside mount

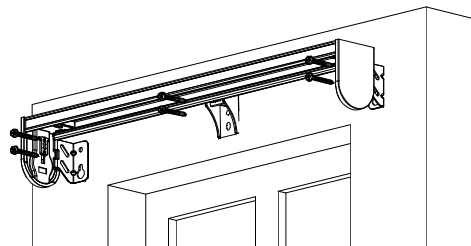

The space between each mounting bracket should be divided evenly as pictured.

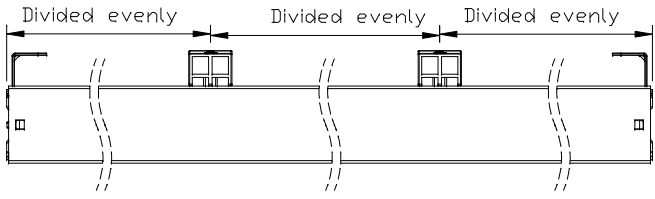

Shade Installation and Removal

※Installation of Roller Shade with Raceway System(Inside Mount)

Attach the shade brackets and extensions into the two ends of the raceway. Make sure the extension bolt locks into the raceway's dedicated hole. Install the shade and raceway system into the window opening. Taking care that the distance between the 1st screw and the window edge is at least 3/4".

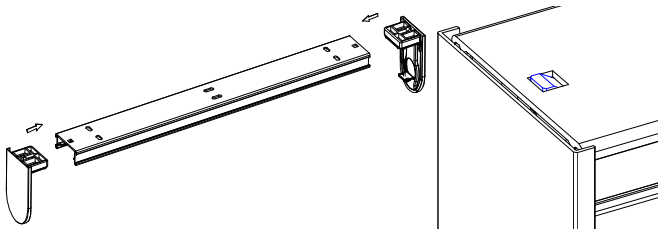

※Installation of Roller Shade with Raceway System(Outside Mount)

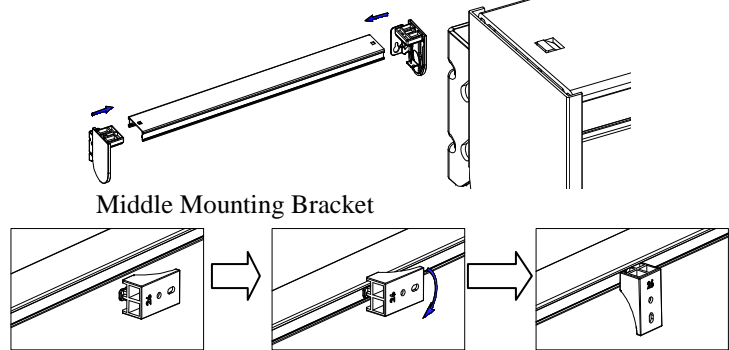

※Removal of Roller Shade with Raceway System

- Use a tool to push the lock pin on end plug bracket upward①
- Use tool to draw back the end plug from bracket②
- Finally remove shade from mounting bracket. As shown drawing③

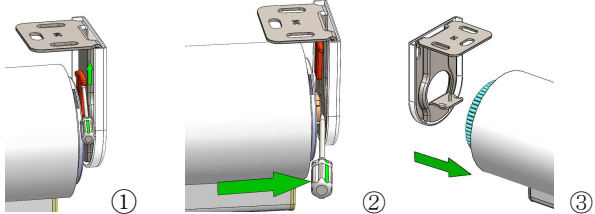

Fascia & Valance Installation

Valance Bracket Installation

After installing the shade and raceway, the brackets for the valance or fascia come next. When installing the valance brackets, the mounting brackets must be avoided. Align the valance bracket with the raceway first and then push the bracket onto the raceway. The top groove of the valance bracket should hook onto the top of the raceway while the bracket's bottom groove clips into the bottom rib of the raceway, as

shown below.

The drawing below shows the valance brackets installed in an ideal position. They are placed far enough apart so that the space is divided evenly, and without interference from the mounting brackets. If the mounting bracket's location conflicts with that of the valance bracket, the valance bracket location should have an offset of 50mm to avoid interference.

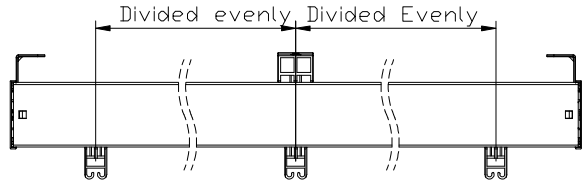

Valance Clip Installation

Insert the valance clip into the dedicated groove on the aluminum strip, paying special attention to the direction the valance clip. For a valance, the valance clip should face downwards. For valance, it should face up. The valance clip location should align with the valance bracket as pictured below.

Valance Bracket on Raceway:

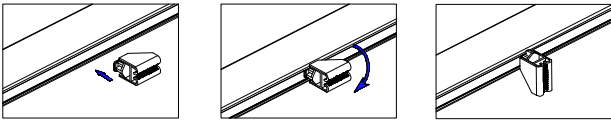

For Fascia:

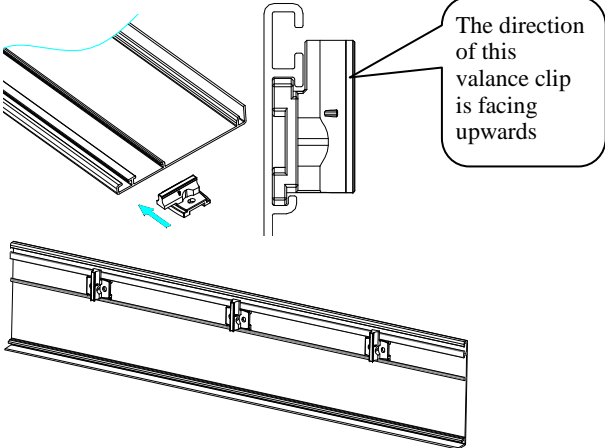

Attach Fascia End Cap to Fascia

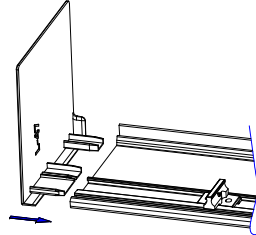

Attach Valance/Fascia to Raceway

Slide the valance clips to a position on the valance/fascia so that they are each aligned with a valance bracket on the raceway, and then push the valance clips into the valance bracket.

For Fascia:

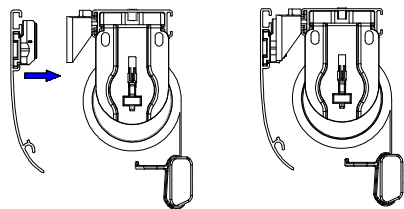

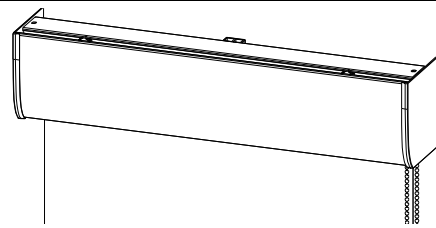

Fascia Removal

- First, remove Valance/Fascia together with valance clip from valance bracket.

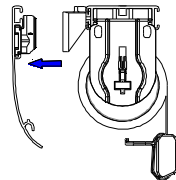

- Take down shade from mounting bracket before removing valance Bracket from raceway
Turn the valance bracket 90 degree then take off valance bracket from raceway, as shown below

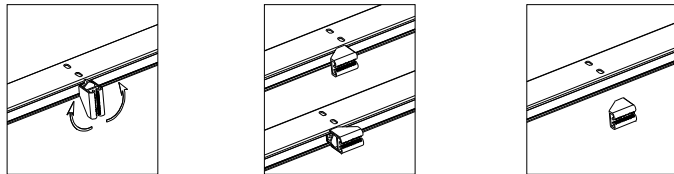

Note: The installation & removal for all fascias & valances are the same.

Dual Shade Installation

Installation of the mounting brackets & raceway is the same for dual shades as it is for single shades Please install the back shade before install the front shade. Installation of the valance clips is also very similar. Please refer to the previous sections for single shades for more info. Please pay attention to distinguish the left and right shade bracket, refer the below instructions.

IM Dual Shade

Left shade bracket with lug at bottom

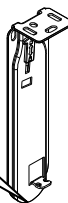

Right shade bracket with lug at top



OM Dual Shade

Left shade bracket with lug at bottom

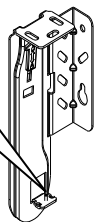

Right shade bracket with lug at top

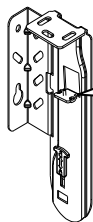

7.6mm extension

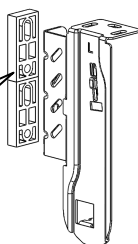

When the fabric roll diameter is larger than 64mm, shade brackets will need to be installed with 7.6mm extensions, two for each shade bracket.

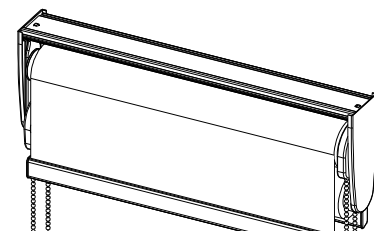

After shade has been installed well ,use valance bracket and valance clip to install the valance into the raceway.

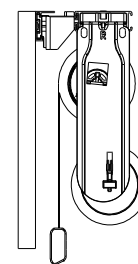
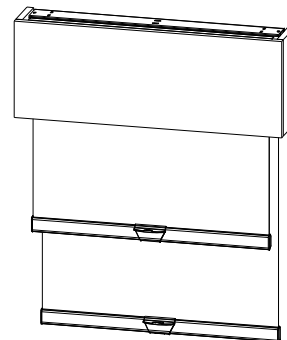
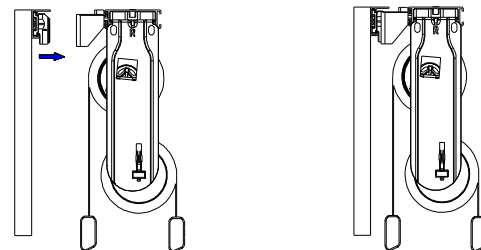

The Hem Bar of both front & back shades should be at the same height.

How to install or remove Handle for Cordless Shade

● Attach Handle to Hem Bar

- Turn over hem bar and you can see a label attached at the center of hem bar. Align the center of the bottom of handle with the label and hook the handle to the hem bar from top to bottom.
- Press the handle from top to bottom to make the top of handle clip into the hem bar.
- Finally tear off the label from hem bar.

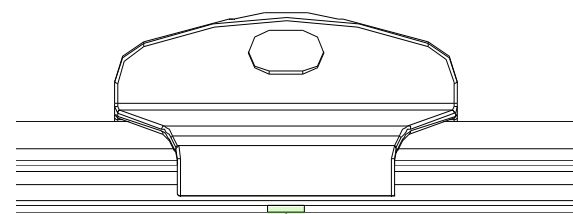
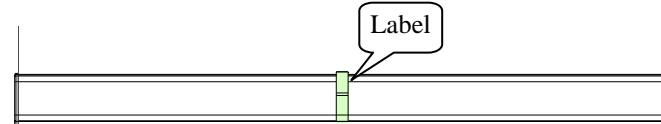

The center of handle should be aligned with the label.

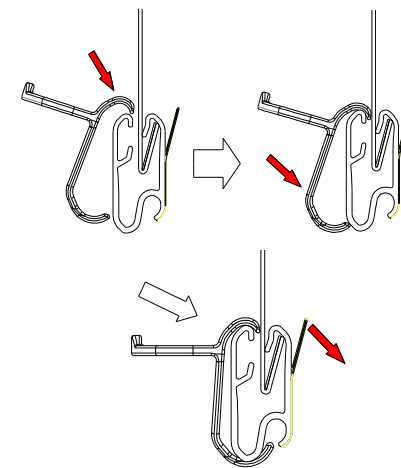

● Remove handle from hem bar

Use straight screwdriver to pry the bottom of Handle from hem bar and then handle can be removed.

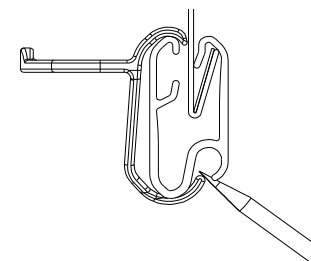

Install Safety Tension Device

Use two 2" flat screws to install the safety device

The chain should be fully extended upon installation of the device

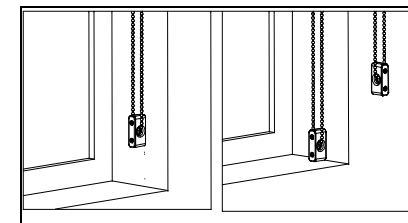

Roller Shade Operation

Cordless Operation

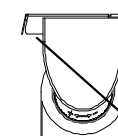

Pull the handle downwards or upwards and the shade will be lowered or raised.

The tension in our cordless roller shades can be adjusted to provide optimal light control and to ensure easy and dependable operation on a variety of window types and sizes. If a cordless shade has been tending to slide down on its own or it fails to roll up, the issue can be easily fixed by turning the adjustment dial towards "+" to increase the tension. Conversely, if the cordless shade cannot stop at the desired height and tends to roll up by itself, the tension can be decreased by turning the adjustment dial towards the "-".

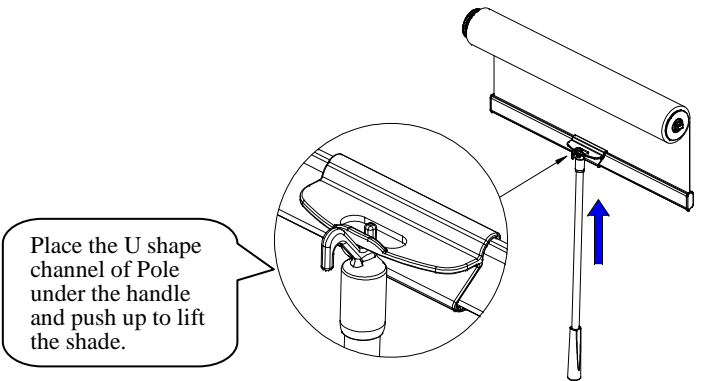
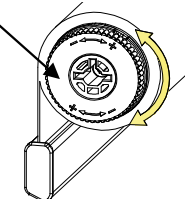

Place the U shape channel of Pole under the handle and push up to lift the shade.

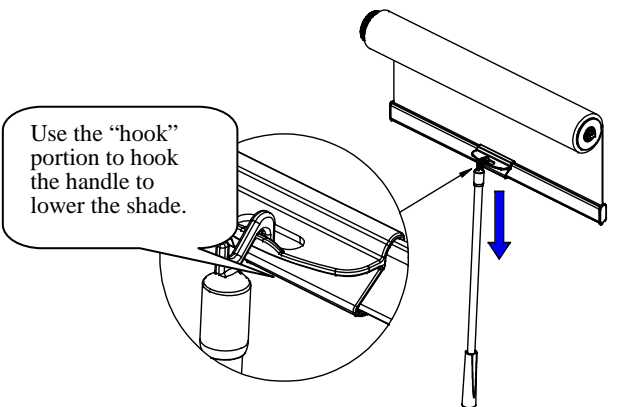

Use the "hook" portion to hook the handle to lower the shade.

Continuous Cord Loop & Operation

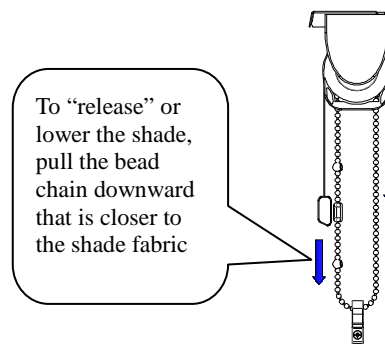

To "release" or lower the shade, pull the bead chain downward that is closer to the shade fabric

To raise the shade, pull the bead chain downward that is further away from the shade fabric

Motorized Operation

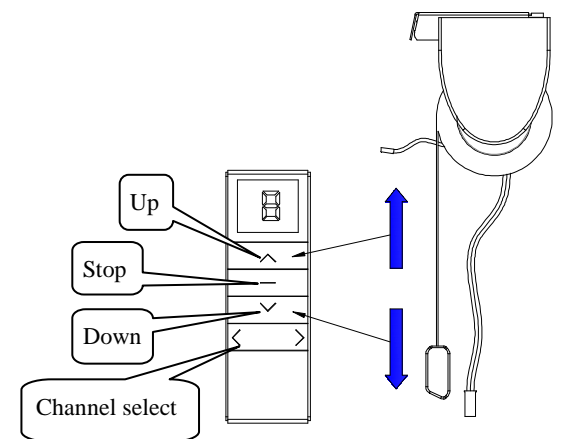

Operating channel number has been pre-programmed in factory based on customer's order request.

When operating the motorized shade, the motor inside the tube will have a little thrilling.