

SECTION 5 DISASSEMBLY AND ASSEMBLY

Inspect the Service Station

The Service Station (*located directly under the Printhead Assembly*) cleans Printhead Cartridge of excess ink and debris, keeps Printhead hydrated and protected when not in use, captures and removes ink used to keep nozzles clear. It moves out of the way of the Printhead during printing. It is designed to provide a long service life.

To access the Service Station for inspection and cleaning:

1. Using the **Touchscreen**, select “**Menu**,” then tap “**Maintenance**” from the drop-down menu. Tap “**Inspect Sled**”. The Service Station [A] moves out from under the Printhead Assembly.
2. Open the Top Cover.
3. Visually inspect the Service Station for cleaning or service. Use a dry, lint-free cloth to soak up any excess ink from the Cap Station [B].
4. Tap “**End Inspection**” on the Touchscreen to move the Service Station back under the Printhead Assembly.
5. Close the Top Cover.

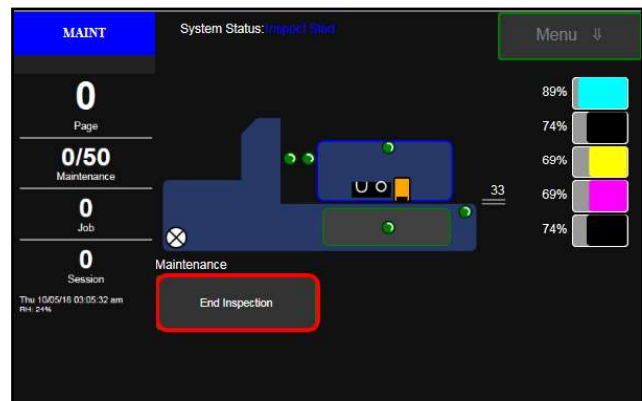
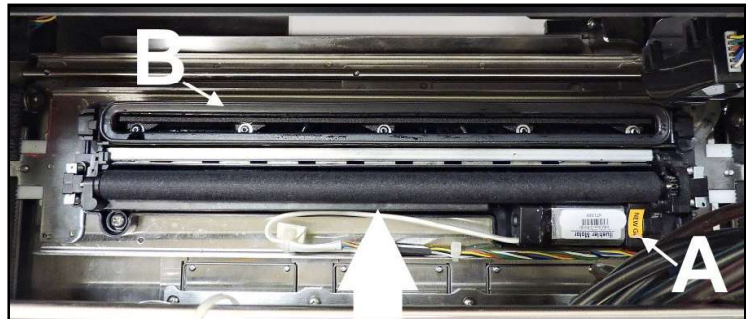
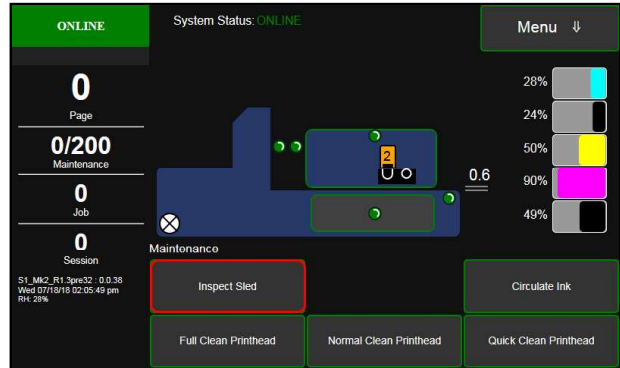

Service Station Components

1. Capping Station
2. Wiper Roller Assembly
3. Wiper Motor Assembly
4. Operator Side Bracket
5. Non-Operator Side Bracket
6. Service Station Base
7. Capping Station Inserts (2)
8. Wiper Roller Assembly Springs (4)

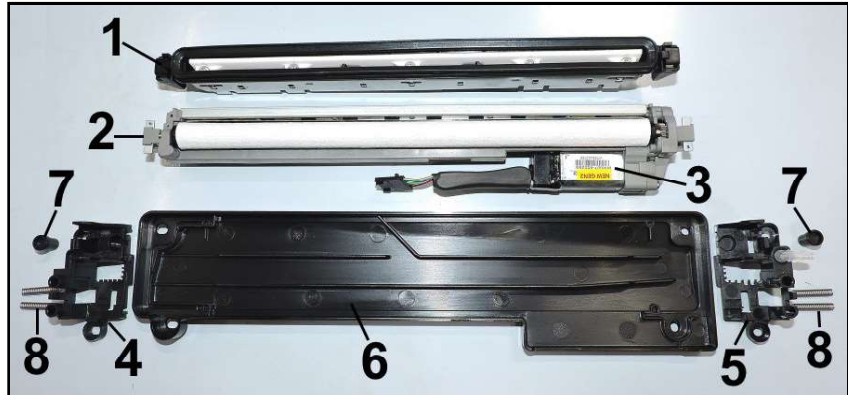

Remove Capping Station

1. Using the **Touchscreen**, select “**Menu**,” and tap “**Maintenance**” from the drop-down menu. Tap “**Inspect Sled**”. The Service Station moves out from under the Printhead Assembly.
2. Open the Top Cover.
3. Gently release the tabs [A] (one located at each end) securing the Assembly to the Service Station Base.
4. Lift the Capping Station [B] out of the Printer. **NOTE: Be careful, watch for dripping ink. Do not lose the (2) inserts the Capping Station rests on (located behind the release tabs).**
5. Install in reverse order.



SECTION 5 DISASSEMBLY AND ASSEMBLY

Remove Wiper Roller

1. Using the **Touchscreen**, select “**Menu,**” and tap “**Maintenance**” from the drop-down menu. Tap “**Inspect Sled**”. The Service Station moves out from under the Printhead Assembly.
2. Open the Top Cover.
3. Release the Roller by pushing the non-gear end toward the Capping Station [A]. This will unsnap it out of the bracket. Then lift the Wiper Roller out of the Wiper Roller Assembly.
4. **Install in reverse order. Be sure to insert the gear end of the Roller first and check that the gear teeth mesh with the other gears.**

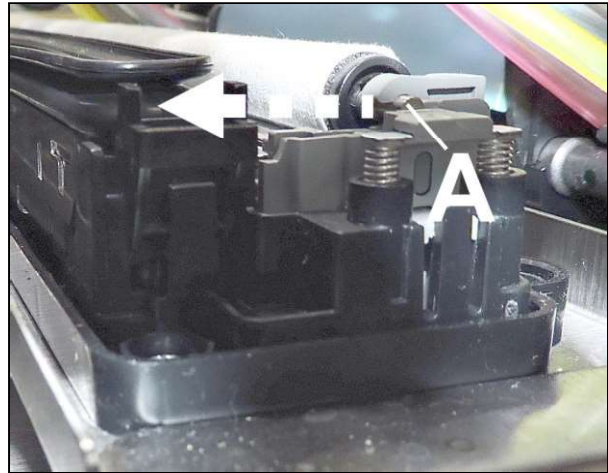

Remove Wiper Roller Assembly

1. Using the **Touchscreen**, select “**Menu,**” and tap “**Maintenance**” from the drop-down menu. Tap “**Inspect Sled**”. The Service moves out from under the Printhead Assembly.
2. Open the Top Cover.
3. Disconnect the Wiper Motor wire harness at the connector [A].
4. Gently release the tabs [B] securing the Assembly to the Service Station Base.
5. Lift the Wiper Roller Assembly out of the Printer. **NOTE: Be careful not to lose the springs [C] located under the Assembly. (2 at each end of the Assembly.)**
6. **Install in reverse order.**
Run **System Test** to check operation.
System Test: Press Wiper Test.

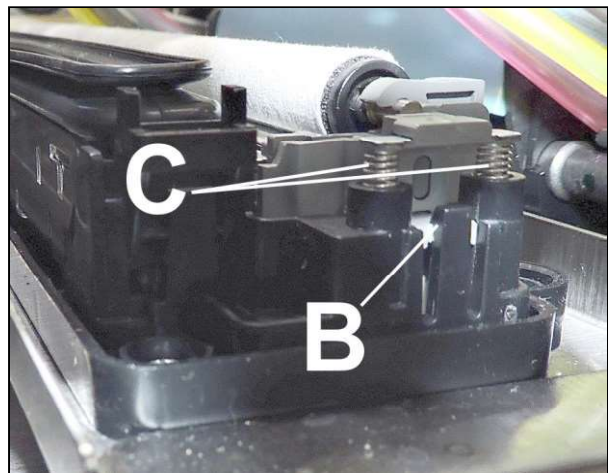
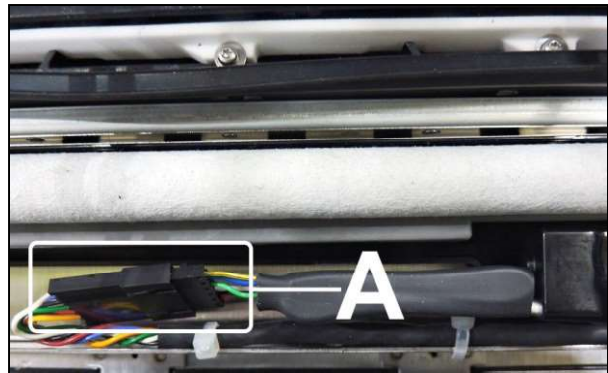

Remove Service Station Base Plate

1. Using the **Touchscreen**, select “**Menu,**” and tap “**Maintenance**” from the drop-down menu. Tap “**Inspect Sled**”. The Service Station moves out from under the Printhead Assembly.
2. Open the Top Cover.
3. Disconnect Ink Waste hose from the hose barb [A].
4. Disconnect the Wiper Motor wire harness at the connector [B].
5. Remove (4) screws [C] securing the Service Station Base to the **Service Station Sled**
6. Lift the Service Station Assembly and Base out of the Printer. **Be careful, watch for dripping ink.**
NOTE: Capping Station – Do not lose the (2) inserts the Capping Station rests on (located behind the release tabs).
NOTE: Wiper Roller Assembly – Be careful not to lose the springs located under the Assembly. (2 at each end of the Assembly.)
7. Install in reverse order.

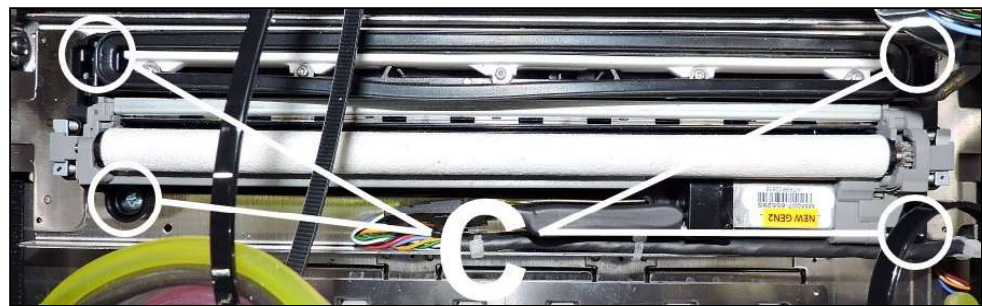
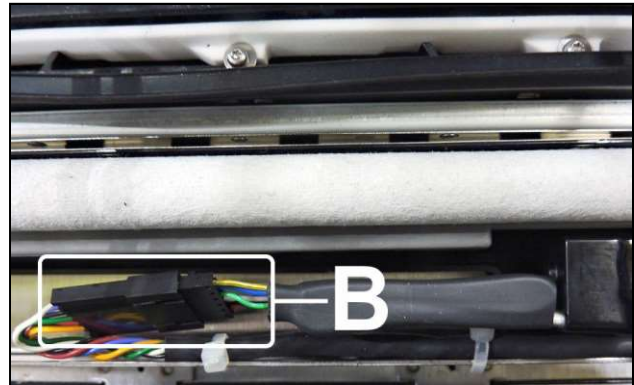

SECTION 5 DISASSEMBLY AND ASSEMBLY

Remove Service Station Sled

NOTE: This procedure requires two people.

1. Remove the Top Assembly Rear Cover.
2. Disconnect the Ink Hose from the hose barb [A].
3. Disconnect the Wiper Motor wire harness at the connector [B]. Cut the (4) wire ties securing the wire harness to the Service Station Sled [C].
4. Remove (4) screws securing the Service Station Base to the Sled [D]. Remove the Service Station Assembly.
5. Position the Service Station Sled under the Printhead Assembly.
6. **Operator Side:** Remove (2) screws securing the Support Strut Bracket [E] to the Clamshell Frame.
7. **Remove Top Assembly.** Remove (4) screws securing the two Top Assembly hinges to the Printer [F] (2 screws per hinge).
8. Release the Top Assembly Latch.
9. **Carefully lift the Top Assembly off of the Printer. DO NOT pull or strain ink hoses or wire harnesses. NOTE: You may have to detach the ink hoses from the hose loom, note the order for reassembly. Put clean, dry rags on the Printer to protect against damage and gently rest the Top Assembly back on the Printer.**
10. **Carefully lift the Top Assembly so you can access and remove the Service Station Slides (1 screw per side) [G] through the Printhead opening in the underside of the Top Assembly.** Try to keep the Assembly level to prevent any ink spills. You may have to have the other person hold the Top Assembly to do this.
11. Slide the Service Station Sled out from under the Printhead Assembly and lift it out of the Printer.
12. **Install in reverse order. NOTE: Grooves on the Slides face out toward the Operator and Non-Operator Sides. The lower groove in the Slides fit around the flange edge of the Top Assembly Base Plate (Media Guide). The upper side of the Belt is held between the groove in the top of the Slides and the mounting ends of the Service Station Sled.**

IMPORTANT: Make sure the Service Station is installed parallel to the Printhead Locator Assembly. Check this by lowering Printhead Locator Assembly to its lowest point and pushing the Service Station Assembly up against it [see arrows]. They should meet flush with no gaps at either end.

