

Parts List

Large Components B Series

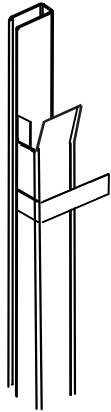

1 Pair 50mm "B" Series Guide



1 x Roller Door Accessory Box



1 x Assembled Roller Door

Additional Components

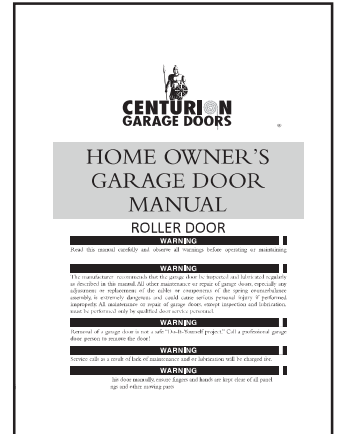

1x Roller Door Manual

Core Components B Series

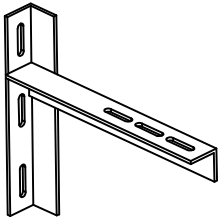

1 Pair "B" Roller Door Bracket
CEN105/106

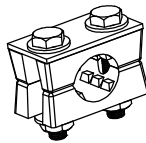

2x Cast Iron Saddle
RP001



1x Planetary Gear set
RDACCB4251P

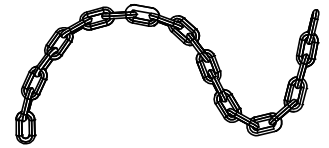

1x Hand Chain

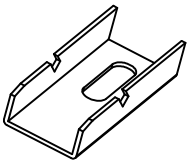

6x AA Series Guide Clips
RGC08401



1x Anti-Coning Clip

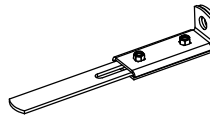

2x Shoot Bolt Lock

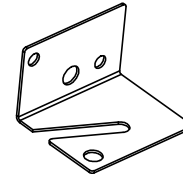

1x Roller Door Chain Lock

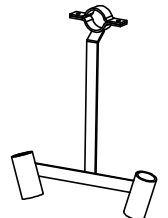

1x Chain Guide

*Planetary Gearing and hand chain only supplied if no motor is being installed

*Shoot bolts only supplied with planetary gearing kit

Fasteners B Series

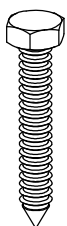

M8 - 70mm Hex Screw
12x

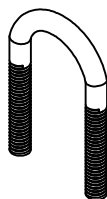

3/8 - Colour Zinc U Bolt
2x



8.2mm ID - Washer
16x



3/8 - Washer
4x

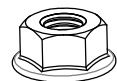

3/8 - Hex Flange Nut
4x