

Defined Careers Foundational Content

Overview

The default Pathways Matching Assessment and default career courses within Defined Careers are written at an 8th grade reading level. For the students who may need content written at a 5th grade level, the foundational assessment and career courses may be more appropriate. The content can be assigned either to an entire class or to individual students.

What is the foundational content within Defined Careers?

There are 2 components of Defined Careers that have the foundational option: the **Pathways Matching Assessment** and the **career courses**. When the foundational setting is turned on for a student or class, both the Pathways Matching Assessment and career courses are set to the foundational content. When the foundational setting is turned off for a student or class, both the Pathways Matching Assessment and career courses are set to the default content.

How does the foundational content compare to the default content?

	Similarities	Differences														
Assessment and Results	<ul style="list-style-type: none">• Triangulates results based on a student's assessed study preferences, interests, and values• On-demand• Untimed• Recommends 4 career pathways	<ul style="list-style-type: none">• Written at a 5th grade reading level• Shorter in length:<ul style="list-style-type: none">◦ Study Preferences component is 5 categories instead of 7◦ Interest Inventory component includes 36 activities with visuals instead of 60 with no visuals◦ Values Inventory component includes 15 work values comparisons instead of 30• Interest Inventory results are presented using different Holland code terminology <table><tr><th>Foundational</th><th>Default</th></tr><tr><td>Builder</td><td>Realistic</td></tr><tr><td>Thinker</td><td>Investigative</td></tr><tr><td>Creator</td><td>Artistic</td></tr><tr><td>Helper</td><td>Social</td></tr><tr><td>Persuader</td><td>Enterprising</td></tr><tr><td>Organizer</td><td>Conventional</td></tr></table> <ul style="list-style-type: none">• Each recommended career pathway has only 1 career course in which the student can enroll as opposed to 5+ career courses	Foundational	Default	Builder	Realistic	Thinker	Investigative	Creator	Artistic	Helper	Social	Persuader	Enterprising	Organizer	Conventional
Foundational	Default															
Builder	Realistic															
Thinker	Investigative															
Creator	Artistic															
Helper	Social															
Persuader	Enterprising															
Organizer	Conventional															
Career Courses	<ul style="list-style-type: none">• Same 5-lesson structure	<ul style="list-style-type: none">• Lessons written at a 5th grade reading level														

How can educators distinguish between foundational and default career courses?

Educators will see the yellow building blocks icon, , in the upper right corner of any foundational career course. Educators can also use the filter in the “Courses” tab from the navigation menu to filter all the foundational courses. It’s important to note that students **DO NOT** see the foundational icon anywhere on their side of the Defined Careers platform.

How do I manage settings to provide access to foundational content for my students?

Educators can manage foundational settings at 2 different levels: class settings and student settings. When a setting is changed for a class or student, it changes both the assessment and the career courses the class or student is able to access.

To change foundational settings for an entire class:

1. Go into the class you’d like to change from your educator dashboard.
2. Click the “More” Button in the upper right corner and select “Class Settings.”

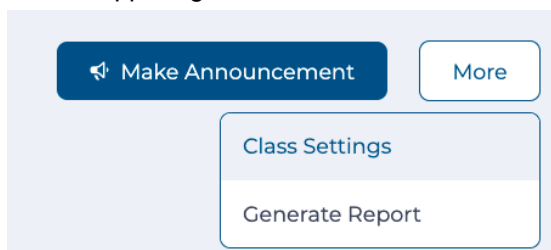

3. Change the setting for “Foundational” as desired. This will change the foundational settings for all students in the class.

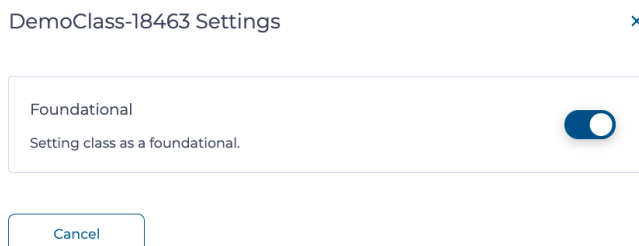

To change an individual student’s foundational settings:

1. Go into the student profile of the student you’d like to change by clicking “View Profile.”

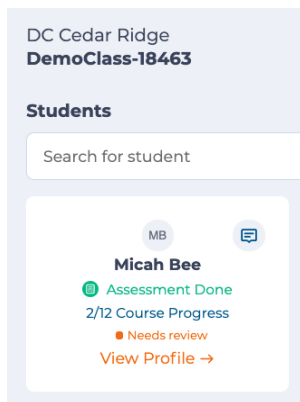

- Click “Student Settings” from the menu on the right.

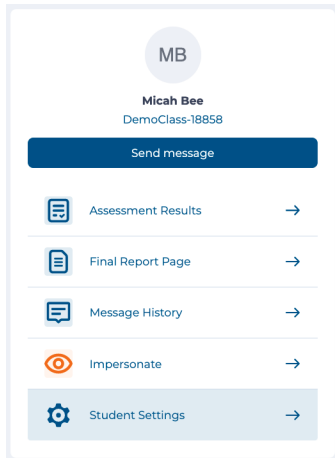

- Select the appropriate foundational setting from the menu.

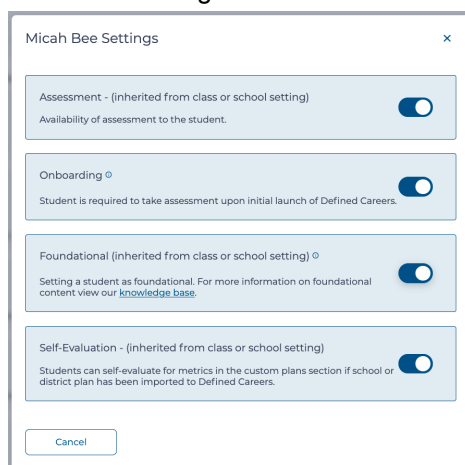

Can I assign default content to a foundational student and vice versa?

Yes. Within Defined Careers students will only have the content available to them to which the settings are assigned.

For example - a student with default settings will have the default Pathways Matching Assessment and the default career courses available to them and a student with foundational settings will have the foundational Pathways Matching Assessment and foundational career courses available to them.

However - educators have the ability to assign other career courses to students regardless of their settings. Therefore, if an educator would like to assign a foundational career course to a student with default settings, that is possible, and if an educator would like to assign a default career course to a student with foundational settings, that is also possible.