

Comment installer votre colonette

1

Détachez la tête de la colonette. Ensuite, à l'aide des 2 trous de la tête de la colonette, tracez 2 marques sous la table où vous souhaitez positionner la colonette.

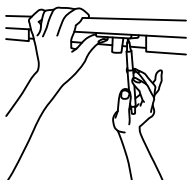

2

À l'aide d'une perceuse, Percez la table à l'endroit où se trouvent vos marques.

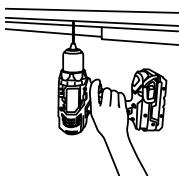

3

Fixez la tête de la colonette à l'aide des 2 vis fournies.

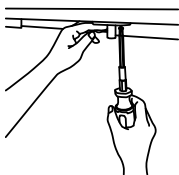

4

Fixez le reste de la colonette à la tête de la colonne vertébrale.

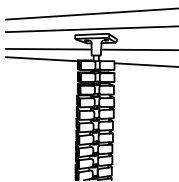

5

Insérez les câbles dans la colonette.

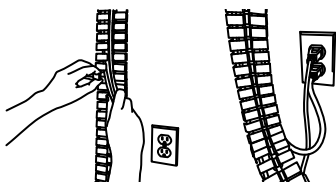

How to Install Your Spine

1

Detach the head of the spine from the spine. Then, using the 2 holes at head of the spine, draw 2 marks under the table where you want to position the spine.

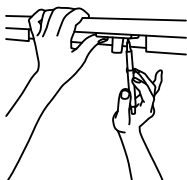

2

Predrill the table where your marks are with a drill.

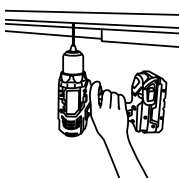

3

Screw the head of the spine using the 2 screws provided.

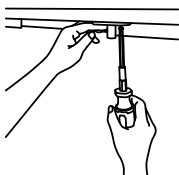

4

Attach the rest of the spine to the head of the spine.

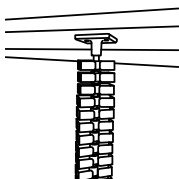

5

Insert the cables into the spine.

