

# BLOOD SAMPLE COLLECTION KIT INSTRUCTIONS

Please read these instructions carefully before collecting your sample.



## KIT CONTENTS

## SCAN FOR COLLECTION VIDEO

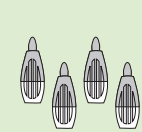

Lancet x4



Gauze x2

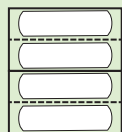

Bandage x4

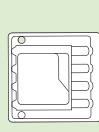

4-sampler  
Clamshell x1

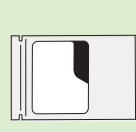

Silver Specimen  
Bag x1

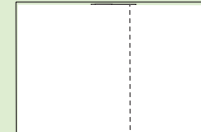

UPS Lab Pack  
w/Label x1



Label for  
Clamshell

## FIRST, UNPACK AND PREPARE YOUR KIT CONTENTS

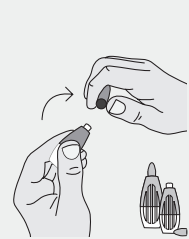

Twist off  
lancet caps

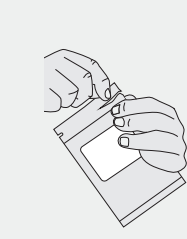

Tear open silver  
specimen bag



Do NOT remove  
desiccant

Remove  
Clamshell

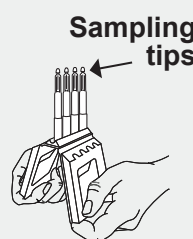

Open  
Clamshell

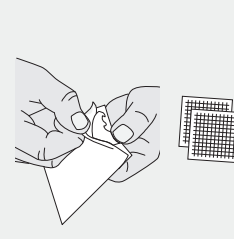

Unwrap  
gauze

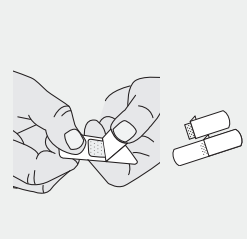

Unpeel back of  
bandages

## STEP-BY-STEP INSTRUCTIONS



- 1 **Wash your hands** with warm, soapy water.



- 2 **Warm your hands** by rubbing them together. You may also warm your hands by walking, jumping, or any other method you prefer. **Warming your hands is IMPORTANT for good blood flow.**

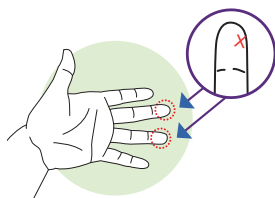

- 3 **Select the finger you will use** to provide the blood sample. See illustration for recommended locations off-center of finger midline.

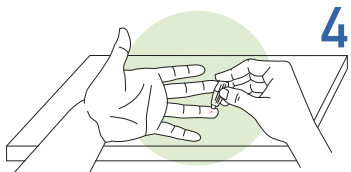

- 4 **Prick your finger** by laying hand on a hard surface. Position the lancet on the chosen location. Apply firm pressure to end of lancet until a click is heard.

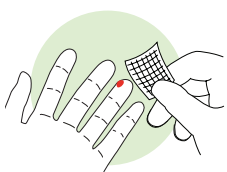

- 5 **Wipe away first blood drop** with the gauze. A blood drop may take up to 20 seconds to form. If needed, gently massage pricked finger upward until drop forms.

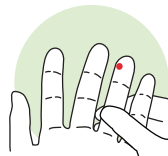

**note** - you may find that wiping away another drop of blood after filling a few sampling tips helps with blood flow.

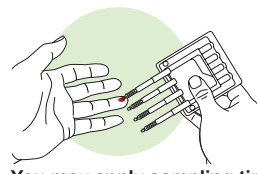

You may apply sampling tips to the blood drop multiple times to fill.

Always point sampling tip towards floor when touching it to blood drop on your finger as shown above. Do NOT drip blood onto tip.

- 6 **Collect sample by touching** one of the four sampling tips to the blood drop. First, watch it turn fully red. Next, count 2 seconds. Last, slowly remove the tip from blood. Repeat this process with the other three sampling tips.

### ensure sampling tips are filled correctly

Under-sampling occurs when: 1) The sampling tip is removed from the blood too soon. Touch tip to blood until no white remains. 2) Blood flow stops. If this happens, repeat steps 4-6 with same tip until it turns fully red.



over-sampled



under-sampled



correctly sampled

Over-sampling occurs when blood is dripped onto the sampling tip from above. Always touch sampling tip to blood drop as shown in step 6.

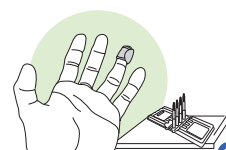

- 7 **Set Clamshell device down** on hard surface and apply bandage to your finger.



- 8 **Close & label Clamshell device** by lifting the sides to meet at the top. Press together until a click is heard. Place label sticker with name, date of birth, collection date & time on the clamshell.

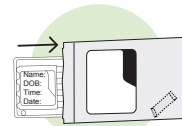

- 9 **Insert Clamshell device** into the specimen bag and seal shut. **Ensure the desiccant is still in the bag.**

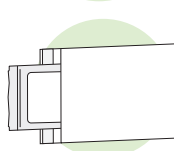

- 10 **Insert specimen bag** into plastic UPS Lab Pack shipping envelope. Include your completed Requisition form. Attach the UPS Shipping label. Drop the Lab Pack at any UPS store location.

### Intended Use

A single use, non sterile device used as a container to collect, store and transport blood specimen for research use.

### Intended User

The Microsampling device in a collection kit is designed to be used by laboratory professionals, healthcare professionals, or laypersons.



Phone: +678-736-6374  
Fax: +770-624-1701



9 Dunwoody Park, Suite 122  
Dunwoody, GA 30338



Info@PrecisionPointDiagnostics.com  
www.PrecisionPointDiagnostics.com