



SOLOWHEEL **Glide 3** User Manual

SOLOWHEEL

TABLE OF CONTENTS

1.	Document Overview	3
1.1.	About This Manual	3
1.2.	Relevant Documents and Data	3
2.	Safe Riding Precautions	3
3.	Product Overview	4
3.1.	Product Serial Number	4
3.2.	Package Inspection	5
3.3.	Product Parts	6
3.4.	Product Parameters	7
3.5.	Product Dimension Drawings	8
4.	Product Function Introduction	9
4.1.	Pull-up Handle and Assist Mode	9
4.2.	Anti-Spinning Button	9
4.3.	Rapid Battery Removal	10
4.4.	Overpower Protection	11
4.5.	Overheating Protection	11
4.6.	Slant Protection	11
4.7.	Digital Bluetooth	11
4.8.	Fun LED's	12
4.9.	Voice Prompts	12
4.10.	INMOTION APP	12

5.	How to Use INMOTION SCV V8	13
5.1.	Preparations before Riding	13
5.2.	Operating Steps for Beginners	13
6.	Maintenance and Service	14
6.1.	Storage	14
6.2.	Air Inflation; Tire and Innertube Replacement	14
6.3.	Pedal Adjustment	15
6.4.	Precautions for Cleaning and Use	15
7.	Legal Statement	16
7.1.	Use Statement	16
7.2.	Personal Information Statement	19
7.3.	Intellectual Property Statement	20
7.4.	Contact Us	21
8.	Product Quality Certificate	22
9.	Product Warranty	24
9.1.	Scope of Warranty Services	24
9.2.	Product Maintenance Service Policies	26
9.3.	Limited Maintenance Liabilities	26
10.	Warranty Card	27
10.1.	Customer Purchase Information Registration	27
10.2.	Maintenance Record	28

1. Document Overview

1.1. About This Manual

This user manual applies to the INMOTION SCV V8 (herein after referred to as the V8) produced by INMOTION Technologies Co., Ltd. The V8 is a rechargeable electric unicycle that uses gyroscope technology for automatic balancing.

Before using the V8, make sure you understand how to operate it correctly. Carefully read all instructions and follow all safety warnings and precautions. ALL USERS must read and understand this manual, the user guide leaflet and watch the safety video found on our website before riding the V8.

If you have any questions or cannot find the information you need from this manual, please contact the dealer authorized by INMOTION or the after-sales service department of INMOTION.

1.2. Relevant Documents and Data

The PDF document for this user manual, the safety video, the INMOTION APP and other help files can be downloaded from the INMOTION official website at: www.imscv.com.

2. Safe Riding Precautions

The V8 is an intelligent and entertaining travel and commuting vehicle. However, you must follow all V8 riding and safety provisions specified in this manual to minimize your risk. Whenever you ride, you risk serious injury, property loss or even death from falls, collisions or loss of control. This manual cannot cover every circumstance you may encounter. USE COMMON SENSE AND BE AWARE OF YOUR SURROUNDINGS AT ALL TIMES! When riding the V8, always comply with local laws. Everyone who rides the V8 must carefully read and follow this manual completely, watch relevant safety videos, and strictly follow the precautions to reduce risks and avoid injuries and losses.

- ALWAYS wear a helmet and protective gear while riding.
- Ensure that the pull-up handle has been folded into place before attempting to ride.
- Do not ride the V8 up and down slopes of more than 25 degrees.

- Do not accelerate or stop suddenly. Do not make sudden turns.
- Pay attention to and avoid road obstructions and obstacles.
- Do not ride the V8 on the sand, gravel roads, wet and slippery roads including snow and ice, and under other hazardous road conditions.
- Do not ride the V8 into water. The waterproof rating level of the V8 is IP55.
- Do not ride for more than 10 minutes in light rain. Do not ride in heavy rain.
- Do not ride the V8 up and down stairs.
- Do not ride the V8 in motor vehicle lanes.
- Do not soak the V8 in water.
- Riding speed must not exceed the maximum speed limits of this model**
- Do not accelerate rapidly after you experience tilting up of the pedals (tilting back of the V8's body).**
- Do not sit on the V8 case or the pull-up handle.
- Do not exceed the weight limit of 113kg (250 pounds). This includes anything you might be carrying.
- Do not lift the V8 off the ground when it is turned on.
- Ensure the battery is sufficiently charged, and that the tire pressure is normal (45 psi) before riding the V8.
- Only use the supplied charger when charging the V8. Users need to charge the V8 at least once every month at room temperature. Battery damage caused by irregular maintenance is excluded from warranty coverage.

****Beginners who are younger than 18 years old need adult supervision to help them learn how to ride the V8. Do not let anyone use the V8 until they understand all safety precautions and have watched the safety video.**

****Always ride in control! Practice safe riding habits such as riding at low speeds. Avoid rapid acceleration or lunging forward to get started. Avoid rapid deceleration, high-speed riding and stunts.**

3. Product Overview

The INMOTION SCV V8 is a fun and practical travel and commuting device and recreation vehicle. Its auto-balancing system works by

detecting changes in the vehicle' s position using the built-in gyroscope and accelerometer, and driving the motor to accelerate accordingly to counteract those position changes. Users can move forward, speed up, slow down, brake, and perform other riding operations by shifting their weight forward or backward, and also can keep lateral balance by steering the wheel with their feet.

3.1. Product Serial Number

Your V8's serial number, a 16-character sequence normally accompanied by a one-dimensional barcode or below a two-dimensional barcode, is the unique identifier of your product. It is used for quality tracking, after-sales service, insurance claims, loss confirmation, and other purposes. Please make sure to record and keep your serial number. You can obtain the serial number from the outer package of the product, the product warranty card, and on the vehicle itself.

3.2. Packing Container Inspection

Each V8 includes the following components and parts: the V8, charger, user manual, warranty card and certificate. Please check after unpacking. If there are any missing components and parts, please consult the dealer.



Warning

Do not disassemble or modify the V8 without permission. Doing so may result in personal injury or damage to the vehicle.

3.3. Product Parts

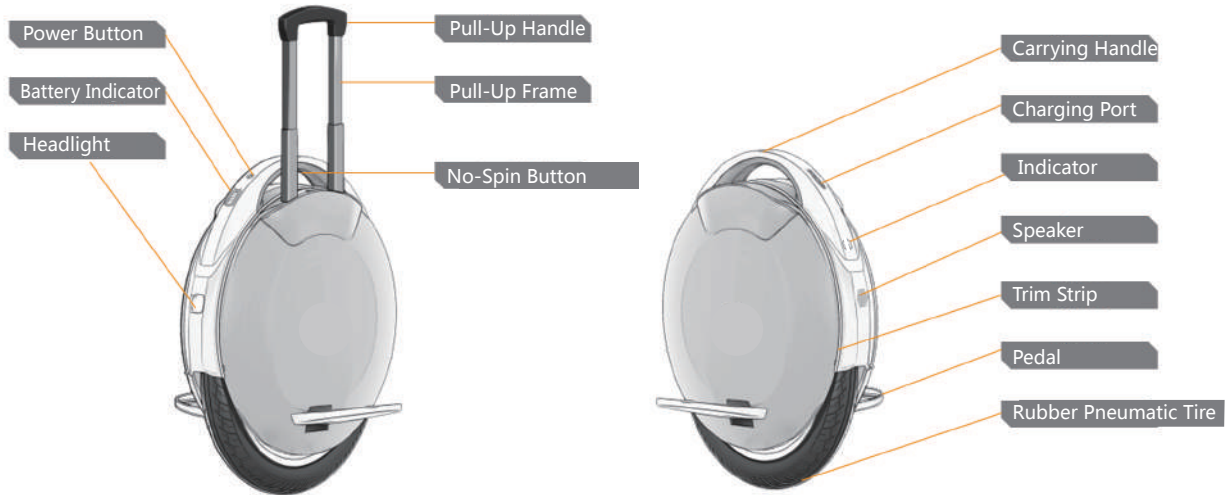

3.4. Product Parameters

Product Model	INMOTION SCV V8	<p>① Riding mileage is measured on a level road with ambient temperature of 77°F, speed of 12.42mph, and load of 154.32 lbs. Factors such as riding habits, ambient temperature, road surface conditions, and load influence the riding mileage. Different models and battery models also lead to different riding mileages.</p> <p>② This speed was measured on a level road with a 154.32 lbs load.</p> <p>③ This angle was measured with a 154.32 lbs load.</p>
Net Weight	29.76 lbs	
Riding Mileage ①	About 27.96-31.06 miles	
Factory Default Speed	15.53mph	
Max. Speed ②	18.64mph	
Climbing Angle ③	25°	
Max. Load	264.56 lbs	
Charging Time	About 4h	
Tire Dimension	16 inch × 2.125	
Factory Tire Pressure	2.8 bar	
Waterproof Level	IP55	
Operating Temperature	14° ~ 104°F	
Motor Power	800W	
Battery	480Wh	
Charger Input Voltage	AC 220V	
Charger Output Voltage	84V * 1.5A	

3.5. Product Dimension Drawings

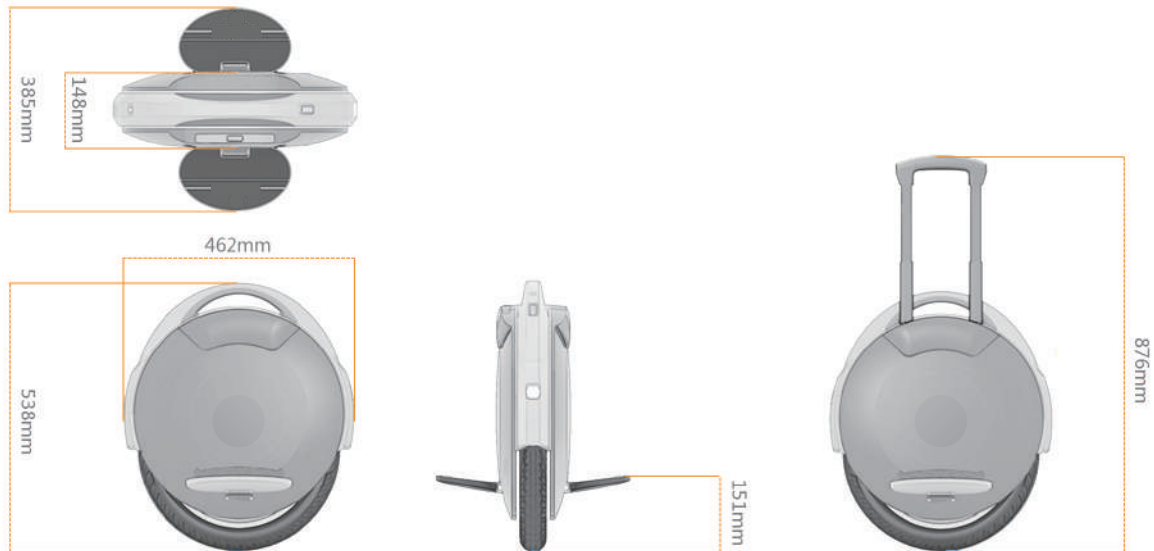

4. Product Function Introduction

4.1. Pull-Up Handle and Assist Mode

The assist mode enables the system to provide proper riding force at a lower power to help users push the unicycle easily when users are unwilling to ride or when the condition is not suitable for riding (for instance, insufficient electric quantity, steep slope, wet and slippery ground, sand, bumpy road, crowded environment, etc.).

Press the button in the middle of the handle. Lift it up. The handle comes up to the highest position. Release the button in the middle. The handle automatically locks. Push the unicycle body. The unicycle enters to the assist mode at this time. Use the same method to release the handle.

INMOTION SCV are designed with special handles along with the assist mode matching the unicycle bodies, and thus the users will feel very relaxed and convenient during riding and pushing.

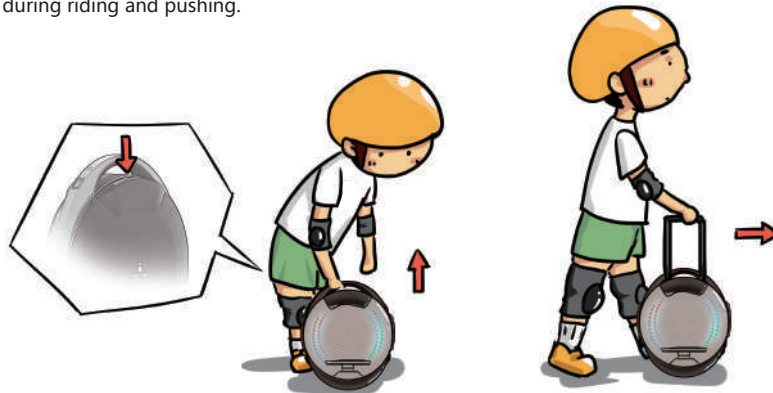

4.2. Anti-spinning Button

Due to the unique algorithm of V8, if the body angle varies after the unicycle body lifts off the ground under normal startup state, it will

lead to motor spinning acceleration until the unicycle shuts down. If being placed on the ground during motor acceleration, the unicycle will be likely to fly off due to the friction between wheels and ground, and there will a risk of running into others in some cases, such as at elevators, stairs, getting on or off the bus, or in crowded places.

The anti-spinning button below the body handle is designed to readjust V8 and bring it back to normal condition. When the user holds the handle to lift up the unicycle, the key will be automatically triggered, and the unicycle will enter the sleep state. In the meantime, the motor will no longer rotate to avoid spinning. Remove your hand from the handle key to let the unicycle fall to the ground again. The unicycle will then return to normal condition for continual use.

The anti-spinning function is on by default when V8 leaves the factory. You need to shut down this function on the mobile APP if installing the learning rope for operation on the handle. Users need to know the above functions and agree to accept the relevant legal liability statements when using this function.

4.3. Rapid Battery Removal

INMOTION SCV V8 are designed with unique rapid removal. The batteries can be easily replaced when operating as shown in the figure below (Phillips screwdrivers are required).

Steps:

1. Loosen the two screws under the pedal first;
2. Put the pedal away, and remove the shell as shown in the figure;
3. Loosen the battery lock screw to pull out the battery cable, and remove the battery afterwards.

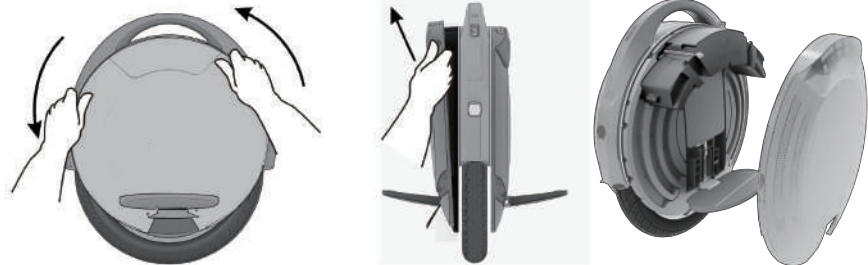

4.4. Overspeed Protection

INMOTION SCV V8 restricts the maximum riding speed to avoid the dangers caused by riding too fast. When the unicycle riding speed comes close to the maximum speed set by the system, the pedal will slightly tilt up 3~5° accompanied by an alarm sound. Users must slow down at this time. Do not accelerate forcibly (there is a risk of crashing if performing forced acceleration. Personal injuries and all losses caused by failure to operate according to the manual shall be borne by the users themselves). The pedal will return to normal angle once returning to normal speed.

When the electric quantity is less than 40%, the maximum speed limit will reduce gradually. When the electric quantity comes up to or is lower than the minimum riding voltage (10%), the unicycle body will automatically tilt up the pedal to give the user the indication to stop riding, otherwise it will cause damage to the unicycle.

4.5. Over-temperature Protection

INMOTION created a protective mechanism to avoid excessive battery temperature when the unicycle operates under heavy load for too long. When the battery reaches the temperature limit, the unicycle will indicate overload and the pedals will turn up. Once the unicycle is powered off, it is not able to immediately turn on. Users are required to wait 15 minutes before turning on the unicycle.

4.6. Slant Protection

When the unicycle body is tilted more than 55° in either direction during riding, the system will automatically exit the self-balancing mode in order to prevent any personal injuries caused by the high-speed rotating tires after the tilting of the unicycle body. The unicycle will then play a prompt tone to signal to the rider the unicycle body needs to be corrected in order to automatically re-enter the self-balancing mode.

4.7. Digital Bluetooth

INMOTION SCV is equipped with built-in digital Bluetooth 4.0 BLE module, which is used for interacting with the vehicles connected with the INMOTION APP.

The name of the Bluetooth 4.0 BLE of INMOTION SCV is V8-XXXXXXXX. XXXXXXXX refers to the last 8 digitals of the product serial number.

BLE Bluetooth needs to be connected via the INMOTION APP instead of the built-in settings of mobile phones. The initial password of Bluetooth connection via the INMOTION APP is 000000. INMOTION SCV can be added and controlled after entering the password. (Only the owner of the INMOTION SCV has the authority of Bluetooth password modification. The user can only modify the password of this unicycle after the authentication of the unicycle owner.)

After the user enters the unicycle owner authentication, click to enter the “Unicycle Status” interface of the INMOTION APP. Select the option of “Password Modification” to modify the Bluetooth password.

4.8. Colorful Atmosphere Lamp

INMOTION SCV V8 are equipped with colorful atmosphere lamps. Users can not only switch different display lamp effects via the APP, but also make animation effects on the APP on their own. When the colorful atmosphere lamp breaks down, it becomes red and flashes for indication. Please download the APP and read the production tutorials for detailed description.

Turn off /on the atmosphere lamp

Press the button under the handlebar and hold the power button at the same time. When hearing “ toot” , it operates successfully.

4.9. Voice Prompts

INMOTION SCV V8 are equipped with the voice prompts with high fidelity. When the unicycle operations or unicycle bodies are abnormal, the unicycles will give out voice prompts. Users can also custom-make the voices, switch themes, adjust volume, turn on or off the unicycles with the use of INMOTION APP. If there is voice loss or noise, users can use INMOTION APP to download the voices again.

4.10. INMOTION APP

INMOTION APP is mobile software designed for INMOTION users by INMOTION Technologies Co., Ltd to utilize unicycle control, make friends, release articles, attend INMOTION activities and purchase accessories. The English name of INMOTION APP is INMOTION respectively. INMOTION APP can be downloaded from our official website or corresponding APP stores (Apple App Store and Google Play).

The following functions can be utilized through INMOTION APP: startup/shutdown, turn on/off the light, speed display, mileage display, electric quantity display, unicycle body parameter setting, voice customization, fault detection, after-sales service, firmware upgrade, etc. For more detailed functions of INMOTION APP, download the product manual of the latest INMOTION APP from the official website.

5. How to Use INMOTION SCV V8

5.1. Preparations before riding

INMOTION SCV V8 is a high-tech travel and commuting device. Riding without learning about operating specifications may cause unpredictable injuries and property losses. The instructions given below are made for users, and contain details about how to correctly ride V8. Matters needing attention during riding are also listed. Please read them carefully and ride V8 in accordance with the instructions.

- Make sure that all parts of V8 are free from damage and installed properly before riding.
- Continuously charge the batteries of V8 for more than 3h before riding.
- You can practice riding in an open indoor or outdoor area that is flat and wide, and covers at least 13.12 ft x 13.12 ft.
- Make sure that you know the surrounding riding environment well so that the unicycle is free from the disturbance of cars, pedestrians, pets, bikes and other obstacles.
- You need a skilled assistant who is familiar with the operation of V8 as well as all the precautions and riding methods described in this manual by your side.
- Do not perform trial ride on slippery and wet fields.
- Please wear comfortable sportswear and flats, and do warm-ups to maintain body flexibility as far as possible.
- Put on safety helmet and protective gear to avoid injuries.

5.2. Operating Steps for Beginners

- Hold the unicycle body, and make sure that it is vertical to the ground after startup.
- Open the pedals on both sides. Step one foot on one side of the pedal. The sole of the foot should be on the center of the pedal.
- The upper body should be naturally upright, and the eyes should look straight ahead. Tilt the center of your body weight to the other side of the pedal. Try to get the other foot off the ground to look for the balance point.
- Gradually begin to slowly slide forward by single-foot support, until the unicycle can keep sliding for a long time with one foot on the pedal.
- After keeping the center of gravity balanced when sliding with one foot, you can step both feet on the pedals. Relax the lower legs on both

sides to ensure the balanced riding.

Your body will go through temporary imbalance during practice, which is very easy to cause the slant of the unicycle body. It is necessary to lean on railings or walls while practicing to help you keep your body in balance. You can also practice with the support of a friend and learn how to ride the unicycle step by step. After being gradually familiar with how to steadily ride straight forward, you can try to change directions by adjusting the your center of body weight or by controlling your feet to twist around.

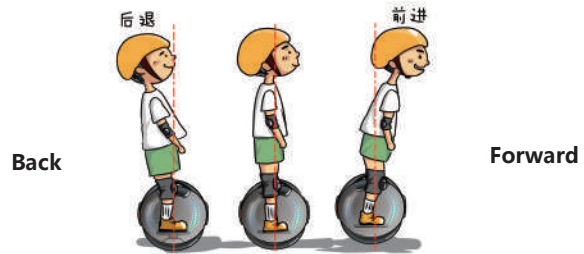

6. Maintenance and Service

6.1. Storage

Unreasonable storage will shorten the life of the built-in lithium batteries or cause other hidden dangers. Please store the V8 in a dry room at suitable temperatures and humidity. If you do not use it for a long time, please fully charge the battery at room temperature and at least once a month.

6.2. Air Inflation and Inner and Outer Tire Replacement

If the tire pressure is insufficient, the tire will need to be inflated. The factory tire pressure of INMOTION SCV V8 is 2.8Bar by default. If the tire of V8 needs to be replaced due to tire burst, etc., please contact the dealer authorized by INMOTION or the after-sales service department of INMOTION for maintenance.

6.3. Pedal Tightness Adjustment

Riders will feel uncomfortable if the pedals of V8 become loose and will even fall under severe conditions. If the pedals become loose,

please respectively use a M10 Allen wrench and a M6 Allen wrench to tighten the screws on the axis and on the side edge of the axis. Please develop a habit of checking all parts of the V8 before using.

6.4. Precautions for Cleaning and Use

- Before cleaning the unicycle the body should be shut down. Charging wire should be pulled up and the charging port should be closed. During rinsing make sure the water does not flow into the battery-charging port.
- Use a soft cloth dipped with clean water to scrub the outer cover of the V8. Do not use high-pressure water jet to flush the V8.
- The waterproof and dustproof level of the V8 is IP55, which means splash-proof and dustproof. Therefore, do not dip the V8 in water, which may cause permanent damage to the unicycle.
- Please do not ride in a rainstorm. The rider could fall down or cause damage to the unicycle from the rain water.
- Please do not place the V8 near a fire source or places with extremely high temperatures, in order to avoid battery damages or even explosion caused by hidden fire dangers.



7. Legal Statement

INMOTION SCV V8 can be considered as an intelligent and portable travel and commuting device. However, it is no replacement for the current means of transportation. When you use INMOTION SCV V8 as a means of transportation for short-distance travel, there might exist conditions causing injuries such as a decline, crash, etc. as well as other risks. You have the responsibility and obligation to carefully read and learn the user manual for INMOTION SCV V8, be familiar with how to ride the INMOTION SCV V8, and be fully aware of the warnings and precautions as well as the provisions specified in the following legal statement, so as to reduce (but cannot totally eliminate) potential risks and to ensure the personal and property safety of yourself and others.

7.1. Use Statement

For your safe application and good experience, kindly use the product in strict accordance with the following requirements:

1. Please make sure to carefully read and completely understand the user manual for INMOTION SCV V8 and User Guide before using.
2. Please do not allow the ones who fail to carefully read and completely understand the user manual for INMOTION SCV V8 to use your INMOTION SCV V8.
3. Please follow the instructions in the user manual for INMOTION SCV V8 with regard to the riding age of 12-60 years old. Do not allow riders who are younger or older than this age group to ride the V8.
4. Those who are pregnant or not in normal physical or mental state cannot ride the V8.
5. When you are in a bad physical or mental state, such as sick, taking drugs, drinking, etc., please do not ride the V8.
6. INMOTION SCV V8 is a riding vehicle designed for one person only. Two or more people must not ride one V8 at the same time. Do not ride the V8 with loads or while holding a baby in your arms.
7. Please make sure that you are fully qualified in the physical and mental conditions for freely getting on/off and controlling the INMOTION SCV V8 without any assistance before riding.
8. Please do not modify or repair the INMOTION SCV V8 without permission, or allow someone else who has not been authorized by our company. If there is anything wrong with the product, please contact the after-sales staff of INMOTION, which is your most secure option.
9. Please make sure that the INMOTION SCV V8 is not loose, damaged, broken, or under other abnormal situations before riding.
10. Before charging, please make sure that the socket is dry, fault-free, and without any foreign matters. During charging, make sure to

insert into the correct socket (100V-240V/50HZ-60HZ), and avoid contact with children and pets. Furthermore, keep the V8 away from combustibles.

11. The batteries of INMOTION SCV V8 must be placed in an environment of -4°F - 113°F. Please do not place the V8 in an environment where the temperature is above 113°F or below -4°F, the batteries will enter the self-locking state, which are unable to be charged or used. Please keep the INMOTION SCV V8 in a suitable environment for charging and using.

12. If there is any leakage (including damage, giving off a peculiar smell/smoke, or overheating) in the batteries, please stop the vehicle immediately, and avoid its contact with other objects.

13. Do not attempt to open or disassemble the batteries on your own. Do not perform abnormal operations or application to the batteries.

14. Due to different battery status and environment, the standby time of the fully charged INMOTION SCV V8 (the electric quantity display screen has 5 scales) and the not fully charged INMOTION SCV V8 (the electric quantity display screen has 1 scale) is respectively 180 days and 30 days at most. Please pay attention to the standby time to avoid causing irreversible damage to the batteries because of failing to charge them in time.

15. Please do not wear high-heeled or other unsuitable shoes, as well as clothes that are loose-fitting and unsuitable when riding the INMOTION SCV V8. Furthermore, you must wear professional protective gear during riding.

16. You are highly recommended to wear protective glasses when riding the INMOTION SCV V8, so as to prevent eye injuries caused by dirt, dust or insects in the air and the possible adverse effects on riding.

17. Do not ride INMOTION SCV V8 on rainy days and on other wet roads. When riding on the wet and slippery roads, the tire resistance reduces, the braking distance becomes longer, and the V8 is easy to slip, which might cause accidents.

18. Please use a dry soft cloth to clean the V8 body. Do not use strong water flow or high-pressure hose to clean the V8 body. Do not soak the INMOTION SCV V8 in the water, causing uncontrollable faults, abnormalities, accidents, and other risks.

19. Do not ride the INMOTION SCV V8 in bad weather or adverse environments with low visibility and poor light. Do not ride the V8 when you are extremely tired.

20. Since it is difficult for riders, motorists, and pedestrians to notice each other in time at night and in an environment with poor light, you are strongly advised against riding at night and in an environment with poor light, in order to avoid severe risks that might arise.

21. Please pay attention to the variation of road surfaces and surroundings when riding the INMOTION SCV V8. Ride carefully to avoid

hurting yourself or others.

22. Please do not ride the V8 under unsuitable road conditions and in improper environment, such as on the stairs, in the elevators, or when passing through the revolving doors.

23. Pay attention to the distance among V8 body, your body and obstacles when riding the INMOTION SCV V8.

24. Do not take the risk of riding on steep slopes, bumpy roads, or other terrains that you have never met before during riding.

25. Please do not make a turn at a rapid speed. Please do not slam on the brakes when riding the V8 on the slippery road. The above-mentioned behaviors can easily cause slipping and other uncontrollable situations.

26. Please do not ride in the bicycle lanes. Please do not ride in the motor vehicle lanes and other unsuitable places. Please strictly obey the traffic rules and other laws and regulations. When the V8 comes close to or passes through crossroads, motor vehicle lanes, corners, and doors, please pay attention to slow down and avoid collisions. The rider needs to have defensive awareness and to pay attention to the dangers that might be caused by traffic and pedestrians.

27. When riding the V8, pay attention to and take precautions against the vehicles from all directions, pedestrians, pot holes, sewer separators, railroad tracks, expansion joints, road surfaces, road construction, debris, and other obstacles as well as other dangerous situations that might affect the personal and property safety of you and others at any time.

28. Do not make and receive phone calls or do any activities or actions that might distract you when riding the INMOTION SCV V8. Pay attention to the external environment at all times.

29. Please ride forward along the riding directions of the bicycle lanes allowed and specified by the local governments and laws or the road edges. Do not ride in a direction not allowed by traffic regulations.

30. Please do not cut in the ways of vehicles and pedestrians when riding the INMOTION SCV V8.

31. Please do not put your hands on another means of transportation for dragging when riding the INMOTION SCV V8. Do not perform any improper behaviors, such as making stunts, doing any other extreme sports, etc.

32. Please do not ride the INMOTION SCV V8 alone to some remote area. Prevent potential risks by riding the V8 with others.

33. INMOTION SCV V8 is a personal short-distance travel and commuting device. Do not use it for freight or other improper purposes.

34. The data and parameters of INMOTION SCV V8 vary along with different product models, which are subject to change by INMOTION without prior notice.

7.2. Personal Information Statement

1. Your personal information will only include the personal information that you voluntarily enter for the INMOTION SCV V8 when using the INMOTION APP (hereinafter referred to as APP) to connect with the INMOTION SCV V8 for registered certification. The personal information that you voluntarily provide during the product application, including but not limited to your name, gender, age, address, contact, occupation, and the time and place for using our service, etc.

2. In the process of using the APP, your personal information provided during the owner certification, product serial number activation, questionnaires at after-sales follow-ups and return visits, solicitation of your opinions or suggestions with regard to our products and services, and activity participation is convenient for us to provide better products and services for you, and improve your user experience.

3. You have the right not to provide your personal information. However, if you refuse to provide some of your personal information we may not be able to provide better products and services for you and even might hinder you from using our products and services.

4. Any personal information provided by you shall be deemed as the fact that you have agreed to your personal information being used by INMOTION itself or its affiliated companies after the disclosure. The application of INMOTION and affiliated companies shall include but not limited to the application of the internal staff, consultants, agents, suppliers, and partners of INMOTION and its affiliated companies.

5. You agree that we might provide your personal information to the interested third party when in line with any of the following conditions:

1) After your special authorization

2) Conforming to the relevant laws and regulations, or the mandatory requirements put forward by the government agencies

(includ

ing the judiciary authorities)

3) Perform the Terms of Services available (including investigating possible violations)

4) Deal with frauds, safety or technical issues

5) Protect the rights, properties and security of users or the public from being damaged within the scope of legal requirements

or the

allowable range

6) The needs under special and/or emergency circumstances

6. The electronic data from your personal information can be used for application, transmission and storage, and the above-mentioned behaviors that exist in or out of China.

7. You completely agree with the idea that INMOTION and its affiliated companies might push the information with regard to the products and services as well as the relevant activity information from time to time for your better application and experience.

8. We will take reasonable and safe measures to protect the safety of your personal information, and to prevent your personal information from being disclosed and used without authorization. Furthermore, we will not be liable of other interested parties accepting and using your personal information described in this legal statement to fulfill the same obligations. You agree that INMOTION decides the time to save and keep your personal information according to the requirements of intended use or any agreements, laws and regulations.

9. You agree to exempt INMOTION and/or its affiliated companies and other receivers and/or users from any claims, responsibilities and losses caused or might be caused by disclosing and using your personal information according to this legal statement, unless the above-mentioned claims, responsibilities and losses are caused by the direct intentional behaviors or gross negligence of the receivers and/or users.

7.3. Intellectual Property Statement

Unless otherwise stipulated in laws and regulations, or otherwise stated in agreements, all rights of the intellectual properties (including but not limited to the copyright, trademark right, patent right, application right, enforcement right, permissions, and other powers) with regard to the products and their accessories, APP and website are reserved by INMOTION. No illegal use or any other uses shall be conducted without the prior written consent of INMOTION.

This legal statement shall apply to the Law of the People's Republic of China.

For all the claims, responsibilities and losses caused or might be caused by consumers and any third party violating this law statement, INMOTION shall assume no responsibility for the claims and any other obligations.

This legal statement constitutes the integral legal part of the INMOTION products (please make sure to transfer this legal statement during

product resale). You can choose to accept all the terms and conditions of this legal statement for using the INMOTION products. If you use the INMOTION products, then you have agreed to accept all the terms and conditions of this legal statement, and to undertake any possible risks and responsibilities.

If you do not agree to accept all the terms and conditions of this legal statement after purchasing our products, please return the goods; and make sure that the products and packaging are intact without affecting the secondary sales during the return process.

Thank you for choosing INMOTION and trusting us. For any questions please contact us. We are always ready to be at your service.

Contact Us

SOLOWHEEL Technologies CO.,Ltd

Address: 4/F, Building 3, Desheng Household Industrial Park, Changbu Village, Xinxu Town, Huiyang District, Huizhou, Guangdong518052

Tel: 4000-1000-12(Mainland China Only)

E-mail: service@solowheel.com

8.Product Quality Certificat

This product has been tested and proved to be qualified for delivery in conformity with standards.

The warranty card (valid with manufacturer' s seal and serial number in the back) and regular sales invoice are effective certificates for maintenance. Please keep the warranty card properly.

Date of Production

QC Qualified Sea

INMOTION Balancing Scooter consists of the parts below. Please open the package to check them and consult the dealer if any of them is missing.

Scooter body, user guide, warranty card, quality certificate, charger, charging wire

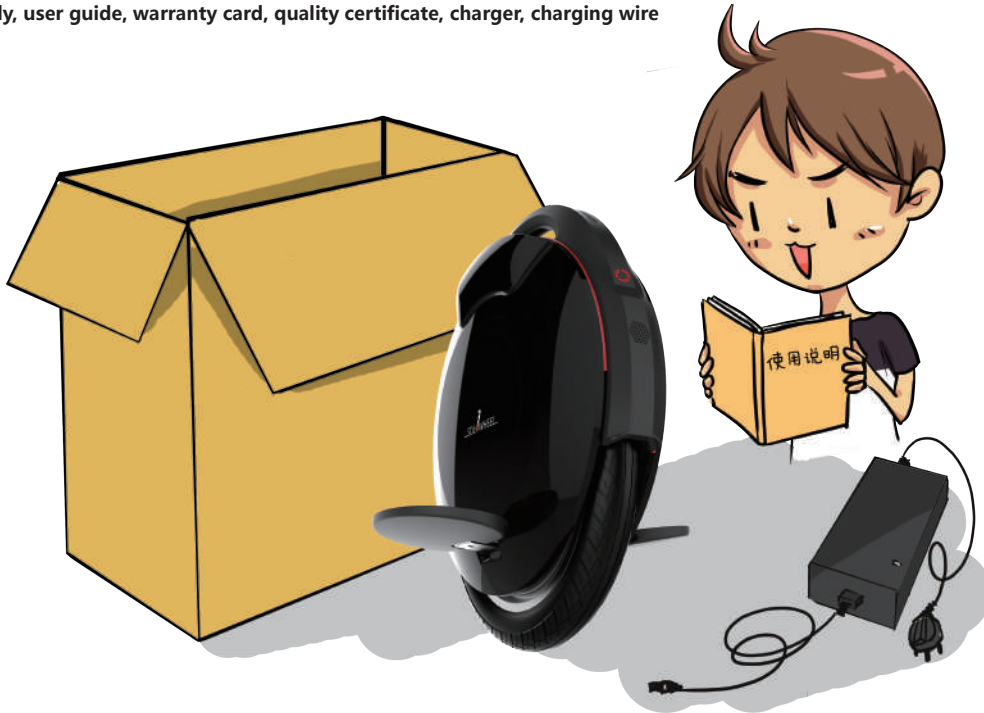

9.Product Warranty

Dear customers:

Thank you for purchasing INMOTION series products.

After purchasing this product, please provide your correct, complete and true personal information, fill the information in the warranty card, and ask for a valid invoice. You are advised to properly keep the warranty card and invoice.

To ensure that you obtain the best quality service of this Company, Shenzhen INMOTION Technology Co., Ltd. makes the following service commitment for its products.

9.1.Scope of Warranty Services

- 1.The Company follows the national rule “three guarantees” (for repair, replacement or compensation of faulty products) for its products. The products (only limited to the products purchased on Chinese mainland) meeting warranty conditions enjoy free services of repair, exchange and return. Except for insurance, postal delivery and transport, warranty services shall be provided free of charge.
- 2.Customers enjoy warranty services with warranty cards. The serial number on the warranty card must be identical to that on the scooter body. The warranty shall start on the earlier date of the following: date on the purchase invoice and product activation date. If a customer cannot show proof of the warranty start date, the date of production shall be taken as the start date to determine whether the product is within warranty validity period.
- 3.If an equipment performance problem is detected and confirmed within 7 days after purchase, customers may choose to repair, exchange or return the product.
- 4.If an equipment performance problem is detected and confirmed within 15 days after purchase, customers may choose to repair or exchange the product.
- 5.If an equipment performance problem is detected and confirmed within the term of service, our Company shall repair the product for free.
- 6.After a product is exchanged, the warranty period of the product shall be reset. Our Company shall affix a seal to the back of the delivery bill indicating a new date, and provide a new warranty card.

7. Warranty periods of the scooter parts are listed below.

Part	Warranty Period	Remarks
Whole scooter	One year	Including LED, scooter enclosure, decorating parts, pedal, built-in music Bluetooth (except battery, and inner and outer tires)
Lithium battery pack	Six months	
Inner and outer tire	Three months	

8. With the warranty period, please note that we do not provide free services and repair in the following circumstances.

- The accumulated mileage of the product exceeds 2000km according to records.
- Damage is caused by failure to install or use the product according to the instruction manual.
- Product serial number is removed or changed.
- The serial number bar code or model indicated on the warranty card is inconsistent with the product itself.
- The product has been dismantled or repaired by unauthorized personnel.
- There is natural abrasion (including abrasion of enclosure, handle bar, gearbox, tire, etc.) that does not affect product functions.
- The product is damaged by due to accident or misuse, such as mechanical damage, drop & break, collision and severe product oxidation.
- Damage is caused by overload, driving over barriers (including but not limited fall and driving down steps), or extreme sports.
- Damage is caused by disassembly, delivery or loading/unloading en route when the product is sent for repair.
- Damage is caused by abnormal storage conditions or force majeure such as fire, liquid soaking, freezing or earthquake.
- There are wear and tear of vulnerable accessories, such as packing materials and technical materials.
- Other fault or damage is caused due to problems unrelated to the design, technology, manufacturing or quality of the product.

9. Our Company will provide paid maintenance services for faulty products exceeding the quality warranty period.

9.2.Product Maintenance Service Policies

10.Customers can dial the official technical support hotline 4000-1000-12 of Shenzhen INMOTION Technology Co., Ltd. or directly contact dealers for after-sale help or services. For details about after-sale service policies and procedures, visit our official website: www.imscv.com.

11.Within three workdays after receiving a customer' s faulty product, our company will inform the customer of issues including cause of the fault, fault clearance responsibility, maintenance fee and expected completion time of maintenance.

12.Our Company starts maintenance work of a product only after knowing that the customer holds no objection to issues including the cause of the fault, fault clearance responsibility, maintenance fee and expected completion time of maintenance.

13.We provide warranty services for the products that were repaired less than 3 months ago or have been repaired and are within the warranty period.

9.3.Limited Maintenance Liabilities

Shenzhen INMOTION Technology Co., Ltd. bears the obligations and responsibilities of maintenance for products, spare parts and accessories, which are only limited to the parts within the warranty period for free maintenance or exchanged faulty parts. We do not assume (or authorize any person to assume) other obligations or responsibilities, including but not limited to the work delay, property loss or other losses due to the product maintenance period. The limited maintenance clauses specified here are the only maintenance policies for the INMOTION SCV, parts and accessories of Shenzhen INMOTION Technology Co., Ltd.. We do not acknowledge any other guarantees or implicit guarantees apart from these articles. In terms of commitment made by a third party on the products of Shenzhen INMOTION Technology Co., Ltd, we will not assume responsibilities. The rules shall take effect from the date of issue.

The SCV series products made by Shenzhen INMOTION Technology Co., Ltd. are covered by PICC (People's Insurance Company of China).

The final explanation right, copyright and alteration right of this warranty card shall be subject to Shenzhen INMOTION Technology Co., Ltd.

10.Warranty Card

10.1.Customer Purchase Information Registration

Customer Name		SN	
Date of purchase			
Contact number			
Email			
Customer' s address			
Name of dealer		Contact way/number	
Address of dealer			

10.2.Maintenance Record

Time	Fault Description	Solution	Maintenance Staff Signature	Remarks



Scan QR code to
download the App



Scan QR code to
follow WeChat

SOLOWHEEL Customer Service Center : 4000-1000-12 (Mainland China Only)