

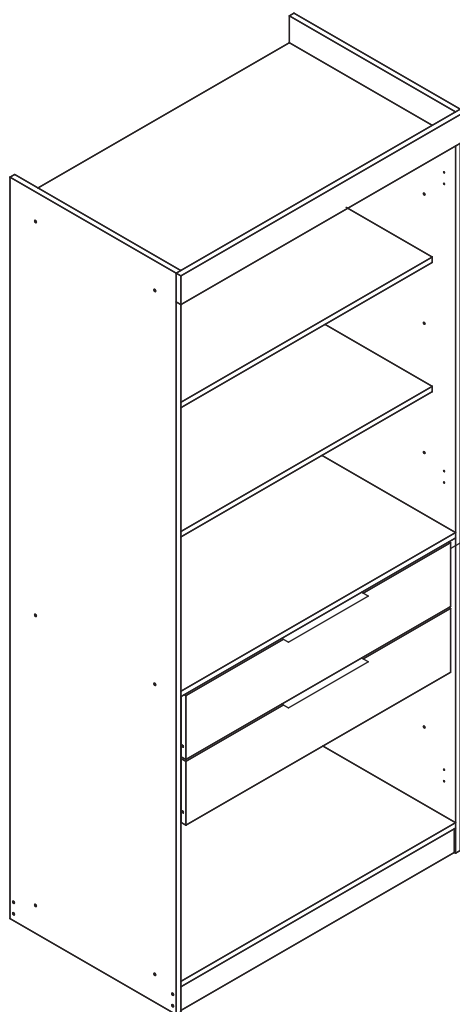

MANHATTAN
COMFORT



109GMC

V.01092023

Included in the package

- 01 - Base = 01 piece (box 1/2)
- 02 - Lower Bar = 02 pieces (box 2/2)
- 03 - Left Side Panel = 01 piece (box 2/2)
- 04 - Right Side Panel = 01 piece (box 2/2)
- 05 - Top Panel = 01 piece (box 1/2)
- 06 - Front of the Drawer = 02 pieces (box 2/2)
- 07 - Left Side Panel of the Drawer = 02 pieces (box 1/2)
- 08 - Right Side Panel of the Drawer = 02 pieces (box 1/2)
- 09 - Rear Panel of the Drawer = 02 pieces (box 2/2)
- 10 - Base of the Drawer = 02 pieces (box 1/2)
- 11 - Shelf of the Drawers = 01 piece (box 2/2)
- 12 - Adjustable Shelf = 02 pieces (box 1/2)
- 13 - Upper Bar = 01 piece (box 2/2)
- 14 - Back Panel = 05 pieces (box 2/2)
- 15 - Union Plastic Profile = 04 pieces (box 1/2)
- 16 - Left Support of the Slides = 01 piece (box 1/2)
- 17 - Right Support of the Slides = 01 piece (box 1/2)
- 18 - Slides = 02 pieces (box 1/2)

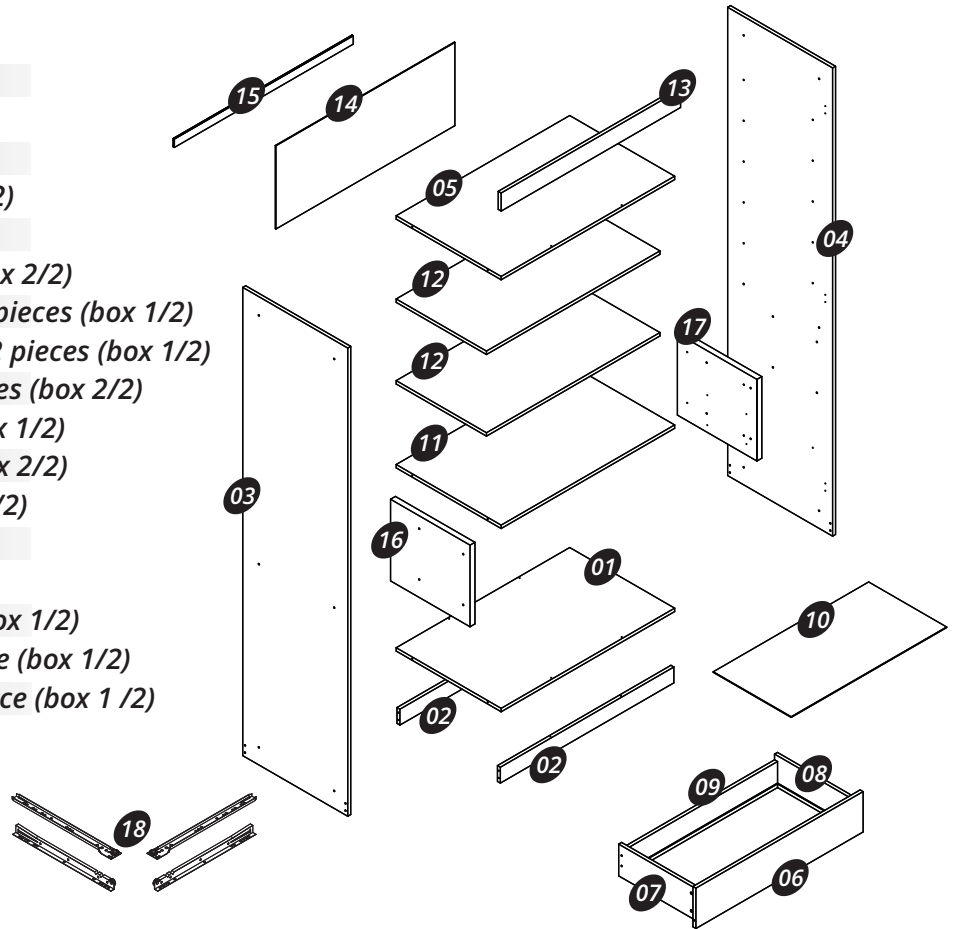

Hardware (box 1/2)

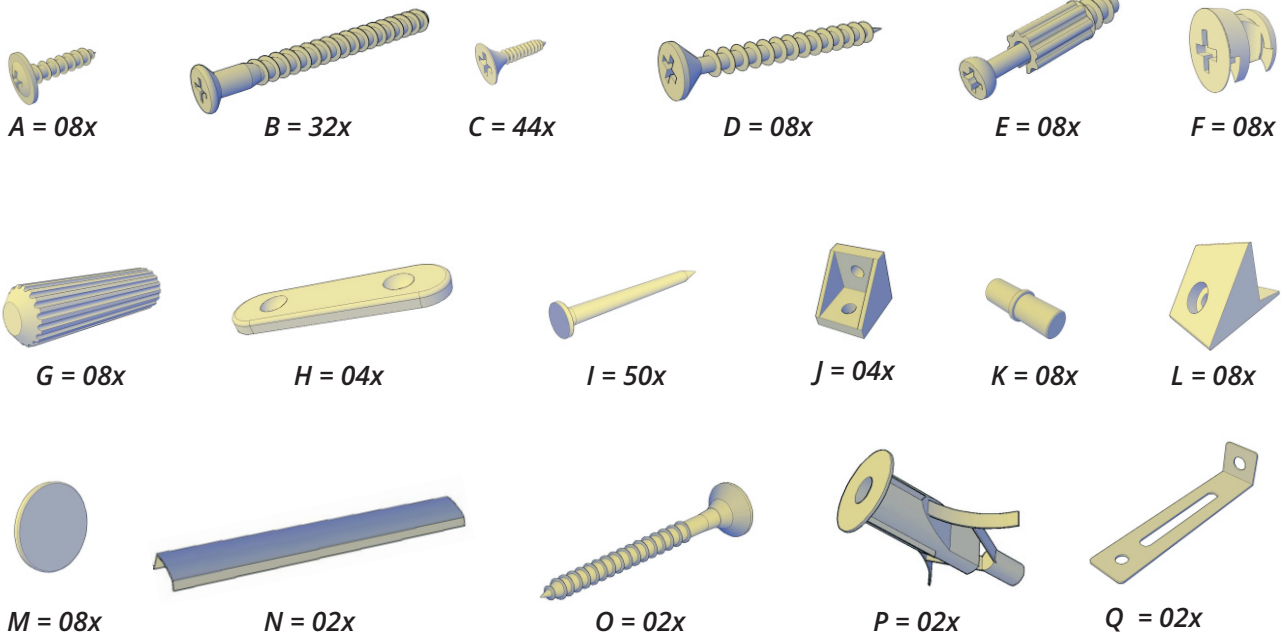

**Tools needed
(not included)**



Philips screw driver



Screw driver

**ATTENTION: BEFORE START ASSEMBLING TAKE
A PICTURE OF THE LABELS ON THE PACKAGES,
THIS WILL BE REQUIRED IN CASE THE PRODUCT
HAS ANY ASSISTANCE DEMAND.**

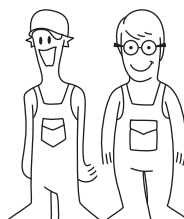
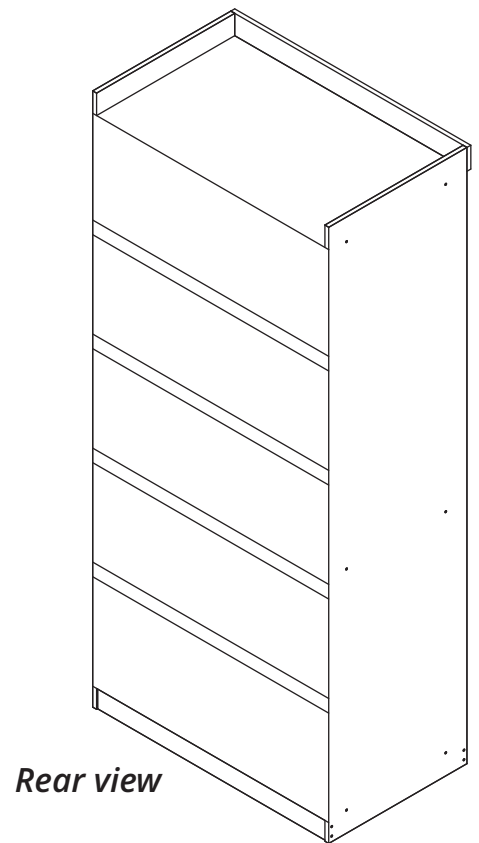
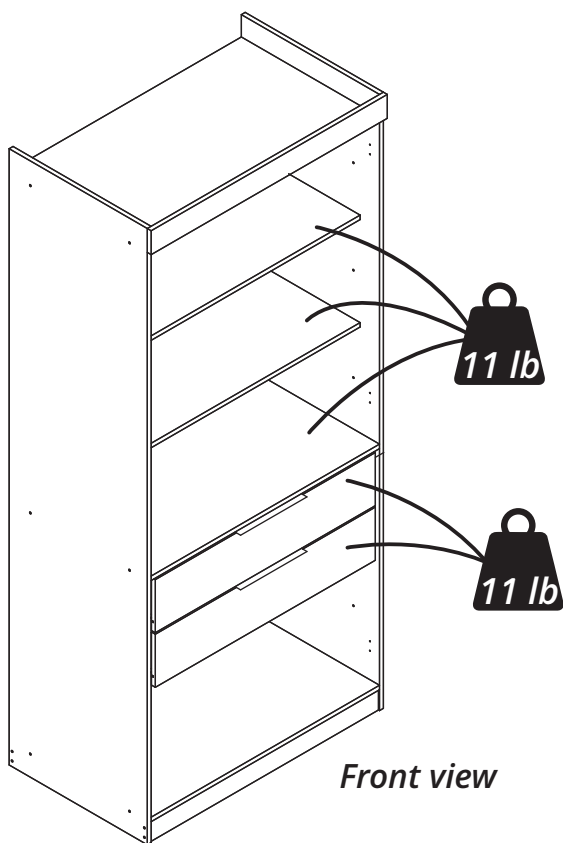

HOW TO IDENTIFY THE SLIDES?

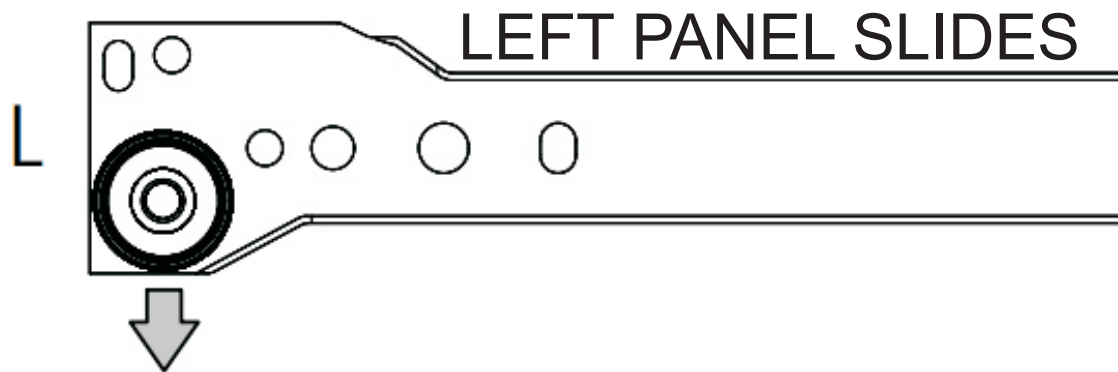

*plastic wheel always pointed to the ground.

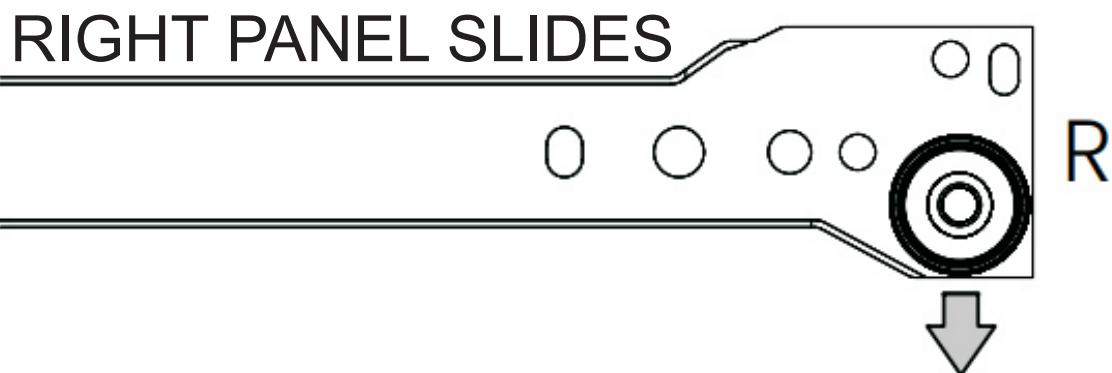

*plastic wheel always pointed to the ground.

WICH HOLES TO ATTACH THE SCREWS?



Step 01

Use the hardware (C)
to apply the slides 18 on the parts 16 and 17.

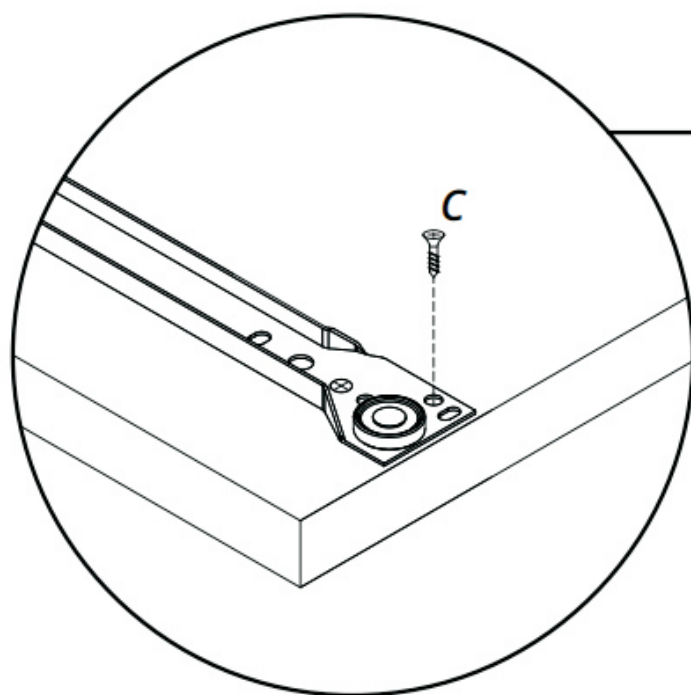
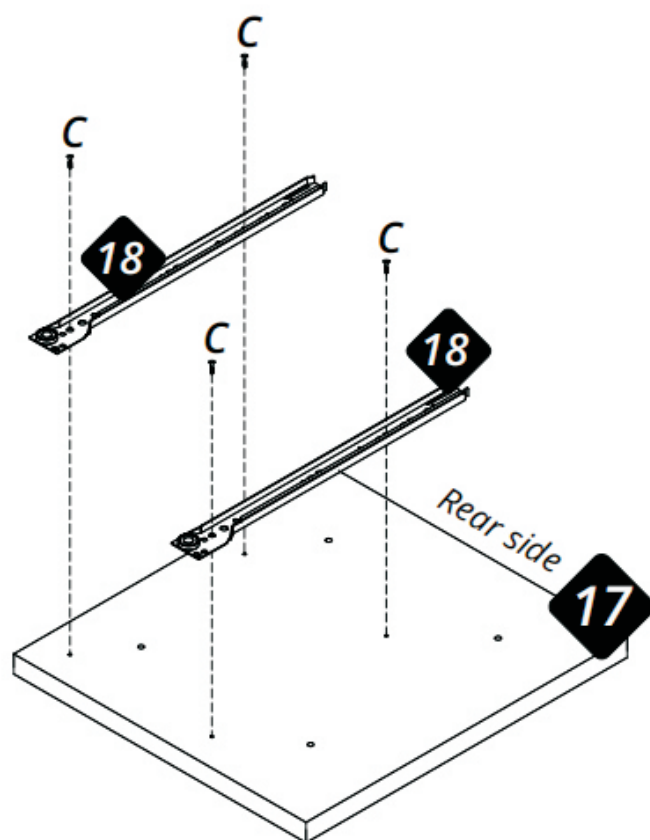
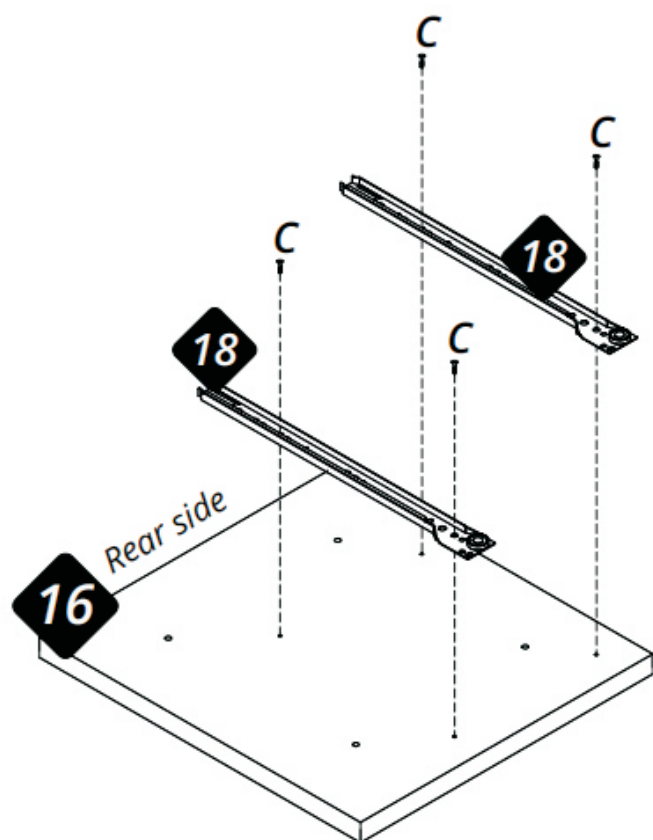

ATTENTION!

It is mandatory to apply the screw (C), observe there is no hole at this position.

Step 02

Using the hardware (G) connect the part (16) onto the part (03) and the part (17) onto the part (04).

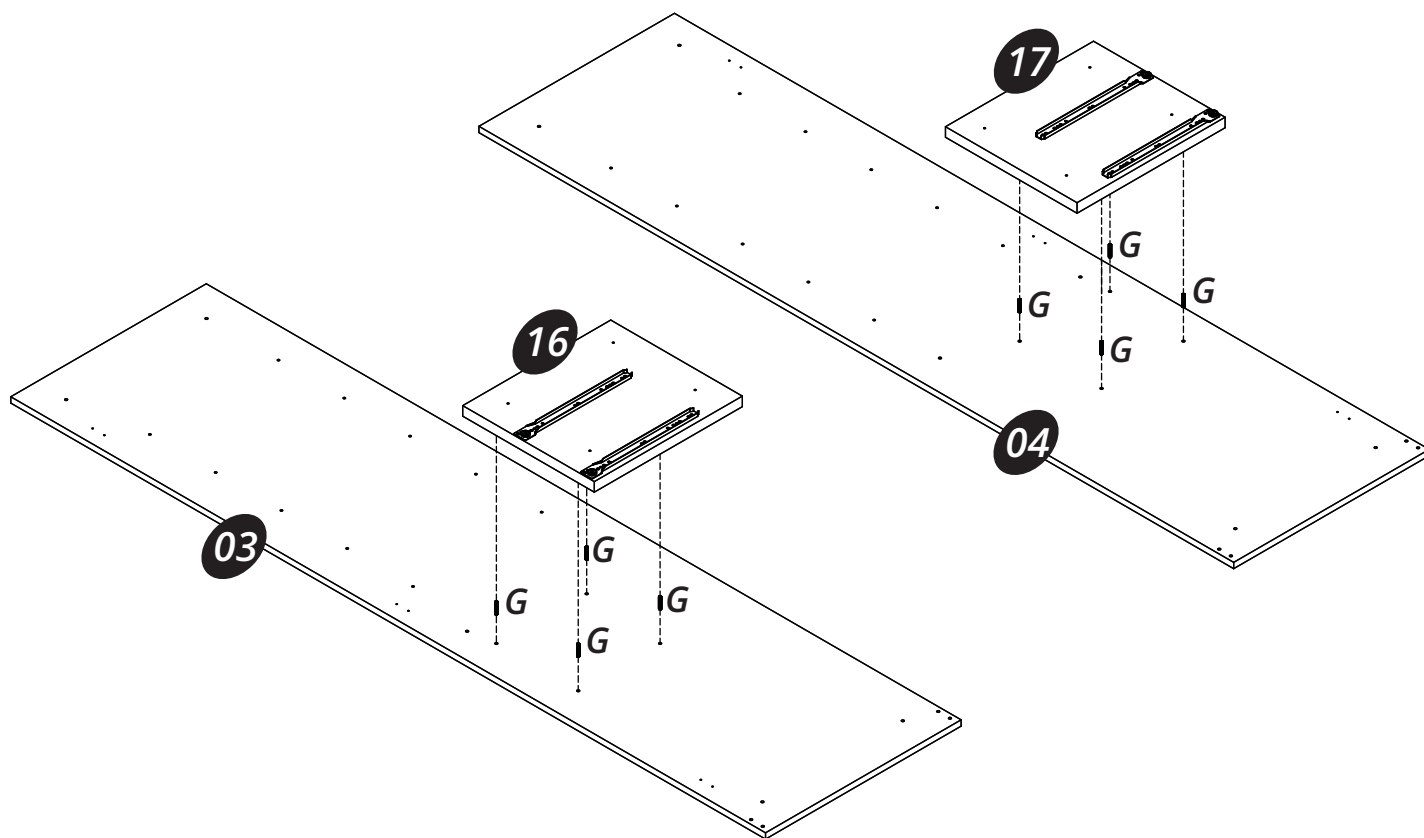

Step 03

Fix the hardware (H) onto the part (03) and the part (04) with the hardware (C).
Connect the part (16) and part (17) with the hardware (D).

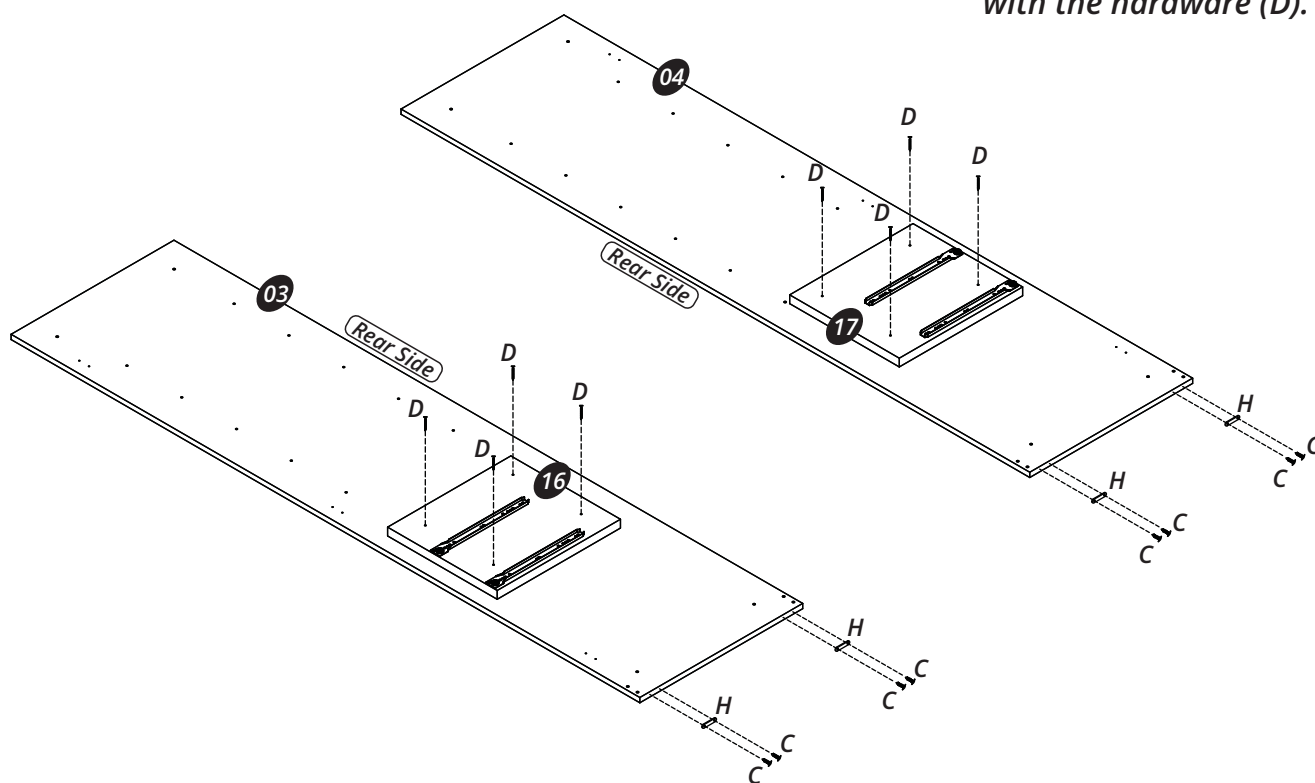

Step 04

Connect the part (01) onto the part (02) with the hardware (B).

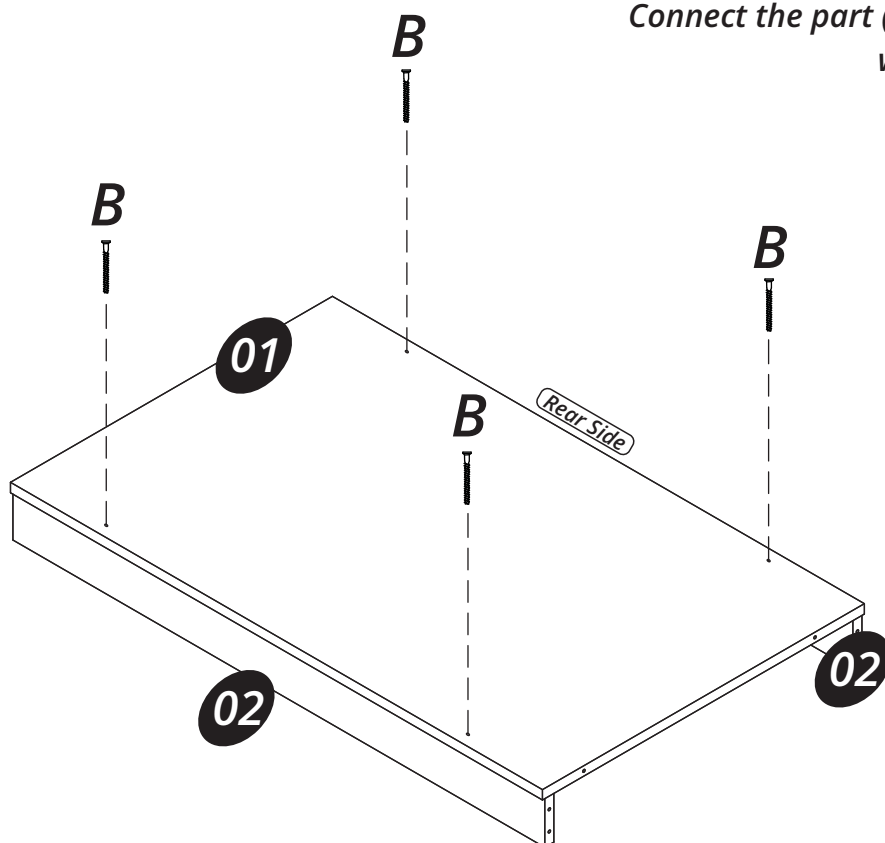

Step 05

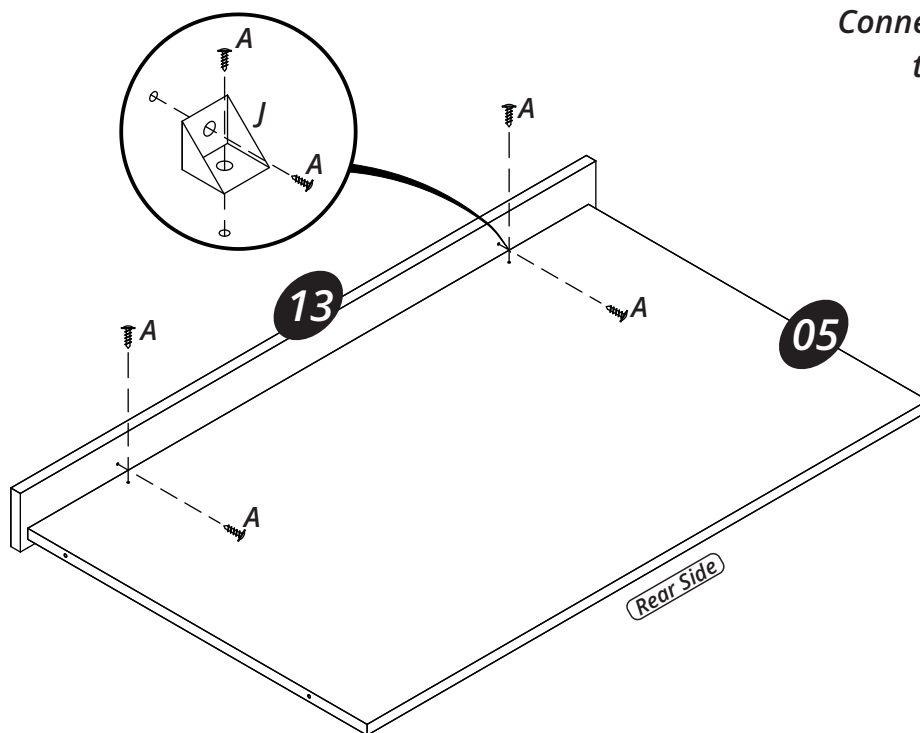

Connect the part (13) onto the part (05) with the hardware (J) and the hardware (A).

Step 06

Connect the part (01), the part (02), the part (11) and the part (05) onto the part (03) and the part (04) with the hardware (B).

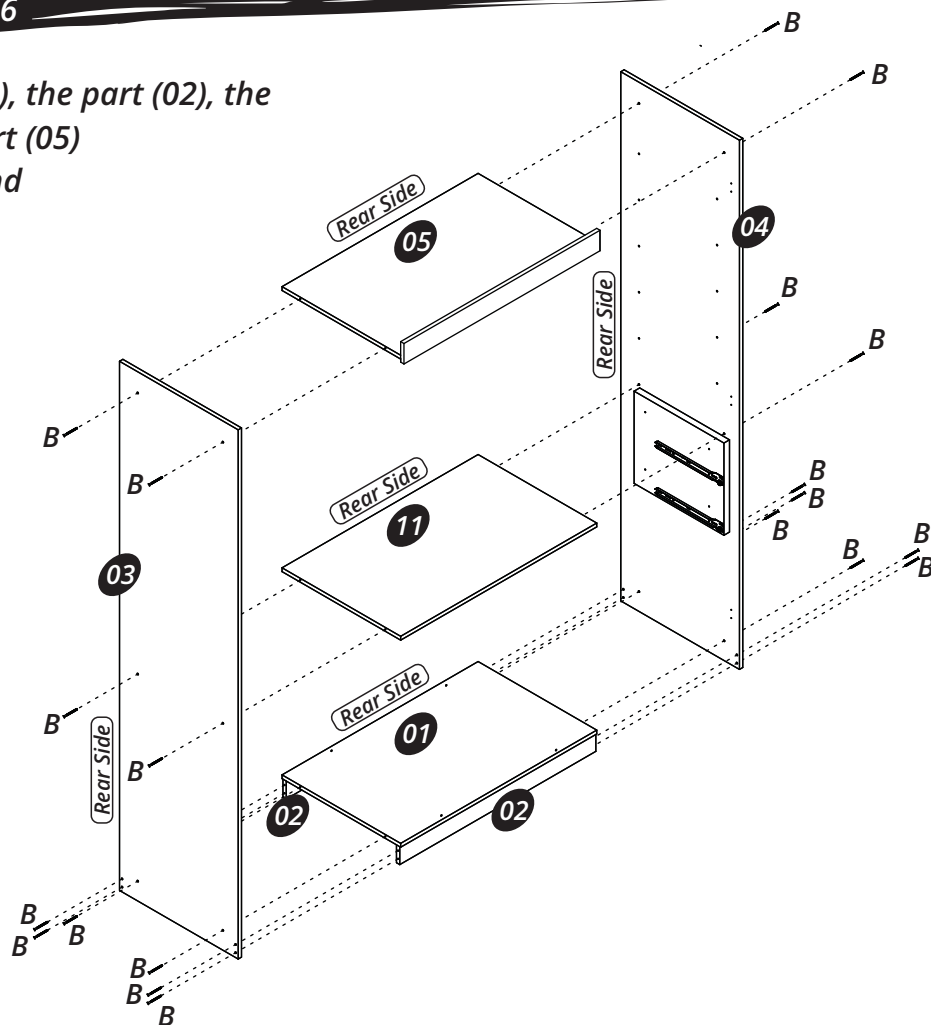

Step 07

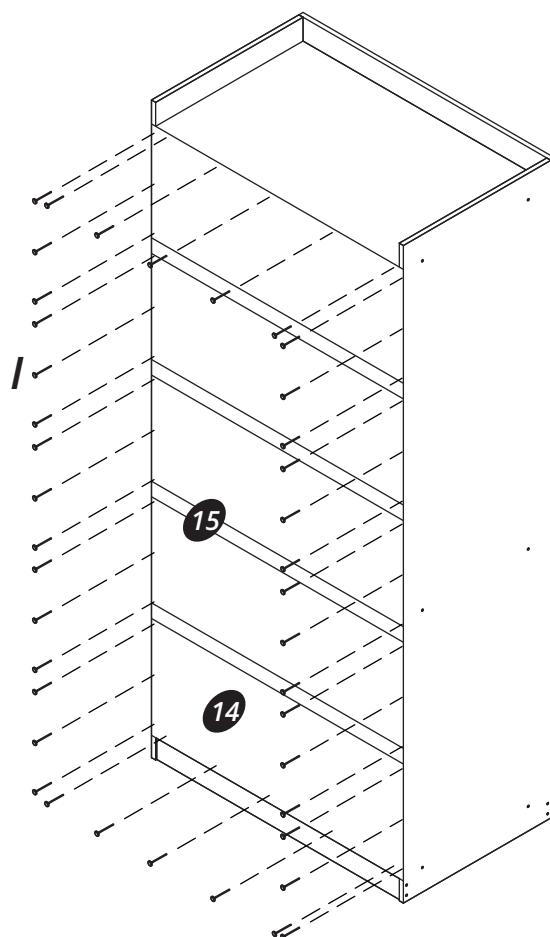

Connect all the parts (14) joining with the part (15) and the hardware (I).

Step 08

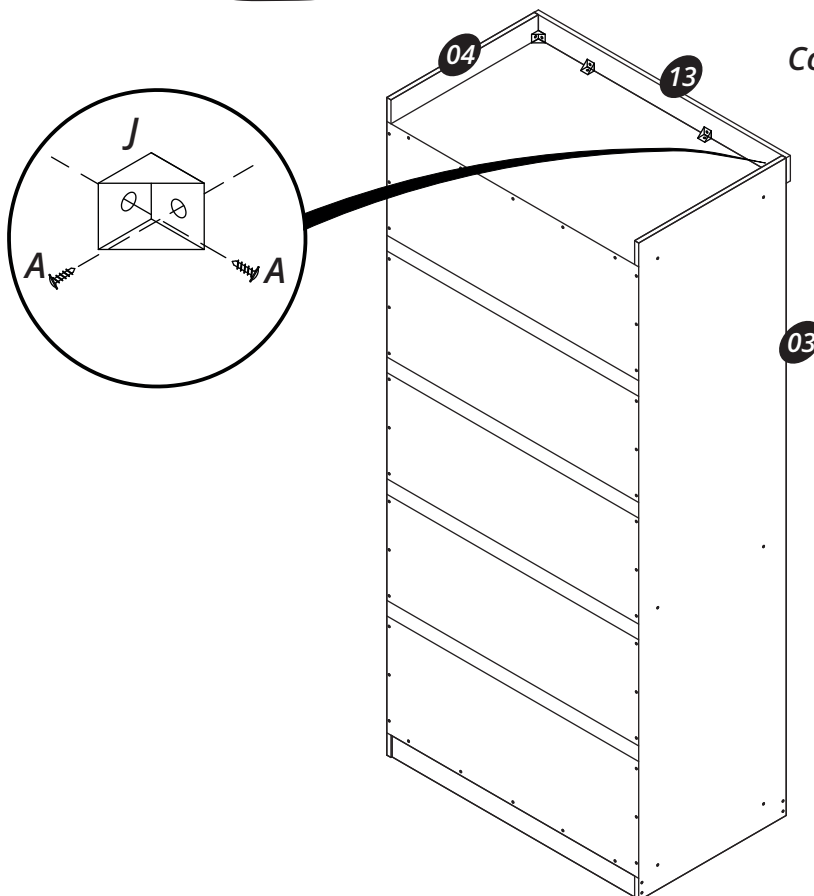

Connect the part (13) onto the part (03) and the part (04) joining the corners with the hardware (J) with the hardware (A).

Step 09

Connect the parts (07), (08) and (09) with the hardware (B).

Apply the part (10) in the groove of the parts (07) and (08) until the groove of the part (09).

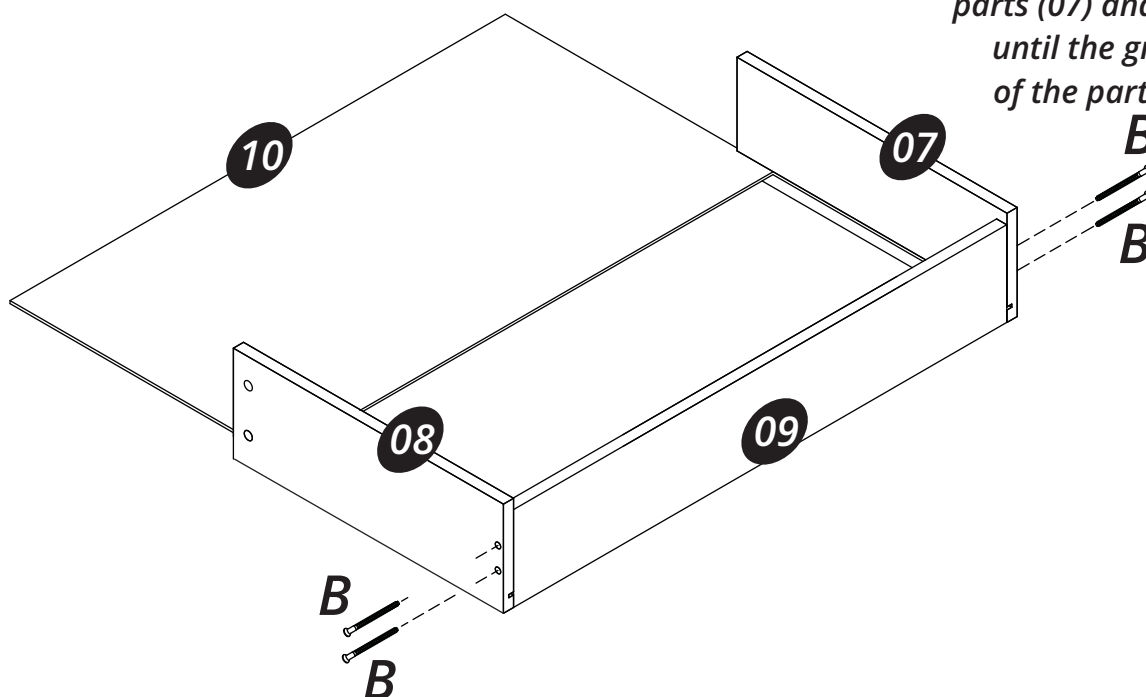

Step 10

Connect parts (07), (08) and (06) using the hardware (E + F).

Apply the hardware (M) on the hardware (F).

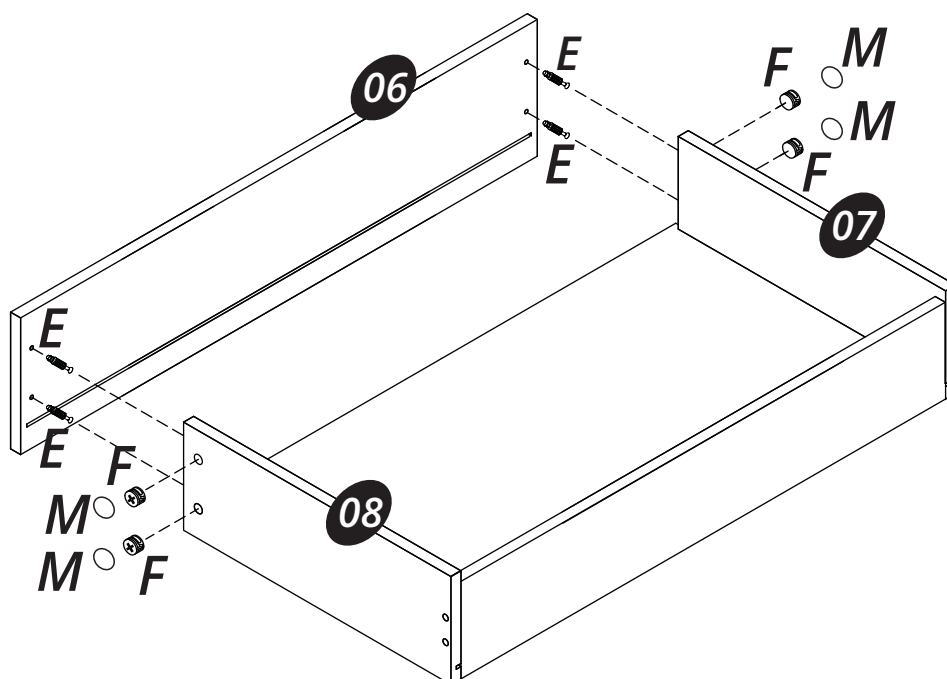

Step 11

Use the hardware (C) with the hardware (L) as shown on detail.

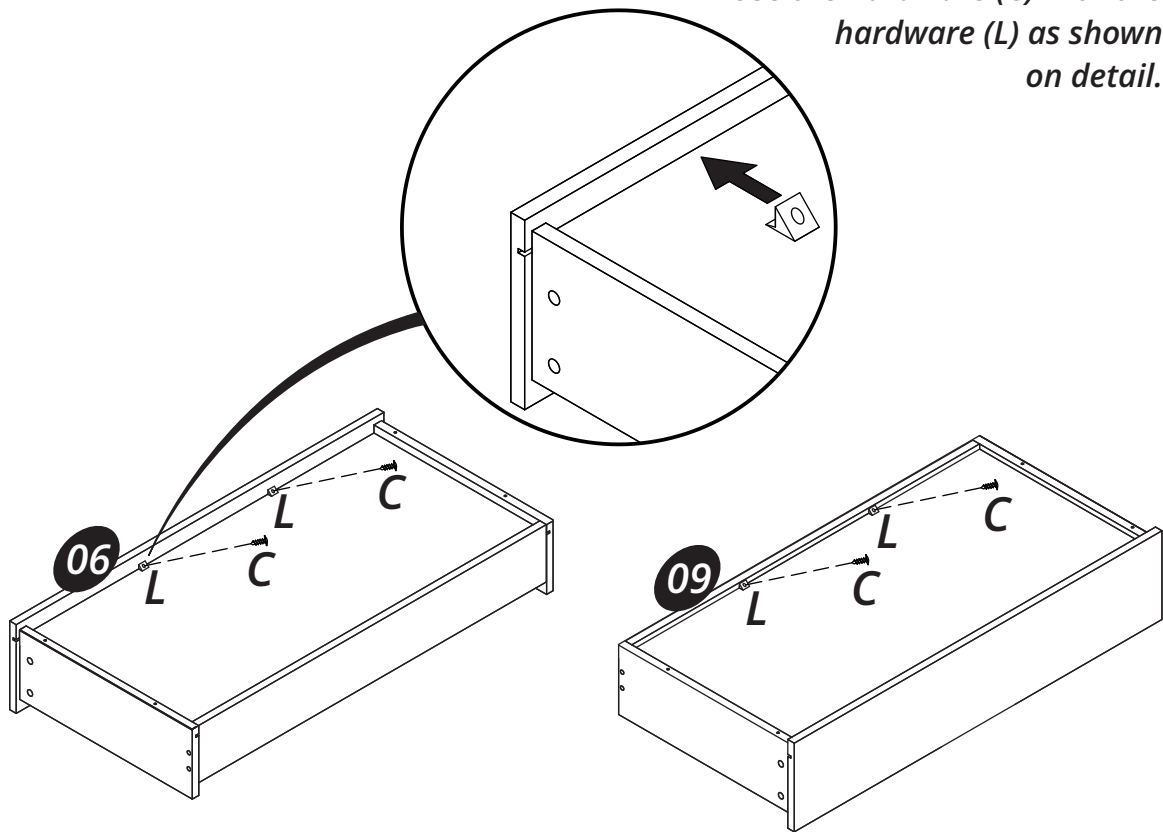

Step 12

Connect the hardware (N) onto the part (06) with the hardware (C).

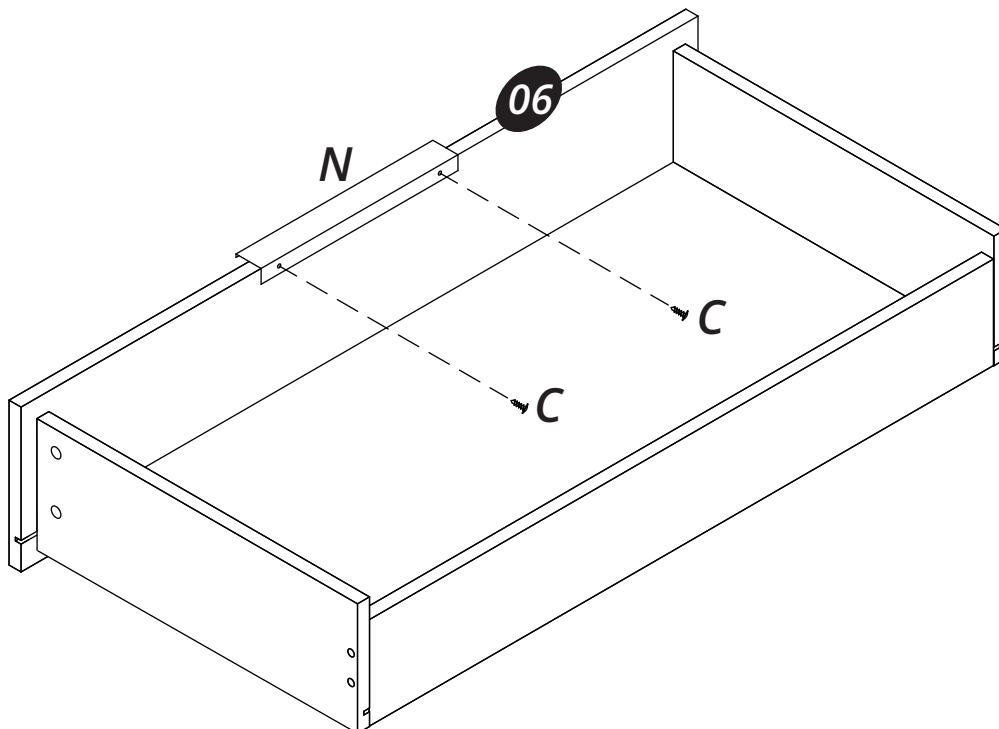

Step 13

You must apply the screws
on the holes
indicated by the arrows.

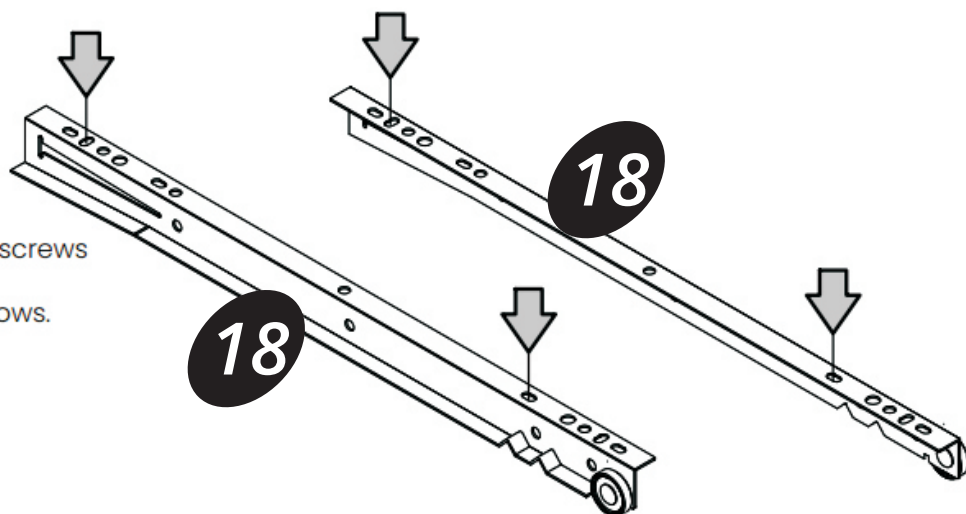

*plastic wheel always pointed
to the rear panel of the drawer
part 09.



C = 08x

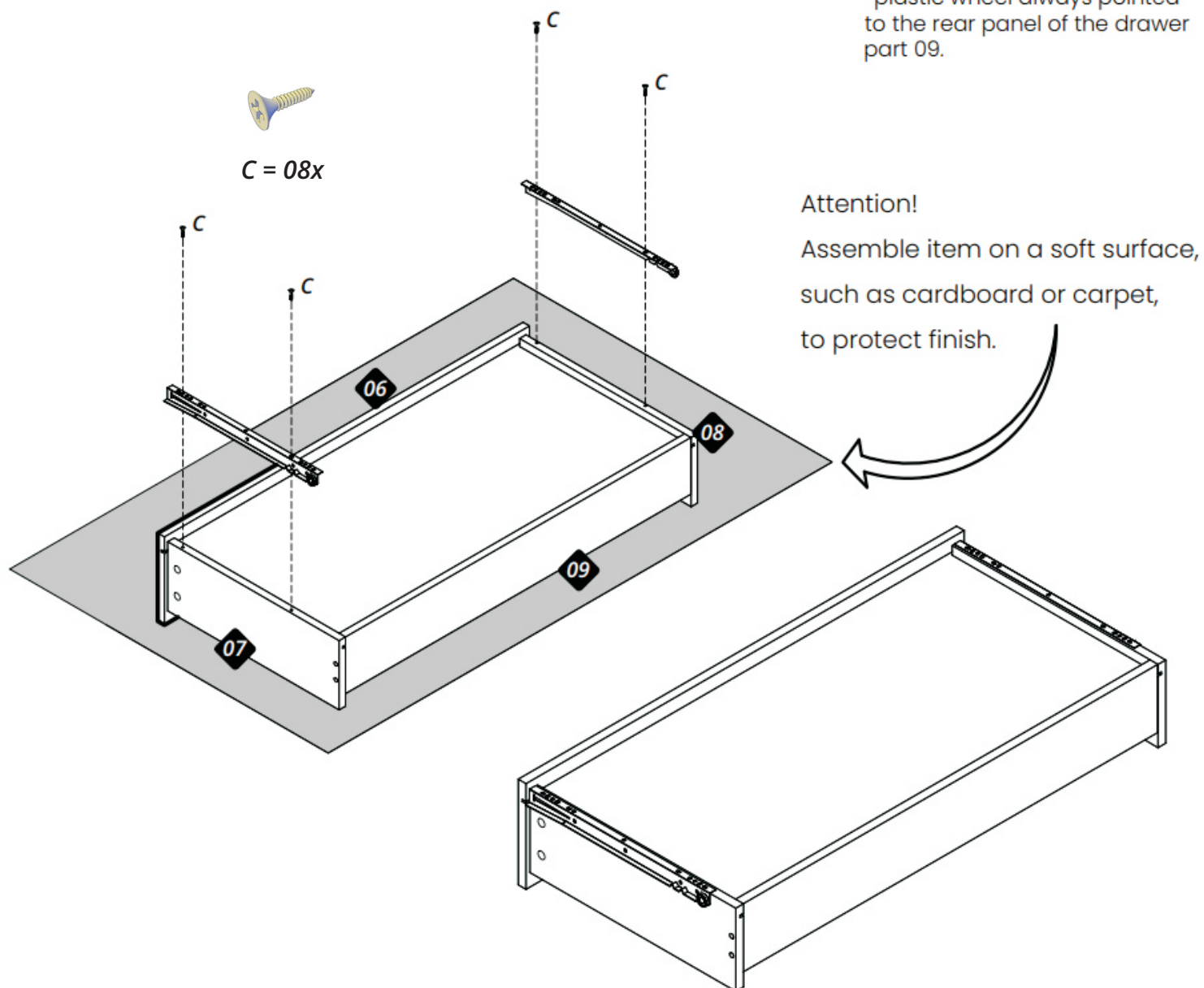

Attention!

Assemble item on a soft surface,
such as cardboard or carpet,
to protect finish.

Step 14

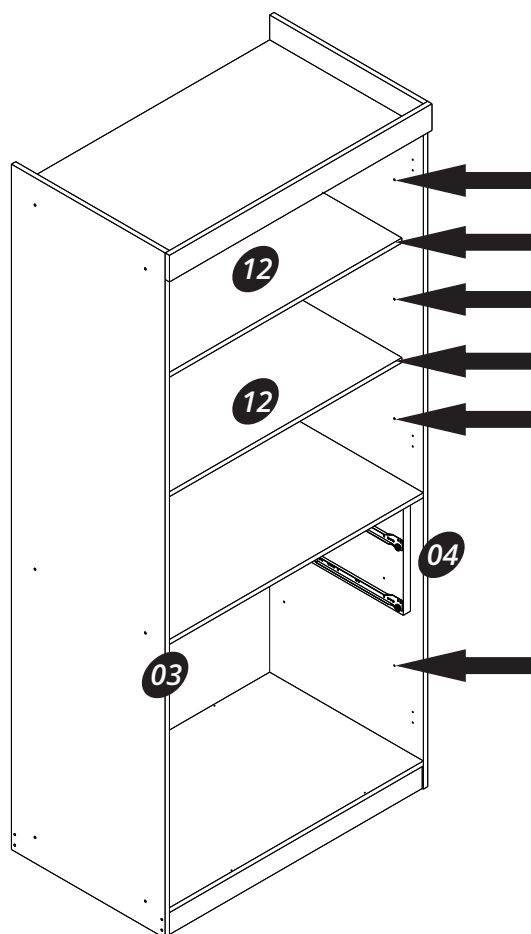

Apply the hardware (K) into the part (03) and the part (04) to support the part (12).

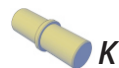

Step 15

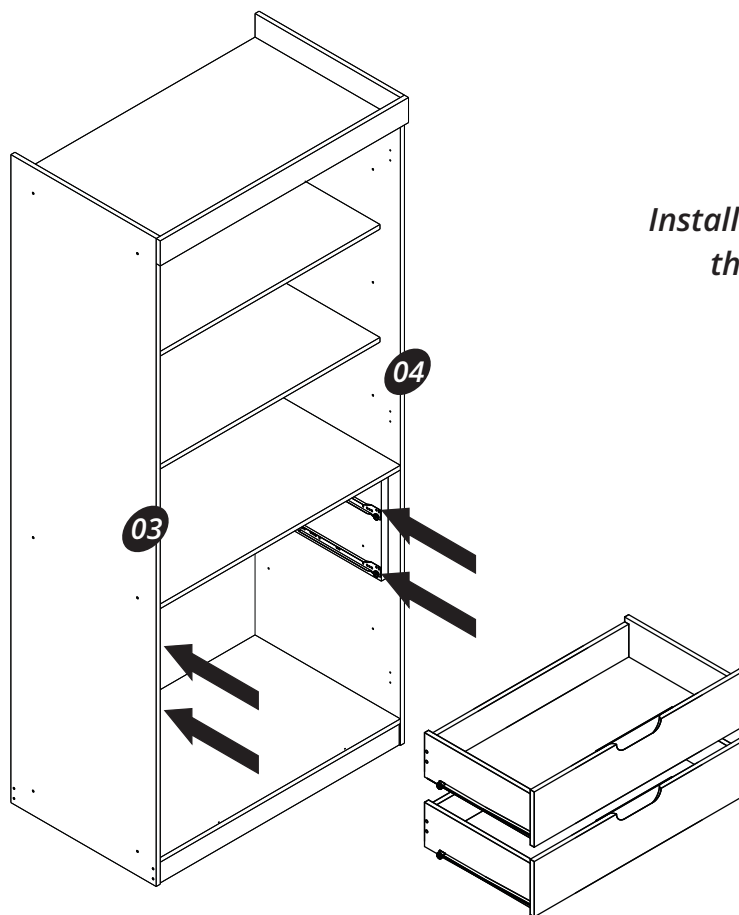

Install the drawer fitting it into the glides fixed on the side of parts (03) and (04).

Attention! Tipover System

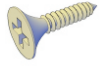

C = 04x

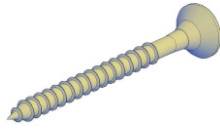

O = 02x

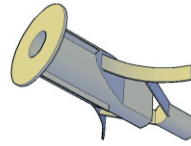

P = 02x

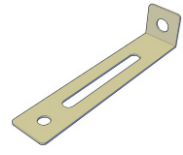

Q = 02x

wall

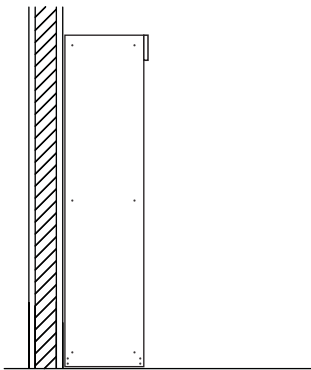

First, approach as close as possible to the wall

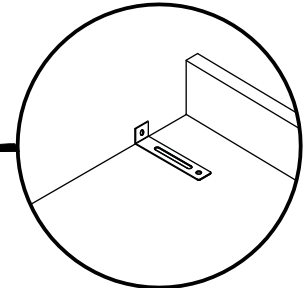
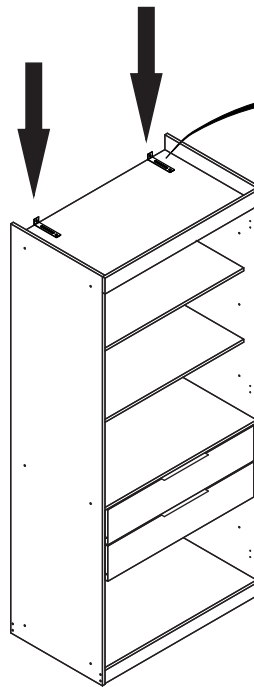

Before you fix the hardware (Q) onto the part (05) with the hardware (C), you will need a pencil to mark where you should drill the wall with a 3/8" drill bit to put in the hardware (P).

*press the hardware wings (P) to put in the hole that you drilled in the wall.

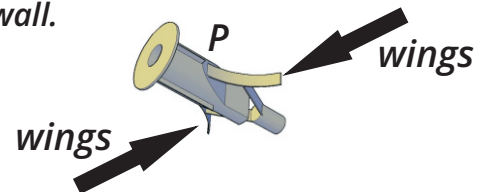

Hardware (P), plugged in the wall.

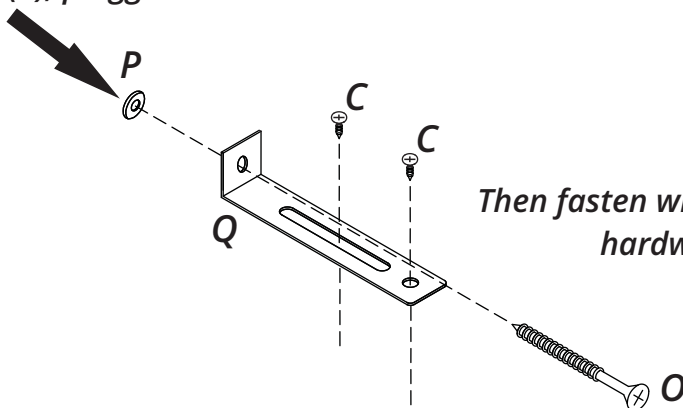

Then fasten with the hardware (C) the hardware (Q) on the part (11)



WARRANTY POLICY

All Manhattan Comfort furniture products are warranted, to the original purchaser at the time of purchase and for a period of 30 days thereafter.

Our warranty is limited to new products purchased in factory sealed cartons. This warranty is valid in the United States of America and Canada.

In order to provide you with timely assistance, please thoroughly inspect your furniture for missing or defective parts immediately after opening the carton.

Manhattan Comfort offers a 30-day parts replacement warranty on all items.

Our furniture products are not intended for outdoor use.

THE WARRANTY DOES NOT COVER:

- Defects/damages by improper assembly or disassembly.
- Defects/damages caused by shipping. Claims for damage during transit should be placed immediately to the transportation company.
- Defects/damages caused by inappropriate use of the furniture.



319 Ridge Rd. Dayton, NJ 08810
908-888-0818