

F.00661

Colors: 353/328
19 LC

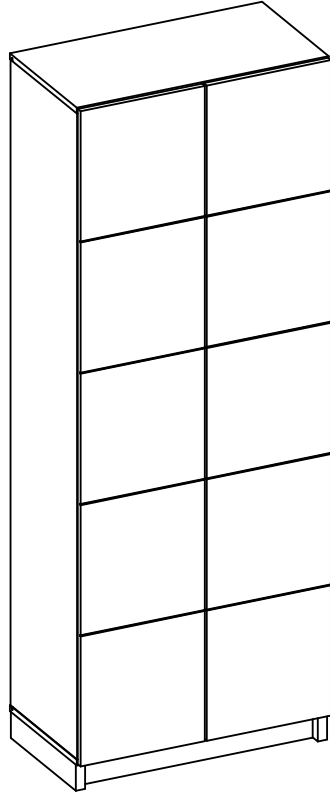

Dimensions /Dimensiones:

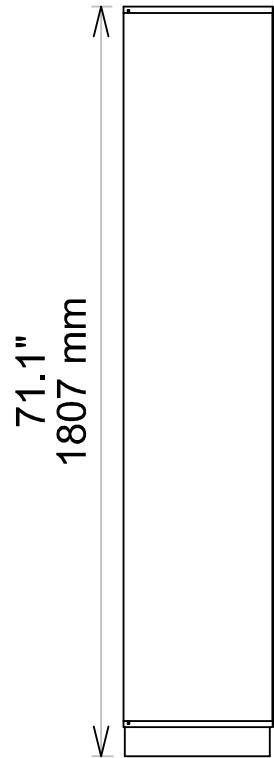
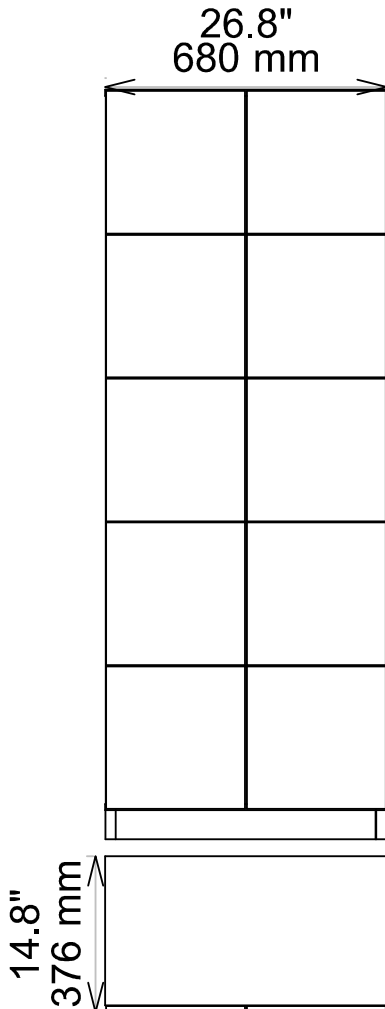

**Assembly Instructions/
Instrucciones de Montaje.**

Introduction / Introducción:

- *Read the manual and follow the steps for a perfect assembly.**
- *Prepare the environment before you start. Leave the room completely clean to start the assembly. Use the carton of the box as a protection layer to separate and protect the parts in order to avoid damages. Image 01.**
- *Don't install it in areas that may be damp, with infiltrations.**

*Observe cuidadosamente el manual y siga estrictamente los pasos de montaje.

*Antes de comenzar prepare el ambiente, dejando completamente limpio y con buen espacio para iniciar el montaje del producto. Utilice el cartón del propio embalaje, así como la protección de manta aislante para separar y apoyar las piezas retiradas de la caja. Forra el área de montaje con la manta aislante, así evita avería en la piezas durante el proceso de montaje, Image 01.

*No instalar en superficies húmedas, o con infiltraciones.

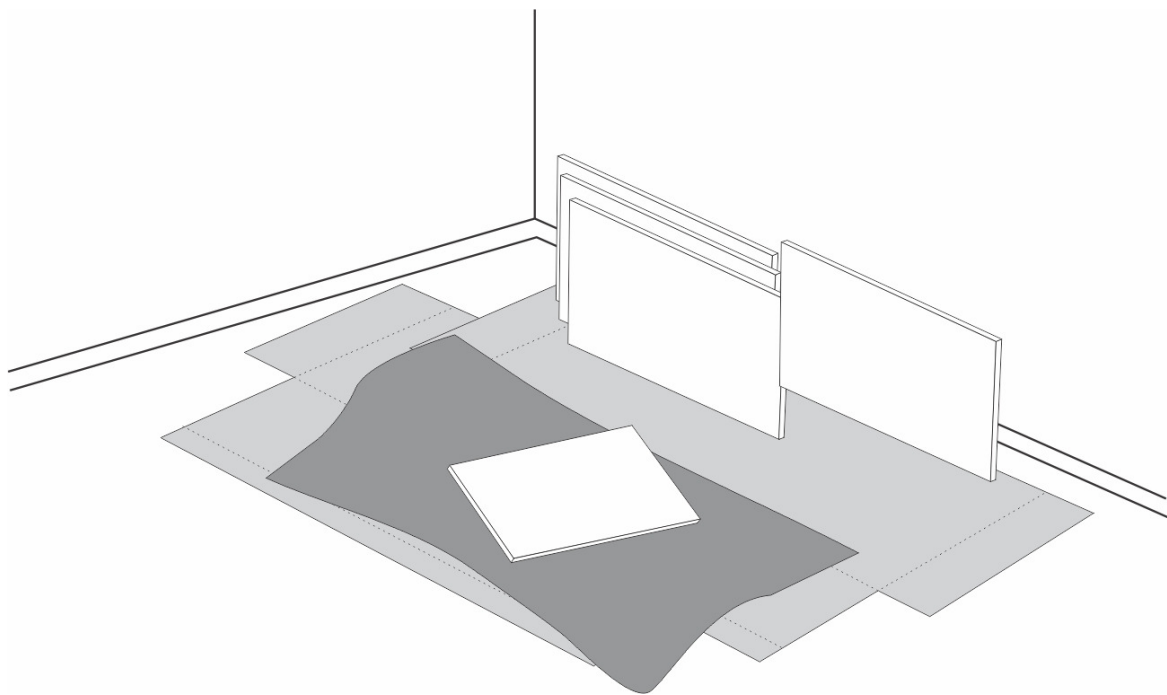

*Image 01 Separated parts / Piezas separadas

***Before beginning the assembly check all components with the parts list, separate hardware by type and assemble the furniture lying down.**

*Antes de comenzar el montaje chequea todos los componentes con la lista de piezas, separe los herrajes por tipo y arma el mueble acostado.

*** The parts come with their code stamped on.**

* Los códigos de las pieza están sellados en las mismas.

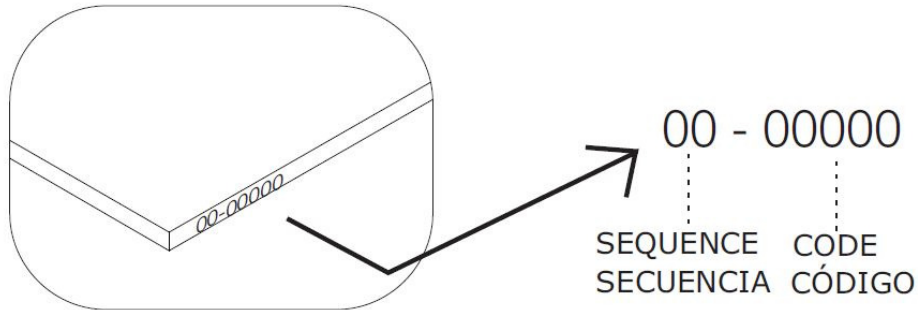

Tools / Herramientas

SCREWDRIVER

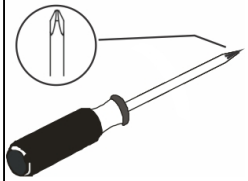

RUBBER CAUCHO



ELETRIC SCREWDRIVER

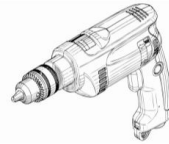

= 02

Hardwares / Accesorios



(A) = 40



(B) = 07



(C) = 11

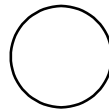

(D) = 11

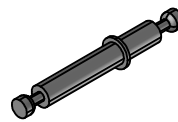

(E) = 02

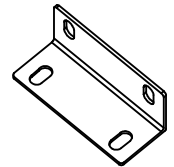

(F) = 10



(G) = 86



(H) = 16

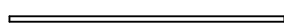

(I) = 01

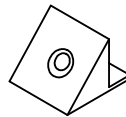

(J) = 18

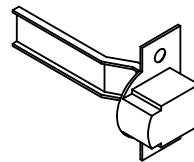

(K) = 06

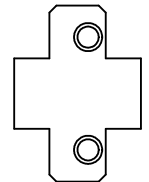

(L) = 06

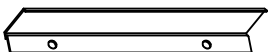

(M) = 02



(N) = 03



(O) = 04



(P) = 04

(02)

PARTS/PIEZAS

SEQUENCE	CODE	DESCRIPTION	QTY
01	90084	BACK/FRONT SKIRTING	2
02	90085	RIGHT/LEFT SKIRTING	2
03	90088	BASE	1
04	90091	TOP	1
05	90099	SHELF	4
06	90104	BACKGROUND	2
07	90105	LEFT SIDE	1
08	90106	RIGHT SIDE	1
09	90107	DIVISION	1
10	90108	PORTABLE SHELF	4
11	90109	LEFT DOOR	1
12	90110	RIGHT DOOR	1

SECUENCIA	CÓDIGO	DESCRIPCIÓN	CANTIDAD
01	90084	RODAPIÉ FRONTAL/TRASERO	2
02	90085	RODAPIÉ DERECHO/IZQUIERDO	2
03	90088	BASE	1
04	90091	CUBIERTA	1
05	90099	REPISA	4
06	90104	FONDO	2
07	90105	LADO IZQUIERDO	1
08	90106	LADO DERECHO	1
09	90107	DIVISORÍA	1
10	90108	REPISA MÓVIL	4
11	90109	PUERTA IZQUIERDA	1
12	90110	PUERTA DERECHA	1

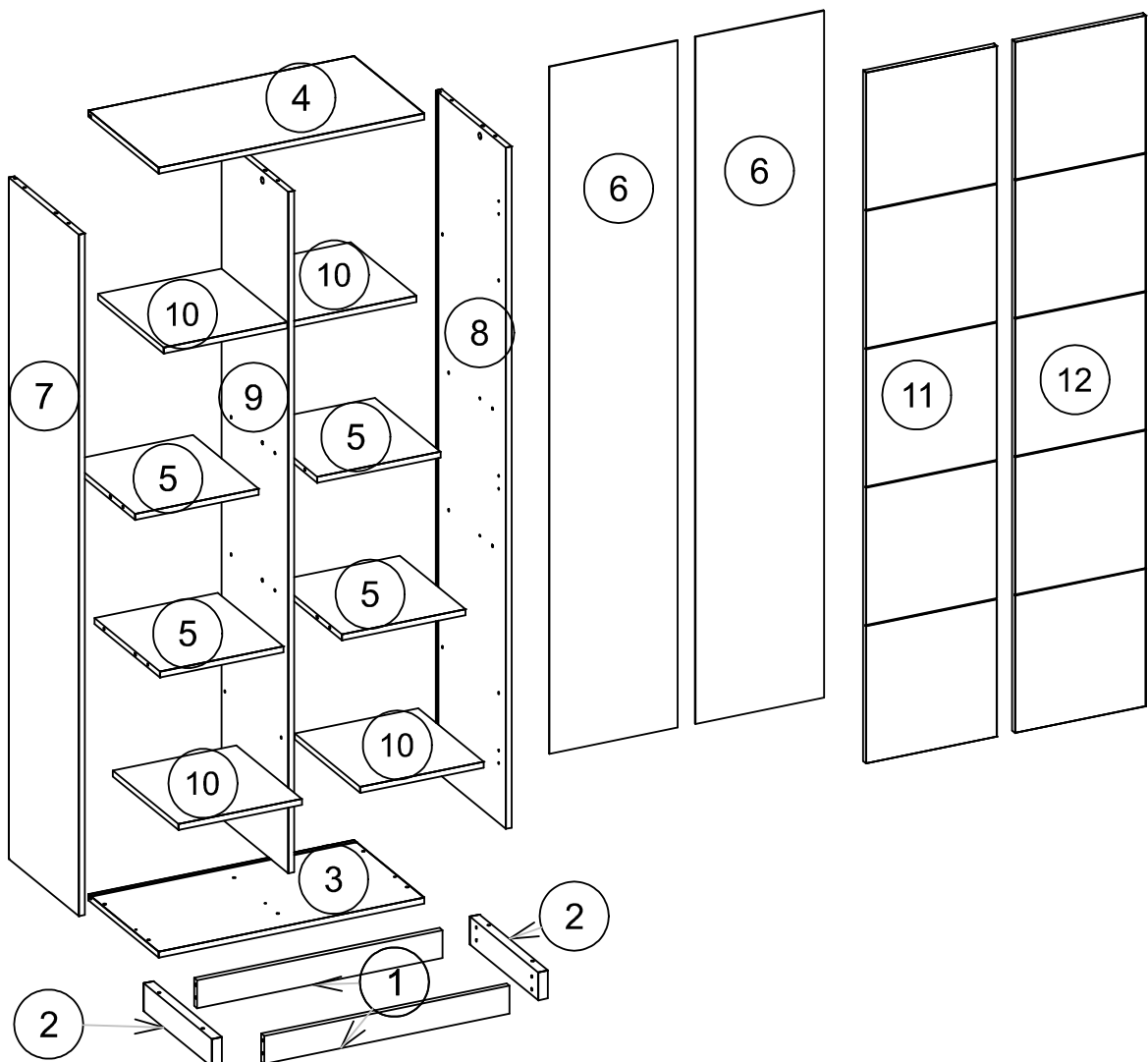

*** Before starting, you have to know:**

() You should always fix the dowel until the end using a rubber hammer.

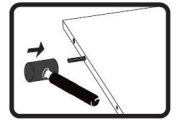

() You must screw the hardware using an electric screwdriver machine or phillips screwdriver only in the 0,196 inches hole (the smaller hole).



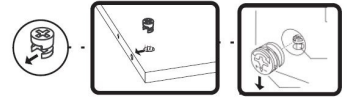

() Always fix this hardware using a phillips screwdriver, with the arrow faced to the hole.

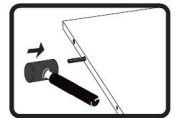

*** Antes de empezar, necesitas saber:**

() Deves siempre fijar ese accesorio hasta el final usando un martillo de caucho



() Deves siempre fijar ese accesorio usando un taladrador eléctrico o llave Phillips solamente en el agujero de 5mm.



() Deves siempre fijar ese accesorio usando llave Phillips con la seta hacia el agujero.

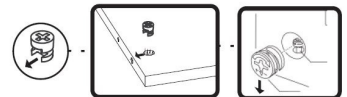

STEP/PASO 01

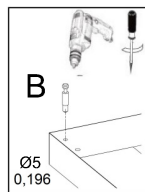
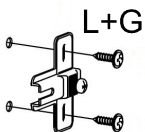

* Insert hardware "A" on the extremities of the part 08, "B", "C", "G", "L" and "H" on the face.
 * Encaja los accesorios "A" en los extremos de la pieza 08, "B", "C", "G", "L" y "H" en las caras.

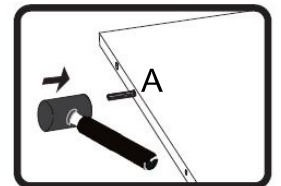
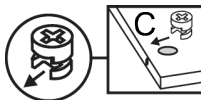
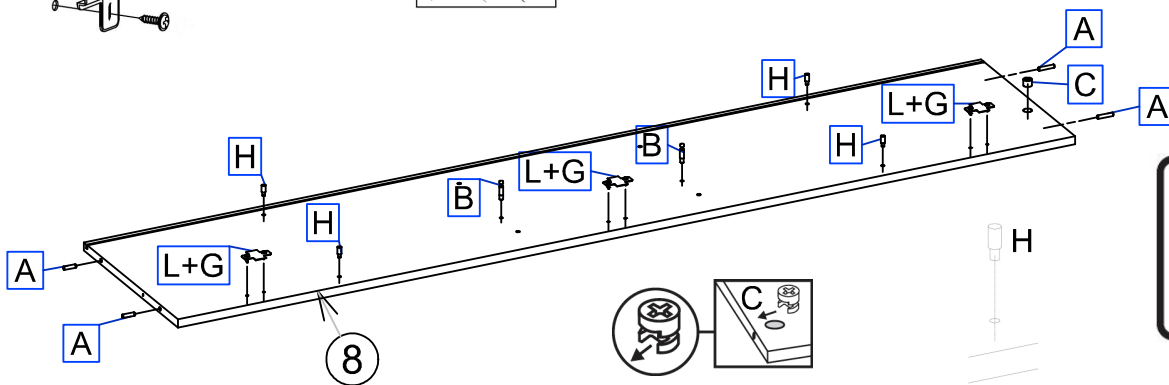

STEP/PASO 02

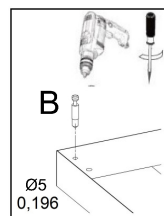
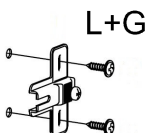

* Insert hardware "A" on the extremities of the part 07, "B", "C", "G", "L" and "H" on the face.
 * Encaja los accesorios "A" en los extremos de la pieza 07, "B", "C", "G", "L" y "H" en las caras.

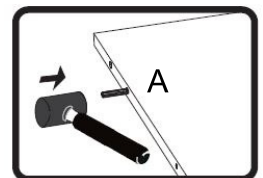
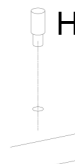
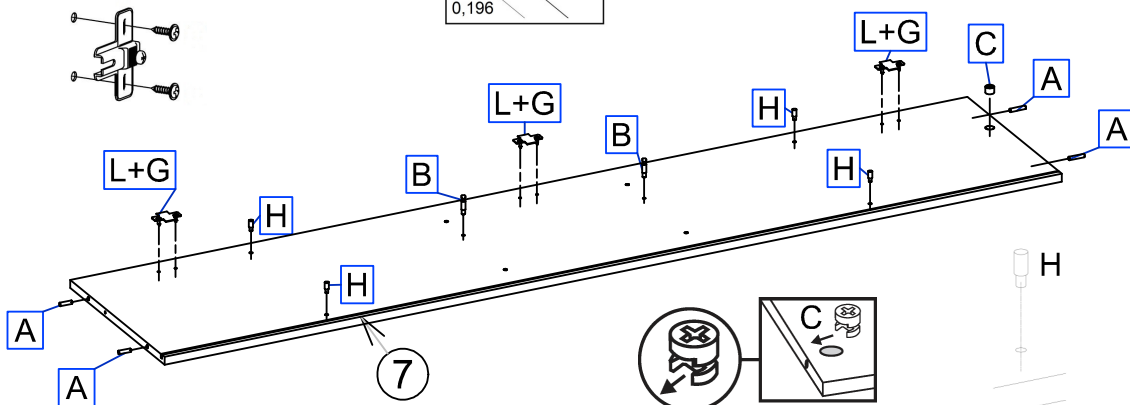

STEP/PASO 03

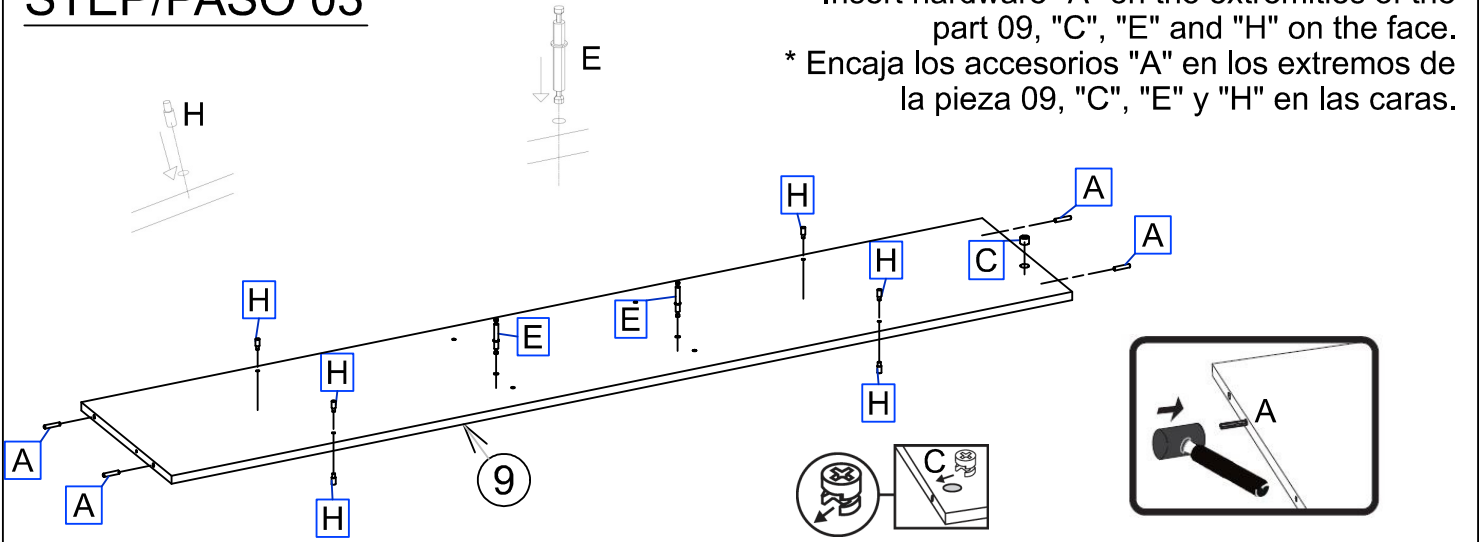

- * Insert hardware "A" on the extremities of the part 09, "C", "E" and "H" on the face.
- * Encaja los accesorios "A" en los extremos de la pieza 09, "C", "E" y "H" en las caras.

STEP/PASO 04

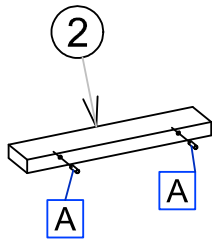

- * Insert hardware "A" on the extremities, of the part 02.
- * Encaja los accesorios "A" en los extremos, la pieza 02.

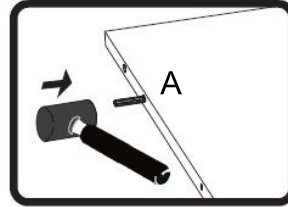

STEP/PASO 05

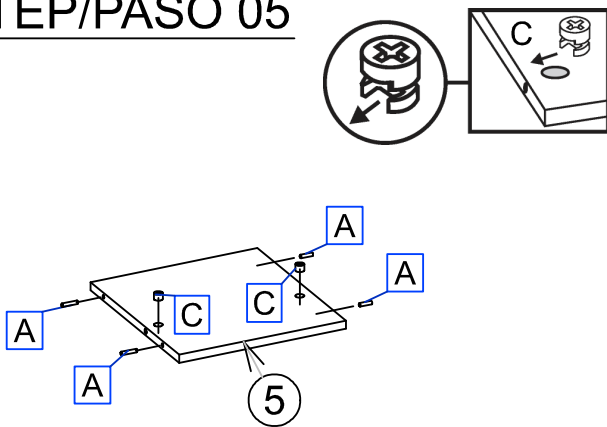

- * Insert hardware "A" on the extremities of the part 05 and "C" on the face.
- * Encaja los accesorios "A" en los extremos de la pieza 05 y "C" en las caras.

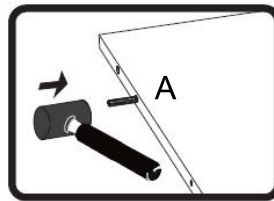

STEP/PASO 06

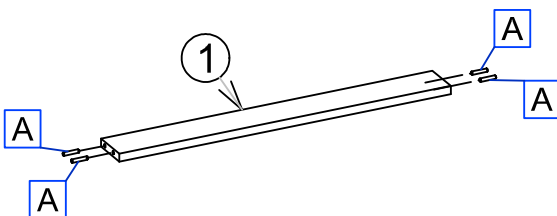

- * Insert hardware "A" on the extremities of the part 01.
- * Encaja los accesorios "A" en los extremos de la pieza 01.

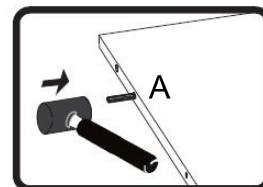

STEP/PASO 07

- * Insert hardware "G", "K" and "M" on the face and of the part 11.
- * Encaja los accesorios "G", "K" y "M" en las caras de la pieza 11.

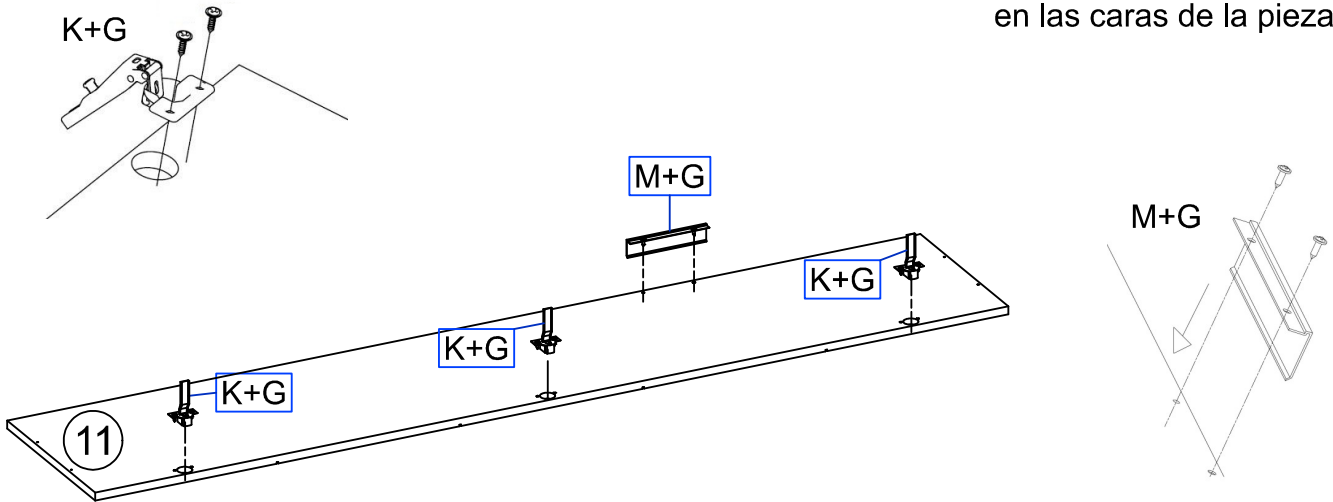

STEP/PASO 08

- * Insert hardware "G", "K" and "M" on the face and of the part 12.
- * Encaja los accesorios "G", "K" y "M" en las caras de la pieza 12.

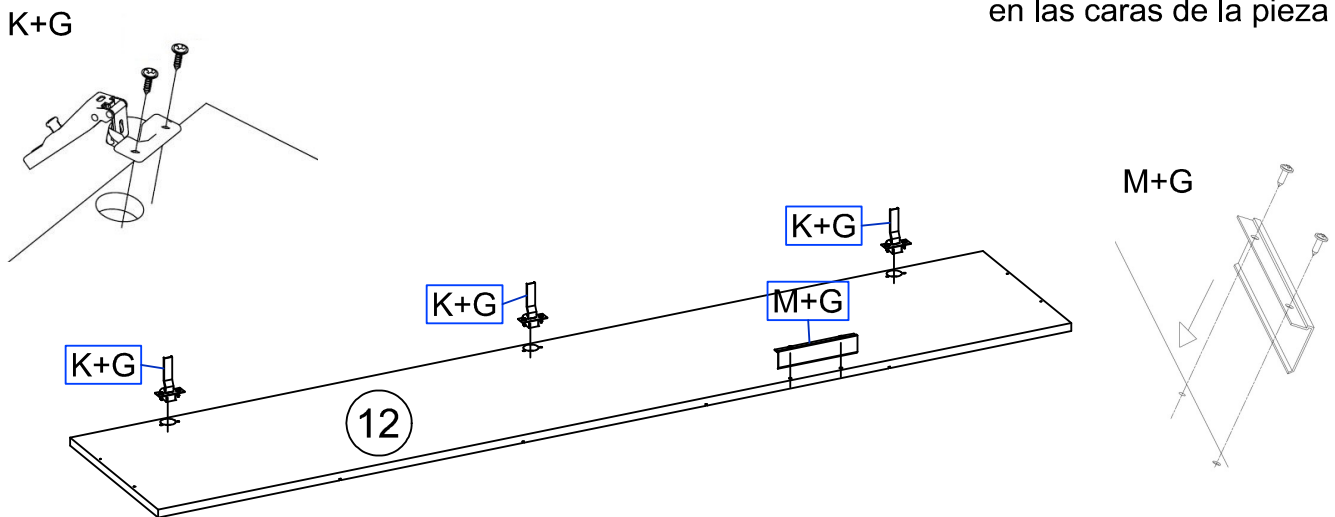

STEP/PASO 09

- * Insert hardware "B" on the face of the part 04.
- * Encaja los accesorios "B" en las caras de la pieza 04.

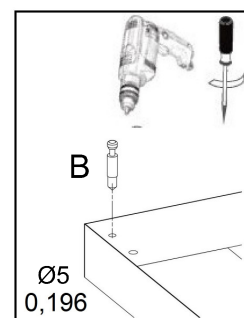
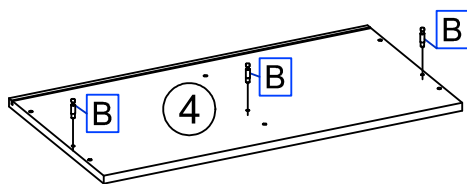

STEP/PASO 10

- * Attach parts 05 to the part 07 according to the image. Then screw the nuts "C" and finish with cover taps "D".
- * Enganche las piezas 05 en la pieza 07 de acuerdo con la image. Atonilar las tuercas "C" y terminar con las tapas "D".

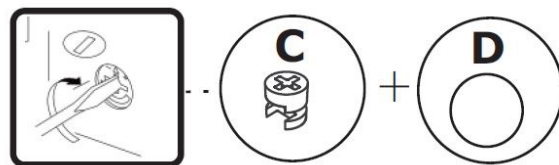
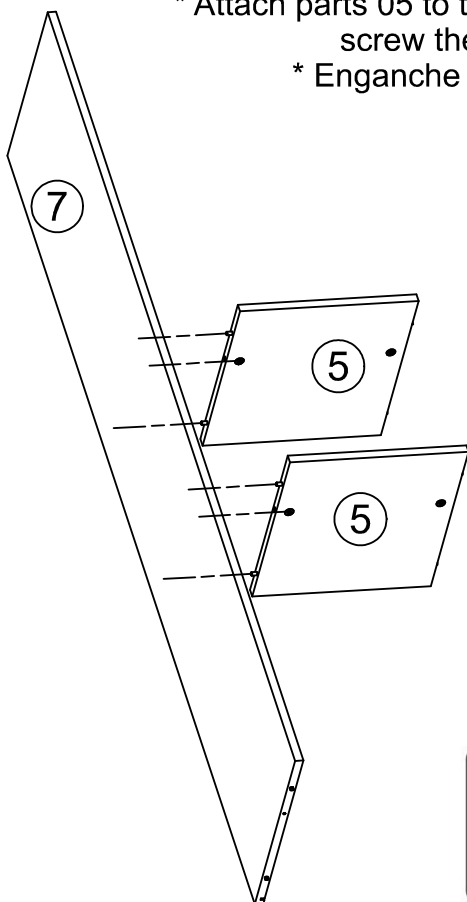

STEP/PASO 11

- * Attach part 09 to the parts 05 according to the image. Then screw the nuts "C" and finish with cover taps "D".
- * Enganche la pieza 09 en las piezas 05 de acuerdo con la image. Atonilar las tuercas "C" y terminar con las tapas "D".

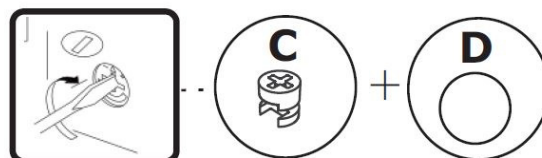
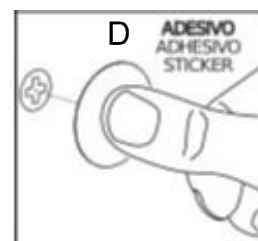
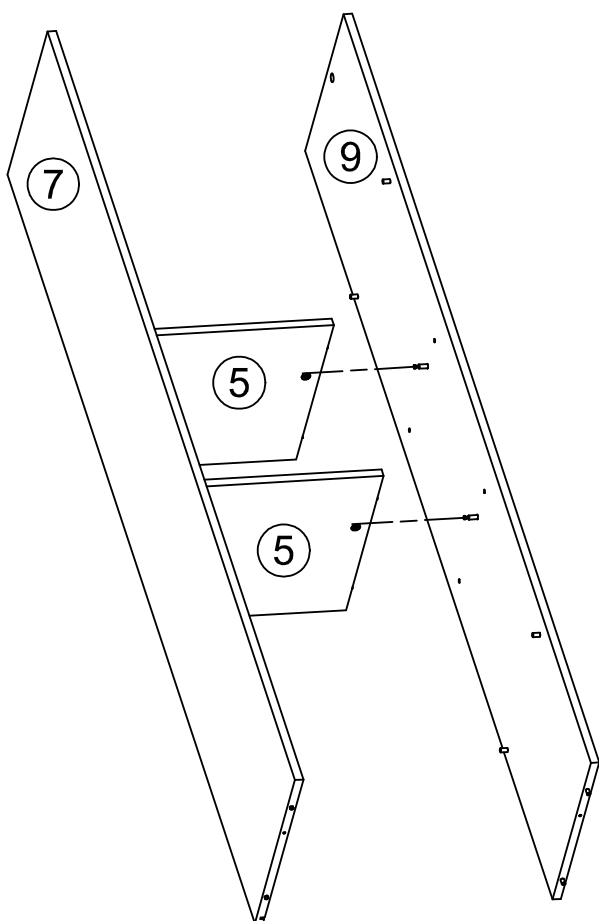

STEP/PASO 12

* Attach parts 05 to the part 09 according to the image. Then screw the nuts "C" and finish with cover taps "D".

* Enganche las piezas 05 en la pieza 09 de acuerdo con la image. Atonilar las tuercas "C" y terminar con las tapas "D".

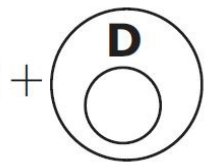
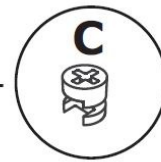
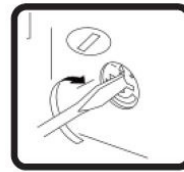
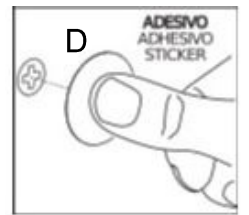
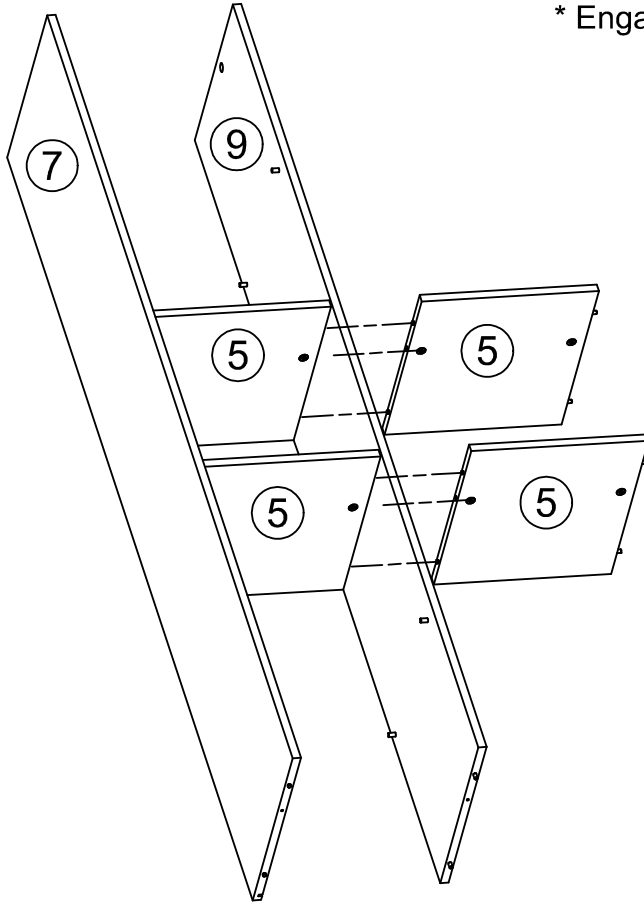

STEP/PASO 13

* Attach part 08 to the parts 05 according to the image. Then screw the nuts "C" and finish with cover caps "D".

* Enganche la pieza 08 en las piezas 05 de acuerdo con la image. Atonilar las tuercas "C" y terminar con las tapas "D".

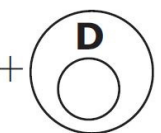
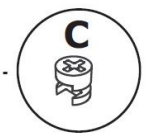
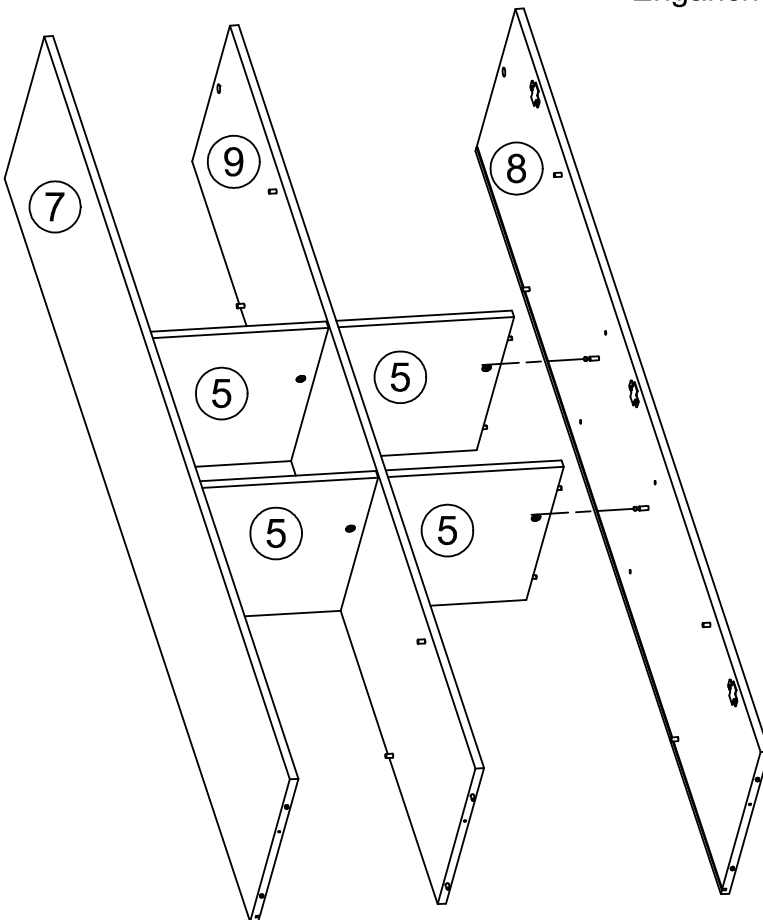

STEP/PASO 14

* Attach part 04 to the part 07, 08 and 09 according to the image. Then screw the nuts "C" and finish with cover caps "D".

* Enganche la pieza 04 en la pieza 07, 08 y 09 de acuerdo con la imagen. Atonilar las tuercas "C" y terminar con las tapas "D".

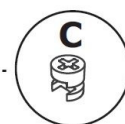
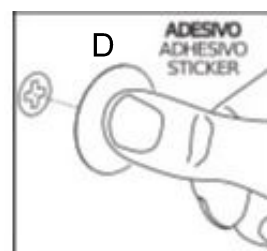
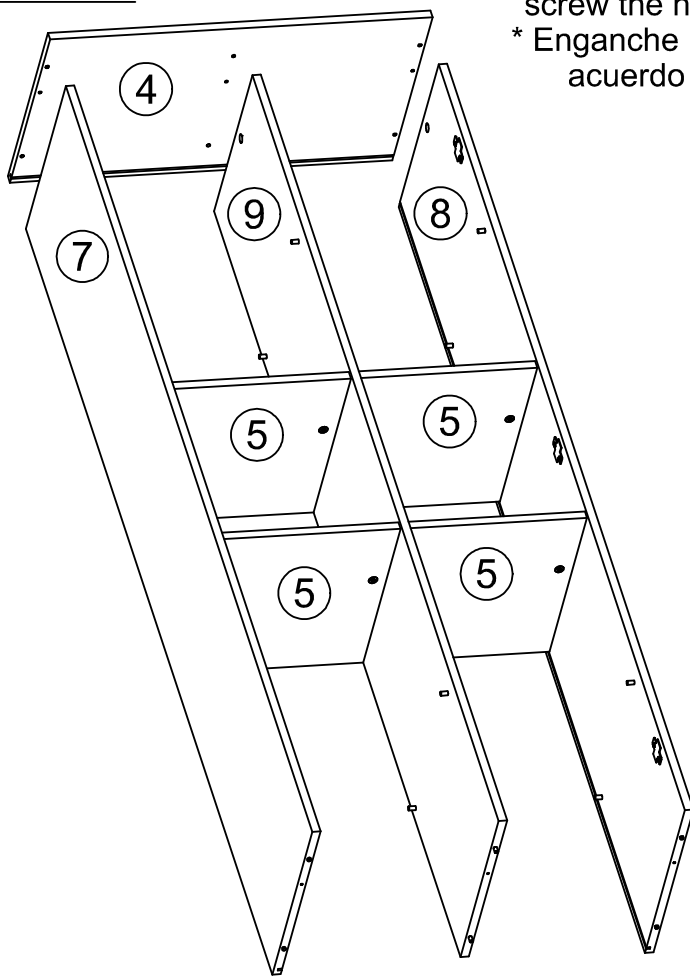

STEP/PASO 15

* Insert the parts 06 to the trail according to the image. Use the "I" to join the 06.

* Enganche la piezas 06 en el camino de acuerdo con la imagen. Usa el "I" para unirte al 06.

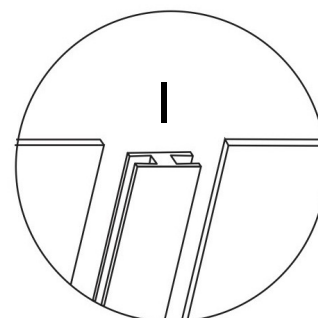
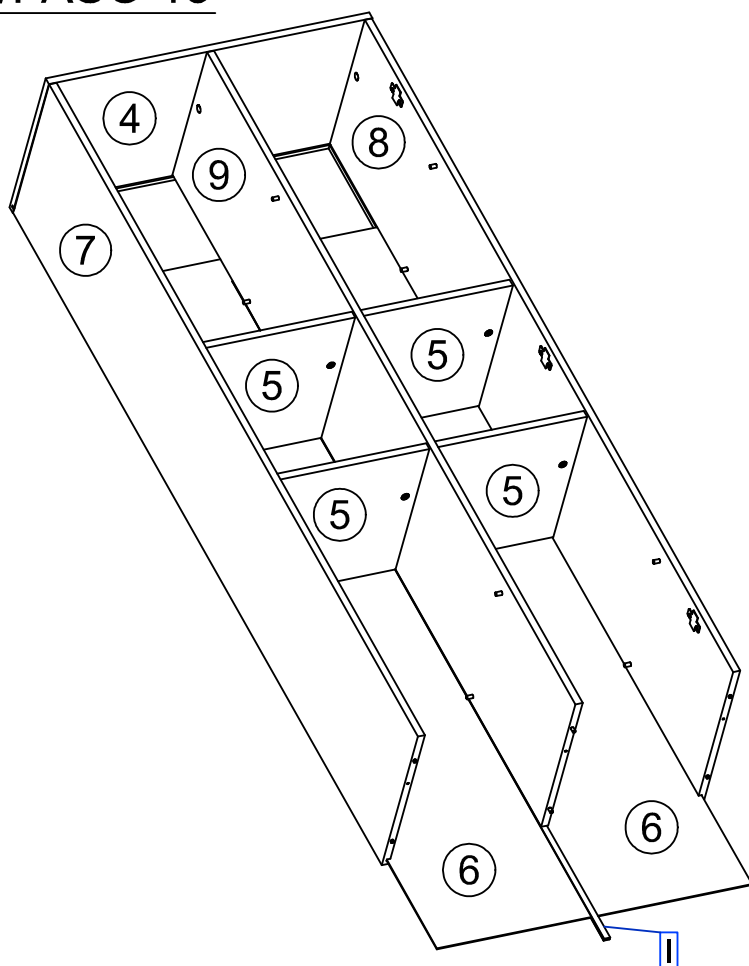

STEP/PASO 16

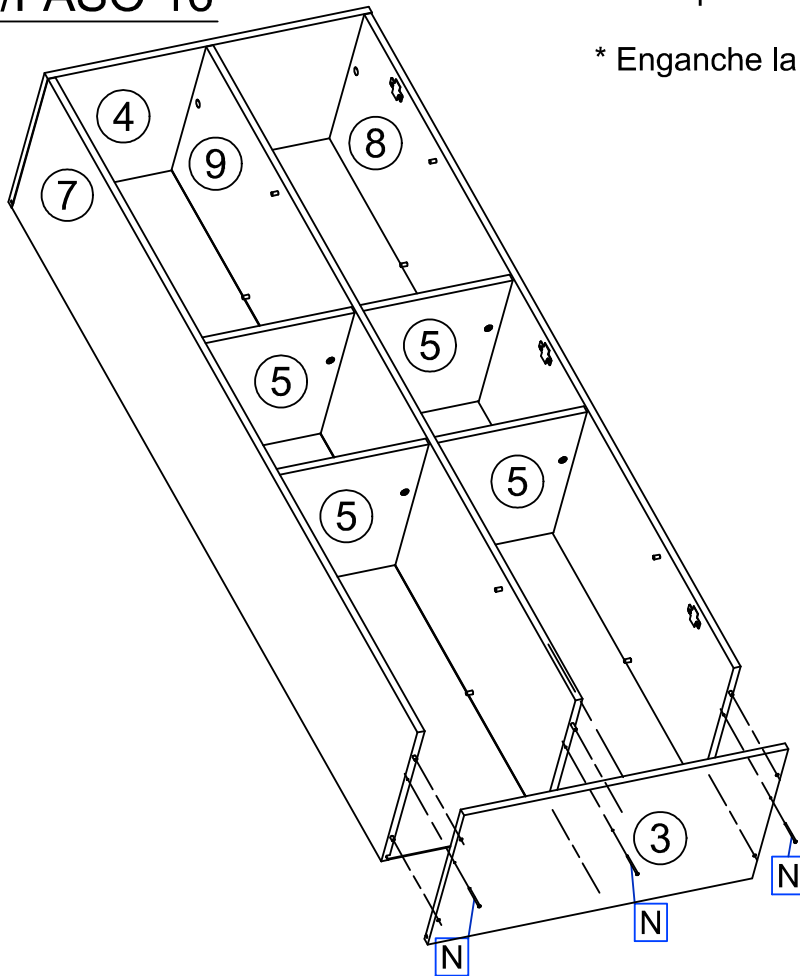

* Attach part 03 to the part 07, 08 and 09 according to the image. Then screw "N".

* Enganche la pieza 03 en la pieza 07, 08 y 09 de acuerdo con la image. Atonilar "N".

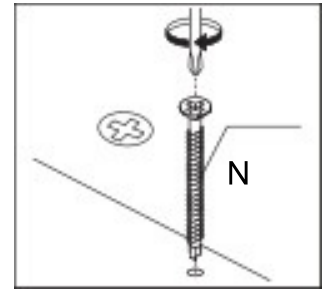

STEP/PASO 17

* Attach the parts 02 to the parts 01 according to the image. Then screw "G" in the angle connector "F".

* Enganche las piezas 02 en las piezas 01 de acuerdo con la image. Atonille "G" en el conector angular "F".

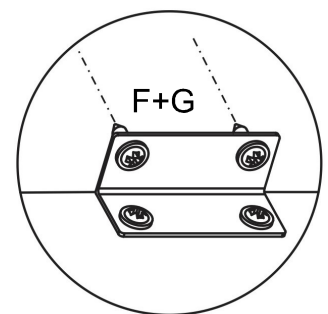
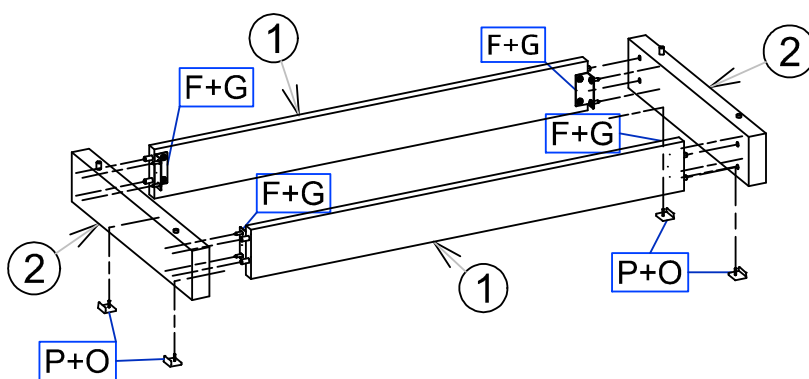

STEP/PASO 18

* Attach parts 01 and 02 to the part 03 according to the image.
Then screw "G" in the angle connector "F".

* Enganche las piezas 01 y 02 en la pieza 03 de acuerdo con la imagen. Atonille "G" en el conector angular "F".

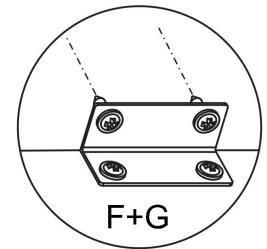
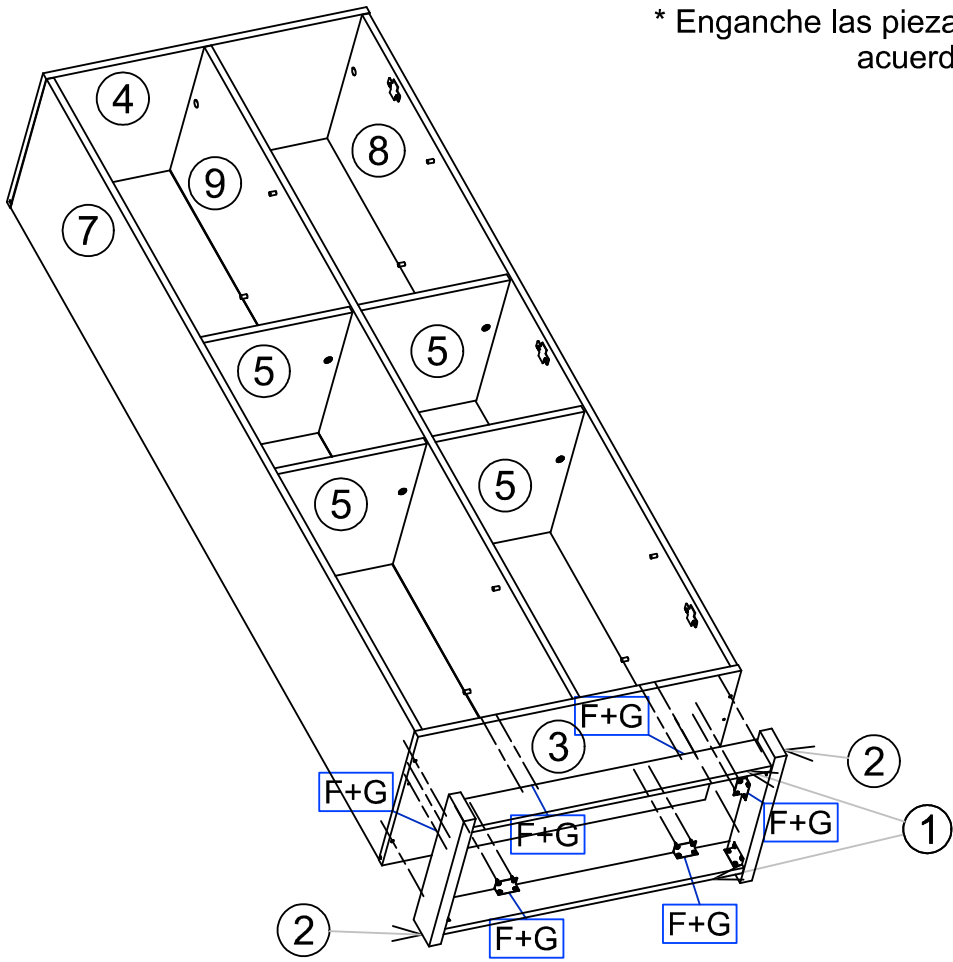

STEP/PASO 19

* Place parts 10 between the parts 07 - 09 and 08 - 09 according to the image.

* Coloque las partes 10 entre las partes 07 - 09 y 08 - 09 de acuerdo con la imagen.

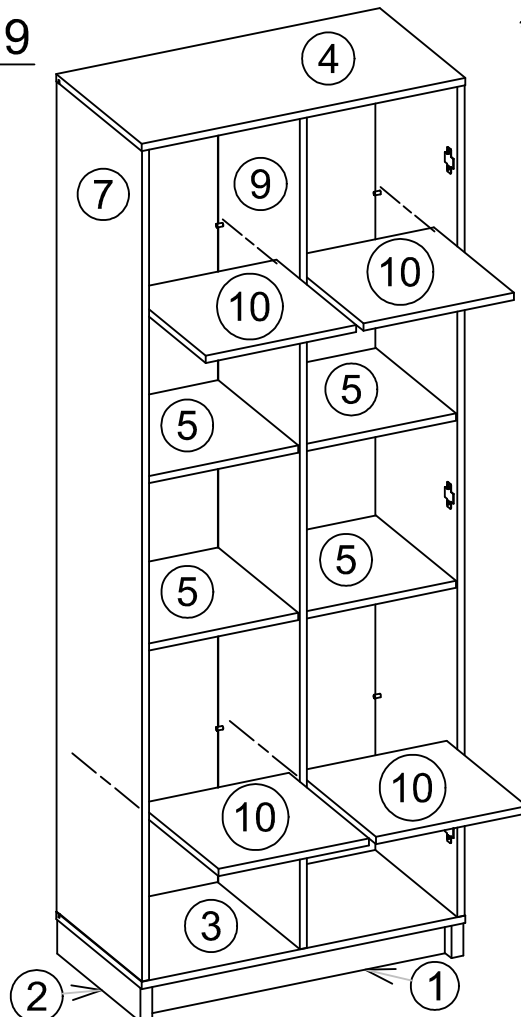

STEP/PASO 20

* Attach parts 11 and 12 to the parts 07 and 08 through the join of the hardware "L" and "K" according to the image.

* Enganche las piezas 11 y 12 en las piezas 07 y 08 a través de la unión de los accesorios "L" y "K" de acuerdo con la image.

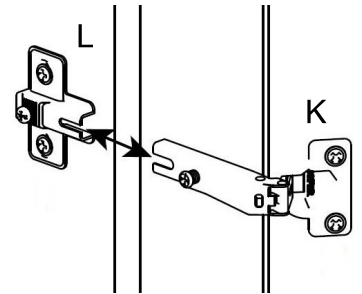
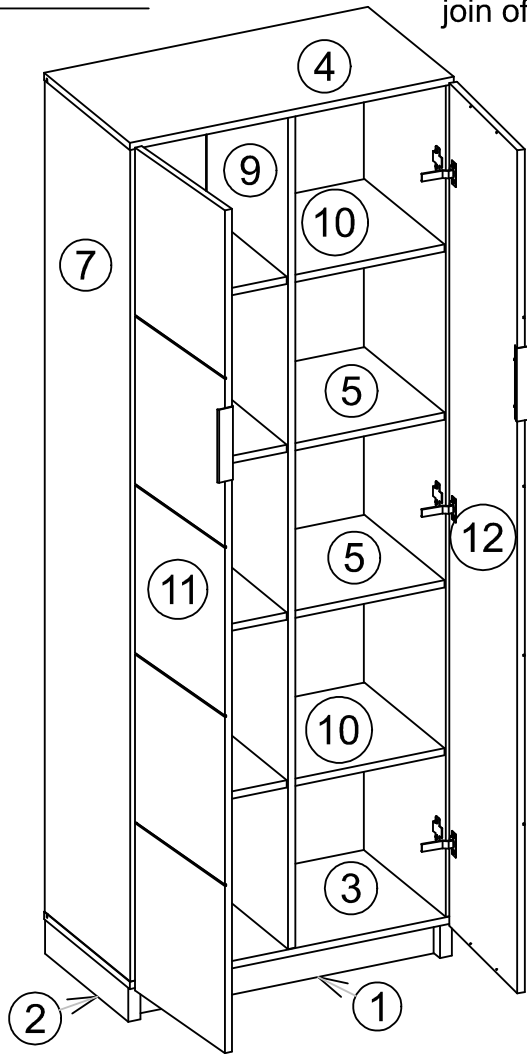

STEP/PASO 21

* Insert hardware "J" and "G" on the face of the parts 06 according to the image.

* Encaja los accesorios "J" y "G" en las caras de la pieza 06 de acuerdo con la image.

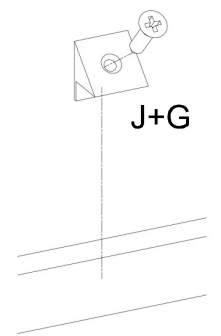
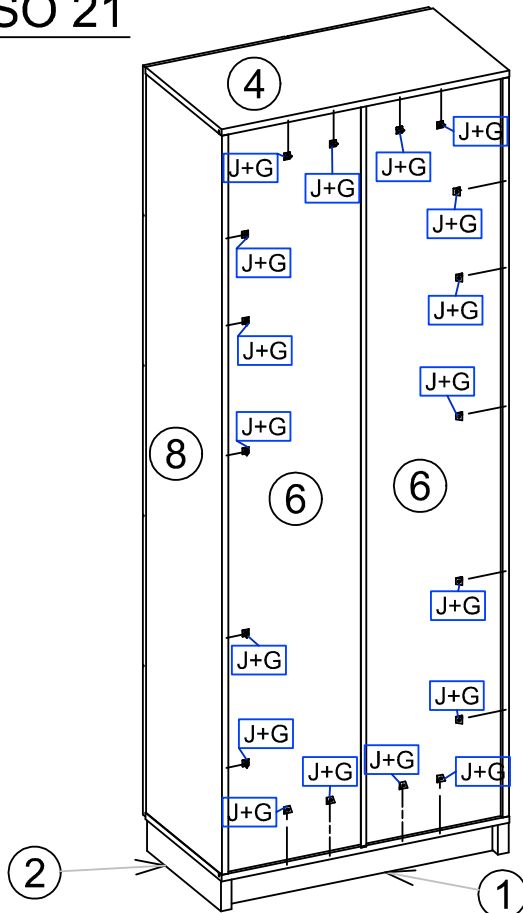

STEP/PASO 22

Warning (tipover sistem)

Atención (sistema anti-vuelco)

* **Attach the hardware Z1 using screw Z2 in the part 08. Then, drill the wall to press the wall plug Z3 in the hole, and screw Z4 to fix the mobile to the wall.**

* Enganche el accesorio Z1 usando el tornillo Z2 en la pieza 08. Entóndes perfora la pared para poner los tacos Z3 en el agujero y atornille la Z4 para fijar el móvil a la pared.

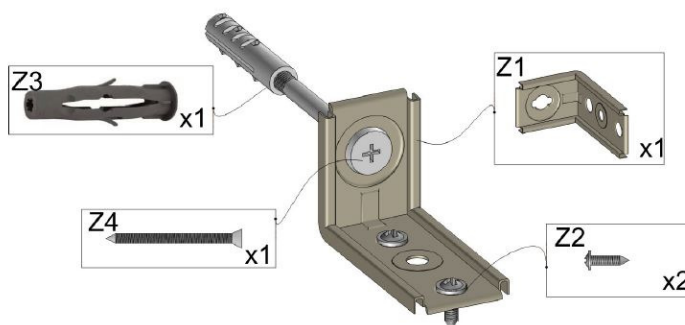
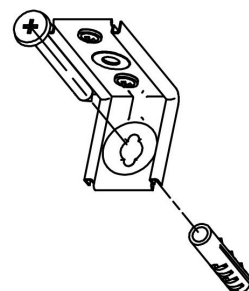
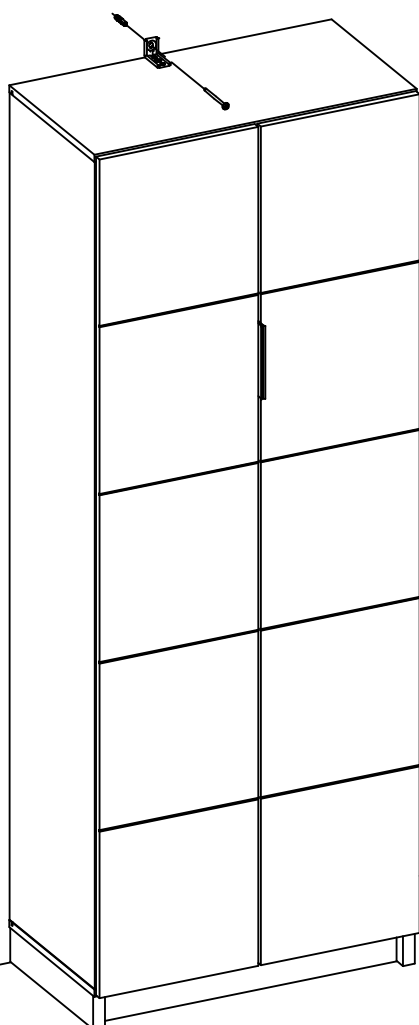

FINAL VIEW / ASPECTO FINAL

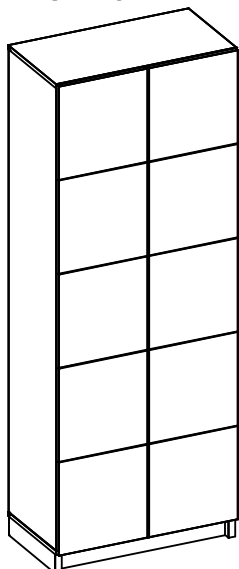

WEIGHT / PESO

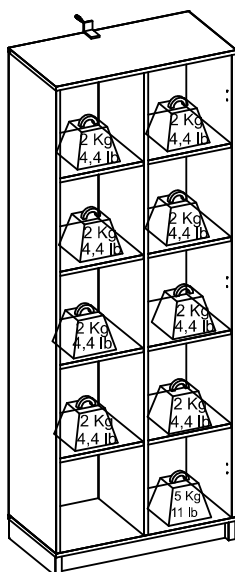

* **Be aware about maximum weights shown in the assembly instruction.**

* Todos los pesos máximos indicados en el manual deben ser respetados.

AVOID ACCIDENTS / PREVENIR ACCIDENTES

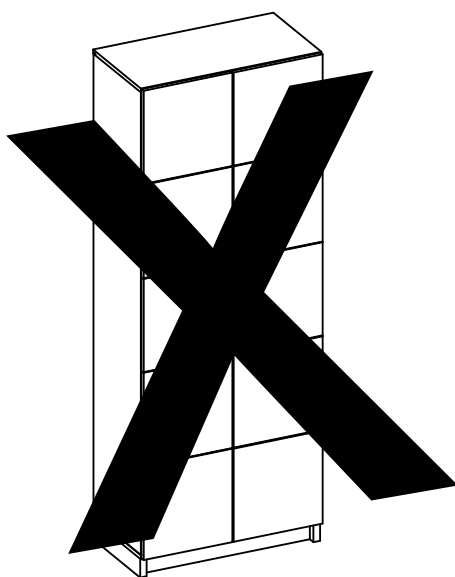

* **Don't climb or lean on the furniture.**

* No se suba ni se apoye en el mueble.

MAINTENANCE AND CLEANING / MANTENIMIENTO Y LIMPIEZA

* **For cleaning use only cloth slightly dampened in water.**

* Para la limpieza utilice sólo un paño húmedo con agua.