

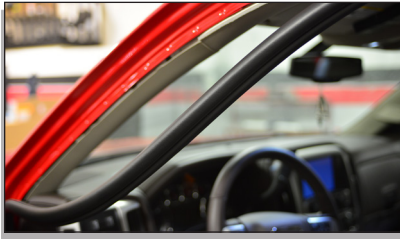

# Custom A-Pillar Pod Installation Instructions

Part#'s 33308: works on: GM Sierra/Silverado 1500  
2014+ & 2500/3500 2015+

## WHAT'S INCLUDED:



## STEP 1:

Pull the door weatherstrip down and away from the trim. Now, remove the factory A-pillar by pulling towards you..



## STEP 2:

Release clip by pressing down, then forward.

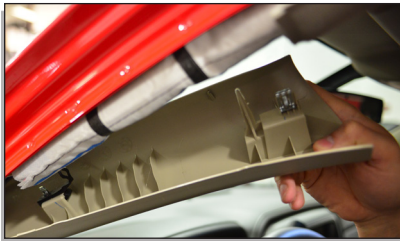

## STEP 3:

The clip will slide off of pillar, allowing it to be removed.



## STEP 4:

Insert the supplied well nut into the slot as shown and be sure to fully seat. Well nut position may need to be adjusted before securing with the screw in step 6.

## STEP 5:

If installing another tuner install the appropriate pod adapter at this time. LWTS+ requires part # 30604 and GTX requires part # 30605, which is not included. Follow instructions on installing the located on the inside of the packaging card. If you have stock speakers be sure to reconnect them at this time.

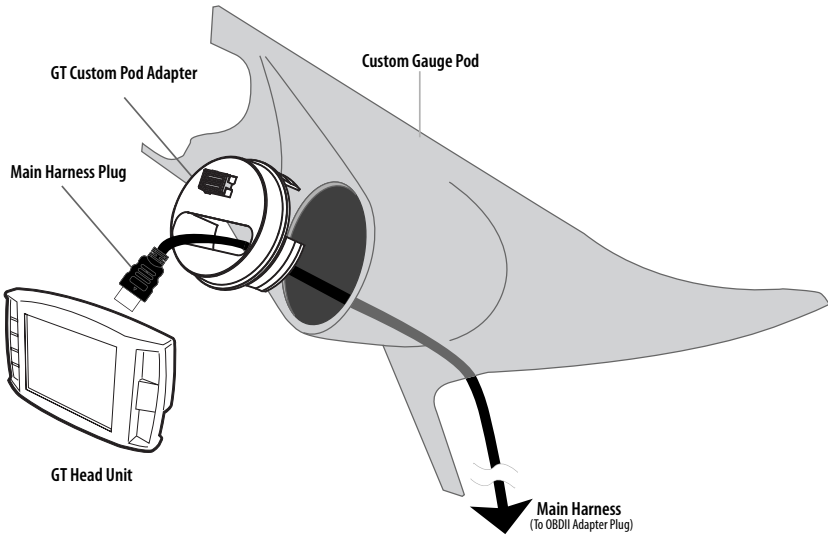

## STEP 5:

Install the bottom portion of the pillar and screw into the well nut. Finally reinstall the weather stripping.

