



# Custom A-Pillar Pod Installation Instructions

Part# 31306: Works On: Ford 6.7L Super Duty 2011- 2016

## WHAT'S INCLUDED:

A-Pillar Pod

Screw

Pod Adapter



## STEP 1:

Place flat head screwdriver in the middle of each side of the cap and open cap, taking care not to damage stock A-pillar.

## STEP 2:

Using a 7mm socket with extension and ratchet; unscrew the two bolts securing the stock A-pillar where the caps were opened up. Loosen them all the way and remove stock A-pillar.



## STEP 3:

Pull back weather stripping in the area of the A-pillar and remove the side panel of the dash by the driver door.

## STEP 5:

If installing another tuner install the appropriate pod adapter at this time. LWTS+ requires part # 30604 and GTX requires part # 30605, which is not included. Follow instructions on installing the located on the inside of the packaging card. If you have stock speakers be sure to reconnect them at this time.

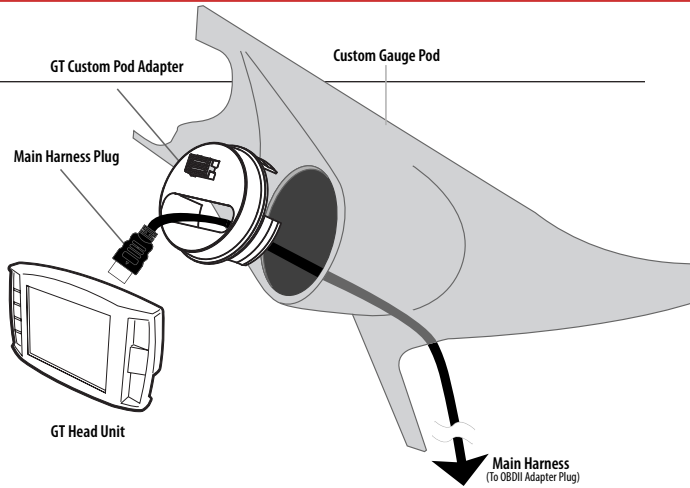

## STEP 6:

Install the custom gauge pod by first aligning the tab into the slot on dash. Guide custom gauge pod so the screw hole lines up with the stock screw hole. Secure using the supplied screw, not the stock screw.

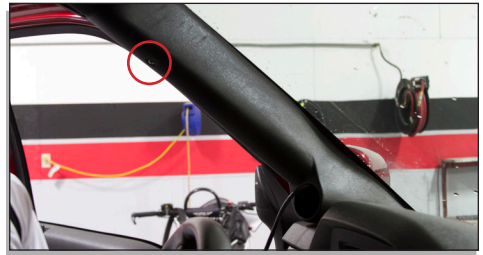

## STEP 7:

Secure the weather stripping, install the side panel and the job is finished. Secure the weather stripping, install the side panel and the job is finished.

