

PRODUCT DATA SHEET

Product Description: Keyless mechanical single sided door lever set with auto-locking function for use with residential and commercial doors. No batteries or low voltage power required. Code change without removing lock from door. Fits standard residential and commercial door preparation with 2 1/8" cross bore, 2 3/4" or 2 3/8" backset. 2 3/4" latch included, 2 3/8" latch sold separately (#MPBCLMB60MM). Most applications require four 3/8" through bolt holes to be drilled; template included. Two back up Schlage SC4 keys included. ADA compliant. Ships with mounting hardware.

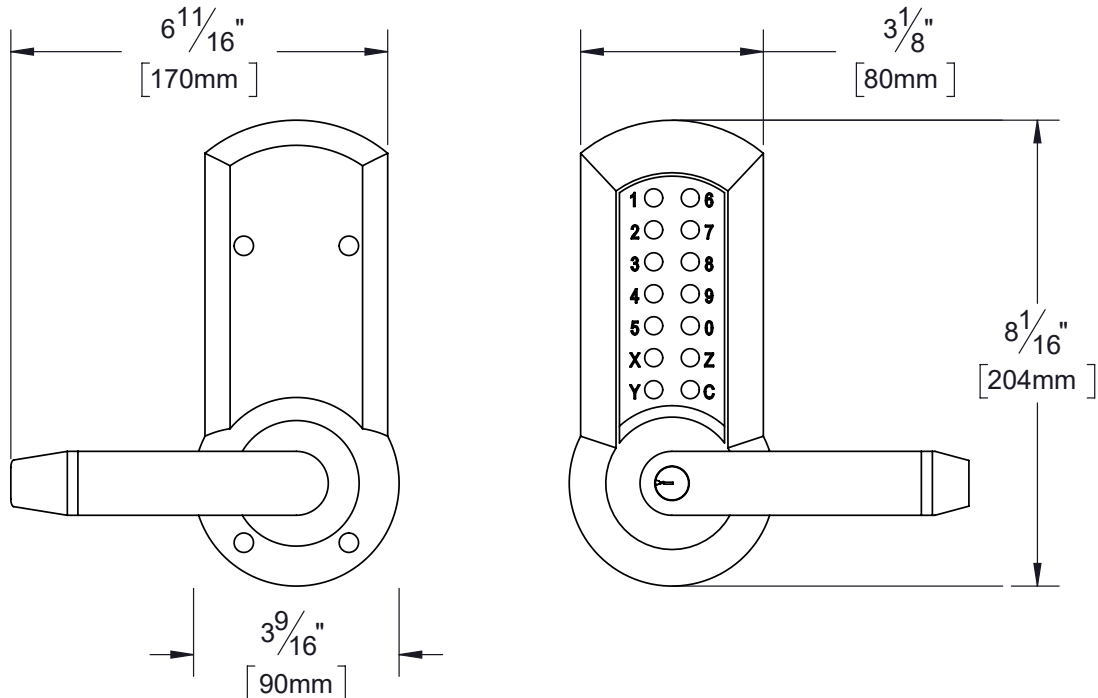

New Door Prep: 2 1/8" Cross Bore, 1" Edge Bore, 4 of 3/8" Through Bolt Holes

Latch Face: 1 3/16" x 2 1/4" Square

Backset: Ships With 2 3/4" Backset Latch, 2 3/8" Backset Latch Sold Separately (Product # MPBCLMB60MM)

Door Thickness: Fits Doors 1 1/2" to 2 1/4" Thick

Overall Size: Keypad: 6 11/16 W X 8 1/16" H X 3 3/8" D
Back Plate: 6 1/2" W X 8 1/6" H X 2 29/32" D

Material: Die Cast Zinc Body, Stainless Steel Push Buttons and Latch Bolt

Finish: US19 Matte Black

Cross Reference

Manufacturer	Part Number
Cal-Royal	CRCODE202



Description:

Mechanical Keyless Single Sided Door Lever Set

Part Number:

MKSL19

Date

07/25

Rev.

00

Sheet 1 of 1