

PRODUCT DATA SHEET

Product Description: Contemporary style privacy function door knob set. Pushbutton latches inside, knob turn opens latch. Knobs fabricated from brass with a US11P venetian bronze finish. Ships with a mortise (not drive in) latch. Optional drive in latch (product #87398) and UL10C fire rated latch (product #87520) available.

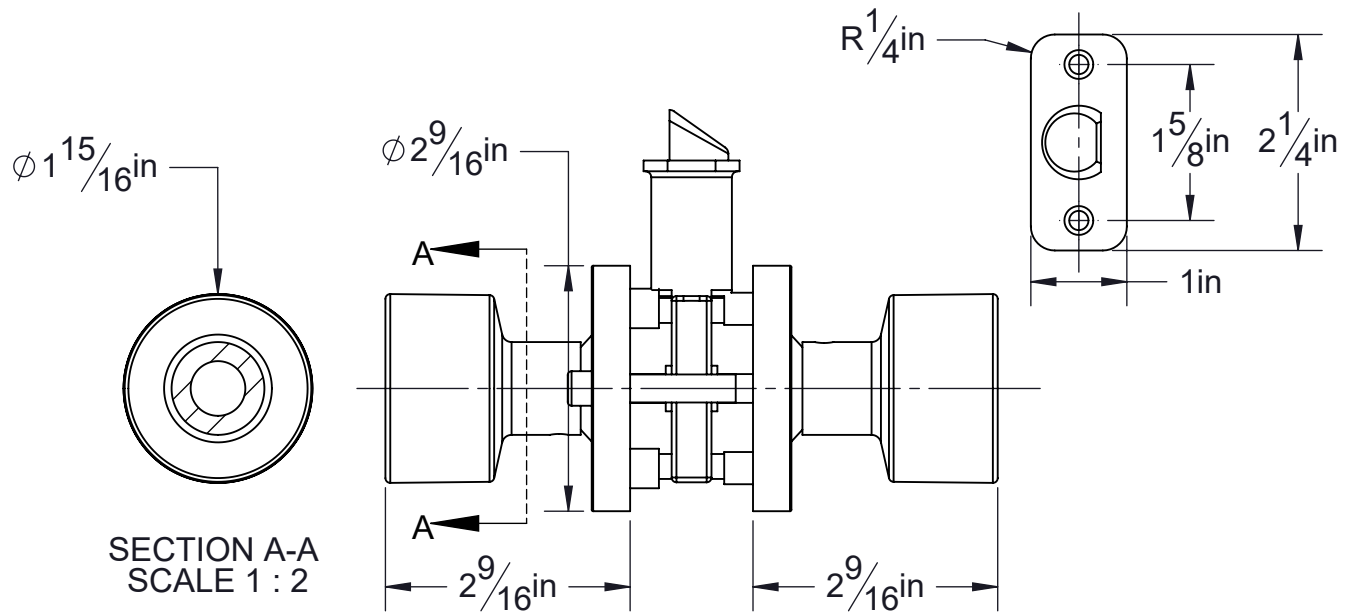

Door Prep: Cross Bore $2 \frac{1}{8}$ +, Edge Bore 1+, Mortise Latch Face $1 \times 2 \frac{1}{4}$ +, Optional Drive In Latch 1" Diameter Drilled Hole

Latches: Ships With Mortise Latch As Shown Above. Optional Drive In Or UL10C Fire Rated Latches Available

Backset: Adjustable Latch to $2 \frac{3}{8}$ or $2 \frac{3}{4}$ +

Door Thickness: Fit all $1 \frac{3}{8}$ - $1 \frac{3}{4}$ Standard Doors

Strike Plate: $2 \frac{1}{4}$ Full Lip Strike

Bolt: $\frac{1}{2}$ Throw



Overall Size: $2 \frac{9}{16}$ W X $2 \frac{9}{16}$ H X $2 \frac{9}{16}$ D

Material: Brass Knobs, Steel Mechanism

Finish: US11P Venetian Bronze

Cross Reference

Manufacturer	Part Number



Description:

Door Knob Set, Privacy, Brooklyn, ANSI Grade 3

Part Number:

87709

Date

Rev.

Sheet 1 of 1