

PRODUCT DATA SHEET

Product Description: Entry lock knob. ANSI Grade 3 with a Kwikset KW 1 keyway. Fabricated from brass with a Venetian bronze finish. Locked or unlocked by key outside or turn button inside. Ships with mounting hardware. Lock ships with mortise latch. Optional drive in and UL10C fire rated latches available.

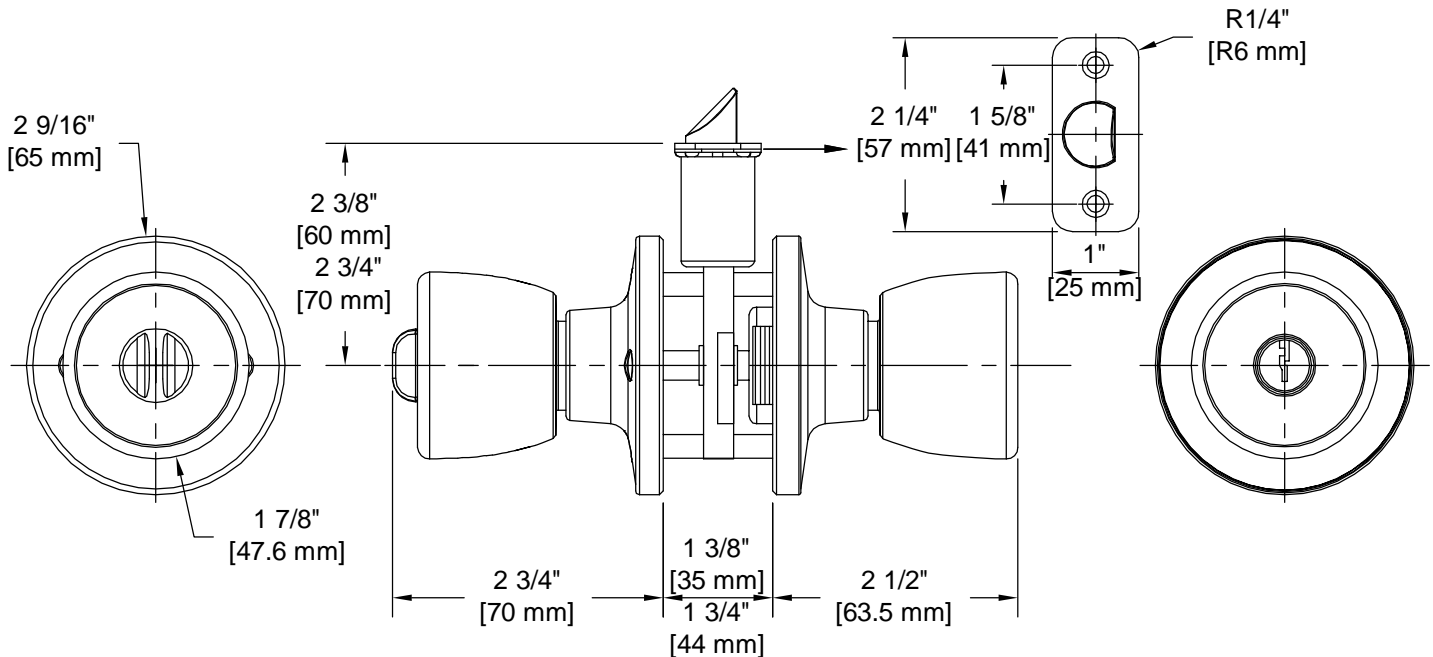

Door Prep: Cross Bore 2 1/8+, Edge Bore 1+, Mortise Latch Face 1+x 2 1/4+, Optional Drive In Latch 1" Diameter Drilled Hole

Latches: Ships With Mortise Latch As Shown Above. Optional Drive In Or UL10C Fire Rated Latches Available

Backset: Adjustable Latch to 2 3/8+or 2 3/4+

Door Thickness: Fit all 1 3/8+- 1 3/4+Standard Doors

Cylinder: Brass with 5 Pin Tumbler Kwikset KW 1 Keyway

Strike Plate: 2 1/4+Full Lip Strike

Bolt: 1/2+Throw

REKEY OPTIONAL

Optional  Latch Available

ANSI 3

KW1 KEYWAY

Overall Size: 2 9/16" W X 2 9/16" H X 2 3/4" D

Material: Brass

Finish: Venetian Bronze

Cross Reference

Manufacturer	Part Number



H Harney
HARDWARE

Description:

**Lock Knob, Entry,
Emerson, KW1, ANSI
Grade 3**

Part Number:

87704

Date

09/16

Rev.

03

Sheet 1 of 1