

PRODUCT DATA SHEET

Product Description: Lock lever, passage, reversible, ANSI Grade 2. Handles are fabricated from zinc and escutcheon is fabricated from stainless steel in a US11P venetian bronze finish. Both levers are always unlocked from inside and outside. ADA compliant. UL10C 3 hour fire rated. Ships with mounting hardware.

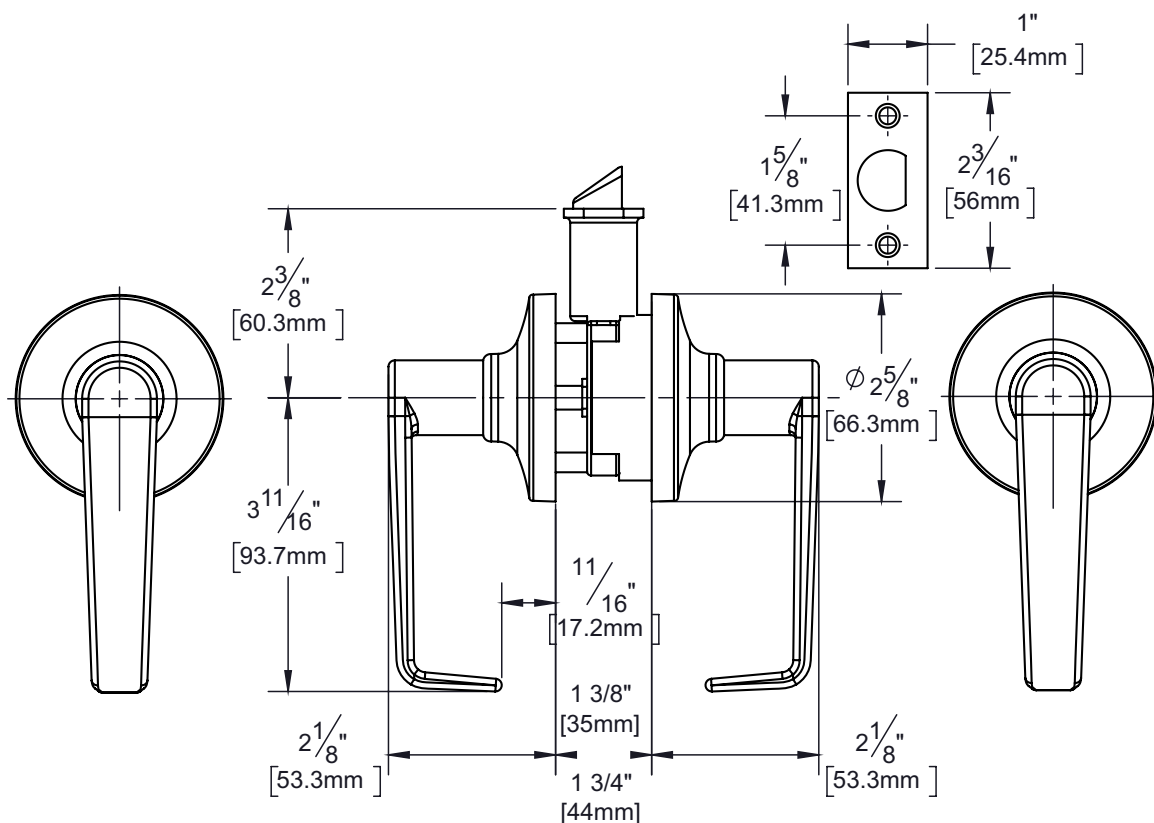

Door Prep: Cross Bore $2\frac{1}{8}"$, Edge Bore $1"$, Mortise Latch Face $1" \times 2\frac{1}{4}"$

Latches: Ships With Mortise Latch As Shown Above

Backset: Adjustable Latch to $2\frac{3}{8}"$ or $2\frac{3}{4}"$

Door Thickness: Fit all $1\frac{3}{8}"$ - $1\frac{3}{4}"$ Standard Doors

Strike Plate: $2\frac{1}{4}"$ Full Lip Strike

Bolt: $1\frac{1}{2}"$ Throw

ANSI/BHMA: A156.2 Grade 2



Overall Size: $6\frac{13}{32}"$ W X $3\frac{11}{32}"$ H X $2\frac{3}{4}"$ D

Material: Zinc Handles, Stainless Steel Escutcheon

Finish: US11P Venetian Bronze

Cross Reference

Manufacturer	Part Number
SCHLAGE	S10D



Description:

**Lock Lever, Passage,
Reversible, UL 10C,
ANSI Grade 2**

Part Number:

86604

Date

10/23

Rev.

01

Sheet 1 of 1