

PRODUCT DATA SHEET

Product Description: Contemporary 12" grab bar, square escutcheon. 12" center to center of mounting brackets, 16" overall length. Fabricated from 18-gauge type 304 grade stainless steel, 1 1/4" diameter tube with a US32 polished stainless steel finish. Welded, type 304 stainless steel mounting flanges. ADA compliant and designed to support loads in excess of 250 lbs when properly installed. For your safety, we recommend a professional installer or licensed contractor to install the grab bar. Ships with mounting hardware.

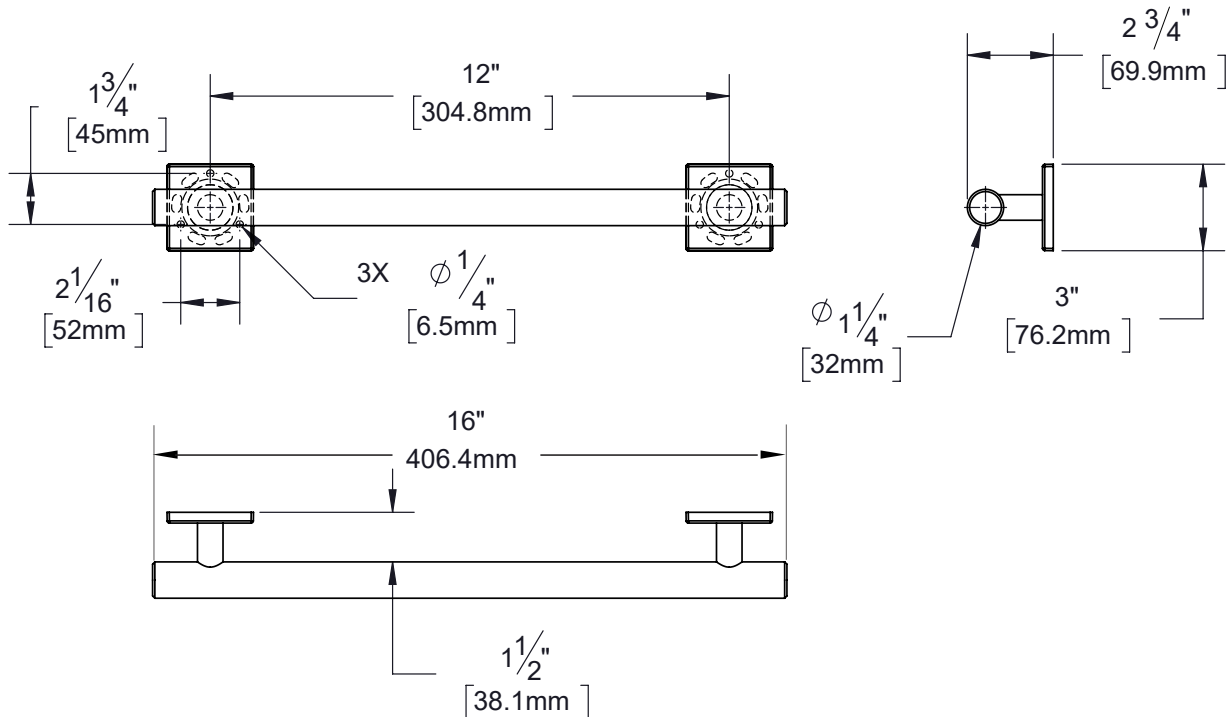

WITH MOUNTING
HARDWARE

ADA

304 STAINLESS

Overall Size: 16" W X 2 3/4" H X 3" D

Material: 304 Grade Stainless Steel

Finish: US32 Polish Stainless Steel

Cross Reference

Manufacturer	Part Number



Description:

Contemporary / Modern Grab Bar, 12", Square Escutcheon, Concealed Screw

Part Number:

71840

Date

10/20

Rev.

01

Sheet 1 of 1