

# PRODUCT DATA SHEET

**Product Description:** Stainless steel adjustable tension shower curtain rod, square escutcheon. Length adjusts from 44" to 72". Rod is a 1" diameter. V, a o a A & A ^ a } A o • quickly installation without drilling holes in the wall. Shower rod and flanges are fabricated from stainless steel with a US32 polished stainless steel finish. Used for standard 5' to 6' tubs.

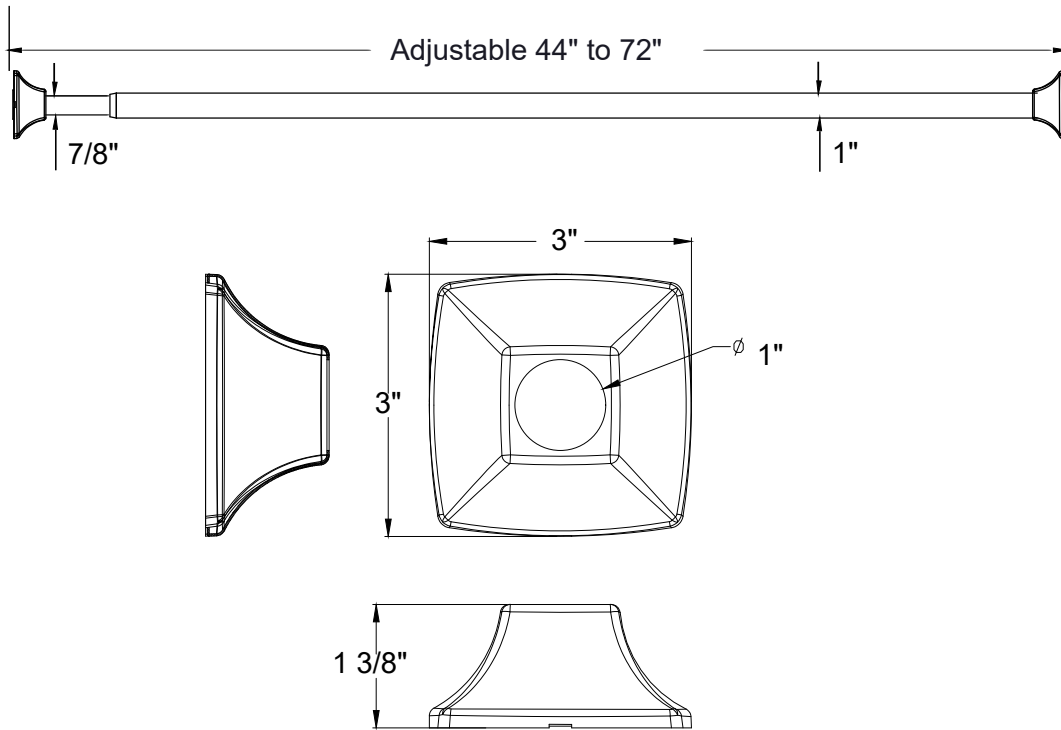

**Material:** Stainless Steel

**Finish:** US32 Polished Stainless Steel

## Cross Reference

Manufacturer

Part Number



Description:

**Straight Tension Shower Rod, Stainless Steel, Adjustable, 5' To 6'**

Part Number:

**51475**

Date

5/21

Rev.

00

Sheet 1 of 1