

# PRODUCT DATA SHEET

**Product Description:** Stainless steel adjustable tension shower curtain rod, square escutcheon. Length adjusts from 44" to 72". Rod is a 1" diameter. V, a, a, & a } Allow quickly installation without drilling holes in the wall. Shower rod and flanges are fabricated from stainless steel with a US32D satin stainless steel finish. Used for standard 5' to 6' tubs.

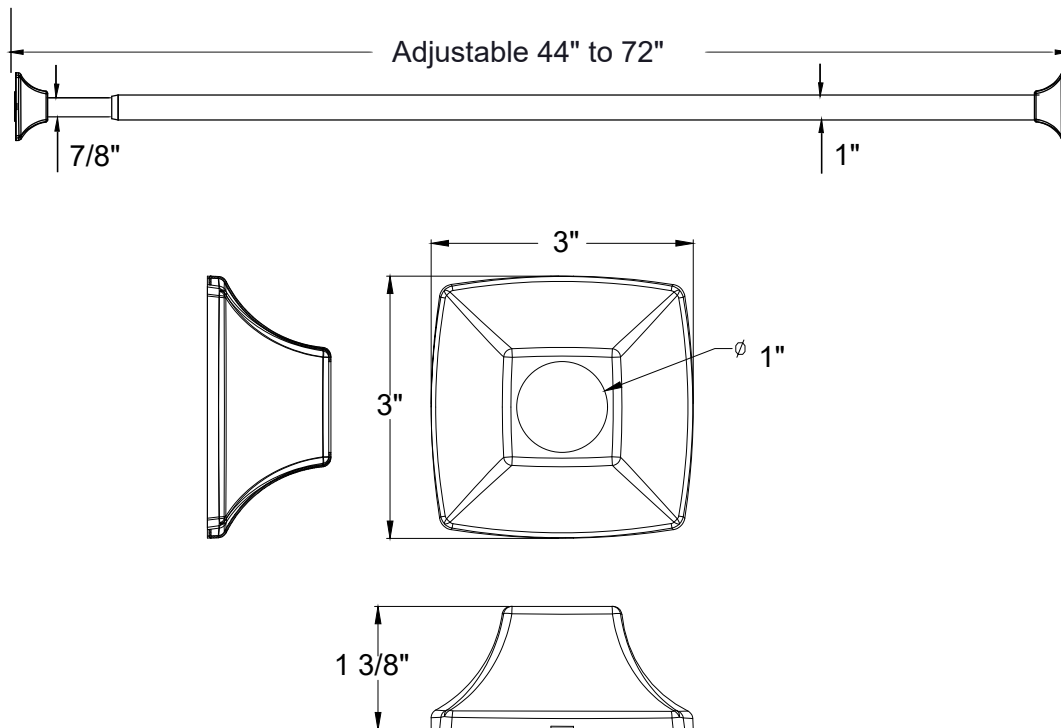

**Overall Size:** 72" W X 1 3/8" H X 3" D

**Material:** Stainless Steel

**Finish:** US32D Satin Stainless Steel

## Cross Reference

Manufacturer	Part Number



Description:

**Straight Tension Shower Rod, Stainless Steel, Adjustable, 5' To 6'**

Part Number:

**51474**

Date

**5/21**

Rev.

**00**

Sheet 1 of 1