

# PRODUCT DATA SHEET

**Product Description:** Decorative handle pull perfect for kitchen or bath cabinets. 5 1/16" center to center. Fabricated from zinc and steel with a US15 satin nickel finish. Individually packaged with mounting screws. Individually packaged with 1" length and 1 3/8" length (M4x0.7) mounting screws.

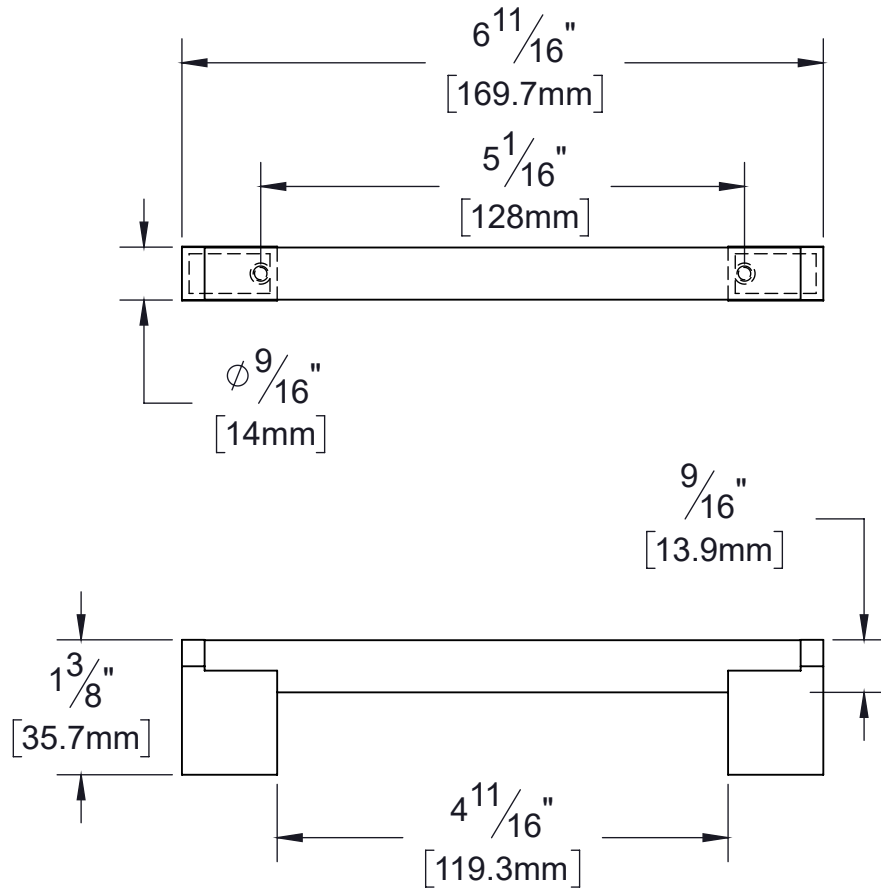

**Overall Size:** 6 11/16" W X 9/16" H X 1 3/8" D

**Material:** Zinc and Steel

**Finish:** US15 Satin Nickel

## Cross Reference

Manufacturer	Part Number



Description:

**Handle Pull,  
Zinc And Steel, 5 1/16"  
Center To Center**

Part Number:

**36297**

Date

09/20

Rev.

01

Sheet 1 of 1