

PRODUCT DATA SHEET

Product Description: Passage function for closet, kitchen, or hallway doors; Universal handing for use on right and left sliding doors; fits standard interior sliding doors 1 3/8 inches to 1 3/4 inches thick; Requires standard door preparation: 2 1/8 inch cross bore, 2 3/8 inch backset, 1 inch x 2 1/4 inch radius corner latch face; Features a unique tap-to-open latch face that opens with a push and acts as a thumb pull; installs quickly with a Phillips head screwdriver; fabricated with brass and zinc; US26 bright chrome finish.

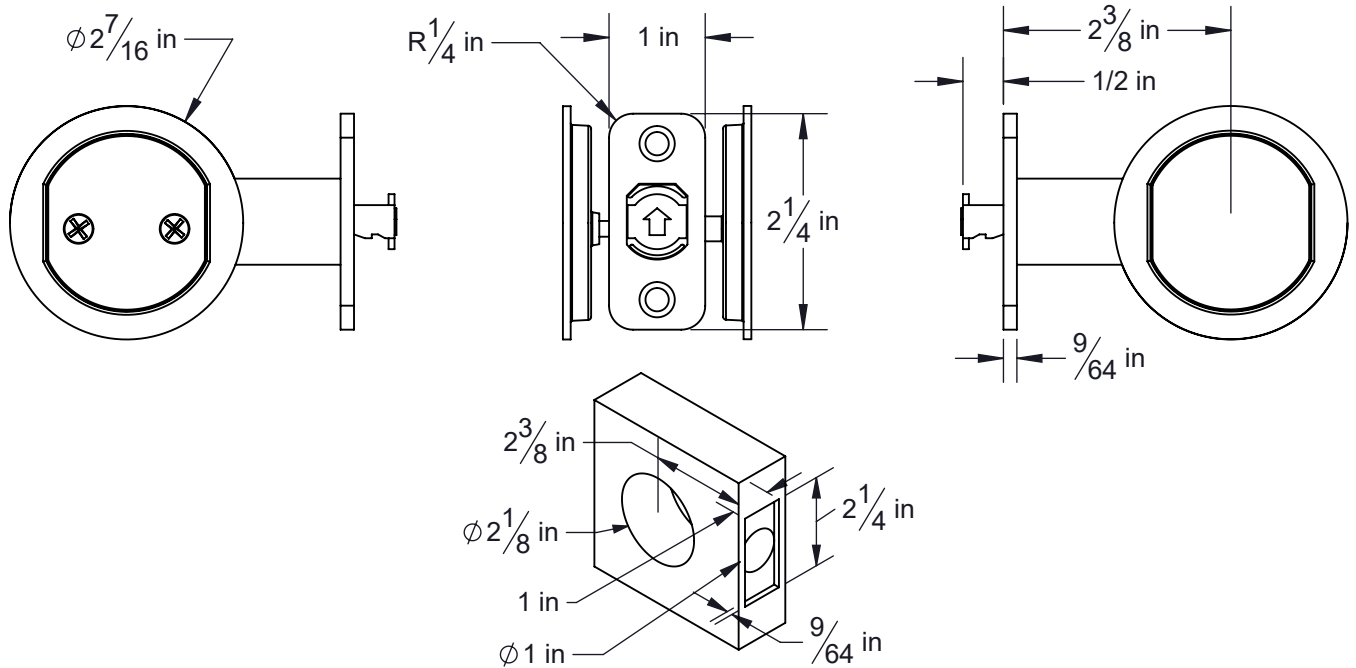

DOOR PREP

Door Preparation: Cross Bore 2 1/8", Edge Bore 1", Mortise Latch Face 1" X 2 1/4" Radius Corners
Latches: Ships With Mortise Latch As Shown Above
Backset: Latch 2 3/8"
Door Thickness: Fits All 1 3/8" - 1 3/4" Standard Doors
Bolt: 1/2" Throw

Overall Size: 2 7/16" X 2 7/16" X 1 3/8" - 1 1/4"

Material: Brass And Zinc

Finish: US26 Bright Chrome

Cross Reference

Manufacturer	Part Number



Description:

**Round Pocket Door
Lock, Passage, 2 1/8 In.
Bore X 2 3/8 In. Backset**

Part Number:

32532

Date

Rev.

Sheet 1 of 1