

# PRODUCT DATA SHEET

**Product Description:** Passage function for closet, kitchen, or hallway doors; Universal handing for use on right and left sliding doors; fits standard interior sliding doors 1 3/8 inches to 1 3/4 inches thick; Requires standard door preparation: 2 1/8 inch cross bore, 2 3/8 inch backset, 1 inch x 2 1/4 inch radius corner latch face; Features a unique tap-to-open latch face that opens with a push and acts as a thumb pull; installs quickly with a Phillips head screwdriver; fabricated with brass and zinc; US15 satin nickel finish.

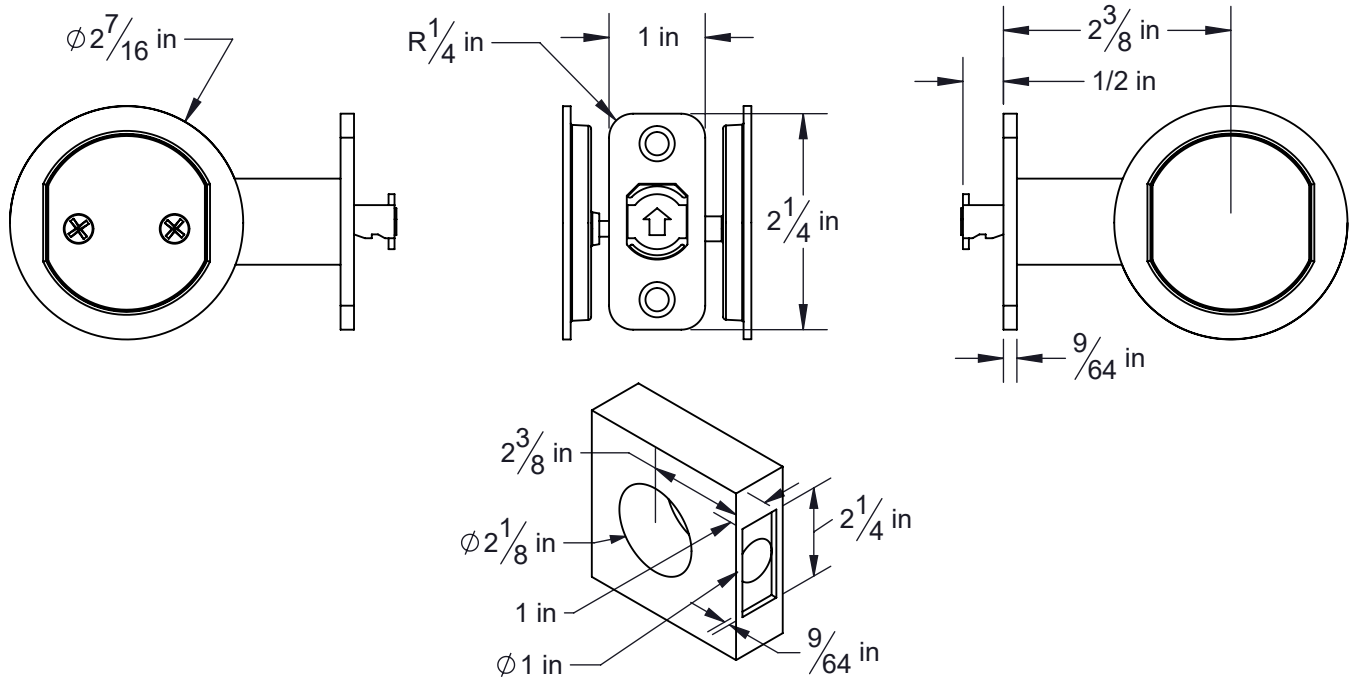

## DOOR PREP

Door Preparation: Cross Bore 2 1/8", Edge Bore 1", Mortise Latch Face 1" X 2 1/4" Radius Corners

Latches: Ships With Mortise Latch As Shown Above

Backset: Latch 2 3/8"

Door Thickness: Fits All 1 3/8" - 1 3/4" Standard Doors

Bolt: 1/2" Throw

**Overall Size:** 2 7/16" X 2 7/16" X 1 3/8" - 1 3/4"

**Material:** Brass And Zinc

**Finish:** US15 Satin Nickel

### Cross Reference

Manufacturer	Part Number



Description:

**Round Pocket Door  
Lock, Passage, 2 1/8 In.  
Bore X 2 3/8 In. Backset**

Part Number:

**32531**

Date

Rev.

Sheet 1 of 1