

Agenda

Rules, Regulations, Certifications and Resources

- Stormwater requirements and permitting
- Principles of low impact development
- New urbanism
- Sustainable Sites Initiative
- Aesthetic, energy-efficiency and health benefits

D. Nunez Brown

Greenfield Development Versus Brownfield Redevelopment

- Defining greenfields and brownfields
- Advantages of greenfield development
- Taking advantage of brownfields for redevelopment
 - Existing infrastructure, community connections, urban renewal, financial and other incentives

S. Gronquist

Ecology and Site Design

- Conservation biology
- Landscape ecology
- Restoration ecology

S. Gronquist

Sustainable Stormwater Management

- Stormwater harvesting and reuse
- Infiltrating stormwater
- Rain gardens

D. Nunez Brown

Designing/Planting for Biodiversity

- Understanding wildlife needs
- Ecosystem services provided by native plants
- Characteristics of native landscapes
- Ways to incorporate native plants into designs
- Lawn design and lawn management
- Which plants provide the most benefit
- Plant behaviors and maintenance practices
- Sourcing native plants

T. Baumgarten

Walkability, Micromobility and Mass Transit

- Connecting the site to sustainable transportation options
- Environmental impacts of transportation options
 - Sidewalks and trails
 - Bike routes
 - E-bikes and scooters
 - Mass transit availability
 - Electric vehicle charging infrastructure

S. Gronquist

Can't Attend? Order the Webinar as an On-Demand Package!

Recordings of this webinar are available for purchase. See course listing online for more information and please refer to specific state licensing rules or certification requirements to determine if this learning method is eligible for continuing education credit.

Sustainable Site Design

Live, Interactive Webinar - Wednesday, March 20, 2024

NON-PROFIT
U.S. POSTAGE PAID
EAU CLAIRE, WI
PERMIT NO. 2016

HalfMoon Education Inc.
PO Box 278
Altoona, WI 54720-0278



Learning Objectives

You'll be able to:

Meet stormwater regulations while integrating low impact development (LID) practices and principles of new urbanism.

Take advantage of opportunities for brownfield redevelopment and realize financial and infrastructure benefits.

Consider conservation biology, landscape ecology and restoration ecology in the site design process.

Design and plant for biodiversity.

Connect sites to transportation options, including pedestrian trails, bike routes and mass transit.



HalfMoon Education Live Webinars

Sustainable Site Design

Live, Interactive Webinar - Wednesday, March 20, 2024

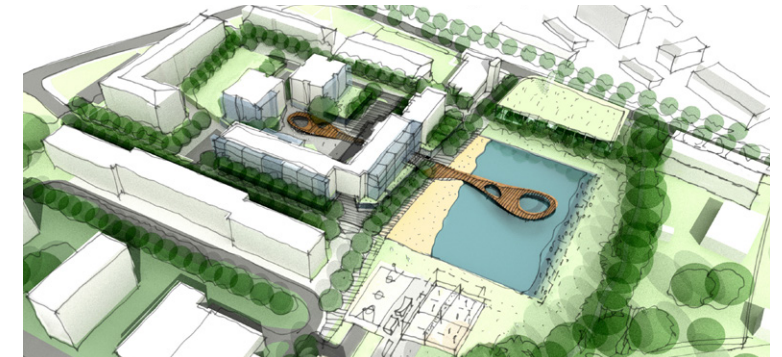

Comply with stormwater requirements

Integrate principles of low impact development and new urbanism

Weigh the advantages of brownfield redevelopment over greenfield development

Implement ecological principles into design

Plan for walkability, micromobility and mass transit access

Continuing Education Credits

Professional Engineers

6.5 PDHs

Architects

6.5 HSW CE Hours

6.5 AIA LU | HSW

Landscape Architects

6.5 HSW CE Hours

6.5 LA CES HSW PDHs

International Code Council

.65 CEUs (Sustainability)



PREFERRED
EDUCATION
PROVIDER



HalfMoon Education Inc.
WWW.HALFMOONSEMINARS.ORG

Webinar Information

Log into Webinar

8:00 - 8:30 am CDT

Break

11:45 am - 12:15 pm CDT

Morning Session

8:30 - 11:45 am CDT

Afternoon Session

12:15 - 4:00 pm CDT

Tuition

\$319 for individual registration.

\$289 for two or more registrants from the same company at the same time.

Included with your registration: PDF seminar manual.

How to Register

- Visit us online at www.halfmoonseminars.org
- Call customer service at 715-835-5900

Webinars are presented via GoToWebinar. Instructions and login information will be provided in an email sent close to the date of the webinar. For more information, please visit our FAQ section of our website, or visit www.gotowebinar.com.

Cancellations: Cancel at least 48 hours before the start of the webinar, and receive a full tuition refund, minus a \$39 service charge for each registrant. Cancellations within 48 hours will receive a credit toward another webinar or the on-demand package. You may also authorize another person to take your place.

Learn More and Register:

www.halfmoonseminars.org

Customer Service (715) 835-5900 Ext. 1

or scan here



Faculty

Tammany Baumgarten is a practicing horticulturist and owner/operator of BaumGardens Landscape and Design in New Orleans. She is a Master Gardener with the LSU AgCenter, the founding president of the Native Plant Initiative of Greater New Orleans and the past president of the Louisiana Native Plant Society. Her passion as a landscape designer, contractor and community educator is to increase the ecological functionality of built landscapes by incorporating native plants and other essential components of good habitat to gardens and green spaces while actively helping others to do so as well.

Sarah Gronquist has been a licensed landscape architect since 2004. She has been teaching landscape architecture since 2006, working with Ray Freeman's LARE Preparatory Courses. She has served as an adjunct professor at many Bay Area institutions, including UC Berkeley, UC Extension, Merritt College, and Berkeley's Owner Builder Center. Ms. Gronquist also developed online courses in grading and drainage for San Francisco's Academy of Art University, with separate tracks for undergraduates and graduate students. After earning an undergraduate degree as a sculptor, she quickly became interested in applying her design skills on larger scale projects. She earned her MLA at the University of Massachusetts, Amherst, and then made her way to California. Since that time, Ms. Gronquist has worked on a wide range of design projects, including private residential gardens, creek restorations, affordable housing developments, public park settings for monumental sculptures, and commercial mixed-use permitting and master planning. She was an early adopter of Alameda County's ReScape (formerly Bayfriendly) landscape sustainability rating program. She was a member of the first class of Bayfriendly Qualified Landscape Professionals back in 2006 and continues to volunteer and teach at ReScape events throughout California. As a lifelong learner, Ms. Gronquist is also an enthusiastic teacher. Her SGLA Technical Training website at www.sarahgronquist.com is the registration portal for LARE webinars. New on-demand courses for the California Supplemental Exam and for refreshing basic grading skills are also available there, along with many free resources for landscape professionals seeking to learn and grow.

Dana Nunez Brown, FASLA, PLA, AICP, LEED AP

A native of New Orleans, Ms. Brown has worked tirelessly to address the U.S. Environmental Protection Agency and Louisiana Department of Environment Quality requirements for water quality. She has written and revised chapters of the development code for several municipalities and parishes. She authored a manual to guide developers and design professionals in designing and implementing stormwater best management practices, and she organizes and leads dozens of stormwater workshops each year. Ms. Brown holds a BLA degree from Louisiana State University and an MLA degree from the Harvard Graduate School of Design, and she is a professional landscape architect, licensed in several states. She is a long-time active member of ASLA and is a Fellow of the organization. Ms. Brown is a certified planner (AICP), and a LEED Accredited Professional (LEED AP). As President of Dana Brown & Associates, she pioneered design of green infrastructure throughout Louisiana. Ms. Brown is a licensed trainer for the National Green Infrastructure Certification Program (NGICP) and a founding member of Water Wise Gulf South, which trains and educates residents in implementing green infrastructure in their neighborhoods. Having taught classes on the subject at the LSU Robert Reich School of Landscape Architecture and the University of New Orleans (UNO), Ms. Brown regularly guest lectures at Tulane University, UNO, and Xavier University. She is the author of *Using Plants for Stormwater Management: A Green Infrastructure Guide for the Gulf South*, LSU Press, April 2014.

Credit Information

This webinar is open to the public and is designed to qualify for 6.5 PDHs for professional engineers, 6.5 HSW continuing education hours for licensed architects, and 6.5 HSW continuing education hours for landscape architects in all states that allow this learning method. Please refer to specific state rules to determine eligibility.

HalfMoon Education is an approved continuing education sponsor for engineers in Florida (Provider License No: CEA362), Indiana (License No. CE21700059), Maryland, New Jersey (Approval No. 24GP00000700) and North Carolina (S-0130). HalfMoon Education is deemed an approved continuing education sponsor for New York engineers and architects via its registration with the American Institute of Architects Continuing Education System (Regulations of the Commissioner §68.14(i)(2) and §69.6(i)(2)). Other states do not preapprove continuing education providers or courses.

The American Institute of Architects Continuing Education System has approved this course for 6.5 HSW LUs (Sponsor No. J885). Only full participation is reportable to the AIA/CES.

The Landscape Architecture Continuing Education System has approved this course for 6.5 HSW PDHs. Only full participation is reportable to the LA CES.

The International Code Council has approved this event for .65 CEUs in the specialty area of Sustainability (Preferred Provider No. 1232).

Attendance will be monitored, and attendance certificates will be available after the webinar for those who attend the entire course and score a minimum 80% on the quiz that follows the course (multiple attempts allowed).

On-Demand Credits

The preceding credit information only applies to the live presentation. This course in an on-demand format may not be eligible for the same credits as the live presentation; please consult your licensing board(s) to ensure that a structured, asynchronous learning format is appropriate. The following pre-approvals may be available for the on-demand format upon request:

6.5 HSW LUs (AIA), 6.5 HSW PDHs (LA CES)

Additional Learning

Pruniversity: The Short Course on Pruning and Training Trees

- Friday, February 23, 2024 | 9:00 am - 4:30 pm CST

Slope Stabilization and Landslide Prevention

- Friday, February 23, 2024 | 9:00 am - 4:30 pm CST

Focus on Volatile Organic Compounds (VOCs)

- Monday, February 26, 2024 | 2:00 - 4:00 pm CST

Dam Design, Construction, and Maintenance

- Thursday, February 29, 2024 | 9:00 am - 4:30 pm CST

Trails and Greenways Design, Construction, and Management

- Thursday, February 29, 2024 | 9:00 am - 4:00 pm CST

NPDES Stormwater Management Program 2024

- Thursday, March 7, 2024 | 8:30 am - 4:00 pm CST

For more information and other online learning opportunities visit:

www.halfmoonseminars.org