

Agenda

Presented by Douglas E. Wance

Overview of Subdivision Map Act

- Goals
- Differences with other statutory frameworks
- History of Subdivision Map Act

Basic Issues for Approval of a Map

- What is a “subdivision” or a “plat”
- Types of maps
- Exemptions, waivers, and exclusions

Processing of Maps

- With other land use and permit applications
- California Environmental Quality Act
- Conditions of approval
- Exactions and mitigation fees
- Water supply planning
- Hearings and findings of approval/disapproval

Finalizing Maps

- Securing vested rights
- Amendment and correction of maps
- Enforcement of maps

Recent Developments

- Case law
- Legislative changes

Ethical Considerations

- Permitted contacts with elected officials
- Public record considerations
- Conflict of interest considerations

Can't Attend? Order the Webinar as an On-Demand Package!

Recordings of this webinar are available for purchase. See course listing online for more information and please refer to specific state licensing rules or certification requirements to determine if this learning method is eligible for continuing education credit.

Current Issues in California Plat and Subdivision Law

Live, Interactive Webinar - Monday, May 22, 2023

NON-PROFIT
U.S. POSTAGE PAID
EAU CLAIRE, WI
PERMIT NO. 2016

HalfMoon Education Inc.
PO Box 278
Altoona, WI 54720-0278



Learning Objectives

You'll be able to:

Define “subdivisions” and “plats.”

Identify maps that are exempted or excluded from Subdivision Map Act requirements.

Explore the approval process under the California Subdivision Map Act.

Learn about amending, correcting and enforcing maps.

Discuss recent case law and legislative changes.

Identify ethics concerns, including permitted contacts with elected officials and public record considerations.



HalfMoon Education Live Webinars

Current Issues in California Plat and Subdivision Law

Live, Interactive Webinar - Monday, May 22, 2023

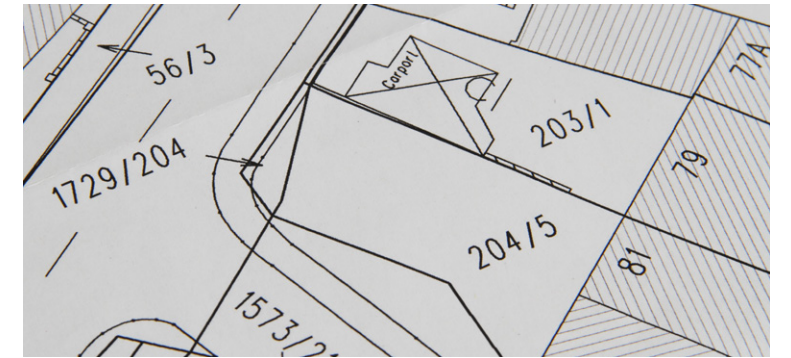

Discuss the goals of the Subdivision Map Act

Examine types of maps

Learn about processing and finalizing maps

Explore the process of permit applications

Get tips on amending and correcting maps

Review recent developments of California subdivision law, including legislative changes

Discuss ethical issues

Continuing Education Credits

Professional Engineers

6.0 PDHs

Land Surveyors

6.0 PDHs

Attorneys

6.0 CLE Hours
(Including 1.0 Ethics Hour)

Certified Planners

CM|6.0



Faculty

Douglas E. Wance *Shareholder with Buchalter Law Firm*
Mr. Wance is a shareholder and former chair of Buchalter’s Land Use Practice Group. He has built a cross-disciplinary practice involving land use and entitlements, water resources, environmental compliance, natural resources, and public law through the representation of both public agencies and private businesses throughout California. Mr. Wance has handled all aspects of these substantive areas, from advising clients regarding the applicability of the law, to guiding clients through a permitting or entitlement process, or defending clients subject to enforcement actions. He successfully represented businesses and public agencies in sophisticated financial, real estate, water resource, environmental compliance, and land development matters in court and before administrative agencies. Mr. Wance’s land use and entitlement background includes representation of residential developers, public entities, major industrial facilities, and other commercial businesses in all phases of project development before local and state agencies, city councils, and county board of supervisors. He has assisted clients in obtaining development and environmental permits and project approvals for power plants, schools, mixed use, and industrial development projects.

Webinar Information

Log into Webinar 8:00 - 8:30 am PDT	Break 11:40 am - 12:10 pm PDT
Morning Session 8:30 - 11:40 am PDT	Afternoon Session 12:10 - 3:20 pm PDT

Tuition
\$319 for individual registration
\$289 for two or more registrants from the same company at the same time.
Included with your registration: *PDF seminar manual.*

How to Register

- Visit us online at www.halfmoonseminars.org
- Mail-in or fax the attached form to 715-835-6066
- Call customer service at 715-835-5900

Webinars are presented via GoToWebinar. Instructions and login information will be provided in an email sent close to the date of the webinar. For more information, please visit our FAQ section of our website, or visit www.gotowebinar.com.

Cancellations: Cancel at least 48 hours before the start of the webinar, and receive a full tuition refund, minus a \$39 service charge for each registrant. Cancellations within 48 hours will receive a credit toward another webinar or the self-study package. You may also authorize another person to take your place.

Can’t Attend? Order the Webinar as an On-Demand Package!
Recordings of this webinar are available for purchase. See details online for more information and please refer to specific state licensing rules or certification requirements to determine if this learning method is eligible for continuing education credit.

Additional Learning

The Art of Retracement for Surveyors
- Monday, May 1, 2023 | 6:30 am - 2:00 pm PDT

Easements and Rights-of-Way
- Tuesday, May 2, 2023 | 6:30 am - 2:00 pm PDT

Simple Vector GIS Design for Civil Engineers and Land Surveyors
- Friday, May 5, 2023 | 12:00 - 2:00 pm PDT

How to Keep Good Records for Engineers and Land Surveyors (and Why It Matters)
- Wednesday, May 10, 2023 | 10:00 am - 1:20 pm PDT

Resolving Conflicts of Surveying Evidence
- Monday, May 15, 2023 | 12:00 - 2:00 pm PDT

GNSS Positioning
- Tuesday, May 16, 2023 | 6:30 am - 1:20 pm PDT

U.S. Army Corps of Engineers Land Boundaries and Access Rights
- Wednesday, May 17, 2023 | 9:45 am - 2:00 pm PDT

For more information and other online learning opportunities visit:
www.halfmoonseminars.org

Continuing Education Credit Information
This webinar is open to the public and is designed to qualify for 6.0 PDHs for professional engineers and land surveyors licensed in California.

This webinar is designed to qualify for 6.0 CLE hours, including 1.0 legal ethics hour, for California paralegals. HalfMoon Education is an approved Multiple Activity Provider with the State Bar of California (Provider Number 8370).

HalfMoon Education is an approved CM Provider with the American Planning Association. This course is registered for CM | 6.0 for Certified Planners.

Attendance will be monitored, and attendance certificates will be available after the webinar for those who attend the entire course and score a minimum 80% on the quiz that follows the course (multiple attempts allowed).

On-Demand Credits
The preceding credit information only applies to the live presentation. This course in an on-demand format may not be eligible for the same credits as the live presentation; please consult your licensing board(s) to ensure that a structured, asynchronous learning format is appropriate.

Learn More and Register:
www.halfmoonseminars.org
Customer Service (715) 835-5900 Ext. 1

or scan here



Registration

Current Issues in California Plat and Subdivision Law
Live, Interactive Webinar - Monday, May 22, 2023

How to Register	Registrant Information
Online: www.halfmoonseminars.org	Name: _____ Company/Firm: _____ Address: _____ City: _____ State: _____ Zip: _____ Occupation: _____ Email: _____ Phone: _____
Phone: 715-835-5900	Additional Registrants: Name: _____ Occupation: _____ Email: _____ Phone: _____ Name: _____ Occupation: _____ Email: _____ Phone: _____
Fax: 715-835-6066	Complete the entire form. Attach duplicates if necessary.
Code:	
Mail: HalfMoon Education Inc., PO Box 278, Altoona, WI 54720-0278	Email address is required for credit card receipt, program changes, and notification of upcoming seminars and products. Your email will not be sold or transferred.
() I need special accommodations. Please contact me.	
Tuition () I will be attending the live webinar. Single Registrant - \$319.00 . Two or more registrants from the same company registering at the same time - \$289.00 each. () I am not attending. Please send me the webinar recording: <input type="checkbox"/> Streamable MP4 Video/PDF Manual for \$329.00 . <input type="checkbox"/> USB Video/PDF Manual for \$329.00 .	
Checks: Make payable to HalfMoon Education Inc. Credit Card: <i>Mastercard, Visa, American Express, or Discover</i> Credit Card Number: _____ Expiration Date: _____ CV2 Code: _____ Cardholder Name: _____ Billing Address: _____ City: _____ State: _____ Zip: _____ Signature: _____ Email: _____	