



# STAINLESS STEEL ENCLOSED BASE CABINETS with DRAWERS

**Item #:** \_\_\_\_\_ **Qty #:** \_\_\_\_\_

**Model #:** \_\_\_\_\_

**Project #:** \_\_\_\_\_

*\*Both feature fully enclosed 30" NSF Drawers*

5" Backsplash



Hinged Doors



Sliding Doors

## HINGED DOOR CABINET

MODEL #	LENGTH	# DRAWERS	WEIGHT
HDRC-305	60"	2	300 Lbs.
HDRC-306	72"	2	360 Lbs.
HDRC-307	84"	3	420 Lbs.
HDRC-308	96"	3	540 Lbs.
HDRC-3010	120"	4	600 Lbs.

## SLIDING DOOR CABINET

MODEL #	LENGTH	# DRAWERS	WEIGHT
SDRC-305	60"	2	300 Lbs.
SDRC-306	72"	2	360 Lbs.
SDRC-307	84"	3	420 Lbs.
SDRC-308	96"	3	540 Lbs.
SDRC-3010	120"	4	600 Lbs.

## ACCESSORIES

Model #	Description	Qty.
TA-105	Mod. to 24" Width	
TA-110	Mod. to 36" Width	
TA-14	Drawer Lock	
TA-46	Door Locks	
NS-2015	NSF Drawer	20x15x5"
NS-2020	NSF Drawer	20x20x5"

### FEATURES:

5" SPLASH is furnished with a 1 5/8" sanitary rolled rim on the front side and 1 5/8" square bend edges on the 2 sides and a 5" splash with a 1" return on the rear side.

### CONSTRUCTION:

All TIG welded. Exposed areas finished to match adjacent surfaces.

Entire Top is mechanically polished to a satin finish and is sound deadened.

UNIT-BODY DESIGN sides, back and shelf are welded to form a single rigid structure.

### MATERIAL:

TOP is 14 gauge stainless steel type "304" series with galvanized understructure.

BODY is 18 gauge stainless steel type "430" series.

LEGS and 1" adjustable bullet feet with gussets are Stainless Steel.



**NEW YORK**  
(800) 645-3166  
Fax: (631) 242-6900

**GEORGIA**  
(800) 832-1218  
Fax: (770) 775-5625

**TEXAS**  
(800) 527-0353  
Fax: (972) 932-4795

**NEVADA**  
(800) 446-8684  
Fax: (775) 972-1578

For Assistance with  
Smart Modifications & Accessories Call: >>>

1-800-498-6634 Fax: 631-586-2933  
smartfab@advancetabco.com

# DETAILS and SPECIFICATIONS

TOL  $\pm .500''$

Units 7' and larger are furnished with 6 legs.

ALL DIMENSIONS ARE TYPICAL

## HDRC Series

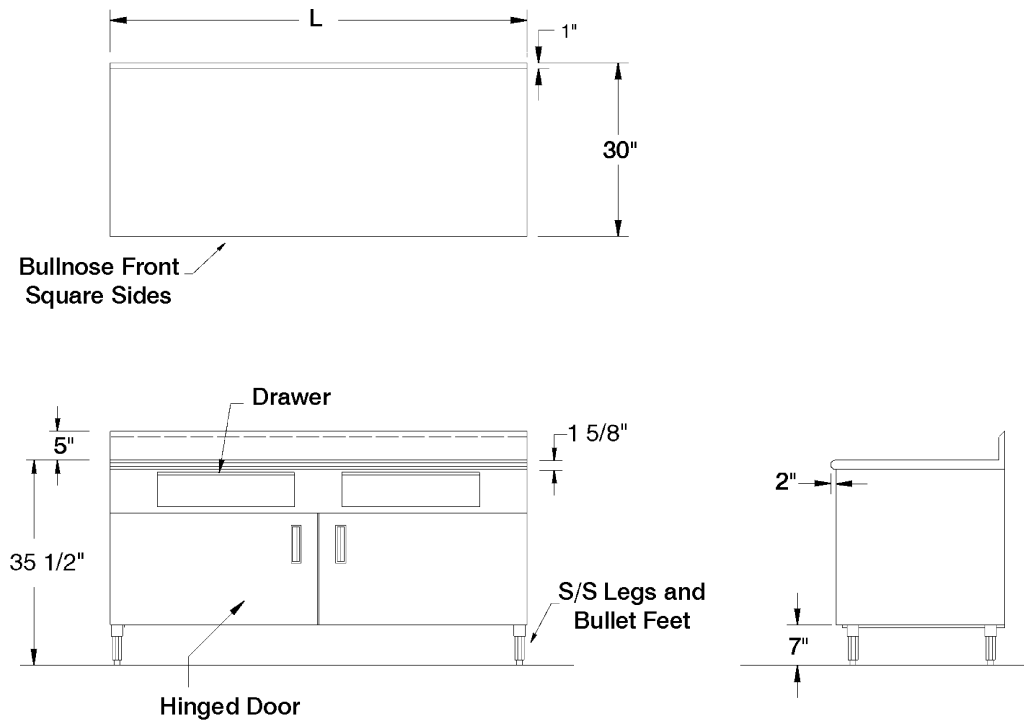

## SDRC Series

