

# BUNN®

## Fresh Mix Dispenser with 1 or 2 Hoppers

ITEM#

PROJECT

DATE

### Features

#### Fresh Mix Dispensers

- Space saving narrow 8" (20.3 cm) cabinet width.
- Variable speed hopper motors offer a wide range of product mix ratios (.75 to 6.6 grams of powder per second).
- Large easy-to-fill translucent hoppers ensure quick and timely refilling.  
FMD-1 = one 8 lbs. (3.6 Kg)  
FMD-2 = two 4 lbs. each (1.8 Kg)
- Lighted graphics merchandise drinks for maximizing profits.
- Large hot water reservoir provides 4.2 gal. (15.9 L)/hour serving capacity.
- Adjustable legs & drip tray allows up to 7" (17.8 cm) opening for 20 oz. cups.
- Specially designed mixing system guarantees perfect beverages every time.
- Improved automatic rinse reduces run-on after beverage is dispensed.
- Designed to be easily serviced from front and top of machine.



Model FMD-1



Model FMD-2



Model FMD-1 available  
with optional  
Hot Chocolate Display

#### Models FMD-1 & FMD-2

Dimensions: 30"H x 7.9"W x 21"D  
(76.2cm H x 20.1cm W x 53.3cm D)

For current specification sheets and other information, go to [www.bunn.com](http://www.bunn.com).

### Related Products

#### Easy Clear® EQ-11-TL

Product No. : 30344.1001  
Dimensions:  
15<sup>7</sup>/<sub>8</sub>" H x 3<sup>5</sup>/<sub>8</sub>" W x 4<sup>17</sup>/<sub>32</sub>" D  
40.3cm H x 9.2cm W x 11.5cm D

#### Easy Clear® ED-11-TL

Product No. : 30244.1001  
Dimensions:  
14<sup>3</sup>/<sub>16</sub>" H x 5<sup>1</sup>/<sub>16</sub>" W x 5<sup>1</sup>/<sub>16</sub>" D  
36cm H x 12.9cm W x 12.9cm D



#### Features deluxe whipper chambers:

1. Robust whipper to ensure full flavor yield.
2. Specially designed self cleaning mixing chamber.
3. Exhaust fan to siphon off moisture that can cause powder buildup.
4. Hot water dispense for easy clean-out.
5. Quick disconnecting parts for thorough sanitizing.

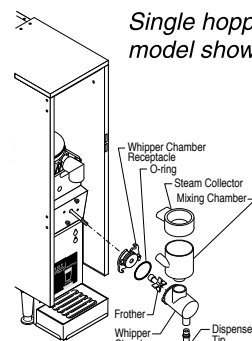

Single hopper  
model shown.

Model	Agency Listing	International Model	Agency Listing
FMD-1	NSF, ETL	No International Model	
FMD-2	NSF, ETL		

Patents Apply

5/04

D3

## Dimensions & Specifications

Model	Product #	Volts	Amps	Tank Heater Watts	Total Watts	Brewing Capacity	Cu. Ft.	Shipping Weight	Cord Attached
FMD-1 BLK	SET00.0196	120	15	1700	1800	4.2 gal./hr.**	8.3	75 lbs. (34 kg)	Yes*
FMD-1 BLK	SET00.0203†	120	15	1700	1800	4.2 gal./hr.**	8.3	75 lbs. (34 kg)	Yes*
FMD-2 BLK	SET00.0200	120	15	1700	1800	4.2 gal./hr.**	8.3	81 lbs. (36.7 kg)	Yes*

† Model has "Hot Chocolate" display. Make-to-order item – requires longer lead time. \*Power cord (NEMA 5-15P) 15 Amp-120V machine only.

\*\*Based on incoming water temperature of 50°F.

Electrical: Model requires 2-wires plus ground service rated 120V, single phase, 60 hz.

Plumbing: 20-90 psi (138-621 kPa) from a 3/8" (10 mm) or larger supply line. A shut-off valve should be installed in the line before the unit. Install a regulator in line when pressure is greater than 90 psi to reduce it to 50 psi. Supplied with 1/4" (6.4 mm) male flare fitting.

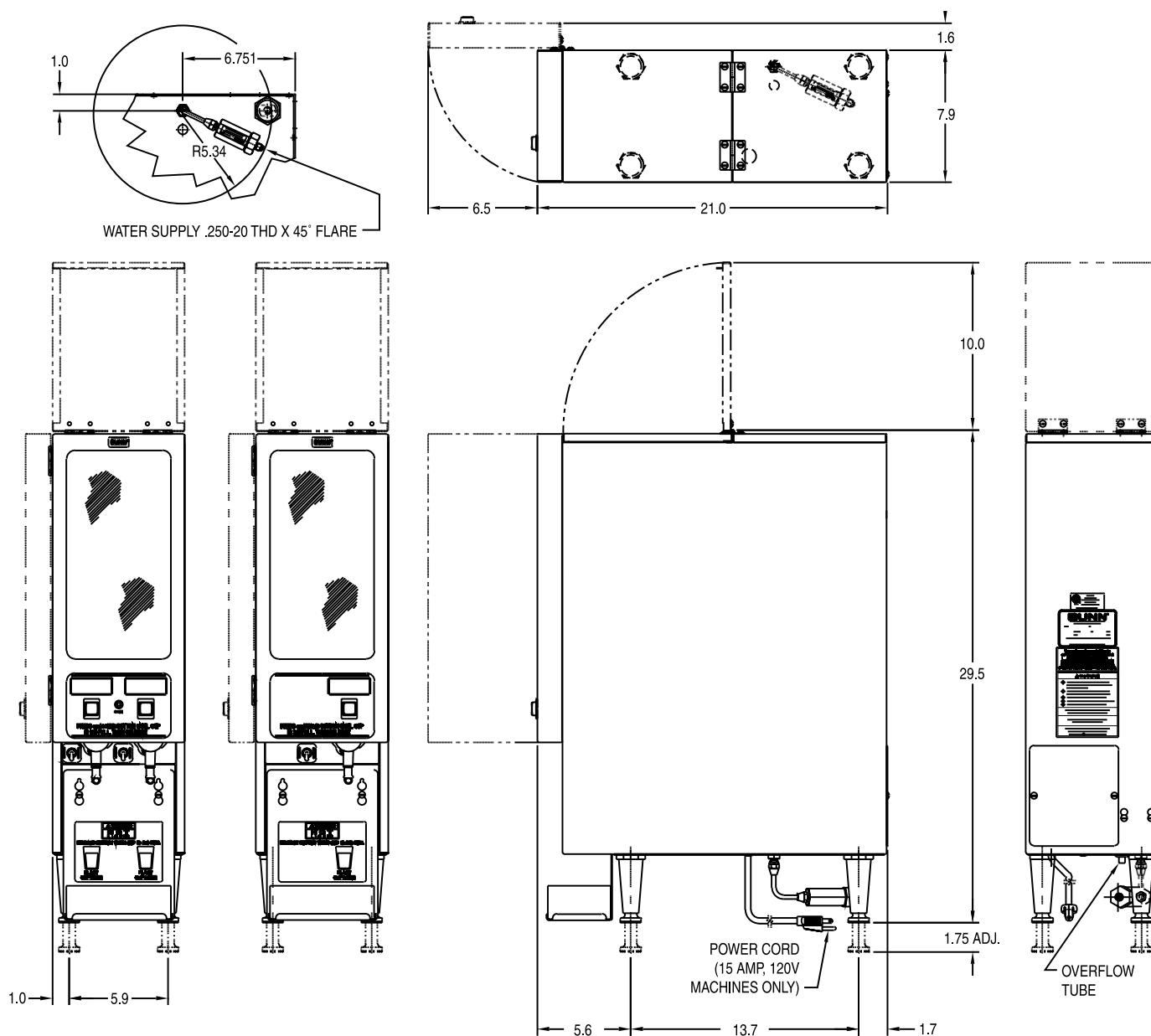

BUNN Corporation - 1400 Stevenson Drive Springfield, Illinois 62703 • 800-637-8606 • 217-529-6601 • Fax 217-529-6644 • [www.bunn.com](http://www.bunn.com)

BUNN® practices continuous product research and improvement. We reserve the right to change specifications and product design without notice. Such revisions do not entitle the buyer to corresponding changes, improvements, additions or replacements for previously purchased equipment.

All dimensions shown in inches. Bunn Corporation owns all copyrights relating to materials in this publication. Please contact Bunn Corporation to request permission to reproduce any portion of this publication.