

Prestige 24 Series

Spec Sheet No. PR-29

Job Name _____

Item No. _____

Insulated Bottle Storage

- All stainless steel structure from top to bottom.
- Mirrored front molding on all units.
- All units are foam insulated.
- Extruded black polyethylene thermal breaker marine edge.
- 3 pack bottle storage rack standard.

- PRI-24-6
- PRI-24-12

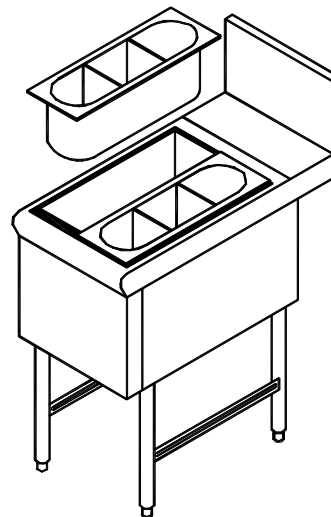

Specifications

- **Ice Bin:** 20 gauge 300 series stainless steel.
- **Front Apron:** 20 gauge 300 series stainless steel.
- **Sides:** 20 gauge 300 series stainless steel.
- **Backsplash:** 20 gauge 300 series stainless steel.
- **Plumbing:** 1" I.P.S. drain.
- **Insulation:** 2 lbs. density, foam in place insulation.
- **Legs:** 14 gauge 300 series stainless steel mounting bracket with 1-5/8" O.D. 18 gauge 300 series stainless steel & 1" adjustable stainless steel bullet feet.
- **Bottle Wells:** Injection molded polypropylene. *(removable)*



Supreme Metal

Toll Free: 800-645-2526
www.suprememetal.com

Prestige 24 Series

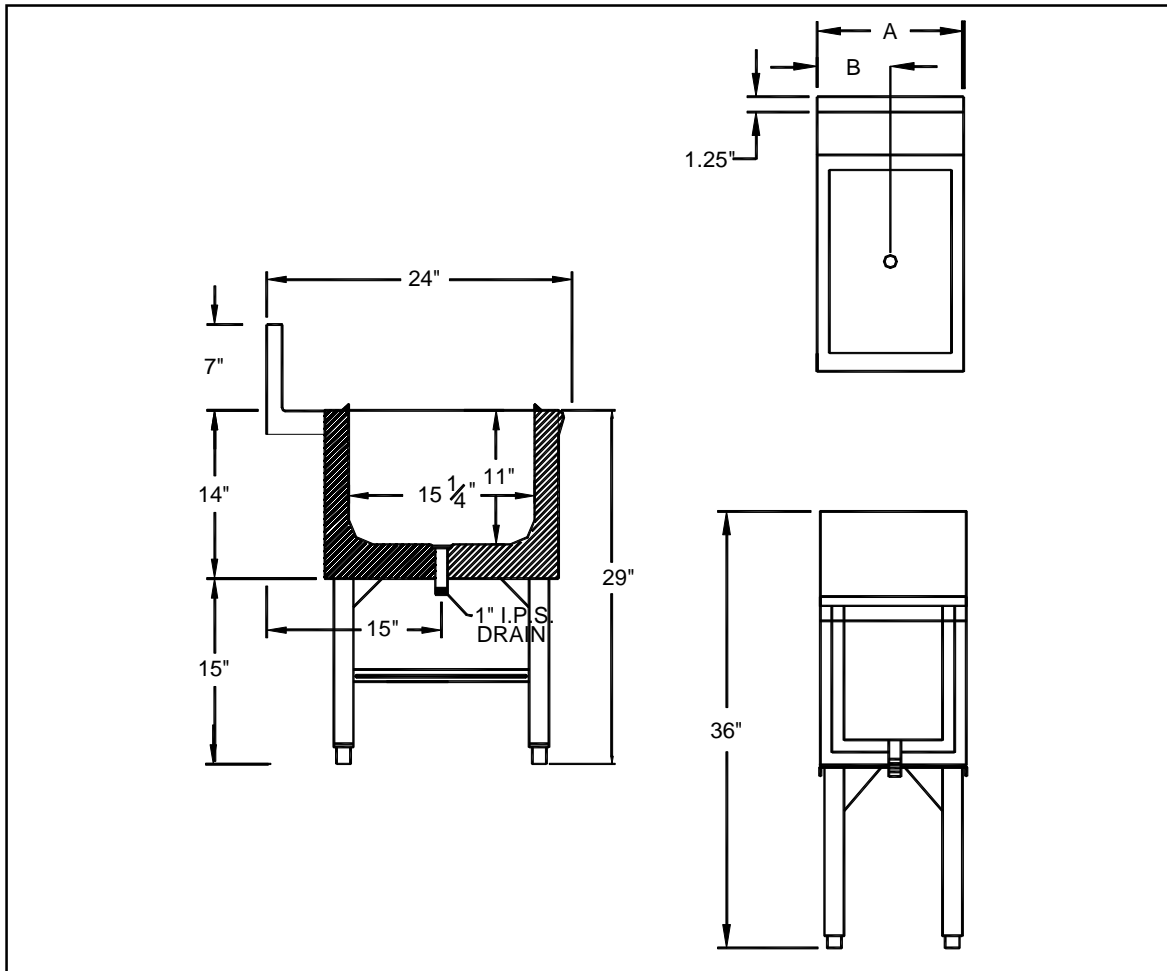

| Model Number | Overall Length (A) | Distance to Drain (B) | Inside Ice Bin Length | Bottle Capacity | Packaged Weight | Cubic Feet |
|--------------|--------------------|-----------------------|-----------------------|-----------------|-----------------|------------|
| PRI-24-6 | 6" | 3" | 4" | 3 | 30 Lbs. | 4 |
| PRI-24-12 | 12" | 6" | 10" | 6 | 45 Lbs. | 6 |

SupremeMetal is constantly engaged in a program of improving their products. We reserve the right to change our specifications without prior notice.